

NOTES

REFER TO STRUCTURAL ENGINEER PACKAGE AND LAYOUTS FOR ALL PROPOSED PLOT DRAINAGE.

REFER TO STRUCTURAL ENGINEER PACKAGE AND LAYOUTS FOR ALL PROPOSED PLOT DRAINAGE DETAILS.

REFER TO STRUCTURAL ENGINEER PACKAGE AND LAYOUTS FOR ALL PROPOSED SOAKAWAY LOCATION AND DETAILS.

REFER TO STRUCTURAL ENGINEER PACKAGE AND LAYOUTS FOR ALL PROPOSED PAVING DETAILS.

REFER ACROSS FOR ALL OUTLINE SPECIFICATION DATA INCLUDING PROPOSED EXTERNAL FINISHES.

NO SURFACE WATER IS TO DISCHARGE ONTO PUBLIC ROAD/SURFACES. ALL SURFACE WATER TO DRAINS/SOAKAWAY ON SITE AND AS PER STRUCTURAL ENGINEERS PROPOSALS.

ALL PROPOSALS SUBMITTED WITH GUIDANCE AND REFERENCE TO THE FOLLOWING DOCUMENTS :

- QUALITY HOUSING FOR SUSTAINABLE COMMUNITIES GUIDELINES
- SOUTH DUBLIN COUNTY COUNCIL DEVELOPMENT PLAN 2016-2019
- DEPARTMENT OF HOUSING, PLANNING, COMMUNITY AND LOCAL GOVERNMENT TECHNICAL GUIDANCE DOCUMENTS A-L [AS APPLICABLE].

ALL DETAILS TO COMPLY WITH TGD PART L APPROVED DETAILS AS APPLICABLE.

Rev	Date	Note	By

Status

DO NOT SCALE FROM DRAWING

All dimensions to be checked on site prior to the start of any work and any discrepancies notified in writing.

Refer to Engineers' drawings for all structural, heating, lighting, power, drainage and ventilation information.

All building works to comply in all respects to current Building Standards for country in which site is located.

All electrical work to be carried out in accordance with the latest edition of the Institute of Electrical Engineers Regulations and to the approval of the Local Authority.

All drainage work to be carried out in consultation with the Local Authority Inspectors and to be tested to the satisfaction of the Local Authority.

LEGEND	
01	<p>PROPOSED BOUNDARY HEDGE PLANTING COMPRISING OF :</p> <ul style="list-style-type: none"> - <i>Griselinia littoralis</i> [GRISELINIA] - <i>Ligustrum ovalifolium aurea variegata</i> [PRIVOT] - <i>Buxus sempervirens</i> [BUXUS] <p>Any variant used to be native to Ireland. All substrates to be prepared as per specific plant requirements.</p>
02	<p>PROPOSED WILDFLOWER PLANTED BED COMPRISING :</p> <ul style="list-style-type: none"> - Native Irish Wildflower Seed - Biodiversity Mix. Seed mix may include any of the following Species: <p><i>Annual Mayweed, Birdsfoot Trefoil, Black Meddock, Bladder Campion, Bluebell, Burdock, Cat's Ear, Common Sorrel, Common Vetch, Corn Marigold, Corn Poppy, Corn Spurry, Corncockle, Cornflower, Cowslip, Dames Violet, Devil's-bit Scabious, Eyebright, Field Scabious, Flag Iris, Fleabane, Foxglove, Garlic Hedge Mustard, Greater Trefoil, Hedge Garlic Mustard, Hemp Agrimony, Hoary Plantain, Kidney Vetch, Ladies Ann Lace, Lady's Bedstraw, Common Centaury, Lesser Knapweed, Musk Mallow, Marjoram, Meadow Buttercup, Meadowsweet, Mullein, Ox-Eye Daisy, Pineapple Mayweed, Purple Loosetrife, Ragged Robin, Red Bartsia, Red Campion, Red Clover, Ribwort Plantain, Rough Hawksbit, Scented Mayweed, Selfheal, Shepherd's Purse, Smooth Hawksbit, Sorrel, St. Johnswort, Teasel, Vetch Common, Weld, White Campion, Wild Angelica, Wild Carrot, Wild Valerian, Wood Sage, Woundwort, Yarrow, Yellow Agrimony, Yellow Rattle.</i></p> <p>Any species used to be native to Ireland. All substrates to be prepared as per specific plant requirements.</p>
03	<p>PROPOSED TREES :</p> <ul style="list-style-type: none"> - <i>Betula pendula</i> [SILVER BIRCH] <p>Any variant used to be native to Ireland. All substrates to be prepared as per specific tree requirements.</p>
04	<p>PROPOSED TREES :</p> <ul style="list-style-type: none"> - <i>Fraxinus excelsior</i> [ASH] <p>Any species used to be native to Ireland. All substrates to be prepared as per specific tree requirements.</p>
05	<p>PROPOSED TURFED GARDEN :</p> <p>Selected cultivars of Fescue, Bents and Smooth-Stalked Meadow rass. Chosen to give a medium texture, with good year round colour, drought/shade resistant, hard wearing, good appearance and good recovery. Any species used to be native to Ireland. All substrates to be prepared as per specific turfing requirements.</p>

NOTE : ALL SPECIED TO BE NATIVE TO IRELAND AND INTENDED TO PROMOTE LOCAL BIODIVERSITY WHILST PROVIDING VISUAL SCREENING AND MITIGATING ANY NEGATIVE VISUAL EFFECTS. ALL PLANTING TO THE APPROVAL OF SOUTH DUBLIN COUNTY COUNCIL PLANNING DEPARTMENT.

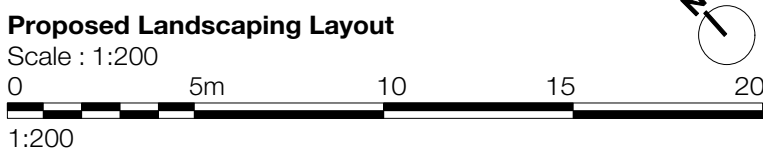

AREAS	
SITE AREA :	733m ² / 0.073 hec
PROPOSED FOOTPRINT :	105m ²
PROPOSED FRONT GARDEN :	235m ²
PROPOSED REAR GARDEN :	393m ²
GROUND FLOOR GIFA :	84.7m ²
FIRST FLOOR GIFA :	68.9m ²
TOTAL GIFA :	153.6m ²

Ian Gaffney
Architectural Consultancy Services
33 Allerton Avenue, Ballycragh, Dublin 24
igaffney88@gmail.com

Job Title			
Richard & Eliana Quinn, Proposed Dwelling at Killakee Green, D.24			
Drawing Title			
Proposed Landscape Layout			
Scale	Page	Drawn by	Checked by
Shown	A3	IG	
Job No.	Drawing No.	Revision	
(19)01	(PL)12		