

1 EXISTING SITE FLOW PATHS  
SCALE 1:500

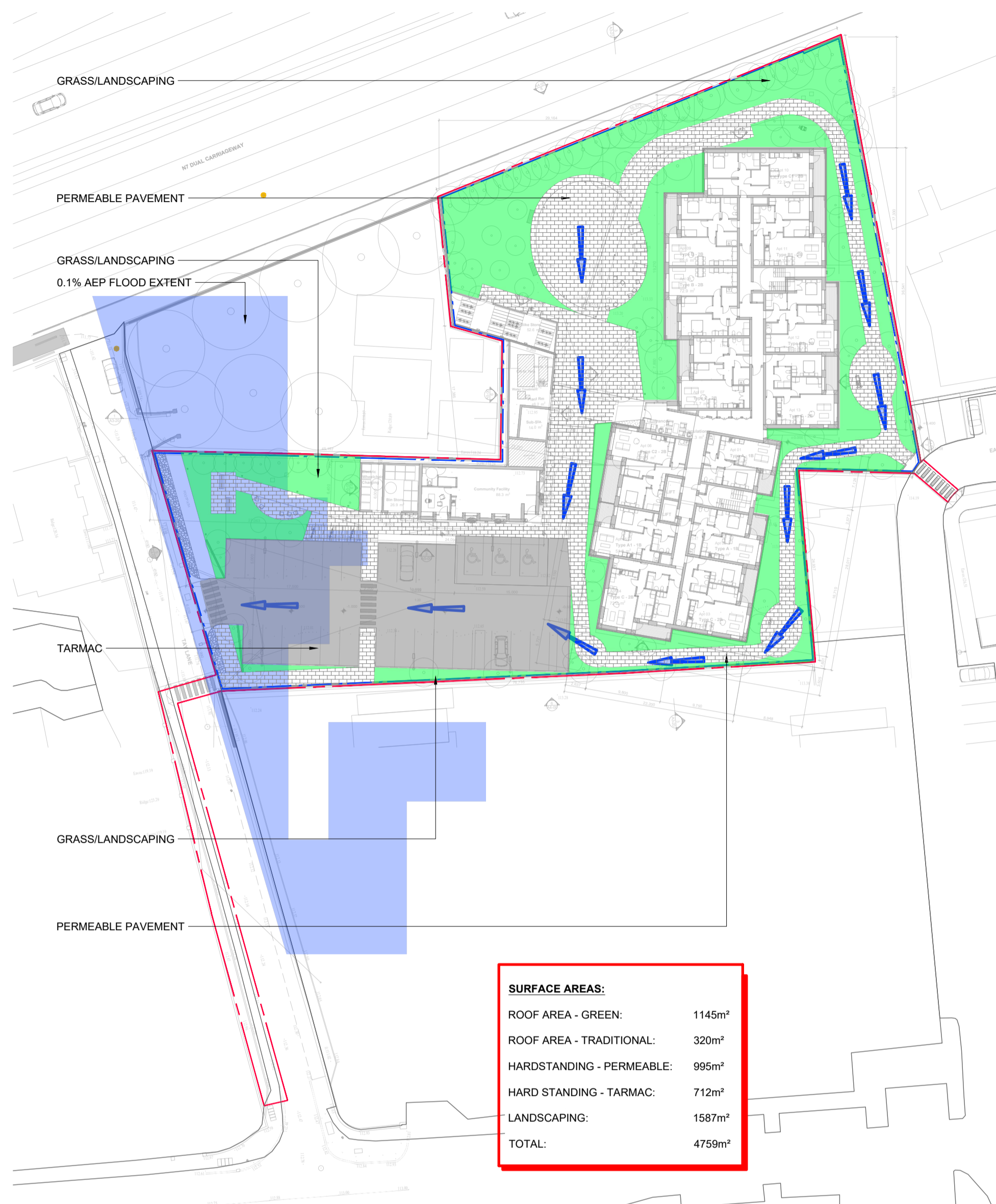

SURFACE AREAS:	
ROOF AREA - GREEN:	1145m <sup>2</sup>
ROOF AREA - TRADITIONAL:	320m <sup>2</sup>
HARDSTANDING - PERMEABLE:	995m <sup>2</sup>
HARD STANDING - TARMAC:	712m <sup>2</sup>
LANDSCAPING:	1587m <sup>2</sup>
TOTAL:	4759m <sup>2</sup>

1 PROPOSED SITE FLOW PATHS AND FINISHES  
SCALE 1:500



**NOTE:**  
IT IS PROPOSED TO INSTALL A SEDUM GREEN ROOF BUILD-UP TO THE MAIN BLOCK BUILDING AS PART OF THE OVERALL SUDS STRATEGY.  
PROPOSED GREEN ROOF: 1145m<sup>2</sup>  
PROPOSED FLAT ROOF: 320m<sup>2</sup>  
TOTAL ROOF AREA: 1465m<sup>2</sup>  
AS A RESULT, THE DEVELOPMENT WILL HAVE 78% GREEN ROOF COVERAGE.

1 PROPOSED GREEN ROOF EXTENTS  
SCALE 1:500

REV. NO.	REV. DESCRIPTION	REV. DATE	DRAWN	CHECKED
P1	PLANNING ISSUE	19/12/2022	TGB	JP
P2	GREEN ROOF EXTENTS ADDED	20/03/2023	TGB	JP
AP1	ISSUED FOR APPROVAL	19/09/2024	BD	JP

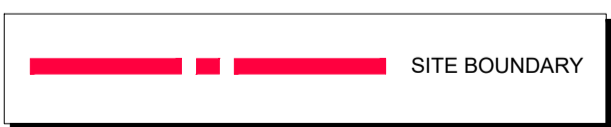

Drawing Stage:  
**FOR APPROVAL**

Project Details:	
Site Address:	ST. BRIDGETS TAYLANE, RATHCOOLE, CO. DUBLIN
Client:	RIVERSIDE PROJECTS Ltd.
Architect:	PAC STUDIO
M&E Designer:	-
Contractor:	-

Notes

Drawn by:	Checked by:	Approved by:	Date:
SG	JP	JP	08/11/2021
Project Name:	Scale:	Project Number:	
ST. BRIDGETS TAYLANE, RATHCOOLE	1:500 @ A1	2127	
Drawing Title:	Project:	Originator:	Zone:
EXISTING AND PROPOSED SURFACE WATER FLOW PATHS	-	CORA	-

**CORA** CONSULTING ENGINEERS  
Behan House,  
10 Lower Mount Street,  
Dublin 2. D02 HT71  
Tel: +353 1 661 1100  
e-mail: info@cora.ie  
Web: www.cora.ie

**System summary**



**BauderEXTENSIVE SEDUMsubstrate**  
SB sedum blanket on substrate system

The BauderEXTENSIVE SEDUMsubstrate system is an ideal product for green roofs. Sedum is both frost resistant and drought tolerant and requires little nutrient and minimal maintenance. Laying Bauder's mature SB sedum blanket on an 80mm bed of BauderGREEN SUB-EM UK extensive substrate gives the system the rooting depth and water retention to make it a very resilient green roof finish. The system is fully GRO and FLL compliant. This system is suitable for both new build construction and refurbishment applications on ≤ 5° (1:11) pitch.

Function	Product name	Thickness (mm)	Weight (kg/m <sup>2</sup> )	Indicative extensive green roof system - sedum
1 *Vegetation Layer	BauderGREEN SB sedum blanket	28	24	
2 Growing medium	BauderGREEN SUB-EM UK extensive substrate	80	96	
3 Filtration layer	FV 125 filter fleece	1	0.13	
4 Drainage Layer	DSE 20 drainage board	20	6.6	
5 Protection Layer	FEM 600 protection mat	4	3.6	
6 Underlying waterproofing system	Bauder's underlying waterproofing system	Not included	Not included	

\*Bauder supply various green roof systems to meet required bio-diversity targets and other green roof requirements.  
In-depth and up-to-date product specific technical data is available for each element within a system.  
Download from our website [bauder.co.uk/technical-centre](http://bauder.co.uk/technical-centre)  
Please note: All green roofs require water during times of drought. Bauder recommends that the watering and maintenance of the roof is considered and addressed during its design.