

DRAWING KEY

APARTMENT TYPES**

unit type	No. of beds	No. of storeys	No. of units
Type A1	- 1 bed	1 storey	16
Type A2	- 1 bed	1 storey	08
Type B2	- 2 bed	1 storey	10
Type B2.1	- 2 bed	1 storey	06
Type B2.2	- 2 bed	1 storey	02
Type B3	- 2 bed	1 storey	08
			50

CAR PARKING* SPACES PROVIDED**

Standard car spaces	40
UA car spaces	02
EV charging points	08
	42

BIKE PARKING* SPACES PROVIDED**

Residents	Standard bike spaces	126
	Cargo bike spaces	03
Visitors	Standard bike spaces	24
	Cargo bike spaces	10
		163

NOTES:
 * Refer to drawings 6268-P-200 to 6268-p-205 for duplex floorplan details
 ** Refer to drawings 6268-P-600 to 6268-P-602 for apartment units floorplan details
 *** Refer to drawing 6268-P-008 for parking strategy details

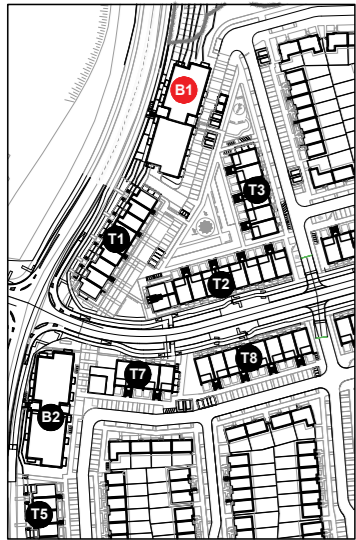

01 Keyplan
 P-302 1:2000

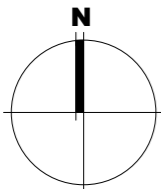

02 Block 01 Level 00 Floor Plan
 P-302 1:200

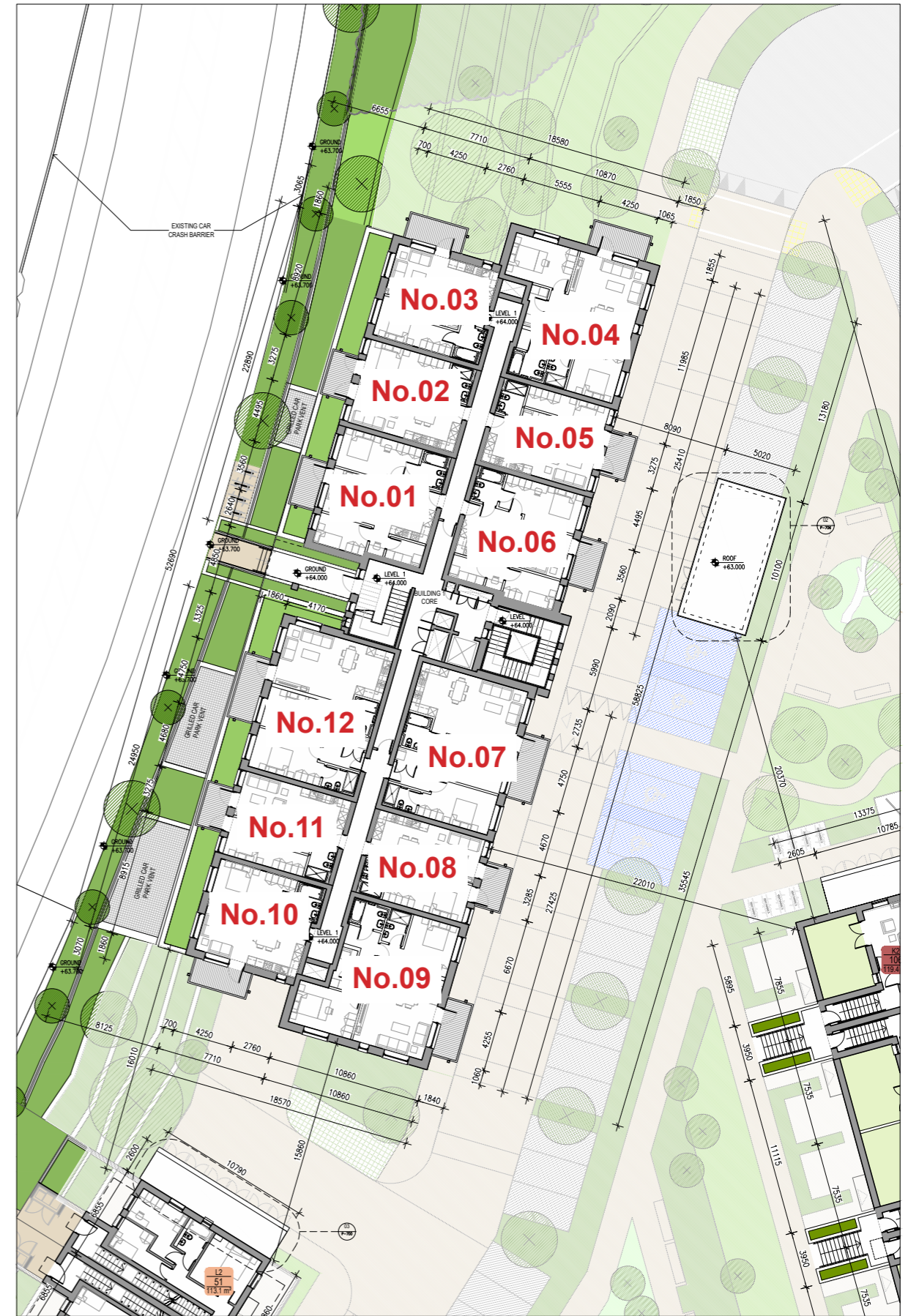

03 Block 01 Level 01 Floor Plan
 P-302 1:200

**Compliance Submission - Proposed Apt Numbering
 Herons Lock House Building (01-50)**

Notes:

Copyright Reserved
 Work to figured dimensions only. Do not scale drawing.
 The contractor is responsible for checking all levels and dimensions on site and shall refer all discrepancies to the Architect.
 Where appropriate, for details of c. c. structure, or mechanical and electrical details, see Engineers drawings.
 Proprietary items shall be fixed in strict accordance with manufacturers instructions.
 Sizes of proprietary items shall be checked with manufacturer.
 The contractor shall be responsible for the coordination of structure, finishes and services.

Issue Status	Progress
Planning Application	<input checked="" type="checkbox"/>
Fire Cert	<input type="checkbox"/>
Disability Cert	<input type="checkbox"/>
Tender	<input type="checkbox"/>
Construction	<input type="checkbox"/>
As Built	<input type="checkbox"/>
Information Only	<input type="checkbox"/>

No.	Date	Revision	Initials
1	01/11/23	RFT Submission	VB

Project	Adamstown Extension - Clonburris SDZ Residential Development
Drawing Title	Apartment Block 01 - Proposed L00-L01 floor plans
Drawing No	6268-P-300a
Scale	1:200@A1
Rev	00
Drawn	RT
Date	03/10/23



DRAWING KEY			
APARTMENT TYPES**			
unit type	No. of beds	No. of storeys	No. of units
Type A1	- 1 bed	1 storey	16
Type A2	- 1 bed	1 storey	08
Type B2	- 2 bed	1 storey	10
Type B2.1	- 2 bed	1 storey	06
Type B2.2	- 2 bed	1 storey	02
Type B3	- 2 bed	1 storey	08
			50
CAR PARKING***			
			SPACES PROVIDED
Standard car spaces			40
UA car spaces			02
EV charging points			08
			42
BIKE PARKING***			
			SPACES PROVIDED
Residents Standard bike spaces			126
Residents Cargo bike spaces			03
Visitors Standard bike spaces			24
Visitors Cargo bike spaces			10
			163
NOTES:			
* Refer to drawings 6268-P-200 to 6268-p-205 for duplex floorplan details			
** Refer to drawings 6268-P-600 to 6268-P-602 for apartment units floorplan details			
*** Refer to drawing 6268-P-008 for parking strategy details			

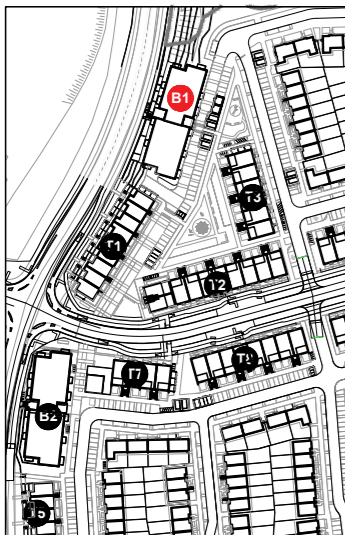

01 Keyplan
P-301 1:2000

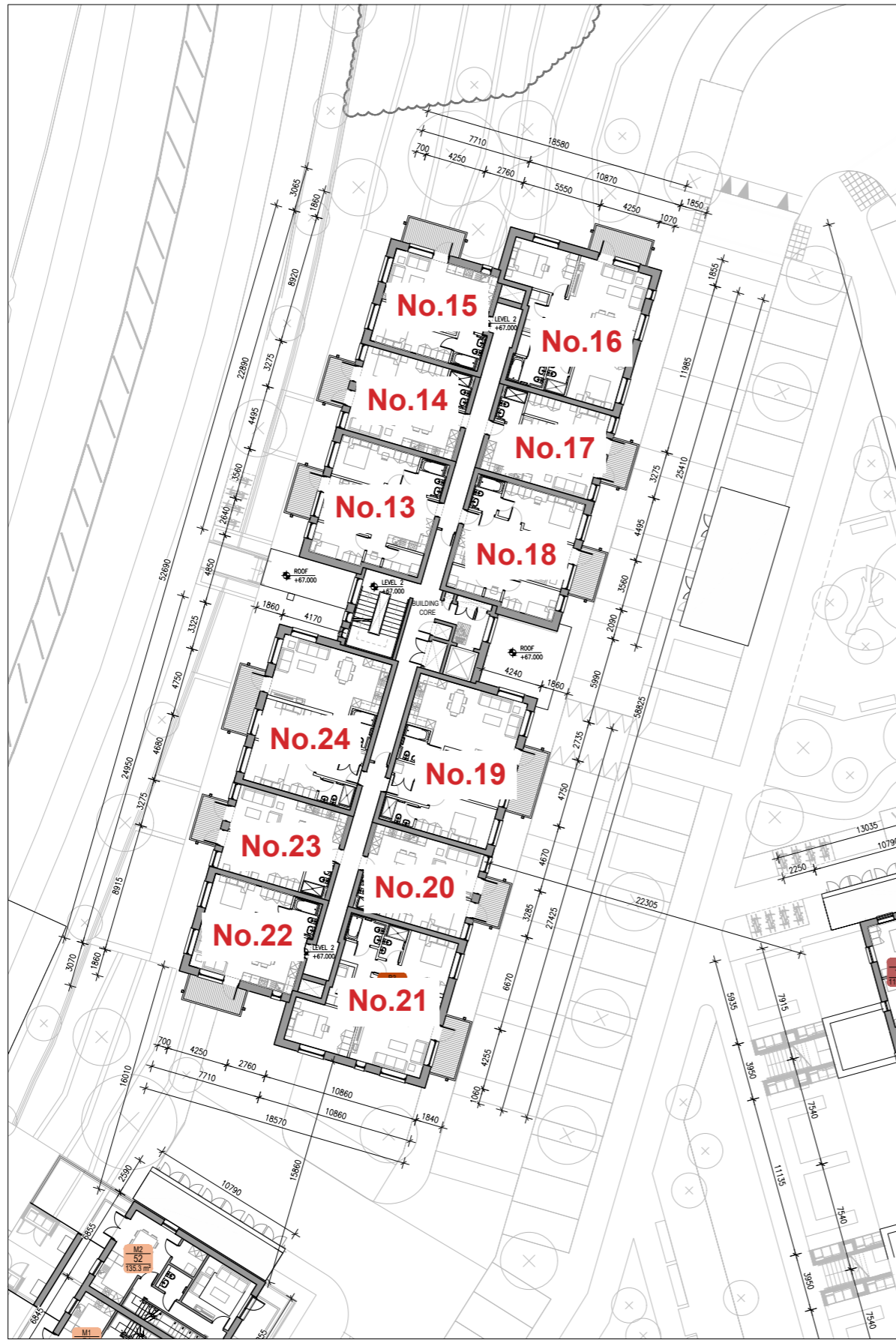
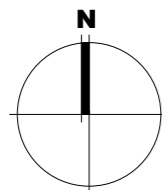

02 Block 01 Level 02 Floor Plan
P-301 1:200

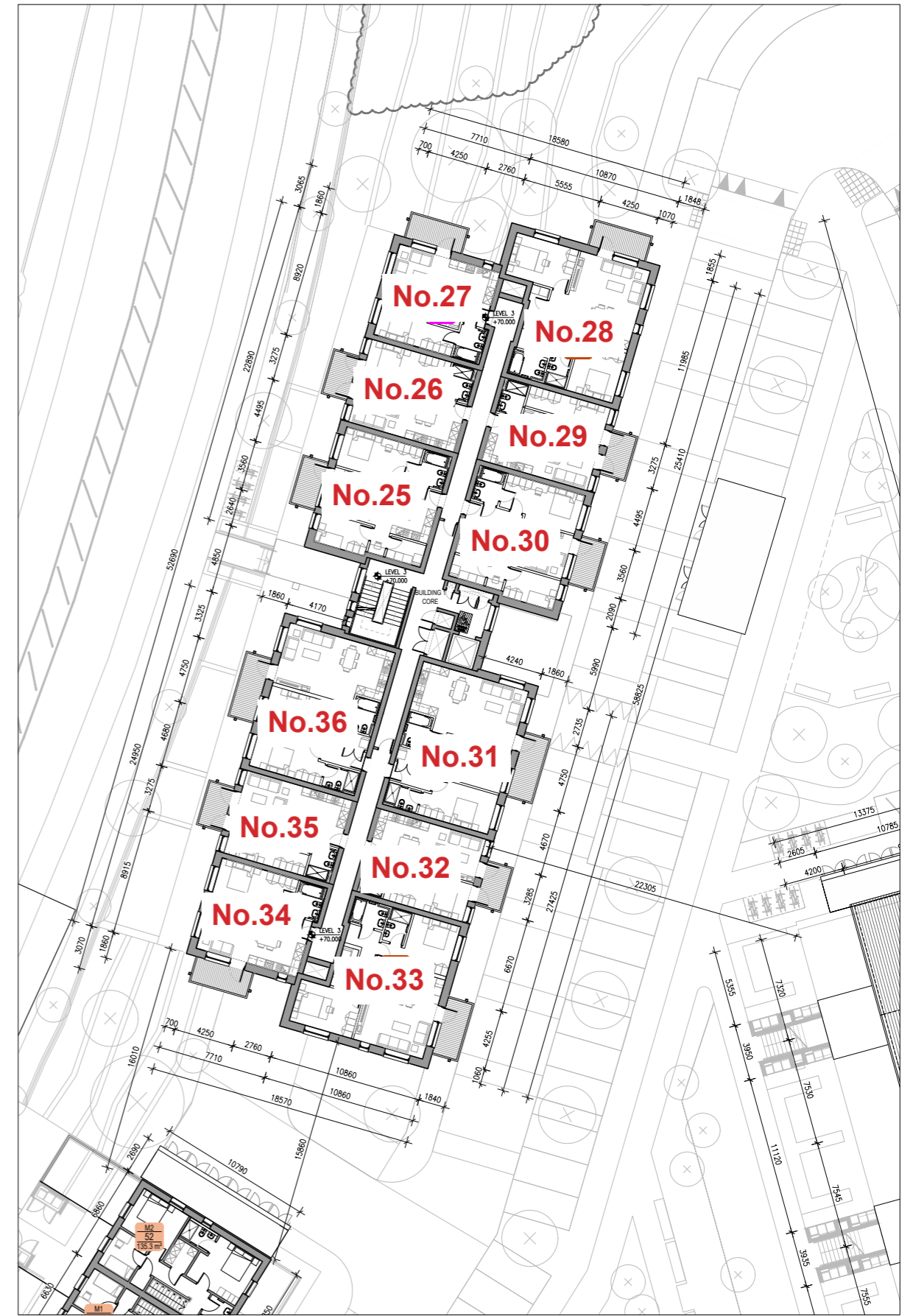

03 Block 01 Level 03 Floor Plan
P-301 1:200

Compliance Submission - Proposed Apt Numbering Herons Lock House Building (01-50)

Notes:
Copyright Reserved
Work to signed dimensions only. Do not scale drawing.
The contractor is responsible for checking all levels and dimensions on site and shall refer all discrepancies to the Architect.
Where appropriate, for details of r.c. structure, or mechanical and electrical details, see Engineers drawings.
Proprietary items shall be fixed in strict accordance with manufacturers instructions.
Sizes of proprietary items shall be checked with manufacturer.
The contractor shall be responsible for the coordination of structure, finishes and services.

Issue Status	Progress
Planning Application	■
Fire Cert	
Disability Cert	
Tender	
Construction	
As Built	
Information Only	

No.	Date	Revision	Initials
1	01/11/23	R1 Submission	VB

Project	Drawing Title	Drawing No.	Scale	Rev	Drawn	Date
Adamstown Extension - Clonburris SDZ Residential Development	Apartment Block 01 - Proposed L02 - L03 floor plans	6268-P-301a	1:200@A1	00	RT	03/10/23

Project		Drawing Title		Drawing No.		Scale		Rev		Drawn		Date	
Adamstown Extension - Clonburris SDZ Residential Development		Apartment Block 01 - Proposed L02 - L03 floor plans		6268-P-301a		1:200@A1		00		RT		03/10/23	

Project		Drawing Title		Drawing No.		Scale		Rev		Drawn		Date	
Adamstown Extension - Clonburris SDZ Residential Development		Apartment Block 01 - Proposed L02 - L03 floor plans		6268-P-301a		1:200@A1		00		RT		03/10/23	



DRAWING KEY

APARTMENT TYPES**

unit type	No. of beds	No. of storeys	No. of units
Type A1	- 1 bed	1 storey	16
Type A2	- 1 bed	1 storey	08
Type B2	- 2 bed	1 storey	10
Type B2.1	- 2 bed	1 storey	06
Type B2.2	- 2 bed	1 storey	02
Type B3	- 2 bed	1 storey	08
			50

CAR PARKING* SPACES PROVIDED**

Standard car spaces	40
UA car spaces	02
EV charging points	08
	42

BIKE PARKING* SPACES PROVIDED**

Residents	Standard bike spaces	Cargo bike spaces
	126	03
Visitors	Standard bike spaces	Cargo bike spaces
	24	10
		163

NOTES:
 * Refer to drawings 6268-P-200 to 6268-p-205 for duplex floorplan details
 ** Refer to drawings 6268-P-600 to 6268-P-602 for apartment units floorplan details
 *** Refer to drawing 6268-P-008 for parking strategy details

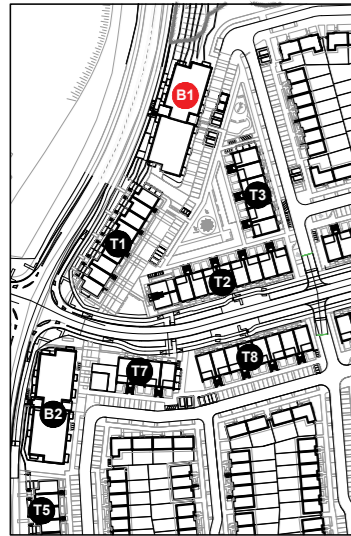

01 Keyplan
P-300 1:2000

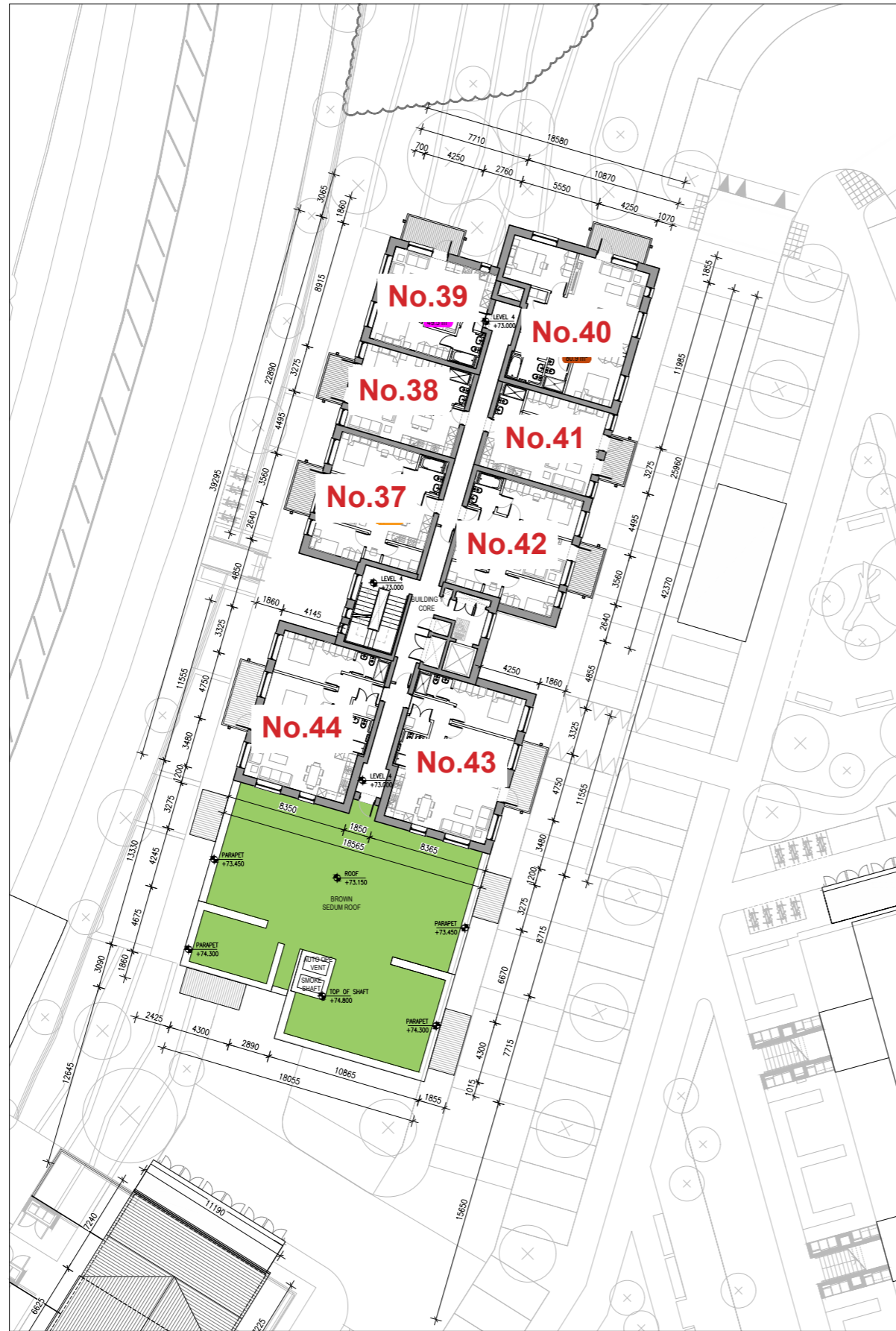
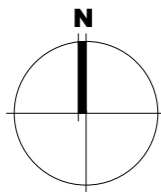

02 Block 01 Level 04 Floor Plan
P-300 1:200



03 Block 01 Level 05 Floor Plan
P-300 1:200

**Compliance Submission - Proposed Apt Numbering
 Herons Lock House Building (01-50)**

Notes
 1. Copyright Reserved
 2. Work to figured dimensions only. Do not scale drawing.
 3. The contractor is responsible for checking all levels and dimensions on site and shall refer all discrepancies to the Architect.
 4. Where appropriate, for details of r.c. structure, or mechanical and electrical details, see Engineers drawings.
 5. Proprietary items shall be fixed in strict accordance with manufacturers instructions.
 6. Sizes of proprietary items shall be checked with manufacturer.
 7. The contractor shall be responsible for the coordination of structure, finishes and services.

Issue Status	Progress
Planning Application	■
Fire Cert	
Disability Cert	
Tender	
Construction	
As Built	
Information Only	

No.	Date	Revision	Initials
1	01/11/23	R1 Submission	VB

Project	Adamstown Extension - Clonburris SDZ Residential Development
Drawing Title	Apartment Block 01 - Proposed L04 - L05 floor plans
Drawing No	6268-P-302a
Scale	1:200@A1
Rev	00
Drawn	RT
Date	03/10/23

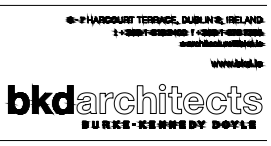

DRAWING KEY

APARTMENT TYPES**

unit type	No. of beds	No. of storeys	No. of units
Type A1	- 1 bed	1 storey	21
Type A2	- 1 bed	1 storey	10
Type B1	- 2 bed	1 storey	12
Type B2.1	- 2 bed	1 storey	10
Type B2.2	- 2 bed	1 storey	00
Type B3	- 2 bed	1 storey	11
			64

CAR PARKING* SPACES PROVIDED**

Standard car spaces	20
UA car spaces	01
EV charging points	24
	21

BIKE PARKING* SPACES PROVIDED**

Residents Standard bike spaces	100
Cargo bike spaces	03
Visitors Standard bike spaces	24
Cargo bike spaces	05
	132

NOTES:

- * Refer to drawings 6268-P-200 to 6268-p-205 for duplex floorplan details
- ** Refer to drawings 6268-P-600 to 6268-P-601 for apartment units floorplan details
- *** Refer to drawing 6268-P-008 for parking strategy details

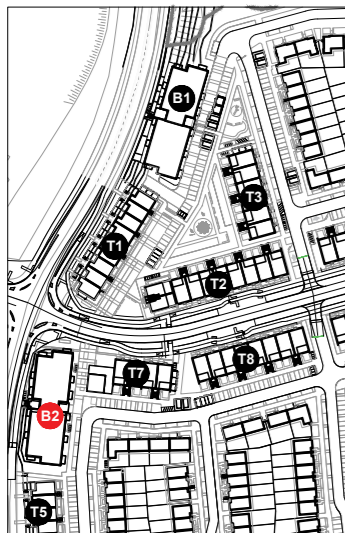

01 Keyplan
P-300 1:2000

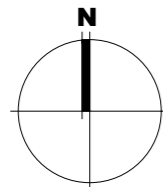

02 Block 02 Level 00 Floor Plan
P-304 1:200

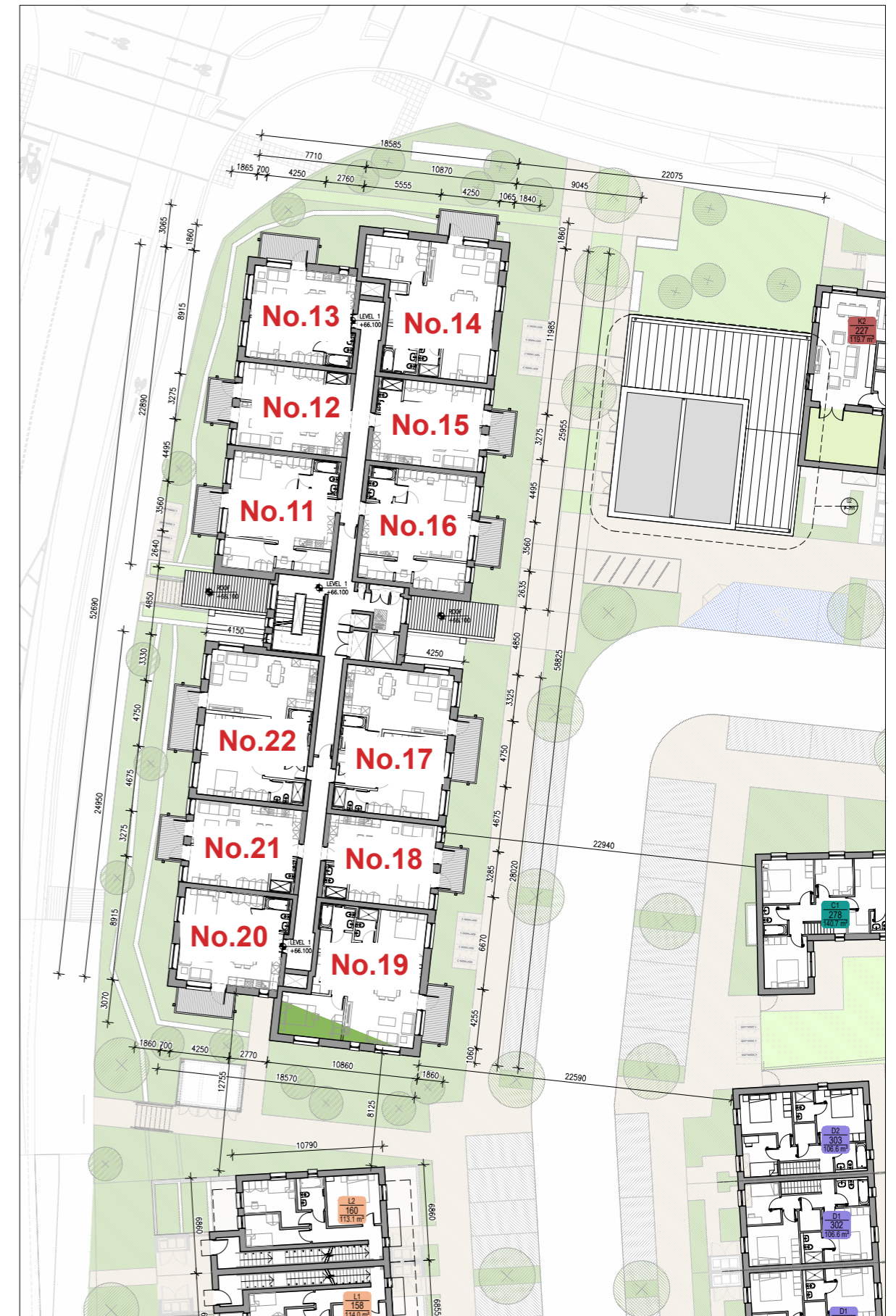

03 Block 02 Level 01 Floor Plan
P-304 1:200

Compliance Submission Proposed Apt Numbering - Herons Lock Manor Building (01-64)

Copyright Reserved
 All rights reserved. No part of this drawing may be reproduced, stored in a retrieval system, or transmitted in any form or by any means, electronic, mechanical, photocopying, recording, or by any information storage and retrieval system, without the prior written permission of the Architect.
 The Architect is responsible for checking all levels and dimensions on site and shall refer all discrepancies to the Architect.
 The Contractor is responsible for checking all levels and dimensions on site and shall refer all discrepancies to the Contractor.
 Where appropriate, for details of r.c. structure, or mechanical and electrical details, see Engineers drawings.
 Proprietary items shall be fixed in strict accordance with manufacturers instructions.
 As of proprietary items shall be checked with manufacturer.
 The Contractor shall be responsible for the coordination of structure, finishes and services.
 Information Only - Proposed Plans 6268-P-304-307
 18/09/2024 14:10:26

Issue Status	Progress
Planning Application	■
Fire Cert	
Disability Cert	
Tender	
Construction	
As Built	

No.	Date	Revision	Initials
1	01/11/23	RFT Submission	VB

Project	Adamstown Extension - Clonburris SDZ Residential Development
Drawing Title	Apartment Block 02 - Proposed L00 - L01 floor plans
Drawing No	6268-P-304
Scale	1:200@A1
Rev	00
Drawn	RT
Date	03/10/23

bkdarchitects
 BURKE-KENNEY-DOYLE

DRAWING KEY

APARTMENT TYPES**

unit type	No. of beds	No. of storeys	No. of units
Type A1	- 1 bed	1 storey	21
Type A2	- 1 bed	1 storey	10
Type B1	- 2 bed	1 storey	12
Type B2.1	- 2 bed	1 storey	10
Type B2.2	- 2 bed	1 storey	00
Type B3	- 2 bed	1 storey	11
			64

CAR PARKING* SPACES PROVIDED**

Standard car spaces	20
UA car spaces	01
EV charging points	04
	21

BIKE PARKING* SPACES PROVIDED**

Residents Standard bike spaces	100
Cargo bike spaces	03
Visitors Standard bike spaces	24
Cargo bike spaces	05
	132

NOTES:
 * Refer to drawings 6268-P-200 to 6268-p-205 for duplex floorplan details
 ** Refer to drawings 6268-P-600 to 6268-P-601 for apartment units floorplan details
 *** Refer to drawing 6268-P-008 for parking strategy details

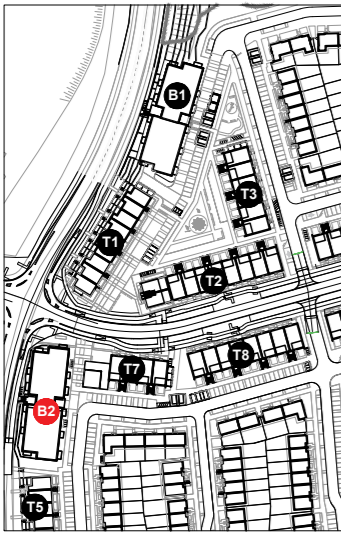

01 Keyplan
P-305 1:2000



02 Block 02 Level 02 Floor Plan
P-305 1:200



03 Block 02 Level 03 Floor Plan
P-305 1:200

Compliance Submission Proposed Apt Numbering - Herons Lock Manor Building (01-64)

Notes	Issue Status
1. Copyright Reserved	
2. Work to figured dimensions only. Do not scale drawing.	
3. The contractor is responsible for checking all levels and dimensions on site and shall refer all discrepancies to the Architect.	
4. Where appropriate, for details of f.c. structure, or mechanical and electrical details, see Engineers drawings.	
5. Proprietary items shall be fixed in strict accordance with manufacturers instructions.	
6. Sizes of proprietary items shall be checked with manufacturer.	
7. The contractor shall be responsible for the coordination of structure, finishes and services.	
8. Proposed Plans.dwg 18/05/2024 14:41:16	

Progress	Planning Application	Fire Cert	Disability Cert	Tender	Construction	As Built	Information Only

No.	Date	Revision	Initials
1	01/11/23	RFI Submission	VB

Project	Adamstown Extension - Clonburris SDZ Residential Development
Drawing Title	Apartment Block 02 - Proposed L02 - L03 floor plans
Drawing No	6268-P-305
Scale	1:200@A1
Rev	00
Drawn	RT
Date	03/10/23

PHARMACY TOWER, DUBLIN 8, IRELAND
 T: +353 (0)1 454 5000 F: +353 (0)1 454 5001
 www.bkd.ie

bkdarchitects
 BURKE-KENNEDY DOYLE

DRAWING KEY			
APARTMENT TYPES**			
unit type	No. of beds	No. of storeys	No. of units
Type A1	- 1 bed	1 storey	21
Type A2	- 1 bed	1 storey	10
Type B1	- 2 bed	1 storey	12
Type B2.1	- 2 bed	1 storey	10
Type B2.2	- 2 bed	1 storey	00
Type B3	- 2 bed	1 storey	11
			64
CAR PARKING*** SPACES PROVIDED			
Standard car spaces			20
UA car spaces			01
EV charging points			04
			21
BIKE PARKING*** SPACES PROVIDED			
Residents	Standard bike spaces		100
	Cargo bike spaces		03
Visitors	Standard bike spaces		24
	Cargo bike spaces		05
			132
NOTES:			
* Refer to drawings 6268-P-200 to 6268-p-205 for duplex floorplan details			
** Refer to drawings 6268-P-600 to 6268-P-601 for apartment units floorplan details			
*** Refer to drawing 6268-P-008 for parking strategy details			

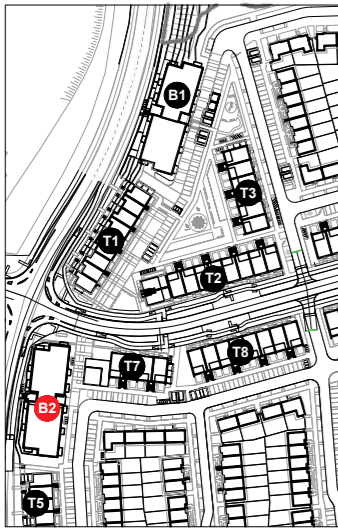

01 Keyplan
P-305 1:2000

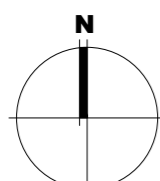

02 Block 02 Level 04 Floor Plan
P-306 1:200

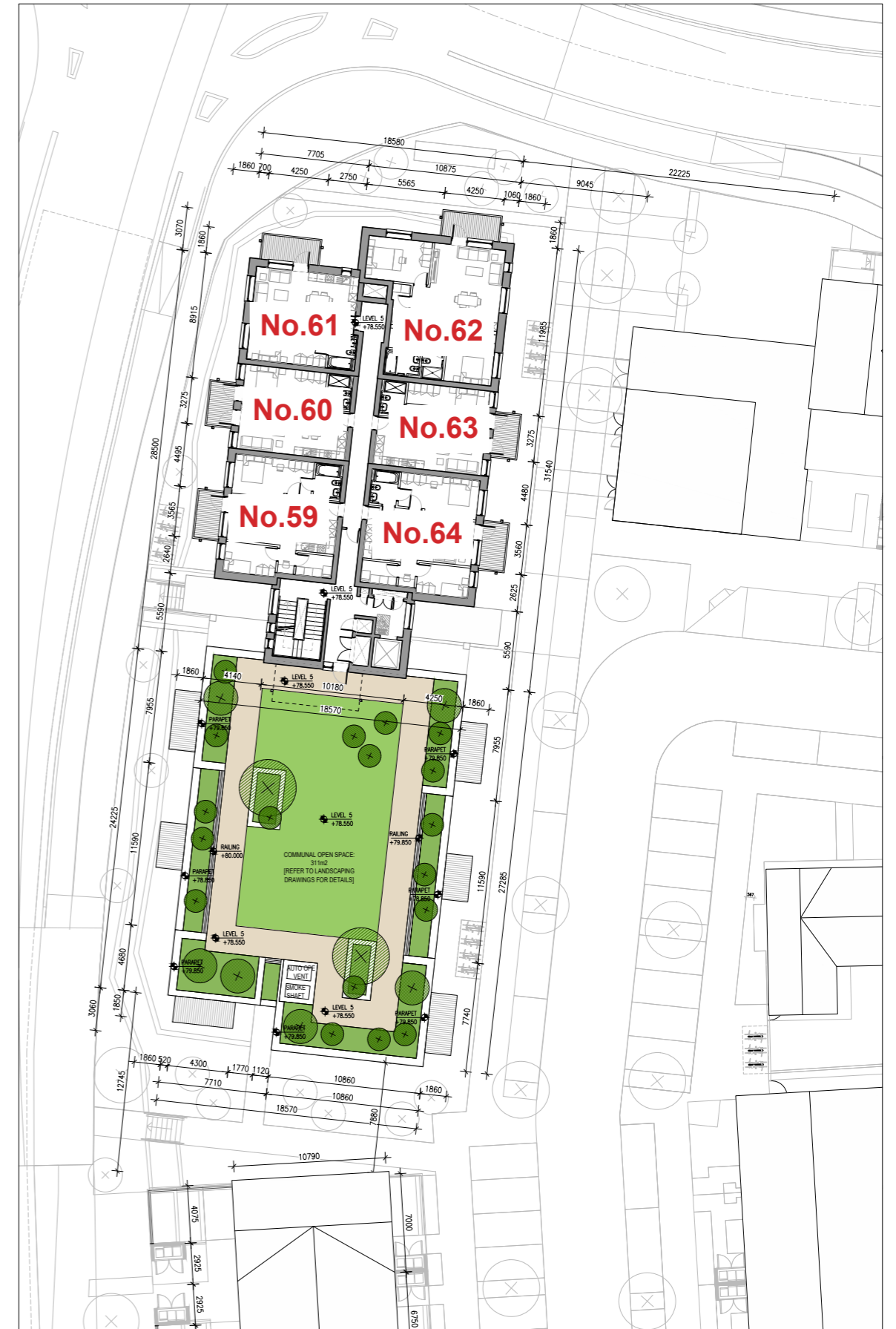

03 Block 02 Level 05 Floor Plan
P-306 1:200

Compliance Submission Proposed Apt Numbering - Herons Lock Manor Building (01-64)

Notes	Issue Status
1. Copyright Reserved	Progress
2. Work to figured dimensions only. Do not scale drawing.	Planning Application
3. The contractor is responsible for checking all levels and dimensions on site and shall refer all discrepancies to the Architect	Fire Cert
4. Where appropriate, for details of c. structure, or mechanical and electrical details, see Engineers drawings	Disability Cert
5. Proprietary items shall be fixed in strict accordance with manufacturers instructions.	Tender
6. Sizes of proprietary items shall be checked with manufacturer.	Construction
7. The contractor shall be responsible for the coordination of structure, finishes and services.	As Built

No.	Date	Revision	Initials
1	01/11/23	RFI Submission	VB

Information Only - Proposed Plans 6268-P-301

Project		Adamstown Extension - Clonburris SDZ Residential Development	
Drawing Title		Apartment Block 02 - Proposed L04 - L05 floor plans	
Drawing No		6268-P-306	
Scale	1:200@A1	Rev	00
Drawn	RT	Date	03/10/23

11 HAVESLUY TERRACE, DUBLIN 9, IRELAND
T: +353 (0)1 454 6666 F: +353 (0)1 454 6666
www.bkdarchitects.com
bkdarchitects
BURKE-KENNEDY DOYLE