

INSET PLAN - NATURAL PLAY AREA - 147 SQM - 1:100



**PG1: Wobble Dish**  
by Timberplay - Product Code: 6.27300



**NP1: Locally Sourced** Glacial boulders - various sizes up to 300 - 600mm high  
Installation; 300mm below ground, Form; Rounded edges  
Note: Stepping Boulders to be no more than 300mm apart



**NP2: Hardwood Timber** stepping logs 0.2 - 5m high, Set in in-situ concrete.  
By Creative Play or similar approved.



**PG2: EVOPEDE® Outdoor Slither Stone**  
Material: Limestone, 500mm diameter hole  
By Timberplay - Product Code: 12.00210



**NP3: Overturned felled Tree** - Climbing  
Form: Clipped and sanded where appropriate  
Note: Locally sourced from tree felling within the Clonburris SDZ



**NP4: Overturned Tree Logs** - Seating  
Sanded where appropriate  
Note: Locally sourced from tree felling within the Clonburris SDZ

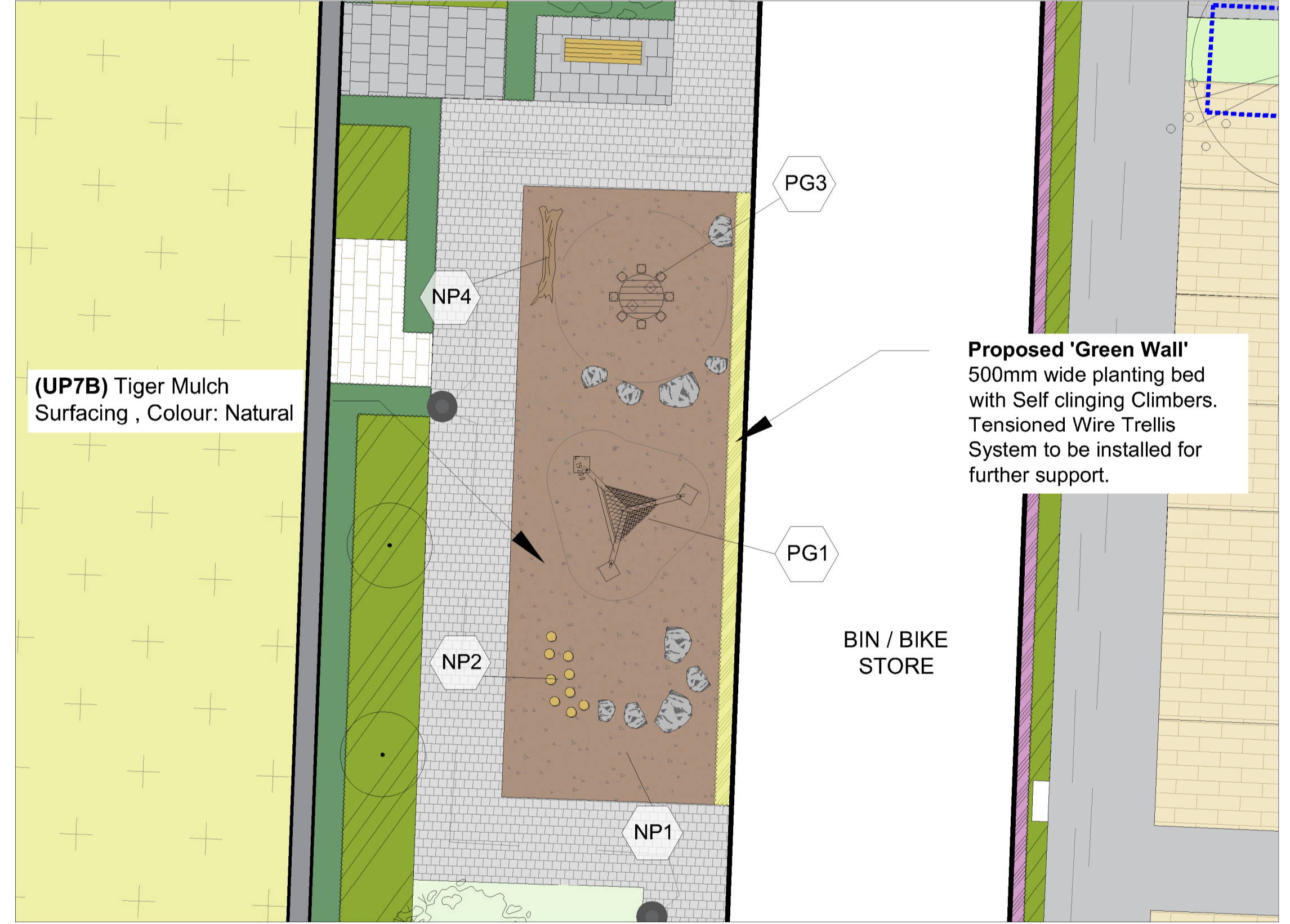

INSET PLAN - TODDLER PLAY AREA - 73 SQM - 1:100



**PG3 - Toddlers Table with 8 Stools**  
By Timberplay - Product Code: 4.35050



**PG5 - Tubular Chimes**  
By Timberplay  
Product Code: 10.52400

**NATURAL PLAY AREA - SURFACE TYPES**



**UP7A - Engineered Woodchip Surfacing**  
NOTE: Grass Berm to enclose Woodchip surface. See Section A-a for interaction with Tiger Mulch Surfacing.



**UP7B - Tiger Mulch Surfacing**  
Colour: Natural  
Note: Tiger Mulch enclosed by Grass Berm Surfacing.



**PG4 - Distorting Mirror**  
By Timberplay - Product Code: 9.10702

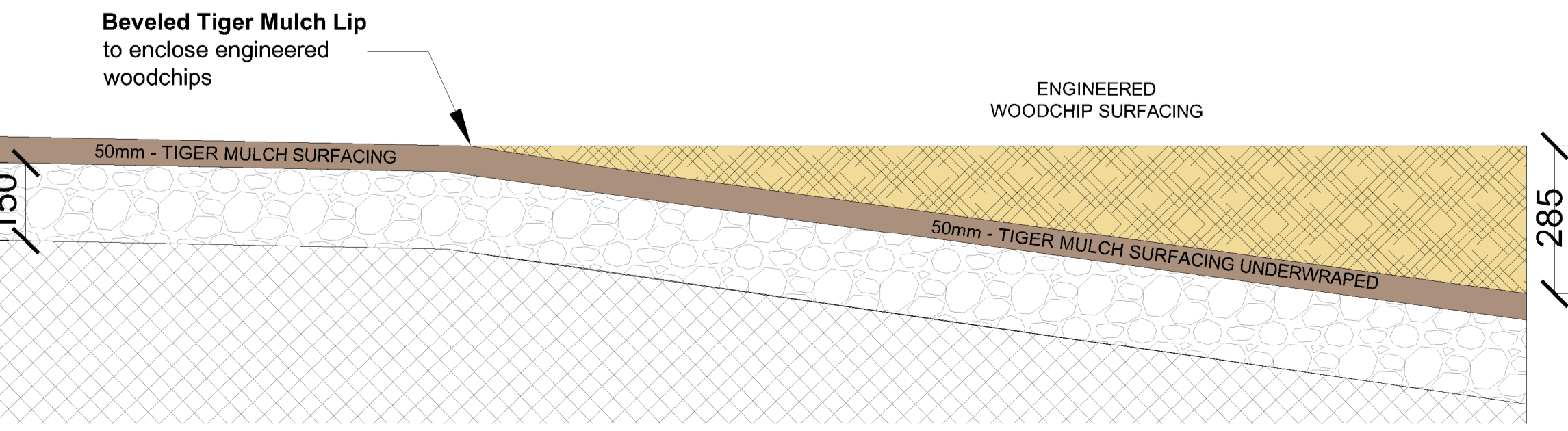

**Section A-a - Typical Section through Tiger Mulch / Engineered Woodchip Surfacing**  
NOTE: Tiger Mulch Underwrapped under Engineered Woodchip Surfacing.

- DRAWING NOTES:**
- TIGER MULCH TO UNDERWRAP ENGINEERED WOODCHIP SURFACING AS PER SECTION A-a.
  - NOTE: NO TIMBER EDGING PROPOSED TO PLAY AREAS. GRASS BERM TO ENCLOSE TIGER MULCH / ENGINEERED WOODCHIP SURFACE.

REV	DATE	AMENDMENT
D	09.07.24	Chicane Style Railing omitted.
C	01.07.24	PG1, PG4 & PG5 revised to Natural Play areas R1 railing added to Plan. Section A-a added.
B	22.05.24	Natural Play areas redesigned further to Natural play specialist best design practise and recommendations
A	17.05.24	Natural Play spaces revised following designers risk assessment and to include more safe and appropriate equipment.

**FOR COMPLIANCE**

**CUNNANE STRATTON REYNOLDS**  
**LAND PLANNING & DESIGN**

DUBLIN, CORK & GALWAY  
GAINSBORO HOUSE, 24 SUFFOLK STREET, DUBLIN 2, D02 KF65  
TEL 01 661 0419  
EMAIL info@csrandplan.ie

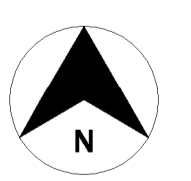

PROJECT: CLONBURRIS CAIRN T3	DATE: JULY 2024
DRAWING: PLAY EQUIPMENT PLAN	SCALE: 1:100 @ A1
	DRAWN: CHECKED: LR AF
	DRAWING NO: CLB-03-06-T9-XX-DR-CSR-LA-0940