

- Note:
- refer to drawing no.:
 - 1738_C_P_00 for Masterplan;
 - 1738_C_P_01.1 for Masterplan - 01/02;
 - 1738_C_P_01.1.1 for Masterplan North East Side;
 - 1738_C_P_01.2 for Masterplan - 02/02;
 - 1738_C_P_01.2.2 for Block 1 - Construction Details;
 - 1738_C_P_01.2.2.1 for Block 1 - Apartment Block External Approach Route;
 - 1738_C_P_01.2.2.2 for Apartment Block Entrances;
 - 1738_C_P_01.2.4 for Parkleigh Green - Levels;
 - 1738_C_P_02 for Curtilage detailed Plans;
 - 1738_C_P_02.1 for Duplex Blocks Link Street - Block A - B - F - G - H - J;
 - 1738_C_P_02.1.1 for Duplex Blocks Link Street - Block F;
 - 1738_C_P_02.2 for Duplex Blocks Link Street - Block L - M - N;
 - 1738_C_P_04.1 for Boundary Treatment Plan & Details | Residential Boundaries;
 - 1738_C_P_04.1.1 for Boundary Transitions - Street D1;
 - 1738_C_P_04.1.3 for Boundary Treatment - House 17 & 18 Parkleigh Lane;
 - 1738_C_P_04.2 for Boundary Treatment Plan & Details | Open Space Boundaries;
 - 1738_C_P_5.1 for Hard Landscape and Earthwork Plan - 01/02
 - 1738_C_P_5.2 for Hard Landscape and Earthwork Plan - 02/02
 - 1738_C_P_06 for Play Areas;
 - 1738_C_P_06.1 for Play Area - Linear Canal Park;
 - 1738_C_P_07 for Soft Landscape Plan - 01/02;
 - 1738_C_P_07.2 for Soft Landscape Plan - 02/02;
 - 1738_C_P_10 series for Soft Landscape Plans;
 - 1738_C_P_12 for Linear Park - Entrance Areas;
 - 1738_C_P_13 for Parkleigh Signage;
 - 1738_C_P_14 for Street signage markup layout;
 - 1738_C_P_15 for Furniture - Benches Layout;
 - 1738_C_P_20 for Landscape Plan - Linear Park Construction Stage;
 - 1738_C_P_21 for Landscape Plan - Northwest Local Park Construction Stage;
 - 1738_C_P_21.1 for Sections - Northwest Local Park;
 - 1738_C_P_22 for Detail Landscape Plan - Western Plaza Area;
 - 1738_C_P_22.1 for Planting Plan - Southwest Linear Park;
 - 1738_C_P_23 for Entrance Area Plan;
 - 1738_C_D series for landscape Details.

- STREET HIERARCHY**
- LOCAL STREETS**
- Parkleigh Row
 - Parkleigh Avenue
 - Parkleigh Drive
 - Parkleigh Close
 - Parkleigh Green
 - Parkleigh Lawns
 - Parkleigh Way
 - Parkleigh Road
- HOMEZONE STREETS**
- Parkleigh Walk
 - Parkleigh Square
 - Parkleigh Lane
 - Parkleigh Crescent
 - Parkleigh Court
 - Parkleigh Grove
 - Parkleigh Gardens

- Entrance Plaza
 - Allows pedestrian and cycle access from development to north
- Communal Amenity Courtyard Space for Apartment Development
- Intimate Open Spaces (Communal Amenity)
 - Spaces for seating and gathering within a residential area, associated with homezones
- Informal seating spaces within canal open space
 - seating areas associated with homezones to the north
 - self-binding gravel surfacing
 - ornamental shrub and perennial planting
- Ormer Lock House (Potential Crossing Point to future detailed design)
- Natural Play Spaces
 - incorporating natural playful elements and less formal structured equipment
- Formal structured play associated with apartment courtyard
- Gentle slope to detention basin
 - Basin edge has varying gradients - outer edge closest to canal slopes less steeply to allow universal access and the basin to become part of the wider landscape
- Local Green Corridor within development
- Existing Bridge to be replaced with new pedestrian/cycle bridge to provide access to Pedestrian/Cycle Greenway
- Attenuation Park - Work by others

- NOTES
- Do not scale from this drawing; use fig and dimensions only.
 - Disproportionate to the drawing for Murray & Associates for circulation.
 - The copyright of this drawing is vested with Murray & Associates. This drawing may not be copied or reproduced without written consent.
 - Use of this drawing for construction purposes is strictly subject to supervision by Murray & Associates.
 - Materials or products referred to on this drawing may be substituted with a material of equal quality and suitability for purpose subject to the approval of Murray & Associates and Council authorities.

murray & associates
landscape architecture

16 The Support Building, 44-45 Clontarf Road, Dublin 3, D03 RFD3 | email@murray-associates.com | www.murray-associates.com | +353 (0)1 854 0000

REV	DATE	REVISION	FT/IS	MB
N	13/06/24	Revision	FT/IS	MB
M	11/06/24	Revision	FT/IS	MB
L	29/05/24	Revision	FT/IS	MB
K	21/05/24	Revision	FT/IS	MB
J	03/05/24	Revision	FT/IS	MB
I	25/04/24	Revision	FT/IS	MB
H	12/03/24	Revision	FT/IS	MB
G	22/12/23	Revision	FT/IS	MB
F	02/11/23	Revision	FT/IS	MB
E	26/09/23	Revision	FT/IS	MB
D	21/08/23	Revision	FT/IS	MB
C	10/07/23	Revision	FT/IS	MB
B	07/07/23	Construction	FT/IS	MB
A	27/06/23	Construction	FT/IS	MB
0	08/06/23	Construction	FT/IS	MB

CLIENT
CAIRN HOMES

PROJECT TITLE
RESIDENTIAL DEVELOPMENT
CLONBURRIS

SHEET TITLE
Masterplan

SHEET NO.
1738_C_P_00

SCALE
1:1000

STAGE
Construction

SHEET SIZE
A1

REVISION
N

DATE
13/06/24

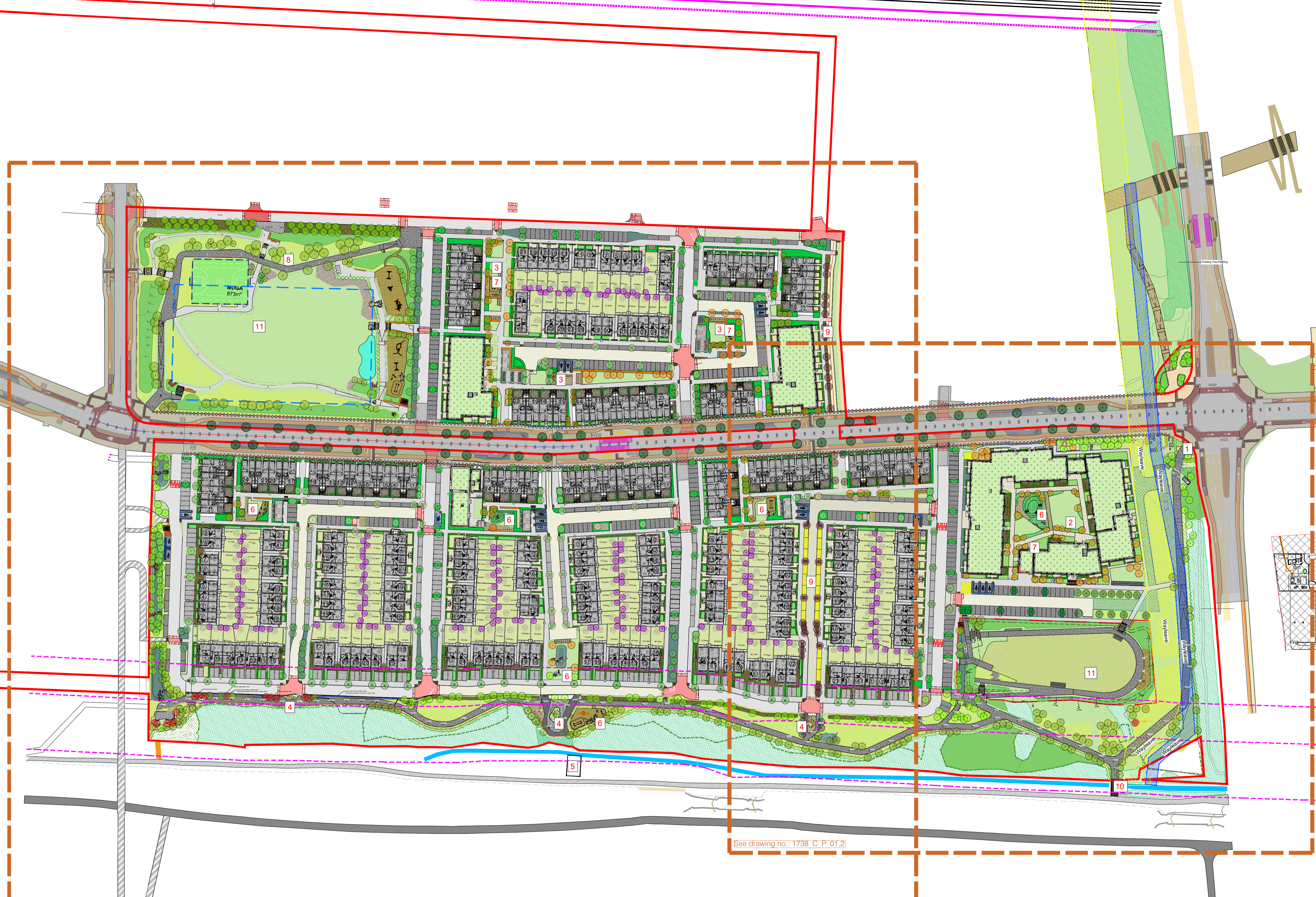

See drawing no.: 1738_C_P_01.1

See drawing no.: 1738_C_P_01.2