

NOTES

- THIS DRAWING IS TO BE READ IN CONJUNCTION WITH ALL ENGINEERS & ARCHITECTS DRAWINGS. DIMENSIONS ONLY (NOT SCALING) TO BE USED. WHERE A CONFLICT OF INFORMATION EXISTS OR IF IN ANY DOUBT - ASK!
- CONSULTANTS TO BE INFORMED IMMEDIATELY OF ANY DISCREPANCIES BEFORE WORK PROCEEDS.
- THIS DRAWING SHOULD BE READ IN CONJUNCTION WITH BMCE 10000 DRAWING.
- ALL TREE PIT SURFACE WATER PIPES TO BE 110mm Ø PIPES LAID AT 1:150. REFER TO DRAWING 11300 FOR PLAN CALL OFF AND DRAWING 12322 FOR CROSS SECTION DETAILS.
- ALL PERFORATED PIPES UNDER PERMEABLE CAR PARKING SPACES TO BE 150mm Ø REFER TO DRAWING 11300 FOR PLAN CALL OFFS AND DRAWING 12300 FOR CROSS SECTION DETAILS.
- ALL SURFACE WATER ROAD GULLY PIPES TO BE 110mm Ø.
- ALL ACO CHANNEL POP UPS TO BE 110mm Ø.
- ALL FOUL PIPES FROM IC TO MAIN SEWER LINE TO BE 150mm Ø @ 1:150 UNLESS OTHERWISE STATED.

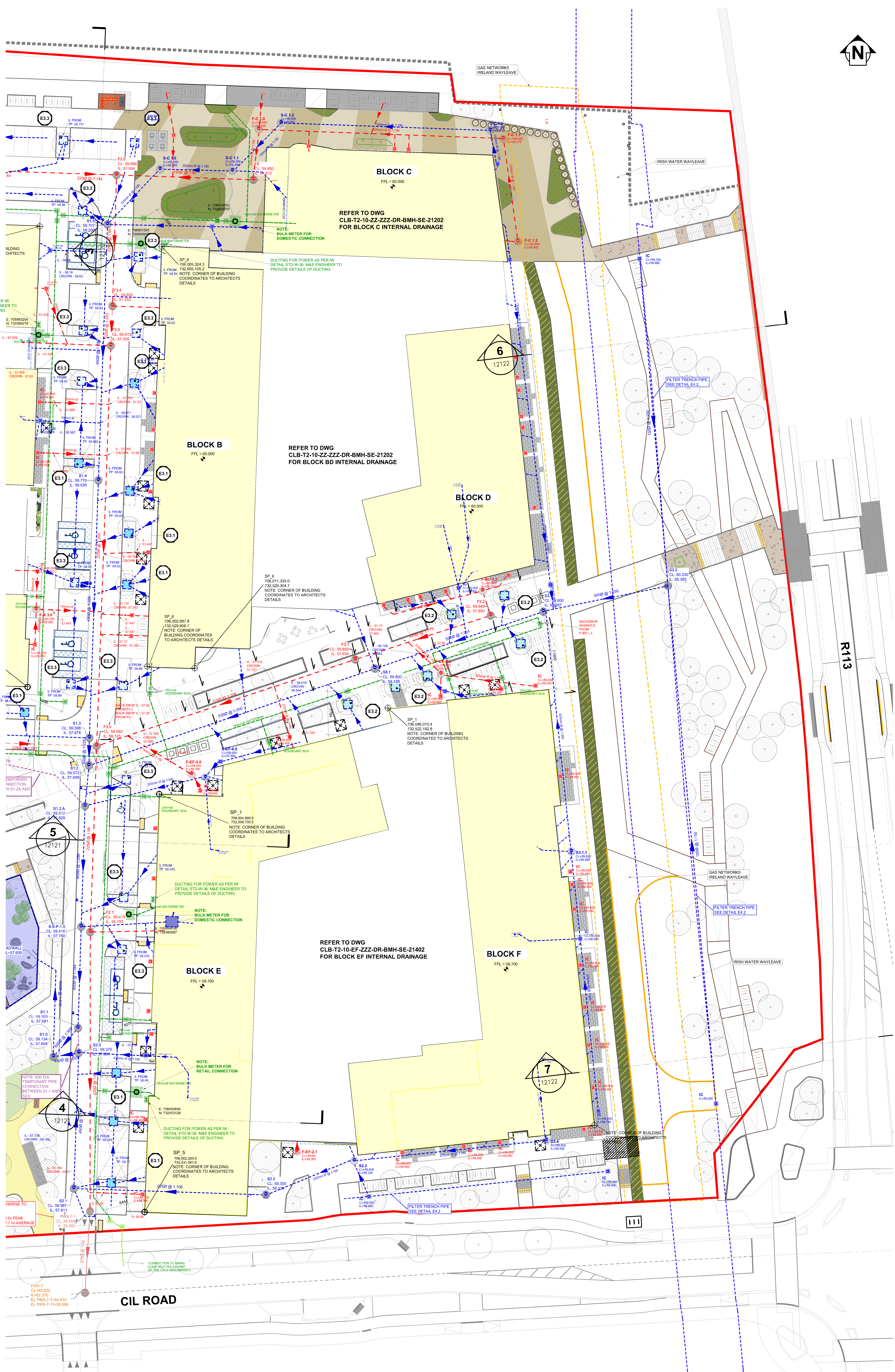
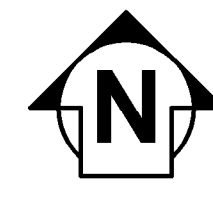

EXTERNAL DRAINAGE AND WATERMAIN LAYOUT - AREA 2

SCALE @ A0: 1:250
SCALE @ A2: 1:500

- NOTES:**
- ALL TREE PIT SURFACE WATER PIPES TO BE 110mm Ø PIPES LAID AT 1:150. REFER TO DRAWING 11300 FOR PLAN CALL OFF AND DRAWING 12322 FOR CROSS SECTION DETAILS.
 - ALL PERFORATED PIPES UNDER PERMEABLE CAR PARKING SPACES TO BE 150mm Ø REFER TO DRAWING 11300 FOR PLAN CALL OFFS AND DRAWING 12300 FOR CROSS SECTION DETAILS.
 - ALL SURFACE WATER ROAD GULLY PIPES TO BE 110mm Ø.
 - ALL ACO CHANNEL POP UPS TO BE 110mm Ø.
 - ALL FOUL PIPES FROM IC TO MAIN SEWER LINE TO BE 150mm Ø @ 1:150 UNLESS OTHERWISE STATED.
 - ALL FOUL CONNECTIONS TO MAIN SEWER IN ROAD TO BE SADDLE DETAIL. STD-W-04 FROM IW STANDARD DETAILS UNDER CROWN AND INVERT LEVELS CALLED UP ON PLAN. REFER TO DRAWING CLB-T2-10-ZZ-ZZZ-DR-BMH-CE-11201 FOR FURTHER IC TO MAIN SEWER ARRANGEMENT.
 - BACKDROP MANHOLE DETAIL AS PER IW DETAIL STD-WW-12.
 - ALL SURFACE WATER CONNECTIONS FROM MAIN SEWER LINE IN ROAD TO BE SADDLE OR JUNCTION CONNECTION.
 - BUILDING COORDINATES AS PER ARCHITECTS SETTING OUT. TAKE FROM DRAWINGS ISSUED 2024.03.21.
 - ALL WATERMAIN PIPES TO BE HDPE.
 - ALL FOUL DRAINAGE PIPES TO BE PVC.

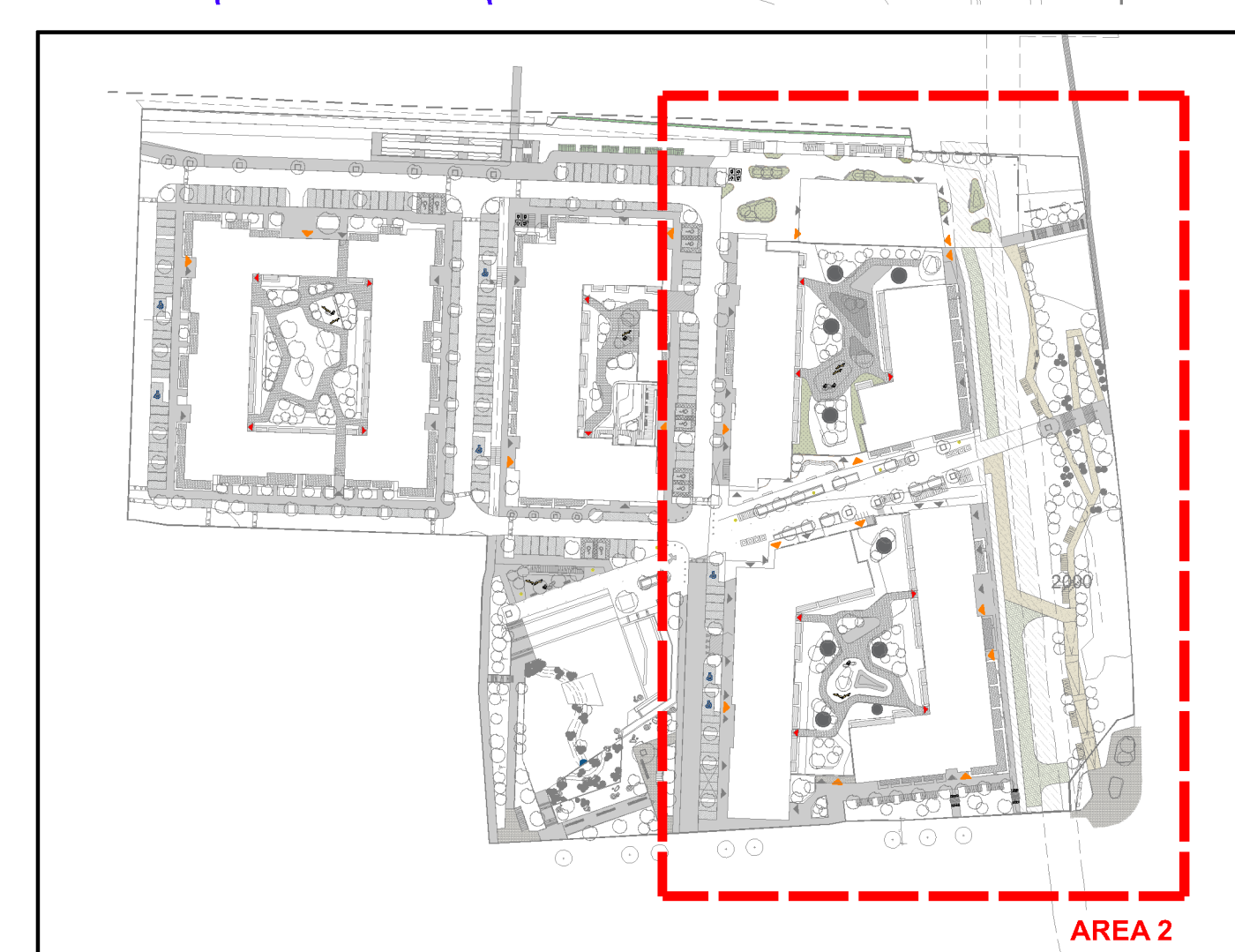

ISSUE	DATE	DESCRIPTION	BY
C8	07.08.24	ISSUED FOR COMPLIANCE	MR
C7	26.04.24	REVISED AS CLOUDED	EC
C6	21.03.24	CL REVISED	MR
C5	04.03.24	INVERTS ADDED	MR
C4	23.02.24	ISSUED FOR CONSTRUCTION	AO
C3	29.01.24	ISSUED FOR CONSTRUCTION	MR
C2	24.01.24	ISSUED FOR CONSTRUCTION	MR
C1	10.11.23	ISSUED FOR CONSTRUCTION	MR
T2	26.10.23	ISSUED FOR INFRASTRUCTURE & GROUNDWORKS STATUS A TENDER	MR
T1	15.09.23	ISSUED FOR INFRASTRUCTURE & GROUNDWORKS STATUS B TENDER	AO

Project Engineer: Kieran Cahill	Project Director: Stephen O'Connor
CONSTRUCTION	
80000000 50 Floor, Mill House, 8 Mill Street, London SE1 7BA, United Kingdom Tel: 02045 253753/3338	
CAIRN HOMES	
PROJECT TITLE	BM PROJECT NO.
SEVEN MILLS - T2	23173
REFERENCE	SUITABILITY
C7M-BMCE-T2-ZZ-M2-10000	REVISION
DRAWING TITLE	
EXTERNAL DRAINAGE AND WATERMAIN LAYOUT AREA 2	
DRAWING REFERENCE	STATUS
CLB-T2-94-SW-ZZZ-DR-BMH-CE-11201	REVISION
	C8