

**LEGEND:**

EXISTING SURFACE WATER DRAINAGE	
PROPOSED SURFACE WATER DRAINAGE	
PROPOSED RAIN WATER PIPE (CLEAN ROOF RUNOFF)	
PROPOSED ACO DRAIN (TO SW DRAINAGE)	
PROPOSED SURFACE WATER DRAINAGE (DISCHARGE PIPE)	
EXISTING FOUL SEWER	
PROPOSED FOUL SEWER	
EXISTING WATER MAIN	
NEW WATERMAIN	
TOPOGRAPHICAL SURVEY DATA	
DENOTES CONCRETE TO PROPOSED TRUCK YARD	
DENOTES CONCRETE TO PROPOSED FOOTPATH	
DENOTES PERMEABLE ROAD	
DENOTES GRASSCRETE SURFACE	
DENOTES GREEN ROOF	
DENOTES TYPICAL ROOF TO ARCH DESIGN	
DENOTES LANDSCAPING	

- PROPOSED SUDS DEVICES THROUGHOUT DEVELOPMENT:**
- TREE PITS (AT THE CAR PARKING AREA AS PER LANDSCAPING DRAWINGS)
  - PERMEABLE PAVING (TO THE ACCESS ROAD TO THE CAR PARKING AND CAR PARKING)
  - SUDSGRID PAVING (TO THE FIRE TENDER ACCESS)
  - ATTENUATION SYSTEMS: DETENTION BASIN AND 2 NO. UNDERGROUND 'STORMTECH' ATTENUATION TANKS.
  - FLOW CONTROL DEVICES (TO THE OUTLETS OF ALL ATTENUATION SYSTEMS)
  - SILT TRAP & PETROL INTERCEPTOR (TO THE INLETS OF ALL ATTENUATION SYSTEMS)

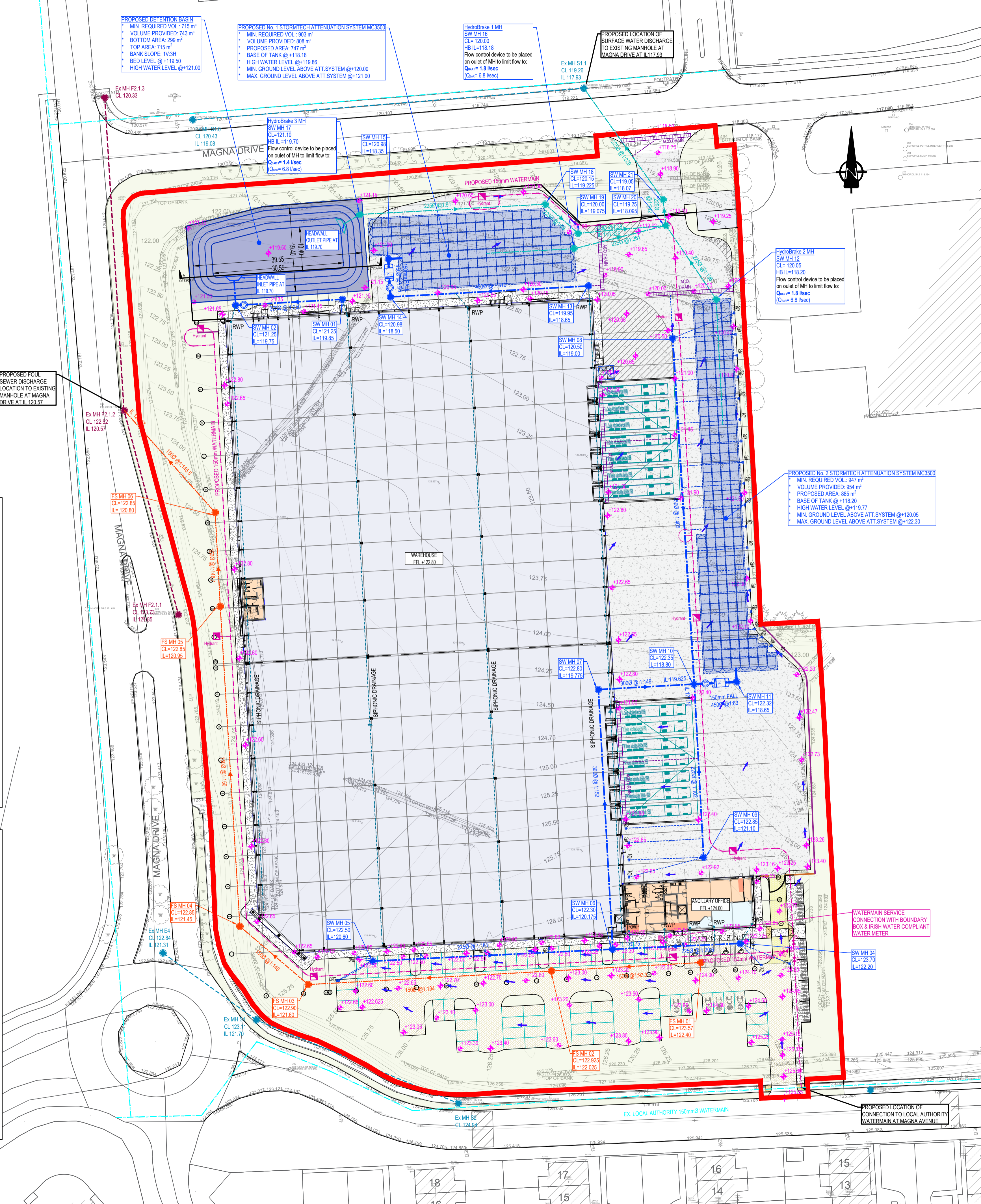
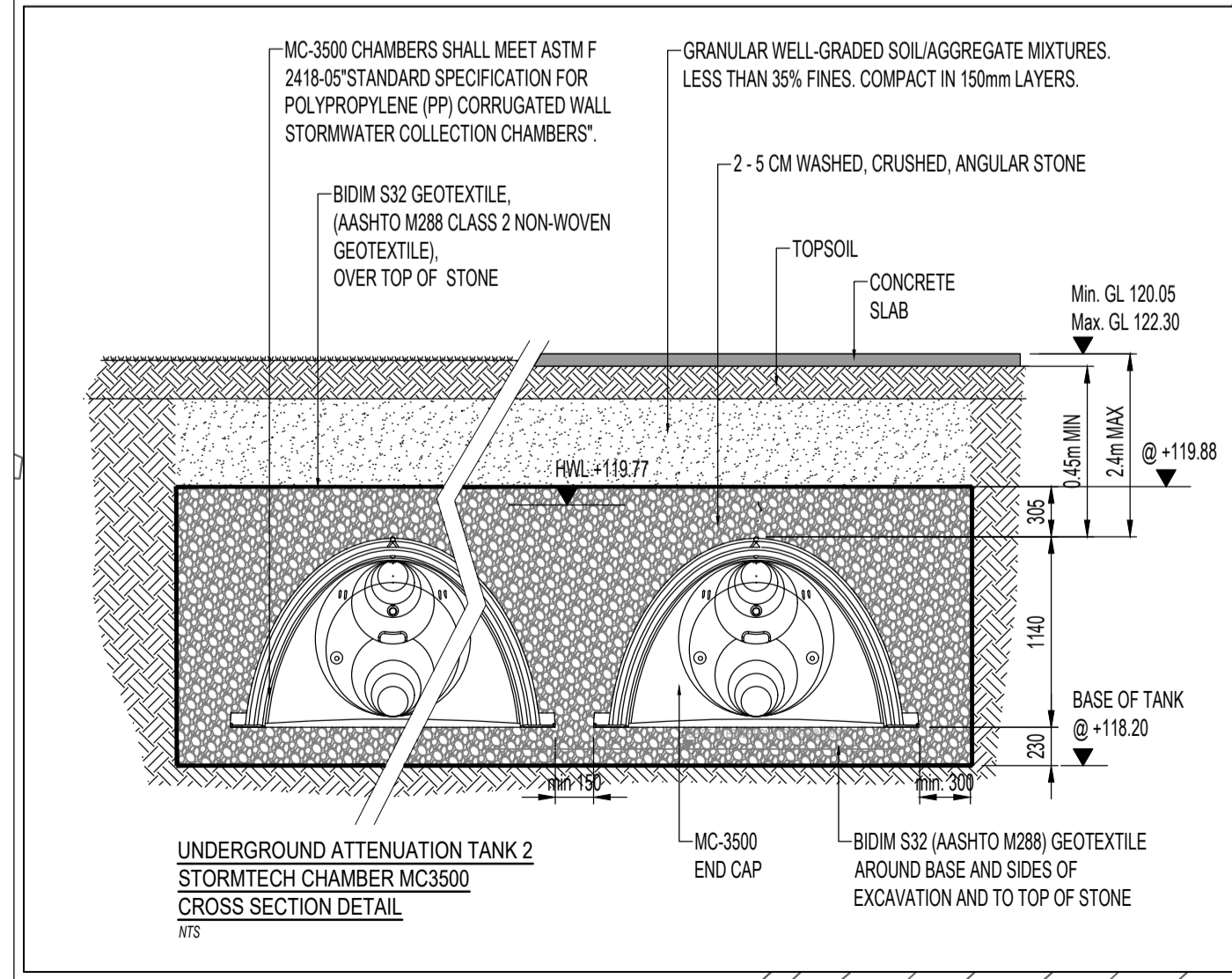
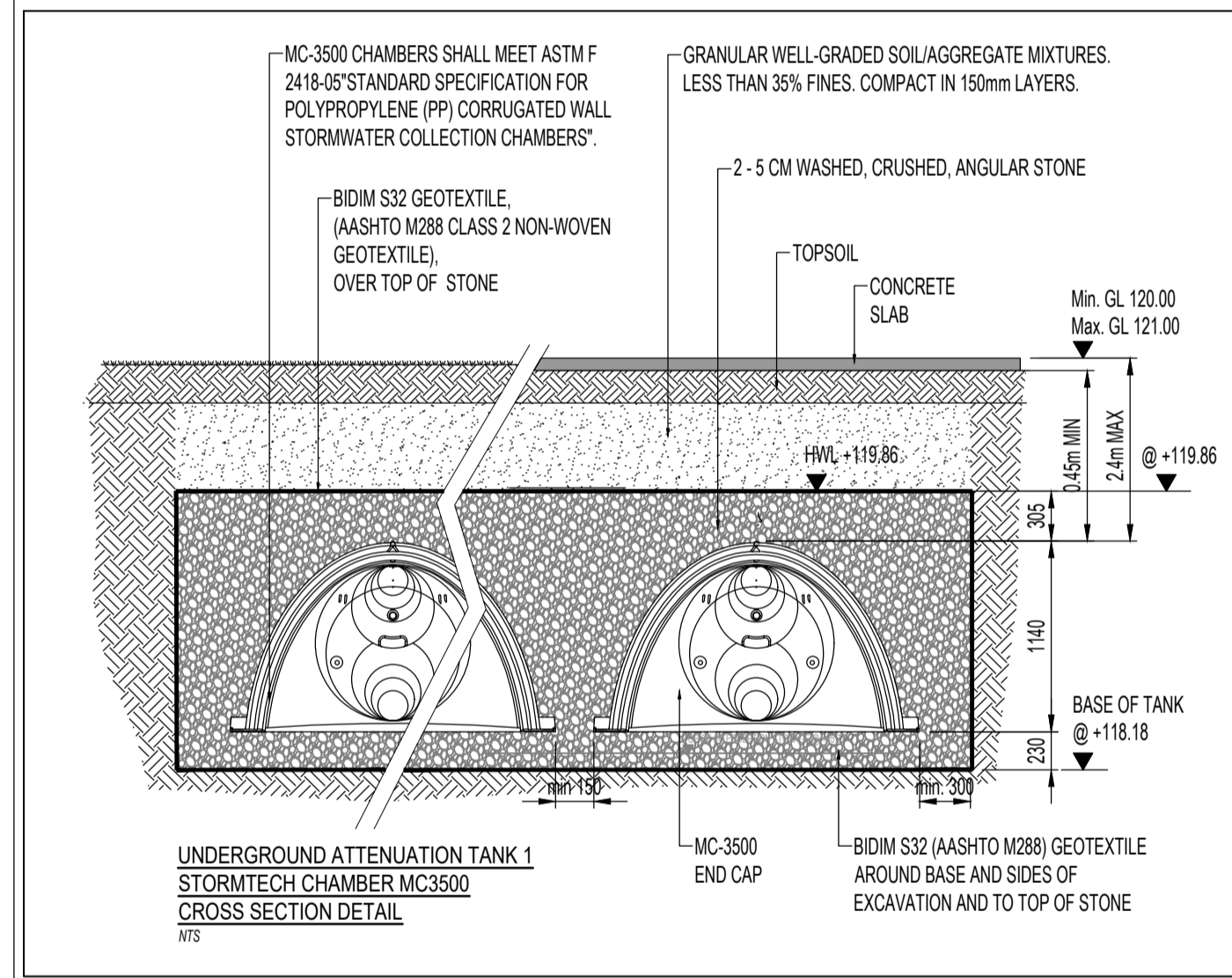

This drawing should not be scaled. Dimensions to be verified on site. Any discrepancies should be referred to the Engineer prior to work being put in hand.

**GENERAL NOTES**

C2	07.06.2024	REVISED AS CLOUDED	ES	SB
C1	05.04.2024	ISSUE FOR CONTRACT	TK	-
Status	Date	Description	By	Chk

Project  
**WAREHOUSE DEVELOPMENT AT, MAGNA DRIVE, CITYWEST**

Title  
**DRAINAGE AND WATERMAIN LAYOUT**

Client  
**ROCKFACE DEVELOPMENTS LTD.**



Unit F3, Block F, Calmount Park  
Calmount Avenue, Dublin 12, D12 PX28  
E-mail: reception@kavanaghburke.ie  
Tel: 01 450 0694

Issue  
**CONTRACT**

Designed By	PB	Checked By	PK	KB Ref.	D1720
Drawn By	GN	Date	APRIL 2024	Scales @ A1	1/500
Project	Originator	Volume	Level	Type	Number

D1720-KB-XX-XX-DR-C-0003 CL1