

- NOTES**
- DO NOT SCALE. USE FIGURED DIMENSIONS ONLY.
 - THIS DRAWING IS TO BE READ IN CONJUNCTION WITH ALL OTHER RELEVANT ARCHITECTURAL AND ENGINEERING DRAWINGS.
 - THIS IS NOT AN INSTALLATION DRAWING, THE SUB CONTRACTOR SHALL SUBMIT INSTALLATION DRAWINGS TO THE ENGINEER FOR APPROVAL.
 - ALL UTILITY DUCTING AND CHAMBERS INDICATED ARE INDICATIVE ONLY. THE CONTRACTOR SHALL LAISE WITH ESB ENGINEERS TO OBTAIN THE LATEST ESB DESIGN INFORMATION AND AGREE EQUIPMENT LOCATIONS BEFORE INSTALLATION COMMENCES.
 - REFER TO ESB NETWORKS FOR ALL CONSTRUCTION ISSUE INFORMATION.
 - REFER TO UTILITY PROVIDERS BELOW GROUND UTILITIES SPECIFICATION DOCUMENT FOR SPECIFICATIONS OF DUCTING, ACCESS CHAMBERS, MINI PILLARS, UNIT SUB-STATIONS AND BACKFILLING REQUIREMENTS.
 - THE CONTRACTOR SHALL ENSURE THAT THE FINAL LOCATION OF ESB OUTDOOR METER CABINETS HAVE BEEN AGREED WITH THE CLIENT/ARCHITECT AND THE SUPPLY AUTHORITY BEFORE INSTALLATION.
 - FUTURE DUCTING WILL BE PROVIDED FOR ON STREET VEHICLE CHARGING STATIONS THAT MAY BE INSTALLED AT A LATER DATE.

- LEGEND**
- ESB — PROPOSED ESB SERVICES DUCT FROM MINIPILLAR TO ESB METER
 - EC — EC — PROPOSED 125mmØ E-CAR CHARGER DUCT FROM VAULT TO EC CHARGER
 - 125mmØ E-CAR CHARGING DUCT
 - SM — SUPPLY AUTHORITY METER + REG FARRELL DOUBLE CABINET
 - FM — FUTURE SUPPLY AUTHORITY METER + REG FARRELL DOUBLE CABINET
 - MP — PROPOSED ESB NETWORKS MINI PILLAR WITH VAULT
 - ME — EXTERNAL METER ENCLOSURE
 - EC — ACTIVE E-CAR CHARGING SPACES (AS IDENTIFIED IN PLANNING COMPLIANCE SUBMISSION)
 - EV — FREE STANDING CHARGING UNIT
 - WU — WALL MOUNTED CHARGING UNIT
 - SU — SUSPENDED CHARGING UNIT
 - EC — FUTURE E-CAR CHARGING SPACES (AS IDENTIFIED IN PLANNING COMPLIANCE SUBMISSION)
 - EV — FUTURE FREE STANDING CHARGING UNIT
 - WU — FUTURE WALL MOUNTED CHARGING UNIT
 - SU — FUTURE SUSPENDED CHARGING UNIT
 - AC — 600mm x 600mm ACCESS CHAMBER
 - EC — INCURTIAGE PARKING WITH WIRING PROVISION FOR E-CAR CHARGING

FOR GUIDANCE ONLY FINAL DESIGN CONFIRMATION BY UTILITY PROVIDER

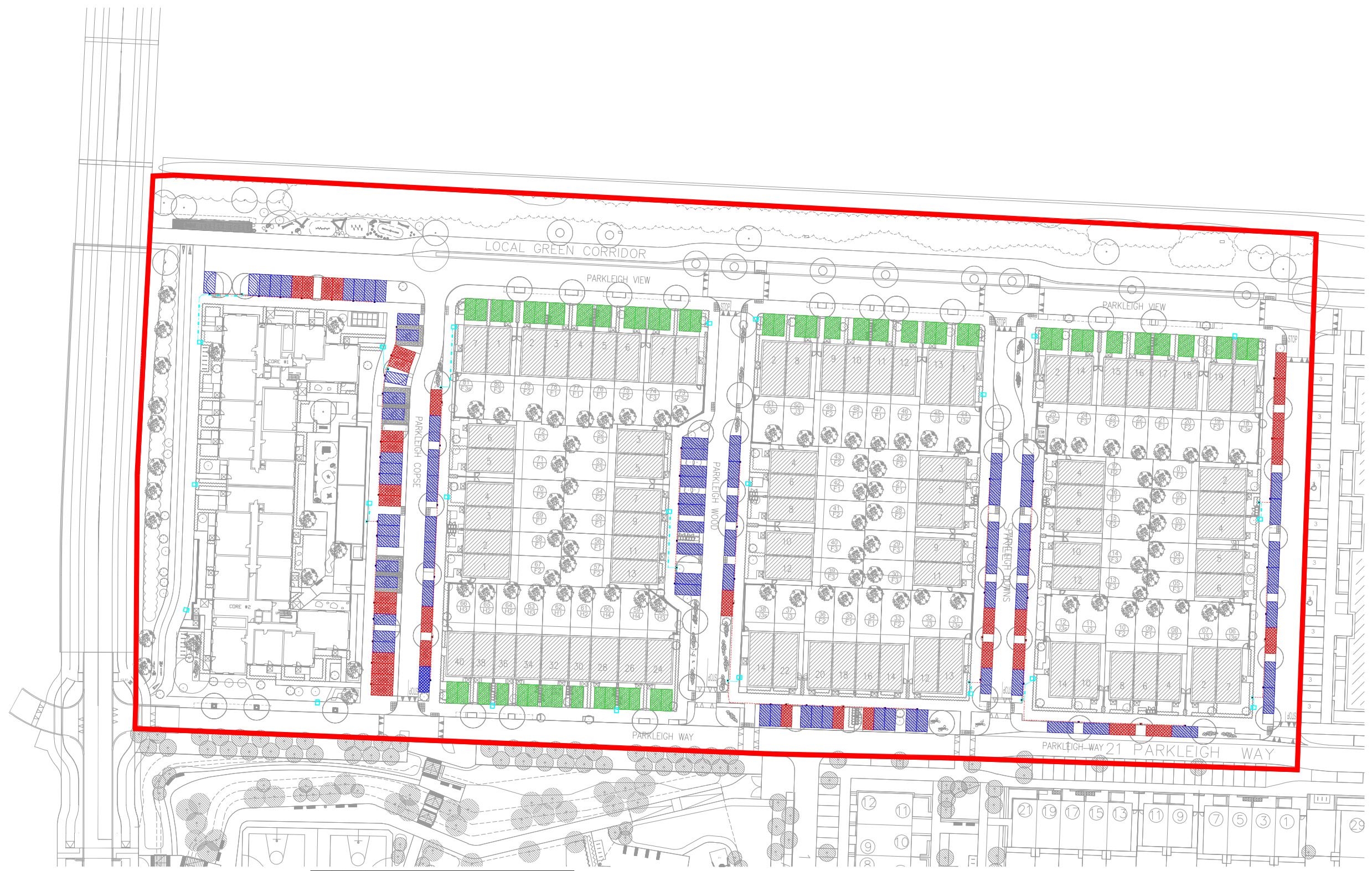

T3	29/04/24	CAIRN COMMENTS ADDED	NB	KF
T2	15/12/23	CAIRN & DESIGN TEAM COMMENTS ADDED	NB	KF
T1	20/07/23	CAIRN & DESIGN TEAM COMMENTS ADDED	NB	KF
T	06/04/23	TENDER ISSUE	AH	KF
REV.	DATE	AMENDMENT	DRN	APPD

STATUS **TENDER**

Waterman Moylan
Engineering Consultants

BLOCK 8, EASTPOINT BUSINESS PARK, ALFIE BYRNE ROAD, DUBLIN D03 H3F4 IRELAND.
Tel: (01) 664 8900 Fax: (01) 661 3618
Email: info@waterman-moylan.ie www.waterman-moylan.ie

CLIENT CAIRN HOMES PLC
ARCHITECT MCORM ARCHITECTS
PROJECT CLONBURRIS, TILE 3

TITLE ELECTRICAL ENGINEERING SERVICES
SITE UTILITIES
PROPOSED E-CAR CHARGING LAYOUT
CLB-T3-60-UT-ZZZ-DR-WM-EE-E1003

DRAWN AH	DESIGNED KF	APPROVED NC	DATE OCT 2022
SCALE 1:500 @ A1	JOB NO. 23-010	DRG. NO. T3-E1003	REVISION T3

