

Henry J Lyons

Adamstown Station District Centre, Co Dublin
Masterplan - Phase 3 - Block A, C & D

Facade Finishes Condition 26- SDZ22A/0005
APRIL 2024



*For illustration purposes only

ADAMSTOWN BLOCKS A, C & D

Revision	Description	Date	Checked
01	DRAFT - ISSUED FOR INFORMATION	05.10.23	DW/RJ
02	DRAFT - ALTERNATIVE BRICK OPTIONS	01/11/23	RJ
03	DRAFT - FOR SIGN-OFF	04/12/23	RJ
04	REVISED BRICK BLOCK C	08/04/24	RJ

CONTENTS

01 Material Palette

02 Facade Finishes

03 External Wall Types Elevation Drawings

01 MATERIAL PALETTE

BLOCK A
BRICKS



BRK-001
VANDERSANDEN
Littoral Ivory



BRK-002
VANDERSANDEN
AVONDROOD



BRK-005
GLAZED BRICK TO ENTRANCES
TO SELECTED SAMPLE

WINDOWS & DOORS
(uPVC)



RAL 7039
UMBRA GREY (SUBJECT TO PVC COATING AVAILABILITY)

ACRYLIC RENDER



EIF-005(A)
Y07 92 09
Verona White or similar to sample

CAPPING
(POWDERCOATED ALUMINIUM)

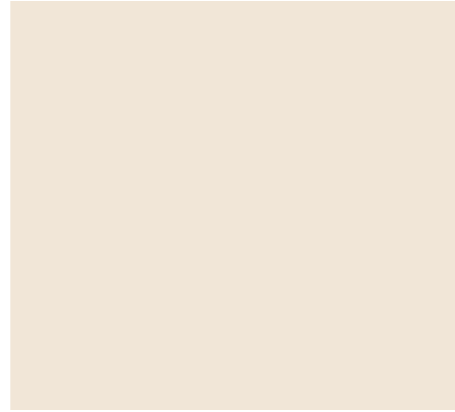

RAL TBC (TO MATCH WALL COLOUR)
(TO MATCH WALL COLOUR)

BALCONIES + RAILINGS



RAL 7039
QUARTZ GREY



CLEAR GLASS
BALCONY GLAZING WHERE REQUIRED

CLADDING
(PERFORATED ALUMINIUM PLATE)

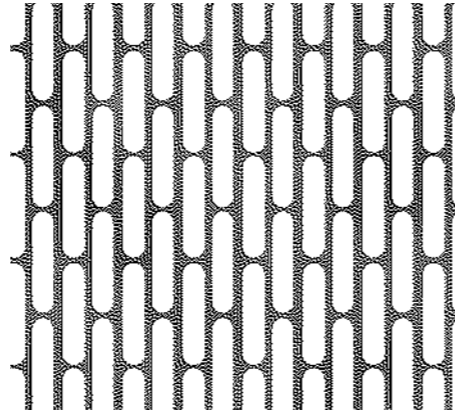

RAL 7022
(UMBRA GREY)



BLOCK A - FROM POCKET PARK

BLOCK C
BRICKS



BRK-003
AG
WOODWARD OLDE DUBLIN - IVORY JOINT



BRK-005
GLAZED BRICK TO ENTRANCES
TO SELECTED SAMPLE

WINDOWS & DOORS
(UPVC)



RAL 7022
(UMBRA GREY)

ACRYLIC RENDER



EIF-005(C)
Y06 95 04
Chalk White or similar approved to sample

BALCONIES + RAILINGS



RAL 7022
(UMBRA GREY)

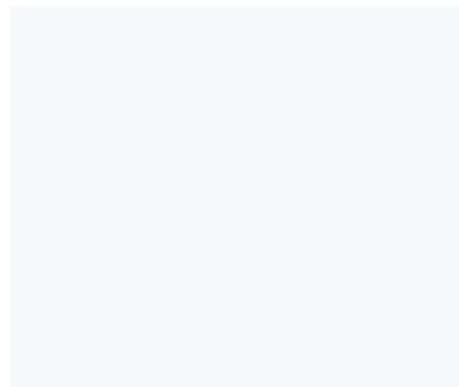

CLEAR GLASS
BALCONY GLAZING

CAPPING
(POWDERCOATED ALUMINIUM)

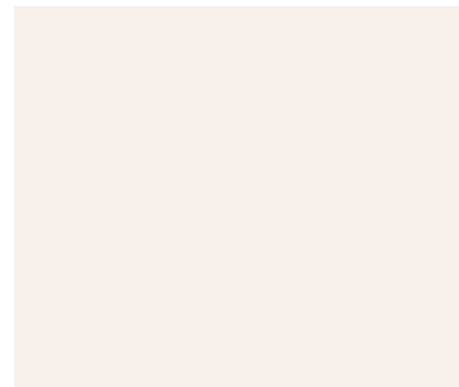

RAL TBC
(TO MATCH WALL COLOUR)

CLADDING
(PERFORATED ALUMINIUM PLATE)

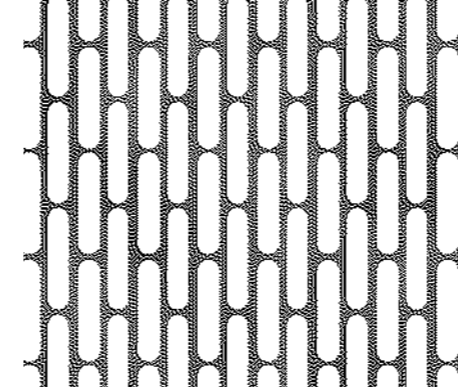

RAL 7022
(UMBRA GREY)



BLOCK C - FROM STATION ROAD



BLOCK C - FROM POCKET PARK

BLOCK D

BRICKS



BRK-004
FORTERRA
WESTCROFT RED MULTI BROWN RED



BRK-003 (RECESS)
VANDERSANDEN
ARGENTIS

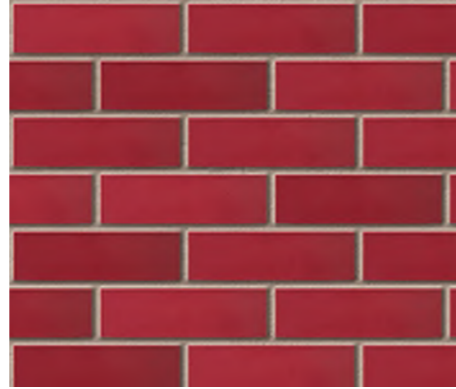

BRK-005
GLAZED BRICK TO ENTRANCES
BURGUNDY RED / BLOCK D3-D4



BRK-005
GLAZED BRICK TO ENTRANCES
BLACK / BLOCK D1-D2



BLOCK D - STATION ROAD

WINDOWS & DOORS (uPVC)



RAL 7039 (UPPER FLOORS)
QUARTZ GREY



RAL 8012 (GROUND FLOOR)
(RED BROWN)

ACRYLIC RENDER

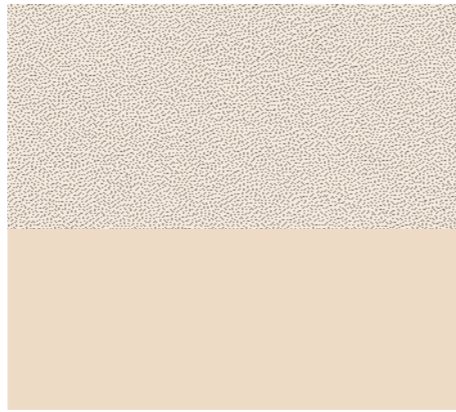

EIF-005D
Y09 88 13
Champagne Chalk or similar approved (to sample)

BALCONIES + RAILINGS

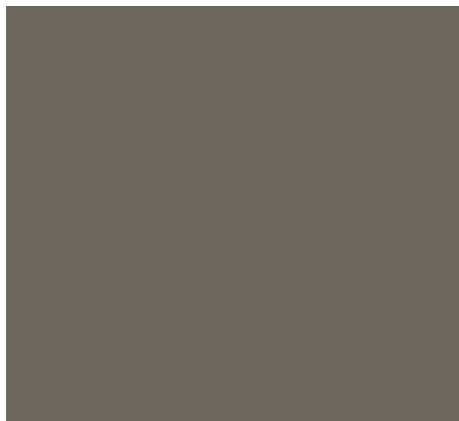

RAL 7039 (BALCONIES ON RENDER)
QUARTZ GREY

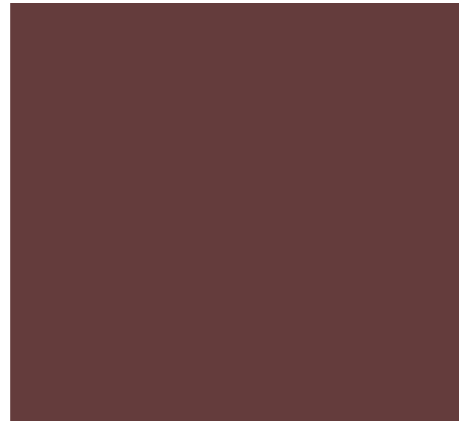

RAL 8012 (BALCONIES ON BRICK)
(RED BROWN)

CAPPING (POWDERCOATED ALUMINIUM)

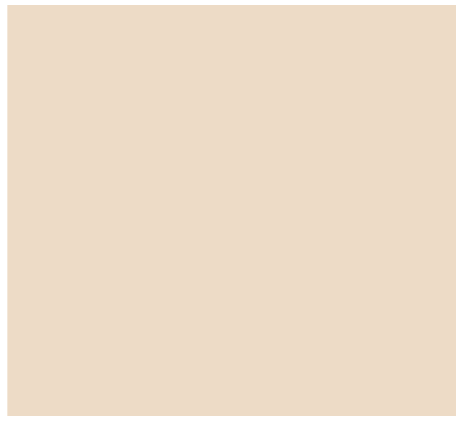

RAL TBC (TO MATCH WALL COLOUR)



BLOCK D

PAVILLION

PAVILLION

RENDER



REN-001
ACRYLIC RENDER
Y06 94 07_Bianco S. Giovanni or similar approved

RAILINGS & DOORS
(Powdercoated aluminium)

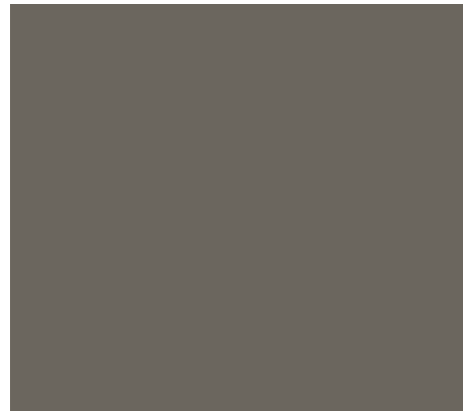

RAL 7039
(QUARTZ GREY)

ALUMINIUM CAPPING
(Powdercoated aluminium)

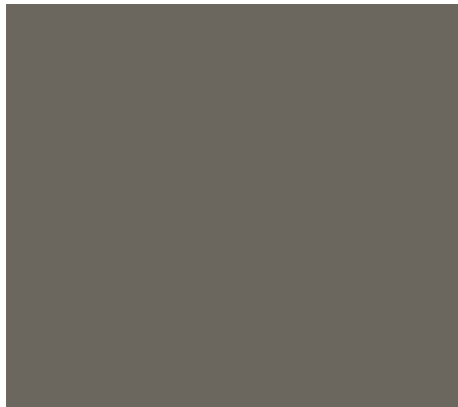

RAL 7039
(QUARTZ GREY)

Henry J Lyons



PAVILLION

02 FACADE FINISHES

VIEW FROM STATION ROAD LOOKING NORTH ALONG GREAT WESTERN WALK

BLOCK C2

BRICK: BRK-003 (BRK-005 - ENTRANCES)
 RENDER: EIF-005(C) (SHADOW GAP AS PER DRAWINGS)
 uPVC WINDOWS & DOORS: RAL 7022
 ALUMINIUM ELEMENTS (BALCONY, RWDP): RAL 7022
 PARAPET CAPPING: RAL TBC (TO MATCH WALL)

BLOCK C1

BRICK: BRK-003 (BRK-005 - ENTRANCES)
 RENDER: EIF-005(C)
 ALUMINIUM CLADDING: RAL 7022
 uPVC WINDOWS & DOORS: RAL 7022
 ALUMINIUM ELEMENTS (BALCONY, RWDP): RAL 7022
 PARAPET CAPPING: RAL TBC (TO MATCH WALL COLOUR)

BLOCK D1

BRICK: BRK-004 (BRK-005 - ENTRANCES)
 RENDER: EIF-005D
 uPVC WINDOWS & DOORS: RAL 7039 / RAL 8012
 ALUMINIUM ELEMENTS (BALCONY, RWDP): RAL 7039 / 8012
 PARAPET CAPPING: RAL TBC (TO MATCH WALL COLOUR)

BLOCK D4

BRICK: BRK-004 (BRK-003 - RECESS, BRK-005 - ENTRANCES)
 RENDER: EIF-005D (EIF-005(C) - RECESS)
 uPVC WINDOWS & DOORS: RAL 7039
 ALUMINIUM ELEMENTS (BALCONY, RWDP): RAL 8012 / 7039
 PARAPET CAPPING: RAL TBC (TO MATCH WALL COLOUR)



VIEW OF BLOCK D FROM BROADGAUGE ROW LOOKING WEST

BLOCK D3

BRICK: BRK-004 (BRK-003 - RECESS, BRK-005 - ENTRANCES)
RENDER: EIF-005D (EIF-005(C) - RECESS)
uPVC WINDOWS & DOORS: RAL 7039
ALUMINIUM ELEMENTS (BALCONY, RWDP): RAL 7039 / RAL 8012
PARAPET CAPPING: RAL TBC (TO MATCH WALL COLOUR)

BLOCK D2

BRICK: BRK-004 (BRK-005 - ENTRANCES)
RENDER: EIF-005D
uPVC WINDOWS & DOORS: RAL 7039
ALUMINIUM ELEMENTS (BALCONY, RWDP): RAL 7039
PARAPET CAPPING: RAL TBC (TO MATCH WALL COLOUR)



VIEW FROM GREAT WESTERN WALK LOOKING SOUTH WITH PAVILLION

BLOCK D1

BRICK: BRK-004 (BRK-005 - ENTRANCES)
RENDER: EIF-005D
uPVC WINDOWS & DOORS: RAL 7039, RAL 8012
ALUMINIUM ELEMENTS (BALCONY, RWDP): RAL 7039
PARAPET CAPPING: RAL TBC (TO MATCH WALL COLOUR)

PAVILLION

RENDER: REN-001
ALUMINIUM ELEMENTS (RAILINGS, RWDP): RAL 7039
ALUMINIUM ELEMENTS (DOORS): RAL 7039
PARAPET CAPPING: RAL TBC (TO MATCH WALL COLOUR)

BLOCK D4

BRICK: BRK-004 (BRK-003 - RECESS, BRK-005 - ENTRANCES)
RENDER: EIF-005D (EIF-005(C) - RECESS)
uPVC WINDOWS & DOORS: RAL 7039
ALUMINIUM ELEMENTS (BALCONY, RWDP): RAL 8012 on brick / 7039 on render
PARAPET CAPPING: RAL TBC (TO MATCH WALL COLOUR)



VIEW FROM GREAT WESTERN LANE LOOKING NORTH

BLOCK A4

BRICK: BRK-002 (BRK-005 - ENTRANCES)
RENDER: EIF-005(A)
uPVC WINDOWS & DOORS: RAL 7039
ALUMINIUM ELEMENTS (BALCONY, RWDP): RAL 7039
PARAPET CAPPING: RAL TBC (TO MATCH WALL COLOUR)

BLOCK A2

BRICK: BRK-002 (BRK-005 - ENTRANCES)
RENDER: EIF-005(A)
uPVC WINDOWS & DOORS: RAL 7039
ALUMINIUM ELEMENTS (BALCONY, RWDP): RAL 7039
PARAPET CAPPING: RAL TBC (TO MATCH WALL COLOUR)

BLOCK A3

BRICK: BRK-002 (BRK-001 - UPPER LEVELS - BRK-005 - ENTRANCES)
RENDER: EIF-005(A)
uPVC WINDOWS & DOORS: RAL 7039
ALUMINIUM ELEMENTS (BALCONY, RWDP): RAL 7039
PARAPET CAPPING: RAL TBC (TO MATCH WALL COLOUR)



ALUMINIUM ELEMENTS (GRATING): RAL 7022

VIEW FROM THE POCKET PARK AT BLOCK A LOOKING WEST

BLOCK D1

BRICK: BRK-004 (BRK-005 - ENTRANCES)
 RENDER: EIF-005D
 uPVC WINDOWS & DOORS: RAL 7039/8012
 ALUMINIUM ELEMENTS (BALCONY, RWDP): RAL 7039
 PARAPET CAPPING: RAL TBC (TO MATCH WALL COLOUR)

BLOCK C1

BRICK: BRK-003 (BRK-005 - ENTRANCES)
 RENDER: EIF-005(C)
 ALUMINIUM CLADDING: RAL 7022
 uPVC WINDOWS & DOORS: RAL 7022
 ALUMINIUM ELEMENTS (BALCONY, RWDP): RAL 7022
 PARAPET CAPPING: RAL TBC (TO MATCH WALL COLOUR)

BLOCK A4

BRICK: BRK-002 (BRK-005 - ENTRANCES)
 RENDER: EIF-005(A)
 uPVC WINDOWS & DOORS: RAL 7039
 ALUMINIUM ELEMENTS (BALCONY, RWDP): RAL 7039
 PARAPET CAPPING: RAL TBC (TO MATCH WALL COLOUR)

BLOCK A3

BRICK: BRK-002 (BRK-001 - UPPER LEVELS - BRK-005 - ENTRANCES)
 RENDER: EIF-005(A)
 uPVC WINDOWS & DOORS: RAL 7039
 ALUMINIUM ELEMENTS (BALCONY, RWDP): RAL 7039
 PARAPET CAPPING: RAL TBC (TO MATCH WALL COLOUR)



03 EXTERNAL WALL TYPE ELEVATION
DRAWINGS

ACD3-HJL-A-ZZ-DR-A-5023_
EXTERNAL WALL TYPE ELEVATIONS BLOCK A 01



1 BLOCK A - EXTERNAL WALL TYPES - NORTH
1:200



2 BLOCK A - EXTERNAL WALL TYPES - SOUTH
1:200



3 BLOCK A - EXTERNAL WALL TYPES - EAST
1:200



EXTERNAL WALL FINISHES KEY	
	BRK-001 VANDERSANDEN LITTORAL IVORY
	BRK-002 VANDERSANDEN AVONDROOD
	BRK-002 VANDERSANDEN AVONDROOD ht & miss pattern
	BRK-003 AG WOODWARD OLDE DUBLIN white mortar
	BRK-004 FORTERRA WESTCROFT MULTI RED
	BRK-005 SELECTED GLAZED BRICK
	EIF-005A ACRYLIC RENDER A
	EIF-005A+ ACRYLIC RENDER A (ARMOURED)
	EIF-005C ACRYLIC RENDER C
	EIF-005C+ ACRYLIC RENDER C (ARMOURED)
	EIF-005A ACRYLIC RENDER D
	EIF-005A+ ACRYLIC RENDER D (ARMOURED)
	REN-001 ACRYLIC RENDER P

ACD3-HJL-A-ZZ-DR-A-5024_
EXTERNAL WALL TYPE ELEVATIONS BLOCK A 02



1 BLOCK A - EXTERNAL WALL TYPES - NORTH COURTYARD
1 : 200



3 BLOCK A - EXTERNAL WALL TYPES - EAST COURTYARD
1 : 200



2 BLOCK A - EXTERNAL WALL TYPES - SOUTH COURTYARD
1 : 200



4 BLOCK A - EXTERNAL WALL TYPES - WEST COURTYARD
1 : 200

EXTERNAL WALL FINISHES KEY	
	BRK-001 VANDERSANDEN LITTORAL IVORY
	BRK-002 VANDERSANDEN AVONDROOD
	BRK-002 VANDERSANDEN AVONDROOD hit & miss pattern
	BRK-003 AG WOODWARD OLDE DUBLIN white mortar
	BRK-004 FORTERRA WESTCROFT MULTI RED
	BRK-005 SELECTED GLAZED BRICK
	EIF-005A ACRYLIC RENDER A
	EIF-005A+ ACRYLIC RENDER A (ARMOURED)
	EIF-005C ACRYLIC RENDER C
	EIF-005C+ ACRYLIC RENDER C (ARMOURED)
	EIF-005A ACRYLIC RENDER D
	EIF-005A+ ACRYLIC RENDER D (ARMOURED)
	REN-001 ACRYLIC RENDER P

ACD3-HJL-C-ZZ-DR-A-5025_

EXTERNAL WALL TYPE ELEVATIONS BLOCK C 01



1 BLOCK C - EXTERNAL WALL TYPES - NORTH
1:200



2 BLOCK C - EXTERNAL WALL TYPES - SOUTH
1:200



4 BLOCK C - EXTERNAL WALL TYPES - WEST
1:200



3 BLOCK C - EXTERNAL WALL TYPES - EAST
1:200



5 BLOCK C - EXTERNAL WALL TYPES - NORTH COURTYARD
1:200



6 BLOCK C - EXTERNAL WALL TYPES - NORTH
1:200

EXTERNAL WALL FINISHES KEY	
	BRK-001 VANDERSANDEN LITTORAL IVORY
	BRK-002 VANDERSANDEN AVONDROOD
	BRK-002 VANDERSANDEN AVONDROOD hit & miss pattern
	BRK-003 AG WOODWARD OLDE DUBLIN white mortar
	BRK-004 FORTERRA WESTCROFT MULTI RED
	BRK-005 SELECTED GLAZED BRICK
	EIF-005A ACRYLIC RENDER A
	EIF-005A+ ACRYLIC RENDER A (ARMOURED)
	EIF-005C ACRYLIC RENDER C
	EIF-005C+ ACRYLIC RENDER C (ARMOURED)
	EIF-005A ACRYLIC RENDER D
	EIF-005A+ ACRYLIC RENDER D (ARMOURED)
	REN-001 ACRYLIC RENDER P

ACD3-HJL-D-ZZ-DR-A-5026_ EXTERNAL WALL TYPE ELEVATIONS BLOCK D 01



1 BLOCK D - EXTERNAL WALL TYPES - NORTH
1 : 200



3 BLOCK D - EXTERNAL WALL TYPES - EAST
1 : 200



2 BLOCK D - EXTERNAL WALL TYPES - SOUTH
1 : 200

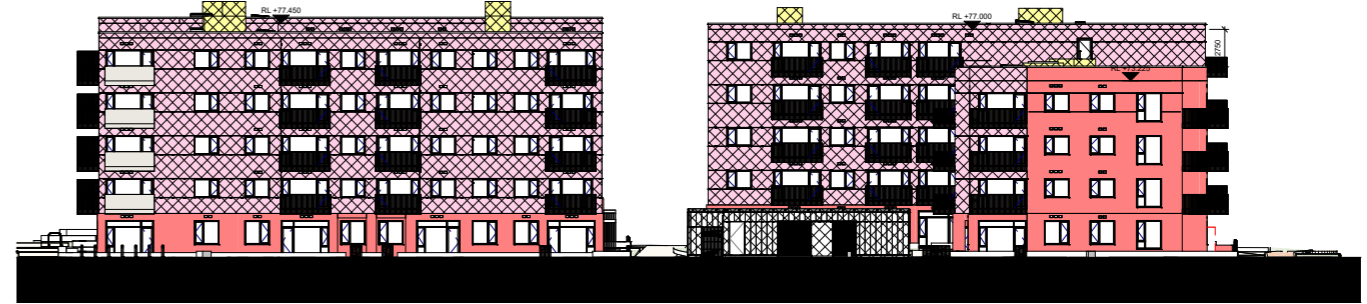

4 BLOCK D - EXTERNAL WALL TYPES - WEST
1 : 200

EXTERNAL WALL FINISHES KEY	
	BRK-001 VANDERSANDEN LITTORAL IVORY
	BRK-002 VANDERSANDEN AVONDROOD
	BRK-002 VANDERSANDEN AVONDROOD ht & miss pattern
	BRK-003 AG WOODWARD OLDE DUBLIN white mortar
	BRK-004 FORTERRA WESTCROFT MULTI RED
	BRK-005 SELECTED GLAZED BRICK
	EIF-005A ACRYLIC RENDER A
	EIF-005A+ ACRYLIC RENDER A (ARMOURED)
	EIF-005C ACRYLIC RENDER C
	EIF-005C+ ACRYLIC RENDER C (ARMOURED)
	EIF-005A ACRYLIC RENDER D
	EIF-005A+ ACRYLIC RENDER D (ARMOURED)
	REN-001 ACRYLIC RENDER P

ACD3-HJL-D-ZZ-DR-A-5027_ EXTERNAL WALL TYPE ELEVATIONS BLOCK D 02



1 BLOCK D - EXTERNAL WALL TYPES - NORTH COURTYARD
1 : 200



3 BLOCK D - EXTERNAL WALL TYPES - EAST COURTYARD
1 : 200



2 BLOCK D - EXTERNAL WALL TYPES - SOUTH COURTYARD
1 : 200



4 BLOCK D - EXTERNAL WALL TYPES - WEST COURTYARD
1 : 200

EXTERNAL WALL FINISHES KEY	
	BRK-001 VANDERSANDEN LITTORAL IVORY
	BRK-002 VANDERSANDEN AVONDROOD
	BRK-002 VANDERSANDEN AVONDROOD ht & miss pattern
	BRK-003 AG WOODWARD OLDE DUBLIN white mortar
	BRK-004 FORTERRA WESTCROFT MULTI RED
	BRK-005 SELECTED GLAZED BRICK
	EIF-005A ACRYLIC RENDER A
	EIF-005A+ ACRYLIC RENDER A (ARMOURED)
	EIF-005C ACRYLIC RENDER C
	EIF-005C+ ACRYLIC RENDER C (ARMOURED)
	EIF-005A ACRYLIC RENDER D
	EIF-005A+ ACRYLIC RENDER D (ARMOURED)
	REN-001 ACRYLIC RENDER P

