

CAVITY BARRIER LOCATIONS IN EXTERNAL AND SEPERATING / COMPARTMENT WALLS FOR A TWO STORY DWELLING

- VERTICALLY:**
 1. AT ALL EXTERNAL CORNERS
 ALSO: VERTICALLY WITH EXTERNAL WALL CAVITY AT NOT GREATER THAN 10M INTERVALS
 2. ON EITHER SIDE OF THE JUNCTION OF PARTY WALLS AND EXTERNAL WALLS

- HORIZONTALLY:**
 3. AT EAVES LEVEL
 OTHER:
 4. AROUND ALL OPENINGS (WINDOWS, DOORS, EXTRACT FANS, WALL VENTS, SERVICES ETC.)
 5. AT VERGES

- FIRESTOP:**
 6. VERTICAL FIRESTOP BETWEEN THE TWO PARTY WALLS FRAMES
 7. FIRESTOP AT JUNCTION OF PARTY WALL AND ROOF
 8. HORIZONTAL FIRESTOP AT EACH INTERMEDIATE FLOOR LEVEL IN PARTY WALLS

- OPES:**
 9. PROPRIETARY CAVITY CLOSER WITH THERMAL RESISTANCE 1.0 m² KW OR BETTER TO ALL OPES TO WINDOW SYSTEM SUPPLIERS CERTIFIED DATA

CONNECTION JOINTS AS PER ENGINEERS DESIGN, EXACT SETTING OUT TO BE AGREED WITH ARCHITECT PRIOR TO CONSTRUCTION

Note:

CONTRACTOR IS TO INCLUDE THROUGHOUT THE BATHROOMS, ENSUITES AND KITCHENS FOR ALL NECESSARY SOFTWOOD FRAMING / CARCASSING / NOGGING / FIXINGS ETC. AND AN 18 MM PLYWOOD LINING ALL ROUND, TO ALL AREAS, TO FORM THE VANITY UNITS, SHELVES, ENCLOSURES, SUPPORTS FOR SHOWER TRAYS AND ANY OTHER ELEMENTS SHOWN ON THE DOS DRAWINGS FOR THESE AREAS.

CONTRACTOR TO INCLUDE FOR PLYWOOD SUPPORTS / NOGGING ETC. TO ALL WALLS, WHERE REQUIRED, TO SUPPORT SHOWER RAILS/ RADIATORS / SINKS / WC / HOLDERS ETC. SHOWN ON THE DSO DRAWINGS FOR THESE AREAS.

SHOWER MAT DE-BONDING LAYER FOR TIMBER FRAME (REF NBS M40/27A)

FOR DETAILS OF ALL BATHROOMS AND KITCHENS, REFER TO DSO DESIGN LAYOUTS, DETAILS AND SPECIFICATIONS

FOR DETAILS OF ALL STAIRS AND BALUSTRADES, REFER TO DSO DESIGN LAYOUTS, DETAILS AND SPECIFICATIONS

SKIRTING BOARDS TO BE PROVIDED THROUGHOUT THE PROJECT, UNLESS IDENTIFIED ALTERNATIVELY. FOR DETAILS REFER TO OI ADVANCED OUTLINE SPECIFICATION

SERVICES PENETRATIONS AND ROUTES ARE NOT TO COMPROMISE THE FIRE OR ACOUSTIC RATING OF WALLS OR FLOORS

ALL OF THE DETAILS ARE BASED ON THE CONSTRUCTION GUIDE PROVIDED BY KINGSPAN. THE DETAILS TO BE REVIEWED ONCE THE TIMBER FRAME SPECIALIST IS APPOINTED.

ALL SUPPORTING STEEL WITHIN TIMBER FRAME TO BE PROVIDED BY THE TIMBER FRAME SPECIALIST.

REQUIREMENT FOR WALL TIES TO BE REVIEWED BY STRUCTURAL ENGINEER AND TIMBER FRAME SPECIALIST.

1 GROUND FLOOR PLAN
 Scale: 1 : 50

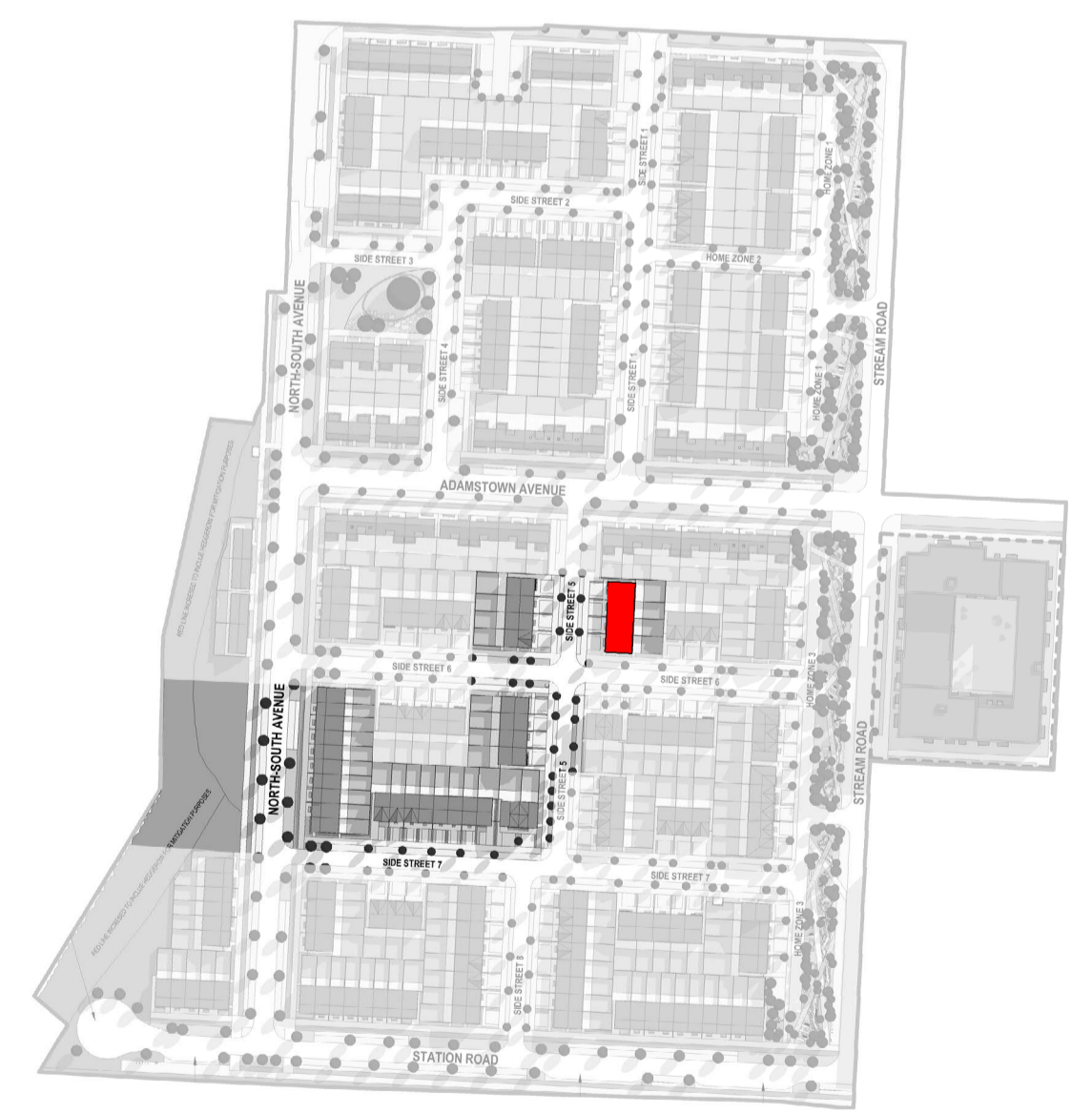

TENDER

REV	DATE	DESCRIPTION	BY
T	18/04/2023	Issued for Tender	SA

NOTE:
 *PLEASE REFER TO SITE PLAN FOR GROUND FLOOR LEVELS AND NORTH POINT LOCATION
 *LEVELS ON THIS SHEET TAKEN FROM TEMPORARY BENCHMARK AT 0.0

Spot Levels

DIMENSIONS IN BLACK RELATE TO WALL FINISH TO WALL FINISH DIMENSION
 DIMENSIONS IN RED RELATE TO BLOCK/STUD TO BLOCK/STUD DIMENSION

FOR DETAILS OF ALL BATHROOMS/KITCHENS, REFER TO DSO DESIGN AND SPECIFICATION

- 11 DOOR TAG
- 11 WINDOW TAG
- 75 X 50 POLYTHENE SLEEVED CAVITY BARRIER
- MINERAL WOOL FIRESTOP
- RAINWATER DOWNPIPE
- POP-UP THROUGH SLAB FOR SERVICES. REFER TO M&E SPECIFICATION FOR SIZE
- RADON VENTING SYSTEM

NORTH POINT

ONLY FOR REFERENCE WITH PLANNING SERVICES

APPROVED BY

Client: ADAMSTOWN STATION & BOULEVARD LTD
 Project: ADAMSTOWN BOULEVARD PHASE 1
 Title: TERRACE TYPE - T5B - GROUND FLOOR PLAN

Sheet No.: 1238-MDO-T5B-00-DR-A-22001
 Scale as: 1:50 @ A1 Current Rev: T Project No.: 1238

MC CAULEY DAYE O'CONNELL
 ARCHITECTS

11 Merrion Square, Dublin 2, Ireland
 Telephone: +353 (0)1 400 4171
 info@mdo.ie | www.mdo.ie