

1. ALL DRAWINGS TO BE CHECKED BY CONTRACTOR ON-SITE AND ENGINEER INFORMED OF DISCREPANCIES BEFORE WORK COMMENCES.
2. ALL DIMENSIONS AND LEVELS ARE IN METERS AND ARE RELATED TO ORDNANCE DATUM. CO-ORDINATES RELATE TO IRISH TRANSVERSE MERIDIAN.
3. ALL WORKS TO BE CONSTRUCTED IN ACCORDANCE WITH THE NRA SPECIFICATION FOR ROAD WORKS UNLESS OVERRIDDEN BY LOCAL OVERSEING AUTHORITY'S STANDARDS.
4. ALL ROAD MARKINGS & SIGNS SHALL COMPLY FULLY WITH THE TRAFFIC SIGNS MANUAL PUBLISHED BY THE DEPARTMENT OF TRANSPORT.
5. ALL SIGNS TO BE MOUNTED ON 76.1mm GALVANISED STEEL POSTS WITH COLOURED SLEEVES U.N.O. TO SPECIFICATION AND IN ACCORDANCE WITH THE TRAFFIC SIGNS MANUAL: MOUNTING HEIGHT TO BOTTOM OF SIGN = 2.3m U.N.O.
6. ALL TRAFFIC MANAGEMENT TO COMPLY FULLY WITH THE PROVISIONS OF CHAPTER 8 OF THE TRAFFIC SIGNS MANUAL.
7. ALL EXISTING SIGNS (INCLUDING POLES) AND MARKINGS TO BE TAKEN UP OR COVERED AND TEMPORARY MEASURES APPLIED IN ACCORDANCE WITH CONTRACTORS TRAFFIC MANAGEMENT PLAN. THE CONTRACTOR MAY USE EXISTING SIGNAGE AS PART OF THEIR TRAFFIC MANAGEMENT PLAN.
8. ALL EXISTING CHAMBERS AND ACCESS POINTS TO REMAIN CLEAR OF OBSTRUCTION THROUGHOUT WORKS. CHAMBERS SHALL BE REBUILT/RETAINED IN POSITION IDENTIFIED ON SITE SERVICES LAYOUT DRAWING.
9. ALL PEDESTRIAN, CYCLE AND VEHICULAR ROUTES MUST BE RETAINED IN ACCORDANCE WITH APPROVED TRAFFIC MANAGEMENT PLAN.
10. ALL MATERIALS TO BE DISPOSED OFF SITE SHALL BE TAKEN TO A LICENSED FACILITY APPROVED BY THE LOCAL OVERSEING AUTHORITY.

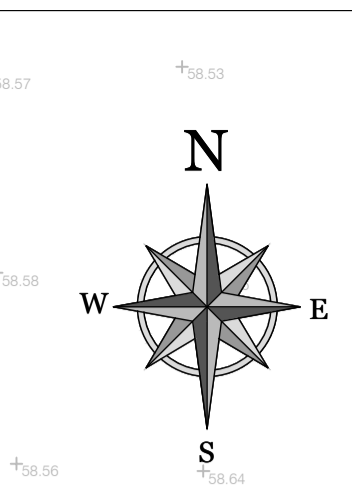

MSE WALL- EVOGEO EVOGREEN OR SIMILAR APPROVED TO PROPRIETARY BRIDGE EMBANKMENT DESIGN TO BE SEPARATELY PERMITTED

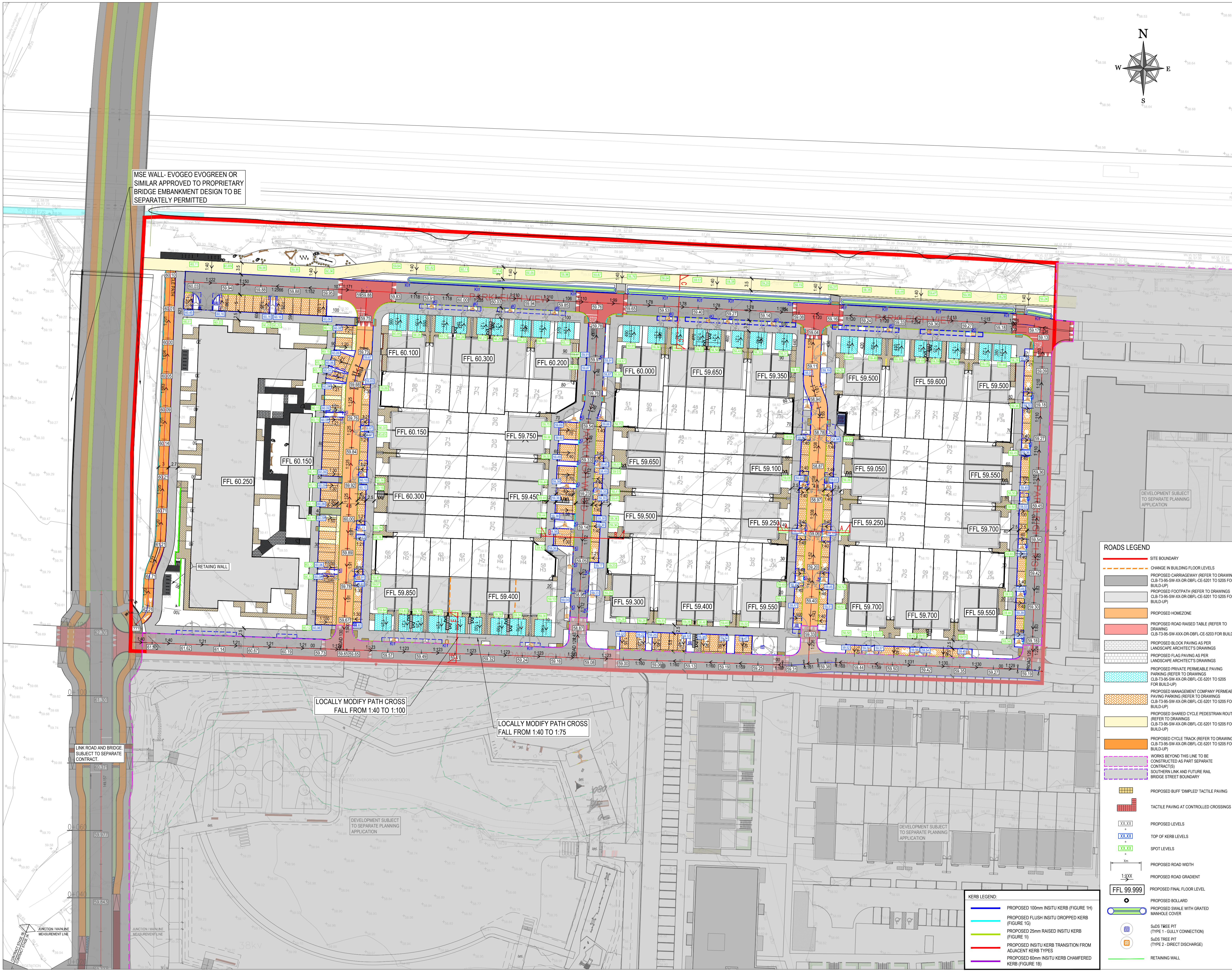

ROADS LEGEND

- SITE BOUNDARY
- CHANGE IN BUILDING FLOOR LEVELS
- PROPOSED CARRIAGEWAY (REFER TO DRAWINGS CLB-T3-95-SW-XX-DR-DBFL-CE-6201 TO 6205 FOR BUILD-UP)
- PROPOSED FOOTPATH (REFER TO DRAWINGS CLB-T3-95-SW-XX-DR-DBFL-CE-6201 TO 6205 FOR BUILD-UP)
- PROPOSED HOMEZONE
- PROPOSED ROAD RAISED TABLE (REFER TO DRAWING CLB-T3-95-SW-XXX-DR-DBFL-CE-6203 FOR BUILD-UP)
- PROPOSED BLOCK PAVING AS PER LANDSCAPE ARCHITECTS DRAWINGS
- PROPOSED FLAG PAVING AS PER LANDSCAPE ARCHITECTS DRAWINGS
- PROPOSED PRIVATE PERMEABLE PAVING (REFER TO DRAWINGS CLB-T3-95-SW-XX-DR-DBFL-CE-6201 TO 6205 FOR BUILD-UP)
- PROPOSED MANAGEMENT COMPANY PERMEABLE PAVING (REFER TO DRAWINGS CLB-T3-95-SW-XX-DR-DBFL-CE-6201 TO 6205 FOR BUILD-UP)
- PROPOSED SHARED CYCLE PEDESTRIAN ROUTE (REFER TO DRAWINGS CLB-T3-95-SW-XX-DR-DBFL-CE-6201 TO 6205 FOR BUILD-UP)
- PROPOSED CYCLE TRACK (REFER TO DRAWINGS CLB-T3-95-SW-XX-DR-DBFL-CE-6201 TO 6205 FOR BUILD-UP)
- WORKS BEYOND THIS LINE TO BE CONSTRUCTED AS PART SEPARATE CONTRACTS
- SOUTHERN LINK AND FUTURE RAIL BRIDGE STREET BOUNDARY
- PROPOSED BUMP 'DIMPLED' TACTILE PAVING
- TACTILE PAVING AT CONTROLLED CROSSINGS
- PROPOSED LEVELS
- TOP OF KERB LEVELS
- SPOT LEVELS
- PROPOSED ROAD WIDTH
- PROPOSED ROAD GRADIENT
- PROPOSED FINAL FLOOR LEVEL
- PROPOSED BOLLARD
- PROPOSED SIAWALE WITH GRATED MANHOLE COVER
- SLOD TREE PIT (TYPE 1- GULLY CONNECTION)
- SLOD TREE PIT (TYPE 2- DIRECT DISCHARGE)
- RETAINING WALL

KERB LEGEND:

- PROPOSED 100mm INSITU KERB (FIGURE 1H)
- PROPOSED FLUSH INSITU DROPPED KERB (FIGURE 1G)
- PROPOSED 25mm RAISED INSITU KERB (FIGURE 1I)
- PROPOSED INSITU KERB TRANSITION FROM ADJACENT KERB TYPES
- PROPOSED 60mm INSITU KERB CHAMFERED KERB (FIGURE 1B)

ORDNANCE SURVEY IRELAND LICENCE
No CYAL50276885
© ORDNANCE SURVEY IRELAND
GOVERNMENT OF IRELAND

no	date	description	by	chkd
10	27-02-24	ISSUED FOR CONSTRUCTION	JVS	DCB
9	07-02-24	ISSUED FOR CONSTRUCTION	JVS	DCB
8	16-01-24	GENERAL UPDATE	JVS	DCB
7	21-12-23	ISSUED FOR CONSTRUCTION	JVS	JC
6	19-12-23	UPDATED FOR TENDER STATUS A	JVS	JC
5	08-12-23	ISSUED FOR TENDER STATUS A	JVS	DCB
4	25-11-23	ISSUED FOR TENDER STATUS B	JVS	DCB
3	25-11-22	ISSUED FOR COMPLIANCE	RMC	DCB
2	20-07-23	ISSUED FOR TENDER STATUS A	DKE	DCB
1	07-06-23	ISSUED FOR TENDER STATUS A	DKE	DCB
0	15-05-23	ISSUED FOR TENDER STATUS B	DKE	DCB

purpose	acceptance
P9 - CONTRACT/CONSTRUCTION	S - ISSUED

DBFL Consulting Engineers
Civil, Structural & Transportation Engineering
www.dbfl.ie

DUBLIN OFFICE: Ormond House, Upper Ormond Quay, Dublin 7, D07 WY04
PHONE: +353 1 450 4000
CORK OFFICE: 14 South Mall, Cork, T12 CT91
PHONE: +353 21 2024538
WATERFORD OFFICE: 50a-52 The Arcade, Maritime Gate, Canada Street, Waterford, X91 W028
PHONE: +353 51 309 500

project ref:
CLONBURRIS TILE 3

drawing title:
PROPOSED PAVEMENT & KERBING DETAILS

client:
CAIRN HOMES PROPERTIES LTD

designed by: DCB
author: DKE
scale: 1:500
sheet size: A1
revision:

drawing no.: **CLB-T3-95-SW-DTM-DR-DBFL-CE-1211**
10