

KEY & PLANTING SCHEDULES

Street Trees (tree pit extent in dashed line)

ID	Species	Size	Quantity	Unit
T1	Atrium glutinosa	16-18 cm g, 4m+ h, 2 m clear stem, RB	8	no
T2	Tilia cordata 'Greenspire'	16-18 cm g, 4m+ h, 2 m clear stem, RB	27	no
T3	Acer campestre 'Elsrijk'	16-18 cm g, 4m+ h, 2 m clear stem, CG	14	no
T4	Betula pubescens	16-18 cm g, 4m+ h, 2 m clear stem, RB	11	no
T5	Sorbus aria	16-18 cm g, 4m+ h, 2 m clear stem, RB	10	no
Native Parkland Trees				
T6	Salix caprea	16-18cm gth, 3.0-3.5m h, feathered, BR	4	no
T7	Atrium glutinosa	16-18cm gth, 3.0-3.5m h, feathered, BR	5	no
T8	Prunus avium	16-18cm gth, 4m+ h, RB	3	no
T9	Quercus robur	16-18cm gth, 4m+ h, RB	8	no
T10	Pinus sylvestris	4m+ ht, RB/CG	6	no
T11	Ilex aquifolium	14-16cm, 4m+ ht, BR	4	no
T12	Crataegus monogyna	12-14cm, 2.5-3.5m h, BR	4	no
Native Large Parkland Trees and Fruit Trees - To rear gardens				
T13	Quercus petraea	25-30cm g, 5m+ ht, RB	1	no
T14	Pinus sylvestris	25-30cm g, 5m+ ht, RB	3	no
Fruit Trees (To rear gardens)				
T15	Malus 'evereste'	10-12cm g, Clear stem, BR	80	no
Specimen Shrubs				
S1	Sambucus nigra 'Golden Tower'	20t CG, 100cm+ ht	8	no
S2	Viburnum opulus	20t CG, 100cm+ ht	17	no
S3	Amelanchier lamarkii	20t CG, 100cm+ ht, multi-stem	28	no
S4	Arbutus unedo	20t CG, 100cm+ ht	25	no
S5	Euonymus europaeus	20t CG, 100cm+ ht	13	no
S6	Mahonia x media 'Charly'	20t CG, 100cm+ ht	12	no
S7	Corylus avellana	20t CG, 100cm+ ht, multi-stem	14	no
Native Woodland (Miyawaki) 575 m²				
P1	Pinus sylvestris	8-10cm, B/R @ 1/10m²	57	no
P2	Quercus robur	8-10cm, B/R @ 1/10m²	57	no
P3	Prunus avium	60-120cm ht, B/R, @ 1m²	575	no
P4	Prunus padus	60-120cm ht, B/R, @ 1m²	575	no
P5	Betula pendula	60-120cm ht, B/R, @ 1m²	575	no
P6	Betula pubescens	60-120cm ht, B/R, @ 1m²	575	no
P7	Malus sylvestris	60-120cm ht, B/R, @ 1m²	575	no
P8	Arbutus unedo	60-120cm ht, B/R, @ 1m²	575	no
P9	Sorbus aucuparia	60-120cm ht, B/R, @ 1m²	575	no
P10	Ilex aquifolium	1+1, 60-90cm ht, B/R @ 1 m²	575	no
P11	Rosa canina	1+1, 60-90cm ht, B/R @ 1 m²	575	no
P12	Corylus avellana	1+1, 60-90cm ht, B/R @ 1 m²	575	no
P13	Crataegus monogyna	1+1, 60-90cm ht, B/R @ 1 m²	575	no
P14	Euonymus europaeus	2t c.g., @ 1 m²	575	no
P15	Hypericum pulchrum	2t c.g., @ 1 m²	575	no
P16	Lonicera periclymenum	2t c.g., @ 1 m²	575	no
P17	Viburnum opulus	2t c.g., @ 1 m²	575	no
P18	Hedera helix	p9 c.g., @ 1 m²	575	no
P19	Luzula nivea	p9 c.g., @ 1 m²	575	no
P20	Primula vulgaris	p9 c.g., @ 1 m²	575	no
P21	Primula veris	p9 c.g., @ 1 m²	575	no
P22	Fragaria vesca	p9 c.g., @ 1 m²	575	no
P23	Ajuga reptans	p9 c.g., @ 1 m²	575	no
P24	Digitalis purpurea	p9 c.g., @ 1 m²	575	no
P25	Phyllis scopendrium	p9 c.g., @ 1 m²	575	no
P26	Dryopteris affinis	p9 c.g., @ 1 m²	575	no
H1 Mixed Native-Hedge To Houses / Apartments				
Total area = 600m²				
H1.1	Ligustrum vulgare	1m ht., 10-15t CG / RB @ 3.0 lm	50%	1,800 no
H1.2	Ilex aquifolium	1m ht., 10-15t CG / RB @ 3.0 lm	50%	1,800 no
H2 Mixed Native Hedgerow - To Western Boundary / Proposed Bridge				
Total area = 260 m²				
H2.1	Viburnum opulus	1+2, 100cm+ ht, B/R @ 4 lm	15%	156 no
H2.2	Crataegus monogyna	1+2, 100cm+ ht, B/R @ 4 lm	40%	416 no
H2.3	Corylus avellana	1+2, 100cm+ ht, B/R @ 4 lm	10%	104 no
H2.4	Euonymus europea	1+2, 100cm+ ht, B/R @ 4 lm	10%	104 no
H2.5	Ilex aquifolium	5t c.g., 100cm+ ht, bushy @ 4 lm	15%	156 no
H2.6	Prunus spinosa	1+2, 100cm+ ht, B/R @ 4 lm	10%	104 no
SW Swale Mix 362 m²				
SW.1	Achillea millefolium 'Moonshine'	2t c.g., @ 9 m²	10%	326 no
SW.2	Libertia grandiflora	2t c.g., 25cm HI/Spr @ 7 m²	30%	760 no
SW.3	Carex 'Golden Edge'	5t c.g., @ 2 m²	20%	145 no
SW.4	Geranium 'Rozanne'	2t c.g., @ 9 m²	20%	652 no
SW.5	Forsythia x intermedia 'Spectabilis'	5t c.g., @ 1 m²	2%	7 no
SW.6	Filipendula ulmaria	2t c.g., @ 5 m²	8%	145 no
SW.7	Iris sibirica 'Perry's Blue'	2t c.g., @ 11 m²	10%	398 no

Code	Area	Plant Species	Quantity	Unit	
F1	Front Garden Shade Mix 1 184 m²	Actaea simplex 'Brunette'	3t c.g. @ 9 m²	10%	166 no
F1		Dryopteris filix-mas	5t c.g. @ 2 m²	5%	18 no
F1		Epidendrum perralderianum	2t c.g. @ 11 m²	30%	607 no
F1		Geranium sylvaticum	2t c.g. @ 9 m²	5%	83 no
F1		Liriope muscari 'Monroe White'	2t c.g. @ 11 m²	10%	202 no
F1		Hebebe ornata 'Burgundy'	3t c.g. @ 9 m²	10%	166 no
F1		Hydrangea quercifolia 'Snow Queen'	5t c.g. @ 2 m²	10%	37 no
F1		Rosmarinus officinalis 'Miss Jessop's Upright'	5t c.g. 40-60cm HI/Spr @ 4 m²	10%	74 no
F1		Hypericum 'Midote'	5t c.g. 30-40cm HI/Spr @ 4 m²	10%	74 no
F2	Front Garden Semi-Shade Mix 441 m²	Viburnum tinus 'Eve Price'	2t c.g. @ 5 m²	10%	221 no
F2		Alchemilla alpina	2t c.g. @ 7 m²	5%	154 no
F2		Persicaria affinis 'Darjeeling Red'	2t c.g. @ 5 m²	5%	110 no
F2		Liriope muscari 'Big Blue'	2t c.g. @ 7 m²	5%	154 no
F2		Sedum spectabile 'Autumn Joy'	2t c.g. @ 6 m²	5%	132 no
F2		Teucrium chamaedrys	2t c.g. @ 5 m²	5%	110 no
F2		Sanguisorba officinalis	2t c.g. @ 5 m²	2%	44 no
F2		Rosa 'Munstead Red'	5t c.g. 40-60cm HI/Spr @ 4 m²	2%	35 no
F2		Nassella tenuissima 'Pony Tail'	2t c.g., 25cm HI/Spr @ 7 m²	10%	309 no
F2		Salvia officinalis 'Purpurea'	2t c.g., 25cm HI/Spr @ 4 m²	10%	176 no
F2		Betonica officinalis	2t c.g., 25cm HI/Spr @ 7 m²	4%	123 no
F2		Veronica virginicum 'Erica'	2t c.g., 20cm HI/Spr @ 7 m²	2%	62 no
F2		Nepeta 'Walkers Low'	2t c.g., 20cm HI/Spr @ 7 m²	10%	309 no
F2		Pittosporum tenuifolium 'Tom Thumb'	5t c.g. 30-40cm HI/Spr @ 4 m²	10%	176 no
F2		Geranium sanguineum	2t c.g., 25cm HI/Spr @ 5 m²	5%	110 no
F2		Deschampsia cespitosa	3t c.g. 25-30cm HI/Spr @ 7 m²	5%	154 no
F2		Dryopteris filix-mas	5t c.g. @ 2 m²	5%	44 no
F3	Front Garden Sun Mix 555 m²	Rosmarinus officinalis 'Miss Jessop's Upright'	5t c.g. @ 5 m²	10%	278 no
F3		Cistus x hybridus	5t c.g. @ 2 m²	10%	111 no
F3		Achillea millefolium 'Moonshine'	2t c.g. @ 9 m²	5%	250 no
F3		Carex 'Golden Edge'	5t c.g. @ 2 m²	5%	56 no
F3		Knautia macedonica	2t c.g. @ 5 m²	5%	139 no
F3		Agastache 'Blue Fortune'	2t c.g., 25cm HI/Spr @ 7 m²	5%	139 no
F3		Nassella tenuissima 'Pony Tail'	2t c.g., 25cm HI/Spr @ 7 m²	10%	389 no
F3		Salvia officinalis 'Purpurea'	2t c.g., 25cm HI/Spr @ 4 m²	10%	222 no
F3		Betonica officinalis	2t c.g., 25cm HI/Spr @ 7 m²	4%	155 no
F3		Pittosporum tenuifolium 'Tom Thumb'	5t c.g. 30-40cm HI/Spr @ 4 m²	10%	222 no
F3		Penstemon 'Garnet'	2t c.g., 25cm HI/Spr @ 9 m²	3%	150 no
F3		Geranium sanguineum	2t c.g., 25cm HI/Spr @ 9 m²	5%	250 no
F3		Rubus 'Goldsturm'	2t c.g., 25cm HI/Spr @ 5 m²	10%	278 no
F3		Kniphofia 'Knapflor' Royal Castle'	2t c.g., 25cm HI/Spr @ 7 m²	4%	155 no
F3		Phlox russelliana	2t c.g., 25cm HI/Spr @ 9 m²	4%	200 no
BA	Bio-retention Planting Mix 235 m²	Veronica beccabunga	9cm BK, @ 11 m²	5%	129 no
BA		Sagittaria sagittifolia	9cm BK, @ 11 m²	10%	259 no
BA		Caltha palustris	11cm BK, @ 5 m²	10%	118 no
BA		Isis pseudoacorus	11cm BK, @ 5 m²	1%	12 no
BA		Menyanthes trifoliate	11cm BK, @ 3 m²	10%	71 no
BA		Lycium scariosum	11cm BK, @ 5 m²	10%	118 no
BA		Thalictrum flavum	11cm BK, @ 5 m²	10%	118 no
BA		Mysotis scorpiodes	9cm BK, @ 11 m²	14%	362 no
BA		Lysimachia vulgaris	11cm BK, @ 5 m²	5%	59 no
BA		Menyanthes trifoliate	11cm BK, @ 3 m²	10%	71 no
BA		Mysotis scorpiodes	9cm BK, @ 11 m²	5%	129 no
BA		Butomus umbellatus	11cm BK, @ 5 m²	10%	118 no
BP	Bulb Planting Mix 170 m²	Supply and plant bulbs on half of all shrubs and swales areas scattered in drifts.			
BP		Crocus vernus 'Remembrance'	@ 40 m²	25%	1700 no
BP		Allium hollandicum 'Purple Sensation'	@ 20 m²	25%	850 no
BP		Narcissus poeticus var. recurvus	@ 20 m²	25%	850 no
BP		Tulipa c. var	@ 10 m²	25%	425 no
D	SEEDING				
WF	Wildflower meadow 23 m²	DW01 - Short Cut Wildflower Mixture - Cut every 6 weeks - By "Design By Nature" or equivalent.		23	sq.m
AG	Amenity grass 5655 m²				
	Public areas 483 m²	EC09 - Species Rich Amenity Grassland Native Flora. By "Design by Nature" or equivalent		483	sq.m
	Gardens 5172 m²	EC09 - Species Rich Amenity Grassland Native Flora. By "Design by Nature" or equivalent		5,172	sq.m

Existing vegetation



Existing Scrub Thicket with additional native hedgerow planting where appropriate

Tree / Hedgerow protection fencing

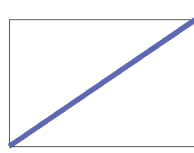

1.2m High Chestnut Pale fence

Detailed Planting - Native Woodland (Miyawaki) scale 1:50

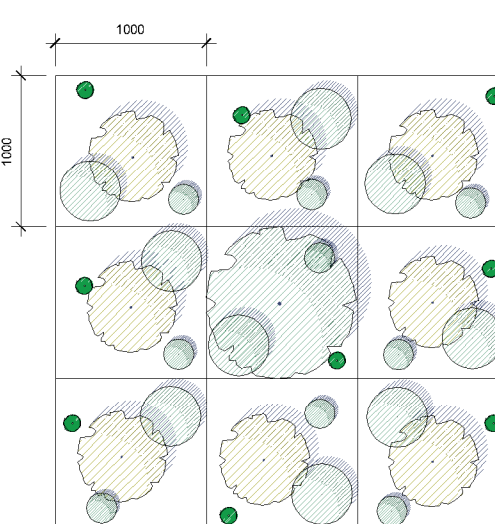

Trees Legend

- Large trees: Pinus sylvestris, Quercus robur
- Medium / Small trees: Prunus avium, Prunus padus, Betula pendula, Betula pubescens, Malus sylvestris, Arbutus unedo, Sorbus aucuparia
- Large shrubs: Ilex aquifolium, Rosa canina, Corylus avellana, Crataegus monogyna
- Medium / Small shrubs: Euonymus europaeus, Hypericum pulchrum, Viburnum periclymenum
- Ground cover: Hedera helix, Luzula nivea, Primula vulgaris, Primula veris, Fragaria vesca, Ajuga reptans, Digitalis purpurea, Phyllis scopendrium, Dryopteris affinis

Play Surfacing

- Engineered Woodchip Play surfacing
- To all playpce surfacing in Public Open Space areas, set within Metal edging, Excel edge 4mm or similar approved

COMPLIANCE

REV	DATE	AMENDMENT
-----	------	-----------

CUNNANE STRATTON REYNOLDS  
LAND PLANNING & DESIGN

DUBLIN OFFICE  
3 MOLESWORTH PLACE DUBLIN 2  
TEL: 01 661 0419 FAX: 01 661 0431  
EMAIL: info@csrandplan.ie

PROJECT:	CLONBARRIS CAIRN T3	DATE:	AUG 2023
DRAWING:	PLANTING PLAN - KEY & SCHEDULES	SCALE:	1:500 @ A1
CHECKED:		DRAWN:	JMC
		CHECKED:	AF
DWG NO:	CLB-03-06-T9-XX-DR-CSR-LA-0700		