

E.Planting Area 5

Scale (1:150)



- S2 x 80no & S5 x 60no., Gc2 x 118no.
- S2 x 200no & S5 x 150no., Gc2 x 154no.
- S3 x 16no.
- S2 x 20no.
- S3 x 16no.
- S3 x 54no & S4 x 48no., Gc1 x 47no.
- S2 x 36no.
- S2 x 80no, S3 x 45no., & S5 x 45no., Gc3 x 68no.
- S3 x 45no. & S4 x 45no., Gc1 x 52no.
- S1 x 30no, S4 x 30no., & S6 x 50no., Gc1 x 52no.
- S1 x 60no & S4 x 45no., Gc1 x 83no.
- S1 x 90no & S4 x 60no., Gc1 x 94no.
- S2 x 80no, S3 x 15no., & S5 x 15no., Gc3 x 15no.
- S3 x 21no. & S4 x 18no., Gc1 x 21no.
- S5 x 20no.

- S2 x 40no, S3 x 30no., & S5 x 45no., Gc3 x 33no.
- S2 x 80no, S3 x 45no., & S5 x 45no., Gc3 x 37no.
- Ligustrum vulgare x 127no.
- S3 x 21no. & S4 x 18no., Gc1 x 21no.
- S5 x 20no.

F.Planting Area 6

Scale (1:150)

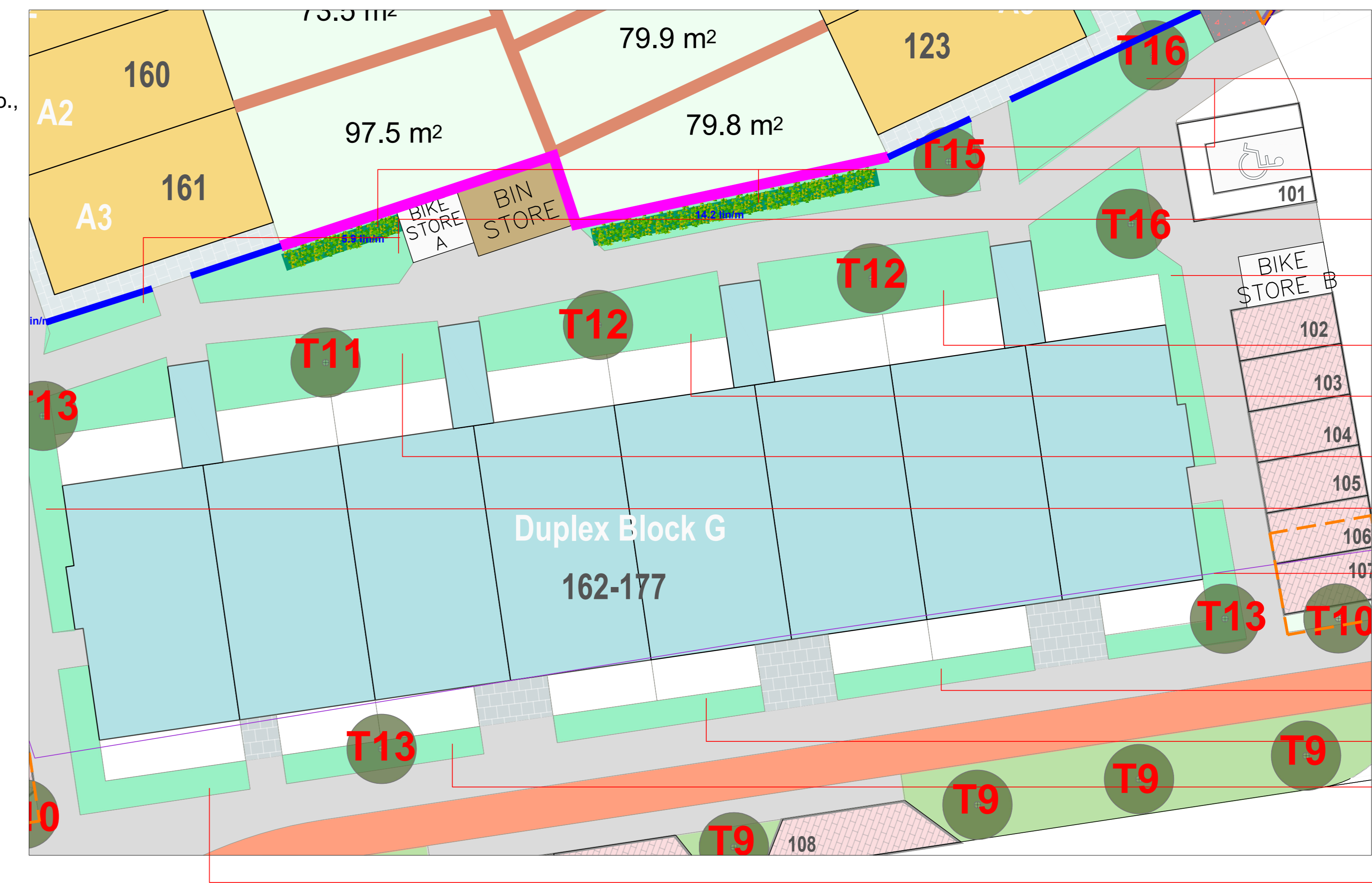

- S3 x 105no. & S4 x 75no., Gc1 x 94no.
- Native hedge x 60no.
- S2 x 80no & S5 x 45no., Gc2 x 29no.
- S2 x 60no, S3 x 30no., & S5 x 30no., Gc3 x 32no.
- S5 x 45no., S7 x 45no., & Gc3 x 36no.
- S3 x 45no. & S4 x 45no., Gc1 x 25no.
- S5 x 45no., S7 x 45no., & Gc3 x 23no.
- S2 x 40no, S3 x 30no., & S5 x 15no., Gc3 x 27no.
- S1 x 15no & S4 x 15no., Gc1 x 34no.
- S7 x 24no. & Gc3 x 19no.
- S3 x 30no & Gc1 x 28no.
- S7 x 30no. & Gc3 x 17no.
- S1 x 24no & S4 x 21no., Gc1 x 27no.

F.Planting Area 6 cont.

Scale (1:150)

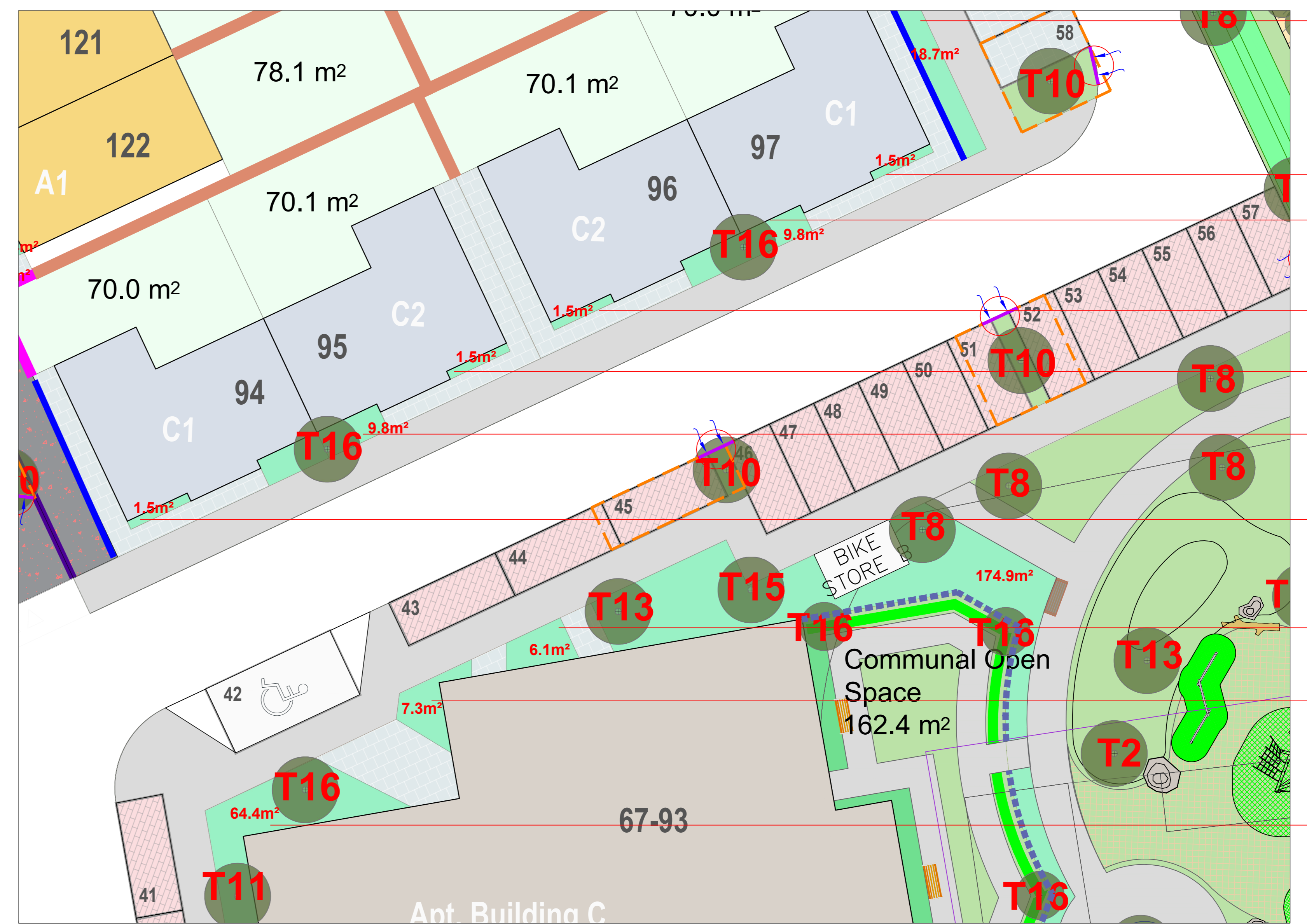

- S2 x 16no & S5 x 12no., Gc2 x 158no.
- S2 x 20no. & Gc1 x 14no.
- S3 x 30no. & S4 x 30no., Gc1 x 46no.
- S2 x 20no. & Gc1 x 14no.
- S2 x 20no. & Gc1 x 14no.
- S3 x 45no. & S4 x 45no., Gc1 x 32no.
- S2 x 20no. & Gc1 x 14no.
- S2 x 40no, S3 x 15no., & S5 x 15no., Gc3 x 7no.
- S2 x 40no, S3 x 15no., & S5 x 15no., Gc3 x 7no.
- S1 x 30no, S4 x 30no., S6 x 50no. & Gc1 x 47no.

Location Plan

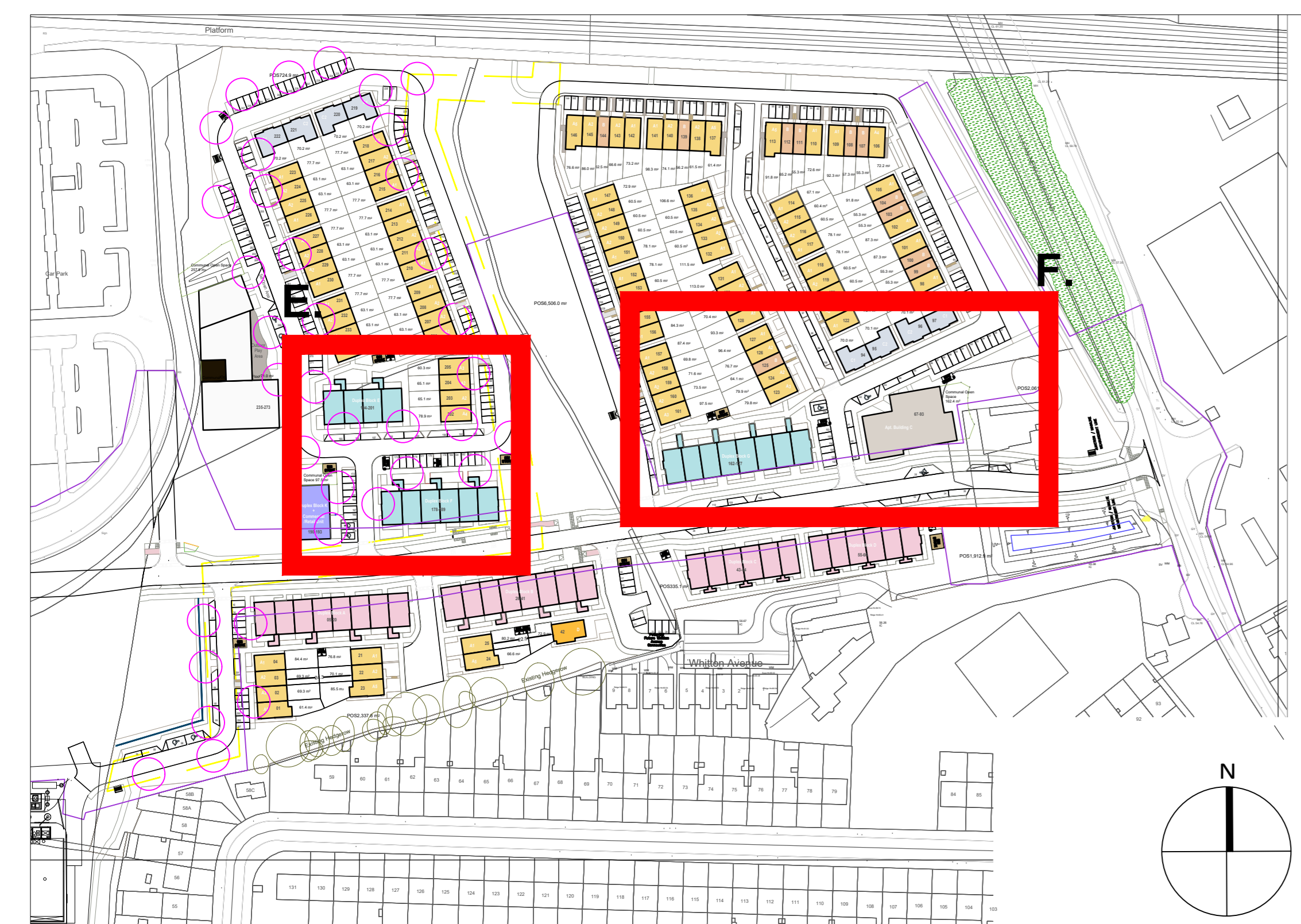

M1 - Wild Flower Meadow (3grams per 1m) - approx. 3056 sq.m			
Wildflower Meadow Mix		Wildflower Meadow Mix	
450mm topsoil depth		450mm topsoil depth	
Species Name	Specification	Plant/m2	No.
Common knapweed - <i>Centaurea nigra</i>	c/g 3L 30-40cm ht.	3m ²	1017
Ribwort plantain - <i>Plantago lanceolata</i>	c/g 3L 30-40cm ht.	4m ²	2395
Red clover - <i>Trifolium pratense</i>	c/g 3L 30-40cm ht.	3m ²	1875
Bird's-foot trefoil - <i>Lotus corniculatus</i>	c/g 3L 30-40cm ht.	3m ²	1117
Bulbous buttercup - <i>Ranunculus bulbosus</i>	c/g 3L 30-40cm ht.	3m ²	1803
Meadow buttercup - <i>Ranunculus acris</i>	c/g 2L 30-40cm ht.	5m ²	1304
Lady's-bedstraw - <i>Galium verum</i>	c/g 2L 30-40cm ht.	5m ²	333
Proposed Shrub Planting - 2908 sq.m			
Code	Species Name	Specification	Plant/m2
P.o.	<i>Prunus 'Otto Luyken'</i>	c/g 3L 30-40cm ht.	3m ²
L.a.	<i>Lavandula angustifolia</i>	c/g 3L 30-40cm ht.	4m ²
L.g.	<i>Libertia grandiflora</i>	c/g 3L 30-40cm ht.	3m ²
C.c.	<i>Cistus corbariensis</i>	c/g 3L 30-40cm ht.	3m ²
S.c.	<i>Sarcococcoa confusa</i>	c/g 3L 30-40cm ht.	3m ²
A.s.	<i>Astelia 'Silver Spear'</i>	c/g 2L 30-40cm ht.	5m ²
S.s.	<i>Sedum spectabile</i>	c/g 2L 30-40cm ht.	5m ²
Proposed Ground Cover Planting			
Code	Species Name	Specification	Plant/m2
B.c.	<i>Bergenia cordifolia</i>	c/g 2L 30-40cm ht.	5m ²
P.a.	<i>Persicaria affinis</i>	c/g 2L 30-40cm ht.	5m ²
H.n.	<i>Helleborus niger</i>	c/g 2L 30-40cm ht.	5m ²

Tree Pit Planting (as per 12.5sqm)	
Species Name	Qty.
Groundcover	15
<i>Persicaria affinis</i>	15
Perennials	
<i>Ligularia przewalskii</i> 'The Rocket'	5
Astilbe spp. (Snowdrift, Hyacinth)	5
<i>Iris pseudocorus</i>	5
<i>Achillea millefolium</i> 'Song Siren Laura'	8
Bulb/Corm/Rhizome	
<i>Aquilegia canadensis</i>	3
Grass	
<i>Miscanthus sinensis</i>	4
<i>Carex pendula</i> or <i>Panicum virgatum</i>	4
Fern	
<i>Dryopteris felix-mas</i> or <i>Dryopteris dilatata</i>	4

- H1 - Native Hedgerow** (450mm topsoil depth / 100cm double row)
Species Name: *Craetagus monogyna*, *Ilex aquifolium*, *Corylus avellana*, *Viburnum opulus* - approx. 1055.0 lin/m
- H2 - Evergreen hedgerow** (450mm topsoil depth / 100cm single row)
Species Name: *Ligustrum vulgare* - approx. 669.0 lin/m

REV	DATE	BY	CHECKED	DESCRIPTION
L	16/12/2023	PR	RM	Completion
K	31/10/2023	PR	RM	Completion
J	16/10/2023	PR	RM	Completion
I	13/10/2023	PR	RM	Completion
H	28/09/2023	PR	RM	Completion
G	22/09/2023	PR	RM	Completion
F	19/08/2023	PR	RM	Completion
E	07/07/2023	PR	RM	Completion

Project Title: Clonburris SZ2 at Dublin 22

Client: Kelland Homes
Drawing Title: Landscape Planting Plan (v1)
Job No: 1577

Scale: Varies
Date: 12/11/2020

Ronan MacDiarmada + Associates Ltd.
Landscape Architects and Consultants.
5 Tooterhill, Rathcoole, Co. Dublin
tel: +353 1 472 4476
fax: +353 1 401 3748
email: ronan@rmda.ie

This Drawing is Copyright ©