

D.Planting Area 4

Scale (1:150)

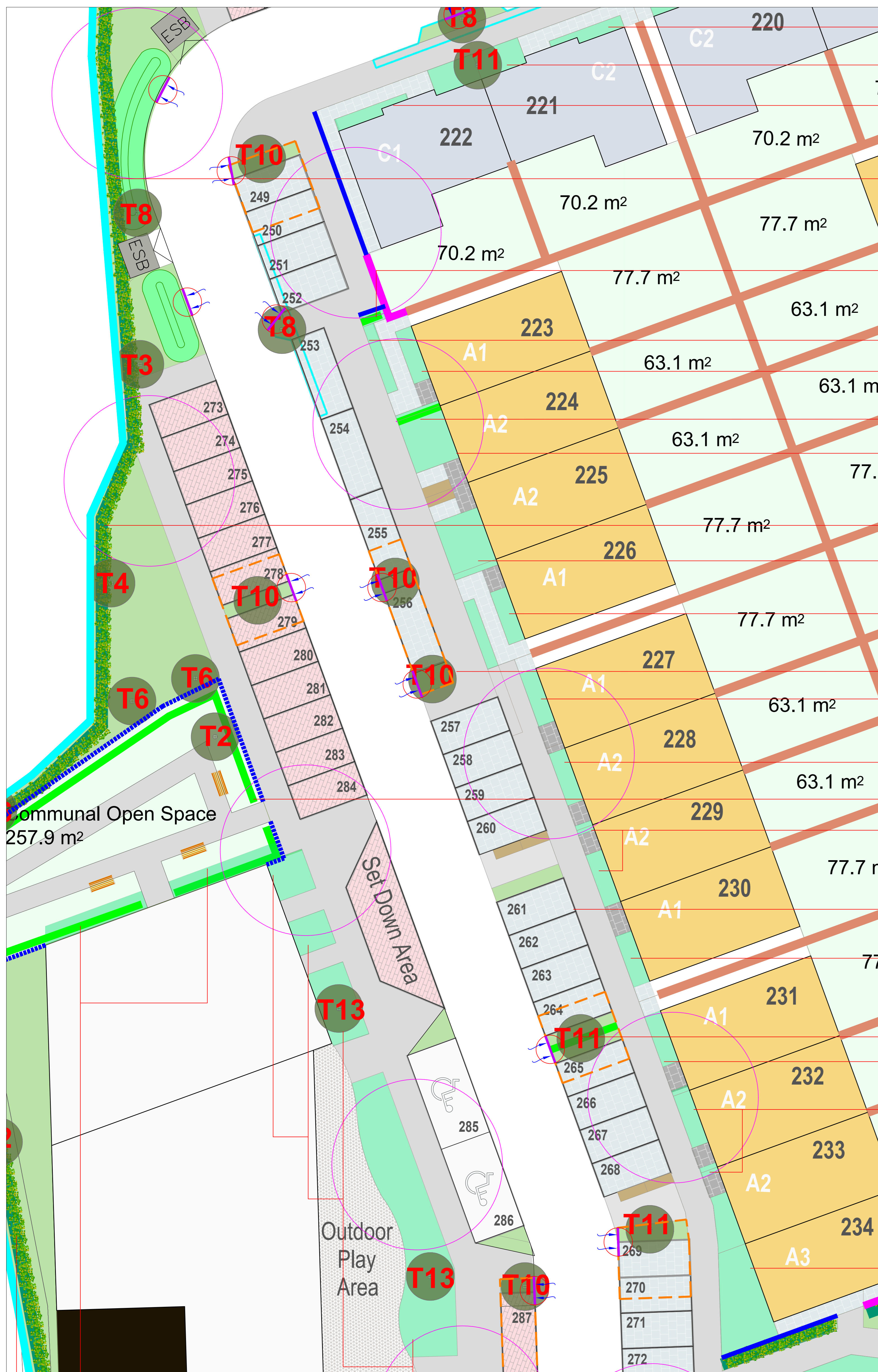

- S2 x 18no.
- S3 x 21no.S4 x 19no
- S2 x 18no.
- Native Hedge x 331no.
- Ligustrum vulgare x 18no.
- S1 x 36no.
- S7 x 26no.
- Ligustrum vulgare x 19no.
- S5 x 22no & S6 x 22no.
- Native Hedge x 103no.
- S5 x 22no & S6 x 22no.
- S2 x 20no.
- Ligustrum vulgare x 11no.
- S2 x 20no.
- S1 x 29no.
- Ligustrum vulgare x 60no.
- S3 x 30no.
- Ligustrum vulgare x 19no.
- S2 x 20no.
- Ligustrum vulgare x 11no.
- S2 x 20no.
- S3 x 30no.
- S1 x 15no & S4 x 12no.

S2 x 28no & S3 x 24no., Gc1 x 23no.

S4 x 111no & S5 x 111no., Gc2 x 109no.

Native Hedge x 127no.

- H1 - Native Hedgerow** (450mm topsoil depth / 100cm double row)  
 Species Name Qty.  
 Crætagus monogyna, Ilex aquifolium, Corylus avellana, Viburnum opulus - approx. 1055.0 lin/m
- H2 - Evergreen hedgerow** (450mm topsoil depth / 100cm single row)  
 Ligustrum vulgare - approx. 669.0 lin/m

Tree Pit Planting (as per 12.5sqm)	
Species Name	Qty.
Perennials	
Ligularia przewalskii 'The Rocket'	5
Astilbe spp. (Snowdrift, Hyacinth)	5
Iris pseudoacorus	5
Achillea millefolium 'Song Siren Laura'	8
Bulb/Corm/Rhizome	
Aquilegia canadensis	3
Grass	
Miscanthus sinensis	4
Carex pendula or Panicum virgatum	4
Fern	
Dryopteris felix-mas or Dryopteris dilatata	4

D.Planting Area 4 cont.

Scale (1:150)

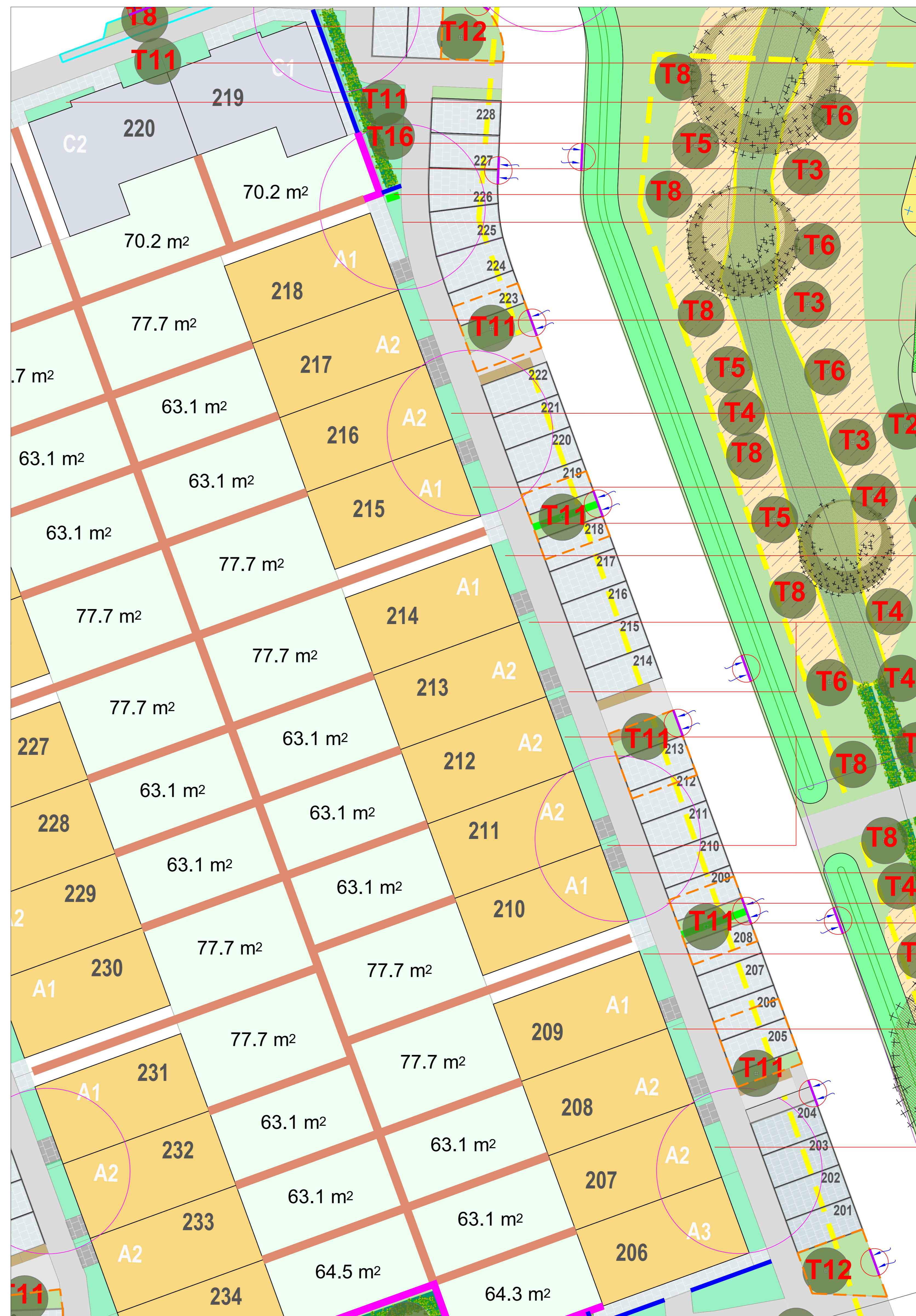

- S2 x 13no.
- S3 x 21no.S4 x 19no
- S2 x 18no.
- S2 x 80no & S3 x 60no., Gc1 x 70no.
- Native Hedge x 39no.
- Ligustrum vulgare x 8no.
- S1 x 13no.
- S3 x 30no.
- S7 x 26no.
- S2 x 20no.
- Ligustrum vulgare x 11no.
- S2 x 20no.
- S6 x 32no.
- S3 x 30no.
- S2 x 20no.
- S5 x 22no & S6 x 22no.
- Ligustrum vulgare x 11no.
- S2 x 20no.
- S5 x 19no.
- S3 x 25no.

M1 - Wild Flower Meadow (3grams per 1m) - approx. 3056 sq.m				
Wildflower Meadow Mix				
Species Name	450mm topsoil depth			
Common knapweed - <i>Centaurea nigra</i>				
Ribwort plantain - <i>Plantago lanceolata</i>				
Red clover - <i>Trifolium pratense</i>				
Bird's-foot-trefoil - <i>Lotus corniculatus</i>				
Bulbous buttercup - <i>Ranunculus bulbosus</i>				
Meadow buttercup - <i>Ranunculus acris</i>				
Lady's-bedstraw - <i>Galium verum</i>				
Proposed Shrub Planting - 2908 sq.m				
Code	Species Name	Specification	Plant/m2	No.
P.o.	<i>Prunus</i> 'Otto Luyken'	c/g 3L 30-40cm ht.	3m <sup>2</sup>	1017
L.a.	<i>Lavandula angustifolia</i>	c/g 3L 30-40cm ht.	4m <sup>2</sup>	2395
L.g.	<i>Liberia grandiflora</i>	c/g 3L 30-40cm ht.	3m <sup>2</sup>	1875
C.c.	<i>Cistus corbariensis</i>	c/g 3L 30-40cm ht.	3m <sup>2</sup>	1117
S.c.	<i>Sarcococca confusa</i>	c/g 3L 30-40cm ht.	3m <sup>2</sup>	1803
A.s.	<i>Astelia</i> 'Silver Spear'	c/g 2L 30-40cm ht.	5m <sup>2</sup>	1304
S.s.	<i>Sedum spectabile</i>	c/g 2L 30-40cm ht.	5m <sup>2</sup>	333
Proposed Ground Cover Planting				
Code	Species Name	Specification	Plant/m2	No.
B.c.	<i>Bergenia cordifolia</i>	c/g 2L 30-40cm ht.	5m <sup>2</sup>	721
P.a.	<i>Pericaria affinis</i>	c/g 2L 30-40cm ht.	5m <sup>2</sup>	517
H.n.	<i>Hebeborus niger</i>	c/g 2L 30-40cm ht.	5m <sup>2</sup>	402

Location Plan



REV	DATE	BY	CHECKED	DESCRIPTION
L	18/12/2023	PR	RMD	Compliance
K	21/10/2023	PR	RMD	Compliance
J	16/10/2023	PR	RMD	Compliance
I	13/10/2023	PR	RMD	Compliance
G	10/10/2023	PR	RMD	Compliance
H	28/09/2023	PR	RMD	Compliance
I	22/09/2023	PR	RMD	Compliance
F	16/08/2023	PR	RMD	Compliance
E	07/07/2023	PR	RMD	Compliance

Project Title: Clonburris SDZ at Dublin 22

Client:	Kelland Homes	Dwg No.:	06 LPP
Drawing Title:	Landscape Planting Plan (R)	Scale:	Varies
Job No.:	1577	Date:	12/11/2020

**Ronan MacDiarmada + Associates Ltd.**  
 Landscape Architects and Consultants.  
 5 Tootenhill, Rathcoole, Co. Dublin  
 tel: +353 1 412 4476 mcb: 086 26 25 438  
 fax: +353 1 401 3748 e-mail: ronan@rmda.ie

This Drawing is Copyright ©