

1 RESIDENT'S PAVILION - LEVEL 00 - GROUND FLOOR PLAN
1 : 100

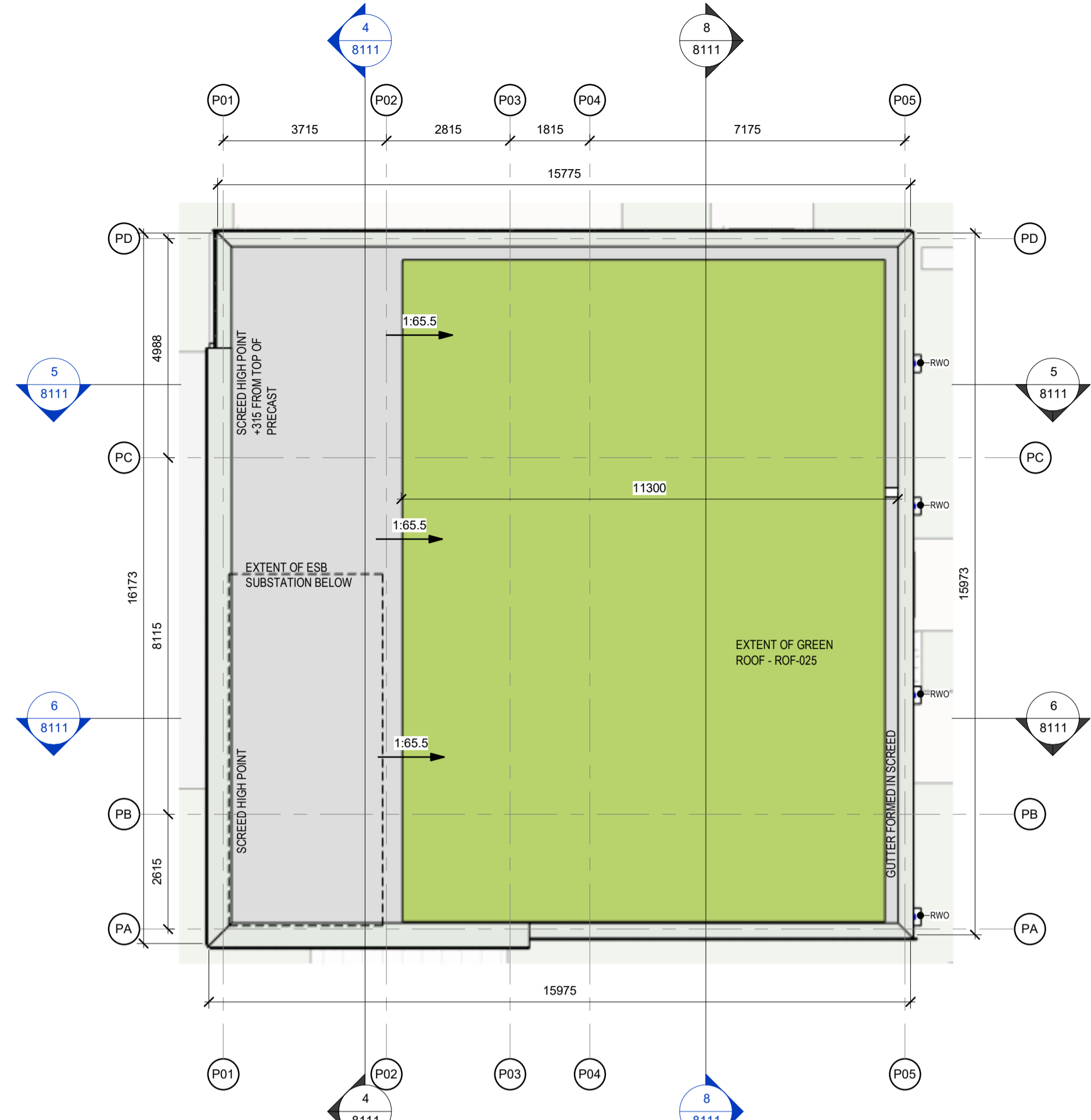

2 RESIDENT'S PAVILION - ROOF PLAN
1 : 100

ALL DIMENSIONS TO BE CHECKED
DIMENSIONS TO BE SCALED FROM THIS DRAWING IS TO BE READ IN CONJUNCTION WITH RELEVANT CONSULTANTS DRAWINGS

SPEC CODE: PAR-116/275mm/45db/60min/M1
ACoustic Rating
FIRE RATING

OVERALL WALL THICKNESS: PAR-102/100mm/42dB/30min/M0
SIDES WITH MOISTURE BOARD
M0 = No Moisture Board
M1 = 1 Side
M2 = 2 Sides

NOTE: "xxx" = Not yet confirmed

INTERNAL WALL TYPE LEGEND

WALL TYPES:

- PAR-102/100mm/42dB/30min/M0
- PAR-104/100mm/42dB/30min/M2
- PAR-106/100mm/42dB/30min/M1
- INTERNAL STRUCTURAL WALL - CONSTRUCTION TYPE T.B.C.

NOTE: SEE DRAWING SERIES 5200 - INTERNAL WALL TYPES FOR MORE INFORMATION ON INTERNAL WALL BUILDUPS
SEE STRUCTURAL ENGINEERS DRAWINGS FOR INFORMATION ON CONCRETE DEPTH WITHIN WALLS. LINER SERVICE VOID VARIABLE TO SUIT CONCRETE DEPTH WITHOUT EFFECTING OVERALL WALL WIDTH.

STANDARD CONCRETE WALLS WITH DUST SEALER FINISH. SEE STRUCTURAL ENGINEERS SPECIFICATION FOR SIZES

RCP LEGEND

- CLG-107 SUSPENDED CEILING - MONOLITHIC SEAMLESS ACOUSTIC (TO ENTRANCE AREAS)
- CLG-150 SUSPENDED GYPSUM BOARD CEILING: 1 LAYER PLASTERBOARD
- CLG-151 SUSPENDED GYPSUM BOARD CEILING: 1 LAYER PLASTERBOARD MOISTURE RESISTANT BOARD IN WET AREAS
- FAC-004 EXTERNAL ALUMINIUM INSULATED SOFFIT LINING PANEL SYSTEM
- WAL-016 120mm FIRE RATED CEILING VOID PARTITION
- BULKHEAD 1 LAYER 12.5 mm PLASTERBOARD ON PROPRIETARY FRAMING
- AFC-103 'PLAIN' IN SITU CONCRETE SOFFIT
- INS-014 EXTERNAL SOFFIT LINER: 180mm ROCKWOOL INSULATION
- PAN-191 CEILING ACCESS HATCH: HATCH TO ACHIEVE SAME FIRE RATING AS CEILING
- RAH-001 ROOF ACCESS HATCH (THERMALLY BROKEN) INCORPORATING LADDER AND TRAPDOOR
- PAN-199 300 x 300 ACOUSTIC ACCESS PANEL NFR

INDICATIVE HORIZONTAL SVP OFFSETS AND BRANCHING. REFER TO CS/OCC DRAWINGS FOR CONSTRUCTION INFORMATION.

SVP PIPE DISCHARGE STACK TO BELOW, 100MM CENTRE POINT COORDINATE ONLY. REFER TO OCC DRAWING FOR DIAMETER ETC

STUB STACK WITH AIR ADMITTANCE VALVE TO BELOW, 110MM CENTRE POINT COORDINATE ONLY. REFER TO OCC DRAWING FOR DIAMETER ETC

SVP PIPE FROM ABOVE, 110MM CENTRE POINT COORDINATE ONLY. REFER TO OCC DRAWING FOR DIAMETER ETC

NOTE:
ALL SVP STACKS TO BE LINED AND BOXED OUT
FOR LOCATIONS OF ELECTRICAL AND MECHANICAL FITTINGS - REFER TO M&E CONSULTANTS DRAWINGS AND SPECIFICATION
REFER TO ARCHITECTURAL SPECIFICATION FOR THE FULL SPECIFICATION ON ALL MATERIAL CODE REFERENCES

Floor Finish Legend

- CON-151
- PNT-046
- RAL: TBC

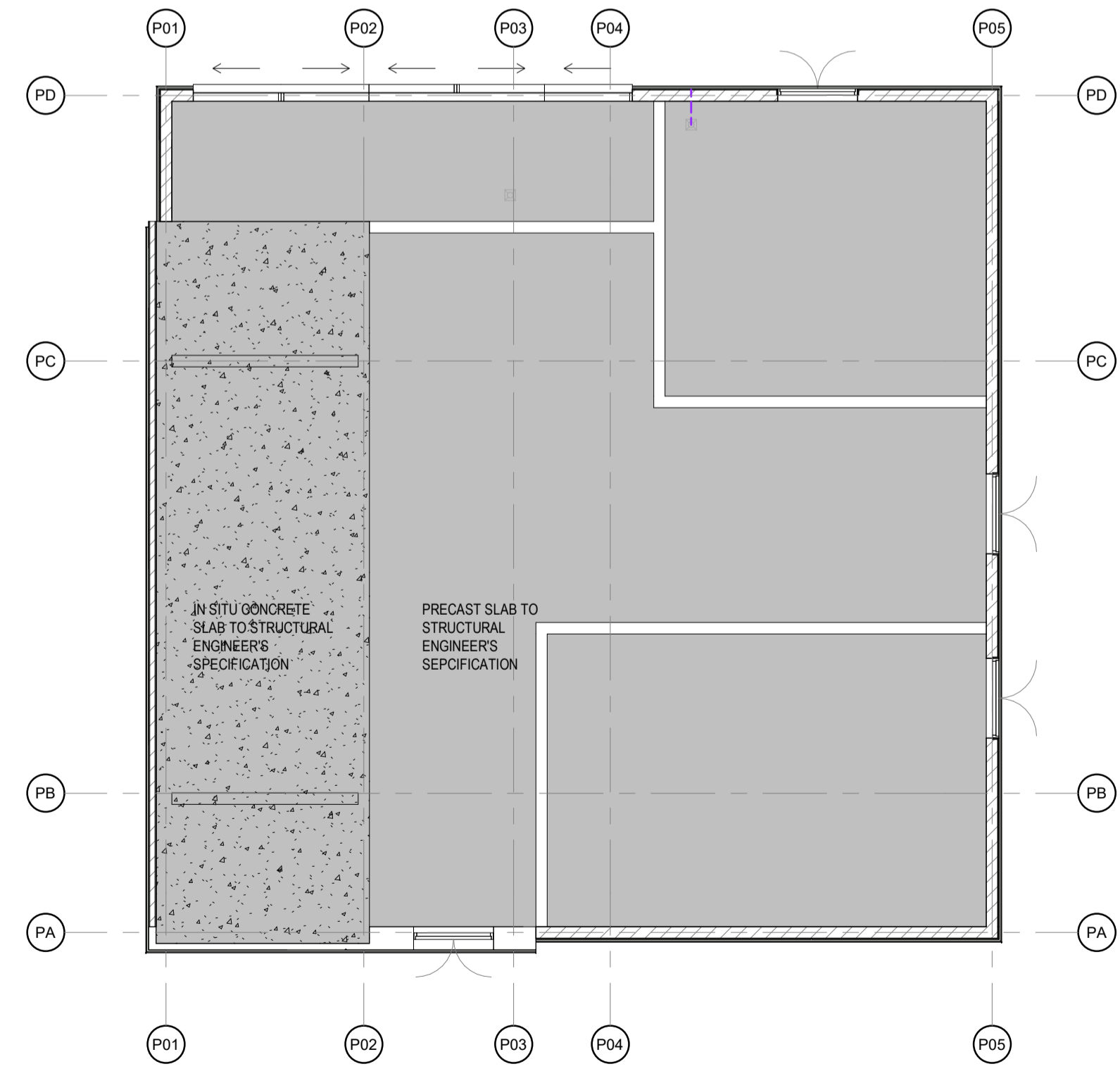

3 RESIDENT'S PAVILION - LEVEL 00 - REFLECTED CEILING PLAN
1 : 100

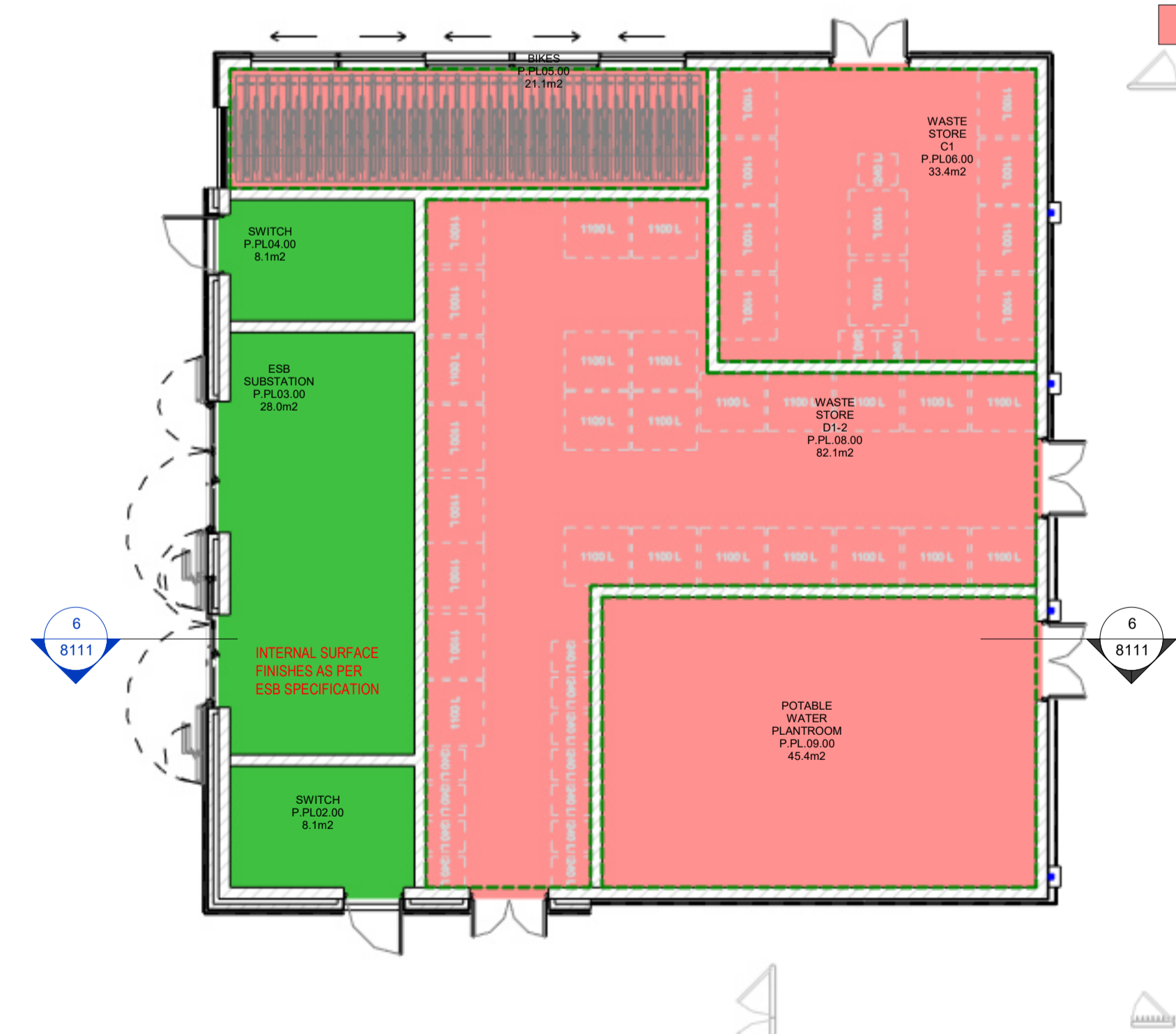

4 RESIDENT'S PAVILION - LEVEL 00 - GROUND FLOOR FINISHES
1 : 100

C02 UPDATE PAVILION BUILDING LAYOUTS & ELEVATIONS

REV	DATE	DESCRIPTION	CKH	DRN
C02	02/10/2023	ISSUED FOR TENDER - ADDENDUM NO. 11	HJL	HJL
C01	25/07/2023	ISSUED FOR TENDER	RJ	RJ

STATUS CODE DESCRIPTION
ISSUED FOR TENDER

CLIENT
QUINTAIN DEVELOPMENTS IRELAND LIMITED

PROJECT
ADAMSTOWN STATION BLOCKS ACD

DRAWING
RESIDENT'S PAVILION - FLOOR PLANS & REFLECTED CEILING PLANS

PROJECT NUMBER: 950747 DATE: 07/25/22

SCALE@ A1: 1:100 DRAWN/CHECKED: RJ/RJ

STATUS CODE: A4 DRAWING NUMBER: ADC3-HJL-D-XX-DR-A-8100 REVISION: C02

COMPLIANCE SUBMISSION
SDZ22A/0005
SDZ23A/0025
23/10/2023

Henry J Lyons
Architecture + Interiors
henryjlyons.com +353 1 888 3333 info@henryjlyons.com 51-54 Pearse Street Dublin D02 KA66