

**DRAWING KEY**

APARTMENT TYPES**			
unit type	No. of beds	No. of storeys	No. of units
Type A1	- 1 bed	1 storey	21
Type A2	- 1 bed	1 storey	10
Type B1	- 2 bed	1 storey	12
Type B2.1	- 2 bed	1 storey	10
Type B2.2	- 2 bed	1 storey	00
Type B3	- 2 bed	1 storey	11
			64

CAR PARKING***		SPACES PROVIDED
Standard car spaces		20
UA car spaces		01
EV charging points		04
		21

BIKE PARKING***		SPACES PROVIDED
Residents	Standard bike spaces	100
	Cargo bike spaces	03
Visitors	Standard bike spaces	24
	Cargo bike spaces	05
		132

**NOTES:**  
 \* Refer to drawings 6268-P-200 to 6268-p-205 for duplex floorplan details  
 \*\* Refer to drawings 6268-P-600 to 6268-P-601 for apartment units floorplan details  
 \*\*\* Refer to drawing 6268-P-008 for parking strategy details

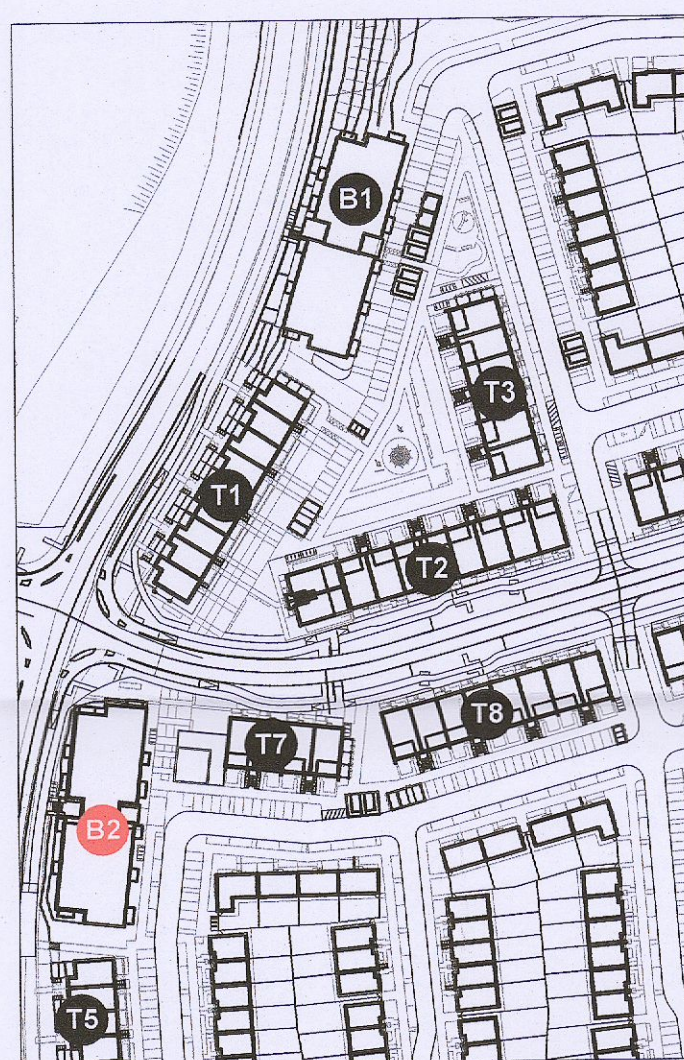

01 Keyplan  
P-306 1:2000



02 Block 02 Level 04 Floor Plan  
P-306 1:200



03 Block 02 Level 05 Floor Plan  
P-306 1:200

- Notes:**
- Copyright Reserved
  - Work to figured dimensions only. Do not scale drawing.
  - The contractor is responsible for checking all levels and dimensions on site and shall refer all discrepancies to the Architect.
  - Where appropriate, for details of r.c. structure, or mechanical and electrical details, see Engineers drawings.
  - Proprietary items shall be fixed in strict accordance with manufacturers instructions.
  - Size of proprietary items shall be checked with manufacturer.
  - The contractor shall be responsible for the coordination of structure, finishes and services.

Issue Status	Progress
Planning Application	■
Fire Cert	
Disability Cert	
Tender	
Construction	
As Built	
Information Only	

No.	Date	Revision	Initials
1	01/11/23	RFI Submission	VB

Project: Adamstown Extension - Clonburris SDZ Residential Development

Drawing Title: Apartment Block 02 - Proposed L04 - L05 floor plans

Drawing No: 6268-P-306

Scale: 1:200@A1 Rev: 00 Drawn: RT Date: 03/10/23

9-7 HARPCOURT TERRACE, DUBLIN 2, IRELAND  
 T: +353-1-618 2400 F: +353-1-676 7386  
 www.bkd.ie  
**bkd architects**  
 BURKE-KENNEY DOYLE