

**DRAWING KEY**

**APARTMENT TYPES\*\***

unit type	No. of beds	No. of storeys	No. of units
Type A1	- 1 bed	1 storey	21
Type A2	- 1 bed	1 storey	10
Type B1	- 2 bed	1 storey	12
Type B2.1	- 2 bed	1 storey	10
Type B2.2	- 2 bed	1 storey	00
Type B3	- 2 bed	1 storey	11
			64

**CAR PARKING\*\*\* SPACES PROVIDED**

Standard car spaces	20
UA car spaces	01
EV charging points	04
	21

**BIKE PARKING\*\*\* SPACES PROVIDED**

Residents	Standard bike spaces	Cargo bike spaces
	100	03
Visitors	Standard bike spaces	Cargo bike spaces
	24	05
	132	

**NOTES:**  
 \* Refer to drawings 6268-P-200 to 6268-p-205 for duplex floorplan details  
 \*\* Refer to drawings 6268-P-600 to 6268-P-601 for apartment units floorplan details  
 \*\*\* Refer to drawing 6268-P-008 for parking strategy details

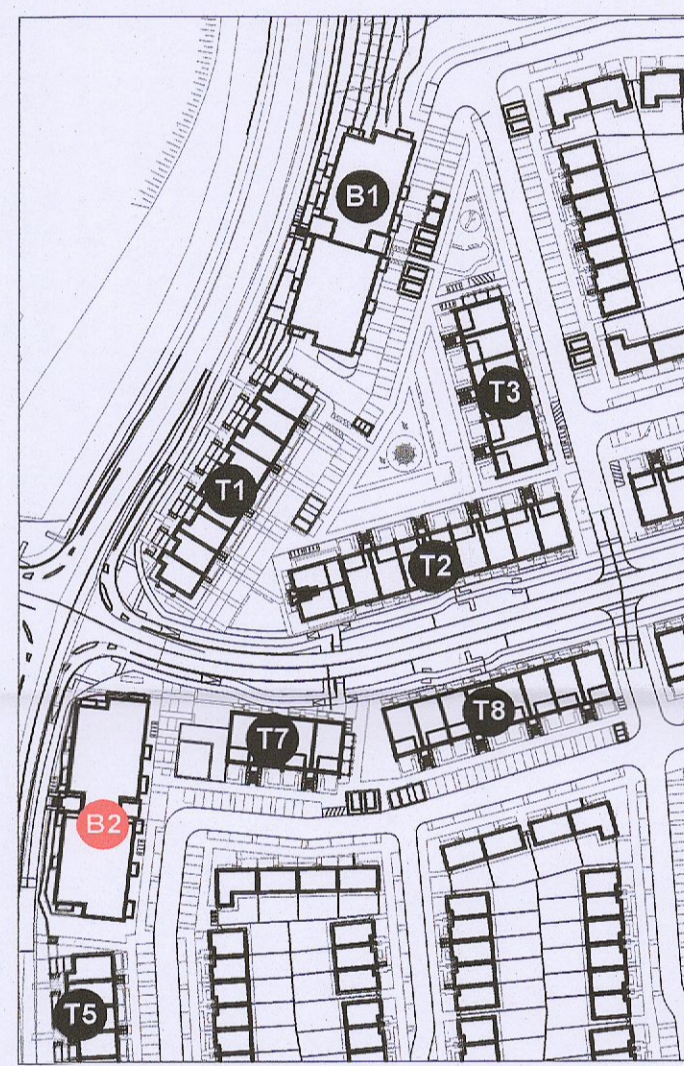

01 Keyplan  
P-305 1:2000

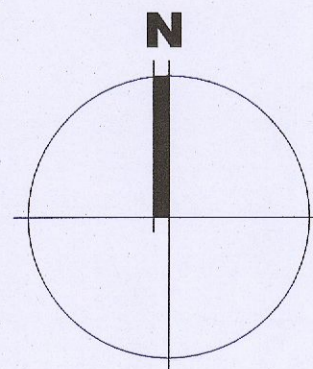

02 Block 02 Level 02 Floor Plan  
P-305 1:200



03 Block 02 Level 03 Floor Plan  
P-305 1:200

**Notes**  
 1. Copyright Reserved  
 2. Work to signed dimensions only. Do not scale drawing.  
 3. The contractor is responsible for checking all levels and dimensions on site and shall refer all discrepancies to the Architect.  
 4. Where appropriate, for details of r.c. structure, or mechanical and electrical details, see Engineers drawings.  
 5. Proprietary items shall be fixed in strict accordance with manufacturers instructions.  
 6. Sizes of proprietary items shall be checked with manufacturer.  
 7. The contractor shall be responsible for the coordination of structure, finishes and services.

**Issue Status**  
 Progress  
 Planning Application  
 Fire Cert  
 Disability Cert  
 Tender  
 Construction  
 As Built  
 Information Only

No.	Date	Revision	Initials
1	01/11/23	R1 Submission	VB

**Project**  
 Adamstown Extension - Clonburris SDZ  
 Residential Development

**Drawing Title**  
 Apartment Block 02 - Proposed L02 - L03 floor plans  
**Drawing No**  
 6268-P-305  
**Scale**  
 1:200@A1  
**Rev**  
 00  
**Drawn**  
 RT  
**Date**  
 03/10/23

6-7 HARCOURT TERRACE, DUBLIN 2, IRELAND  
 t +353-1-618 2400 f +353-1-676 7885  
 www.bkd.ie

**bkd architects**  
 BURKE-KENNEDY DOYLE