

Landscape Planting Plan 1:100 @A1-

Planting Legend:

**SOFT LANDSCAPE** - or similar approved plants - subject to availability.

**Proposed Tree Planting**  
 T1 - Carpinus betulus 'Frans Fontaine' 18-20cm

**Groundcover**  
 - Prunus laurocerasus 'Zabeliana' (300-500mm high) 450mm topsoil depth  
 - Sarcococca hookeriana (300mm - 500mm high) 450mm topsoil depth  
 - Buxus sempervirens (300mm - 500mm high) 450mm topsoil depth  
 - Lavandula 'Hidcote'  
 - Hedera helix Hibernica with bulbs:  
 + Kniphofia royal standard 2L, Agapanthus 2L

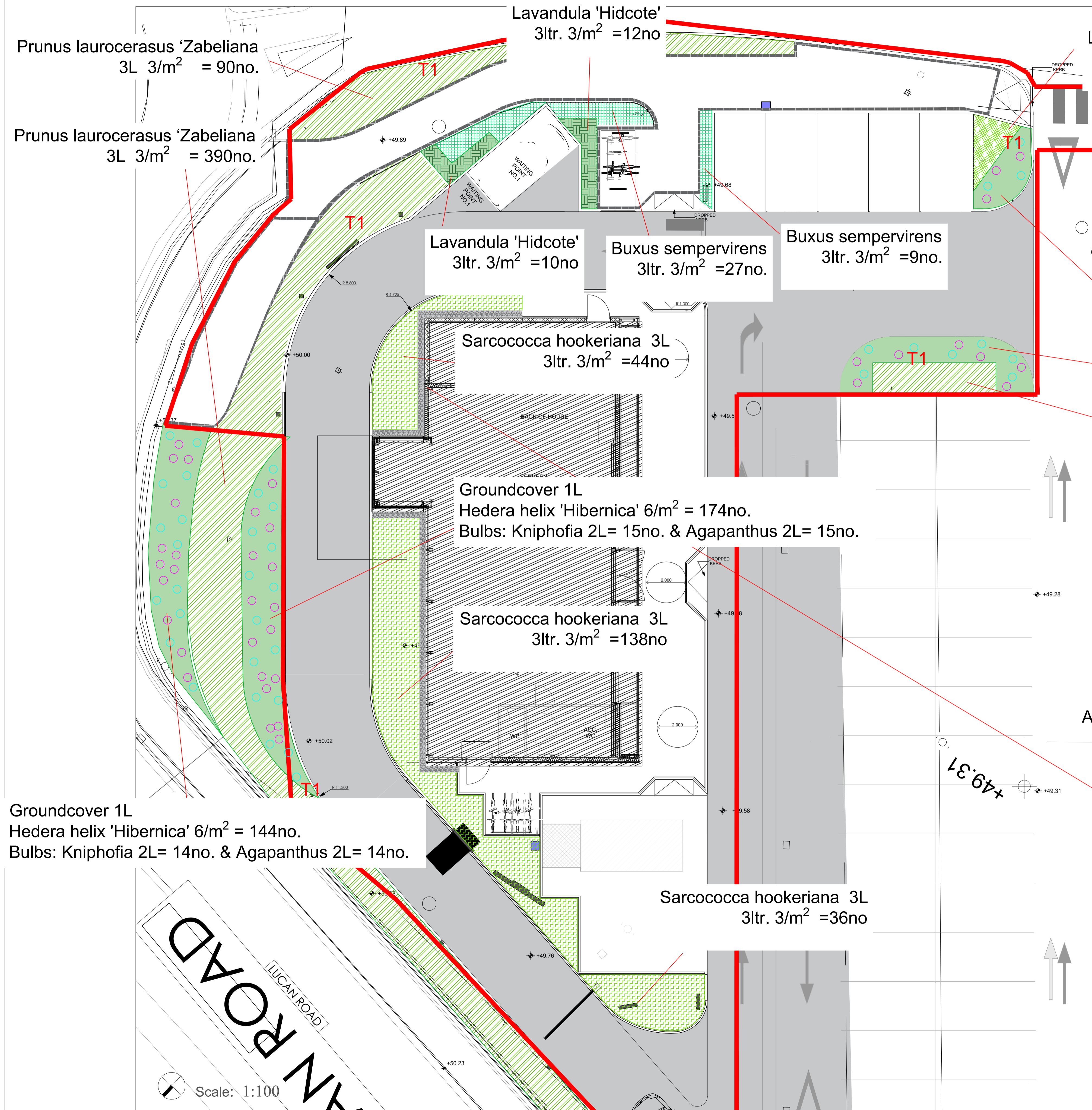

**Groundcover 1L**  
 Hedera helix 'Hibernica' 6/m<sup>2</sup> = 40no.  
 Bulbs: Kniphofia 2L= 3no. & Agapanthus 2L = 3no.  
**Groundcover 1L**  
 Hedera helix 'Hibernica' 6/m<sup>2</sup> = 84no.  
 Bulbs: Kniphofia 2L= 7no. & Agapanthus 2L= 7no.  
**Prunus laurocerasus 'Zabeliana'**  
 3L 3/m<sup>2</sup> = 27no.

**Planting Areas:**

170m<sup>2</sup> - Prunus laurocerasus 'Zabeliana' - 3L 3/m<sup>2</sup>  
 18m<sup>2</sup> - Buxus sempervirens  
 7m<sup>2</sup> - Lavandula 'Hidcote'  
 73m<sup>2</sup> - Sarcococca hookeriana 3L  
 5m<sup>2</sup> - Libertia grandiflora  
 74m<sup>2</sup> - Groundcover 1L Hedera helix 'Hibernica' 6/m<sup>2</sup>  
 Bulbs: Kniphofia 2L & Agapanthus 2L

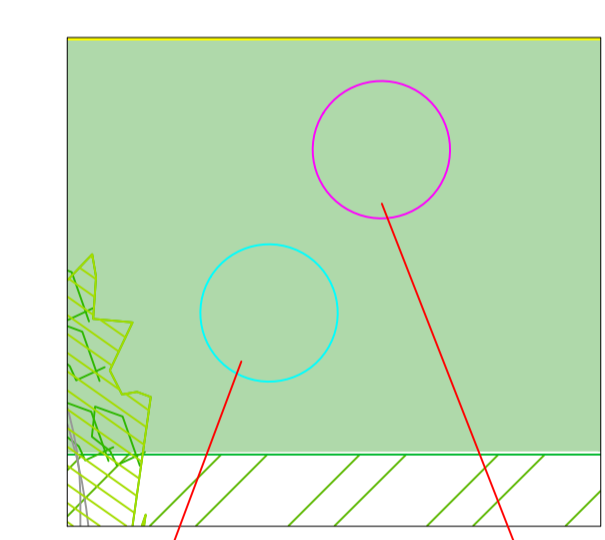

Agapanthus 2L Kniphofia 2L

Gravel Drain

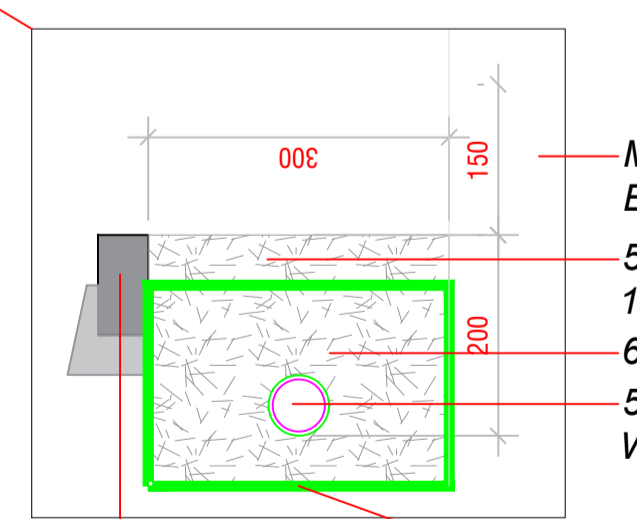

Pin Kerb 150mm x 50mm x 915mm or similar approved.

T1 - Carpinus betulus 'Frans Fontaine' 18-20cm

For Construction

Scale: 1:100

REV	DATE	BY	DESCRIPTION
A	23.02.22	CW	Masterplan
B	03.07.22	CW	Masterplan Update
C	16.08.22	CW	Compliance
D	24.02.23	CW	Construction
E	23.03.23	CW	Update - Planting - Reduced numbers

Project Title: Drive Through Coffee Shop, Lucan Retail Park, Dublin  
 Client: Starbucks  
 Drawing Title: Landscape Planting Plan  
 Job No.: 1677

Dwg. No.: 03  
 Scale: 1:100 @ A1  
 Date: 05.07.2022  
 Drawing By: CW  
 Checked By: RMD

**RMDA**  
 Ronan MacDiarmada + Associates Ltd.  
 Landscape Architects and Consultants.  
 5 Tootenhill, Rathcoole, Co. Dublin  
 tel: +353 1 412 4476 mob: 086 26 25 438  
 fax: +353 1 401 3748 e-mail: ronan@rmda.ie

This drawing is copyright