

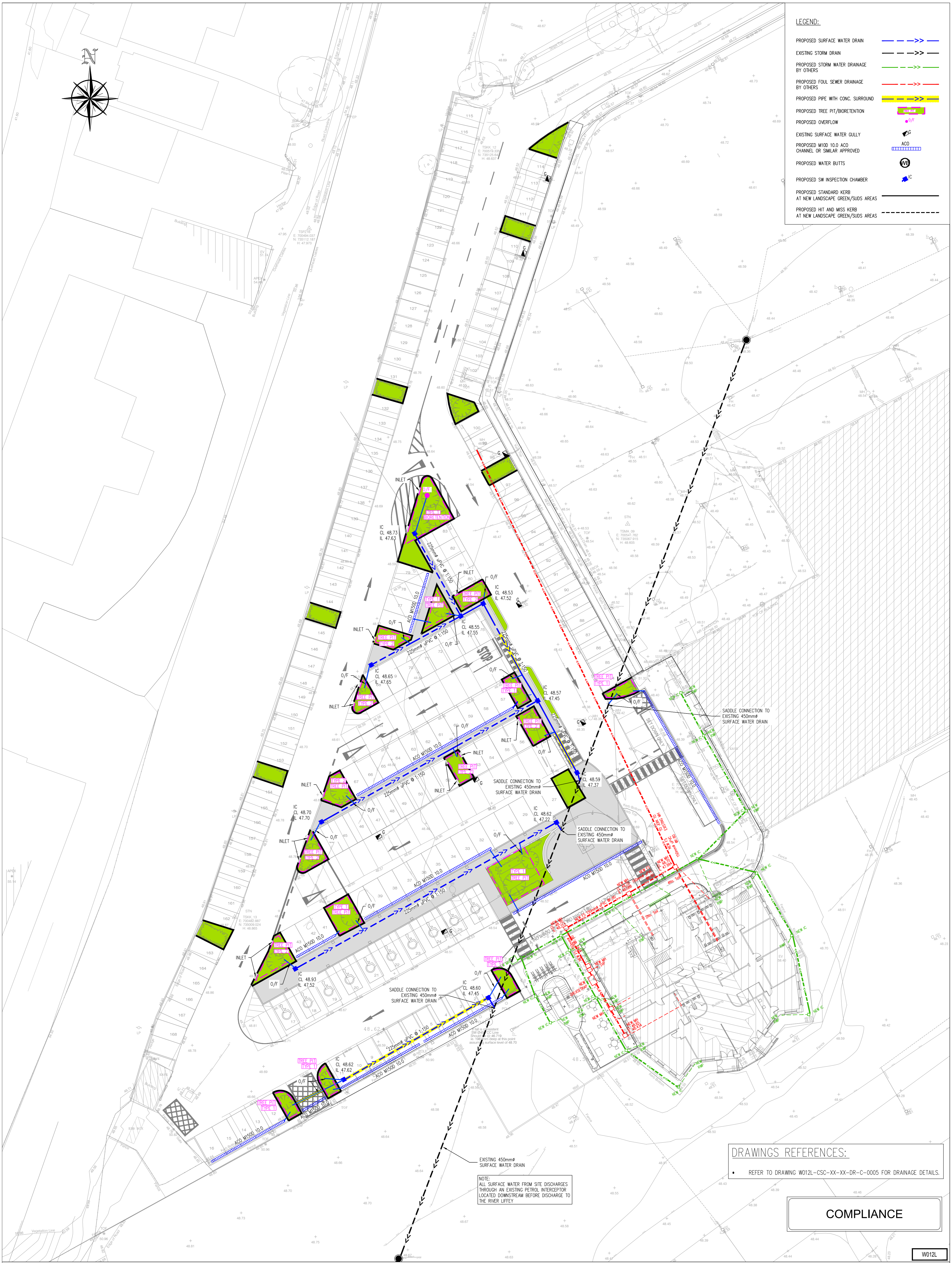

LEGEND:

PROPOSED SURFACE WATER DRAIN	
EXISTING STORM DRAIN	
PROPOSED STORM WATER DRAINAGE BY OTHERS	
PROPOSED FOUL SEWER DRAINAGE BY OTHERS	
PROPOSED PIPE WITH CONC. SURROUND	
PROPOSED TREE PIT/BIORETENTION	
PROPOSED OVERFLOW	
EXISTING SURFACE WATER GULLY	
PROPOSED M100 10.0 ACO CHANNEL OR SIMILAR APPROVED	
PROPOSED WATER BUTTS	
PROPOSED SW INSPECTION CHAMBER	
PROPOSED STANDARD KERB AT NEW LANDSCAPE GREEN/SUDS AREAS	
PROPOSED HIT AND MISS KERB AT NEW LANDSCAPE GREEN/SUDS AREAS	



DRAWINGS REFERENCES:

- REFER TO DRAWING W012L-CSC-XX-XX-DR-C-0005 FOR DRAINAGE DETAILS.

COMPLIANCE

W012L

NOTES

- For setting out refer to Architect's drawings.
- This drawing to be read in conjunction with all other Architectural and Engineering drawings and all other relevant drawings and Specifications.
- DO NOT SCALE THIS DRAWING. Use figured dimensions only.
- No part of this document may be reproduced or transmitted in any form or stored in any retrieval system of any nature without the written permission as copyright holder except as agreed for use on the project for which the document was originally issued.
- Ordnance Survey Ireland Licence Number EN 0074022

Rev. No.	Date	REVISION NOTE	Drn. By	Chkd. By
CP01	07.07.2023	ISSUED FOR COMPLIANCE	JF	SS

Architect	NBK Architects Ltd			
Project	Proposed Extension to Terminal Building and Ancillary Development Works At Weston Airport			
Title	Proposed Drainage Layout Plan			
Dwg. No.	W012L-CSC-ZZ-XX-DR-CP-0003			
Date	July 2023	Drn. By	JF	SS
Scale	1:250 @ A1	Chkd. By	OS	OS
Revision	CP01			

CS Consulting Group
DUBLIN | LONDON | LIMERICK

Head Office
19-22 Dame Street, Dublin 2.
T: +353 (0)1 5480863
e: info@csconsulting.ie
w: www.csconsulting.ie

Quality Environment I.S. EN ISO 9001:2008
Health & Safety I.S. EN ISO 14001:2004
I.S. EN ISO 50001:2011
OHSAS 18001:2007