

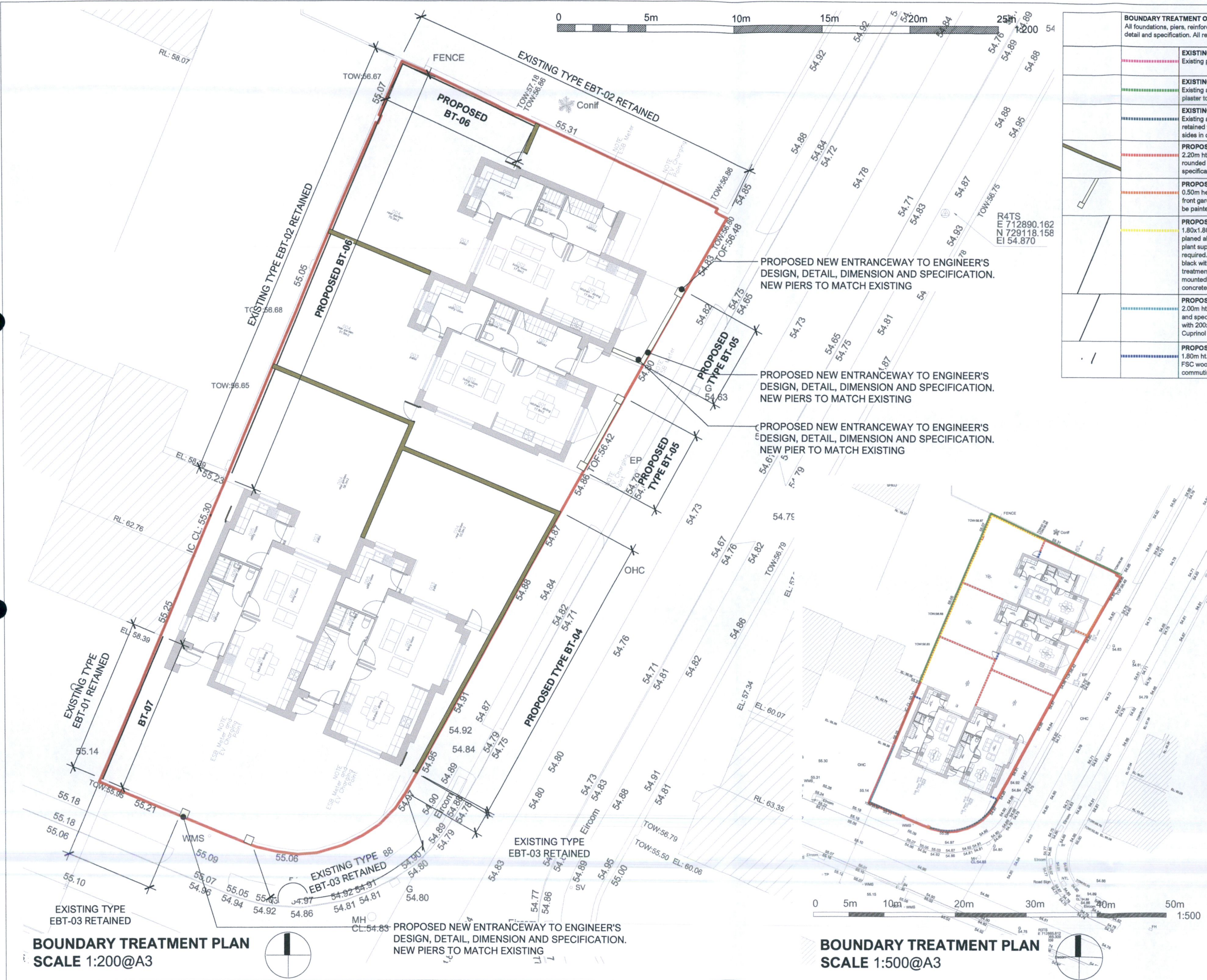

BOUNDARY TREATMENT OUTLINE SPECIFICATION KEY	
All foundations, piers, reinforcing mesh, concrete sub-bases and geotextiles to engineers'/architects' design detail and specification. All retaining walls to engineer's design detail and specification.	
	EXISTING BOUNDARY TREATMENT RETAINED: EBT-01 Existing post-and-rail (2 no. horizontal) painted metal fence (party boundary) retained
	EXISTING BOUNDARY TREATMENT RETAINED: EBT-02 Existing approx 1.6m height concrete block wall (party boundary) retained. Rough-cast plaster to be applied to subject site side of wall and painted olive grey colour
	EXISTING BOUNDARY TREATMENT RETAINED: EBT-03 Existing approx 0.5m height 0.25m width rough-cast wall with rounded capping retained to site boundary in areas indicated on drawing. Wall to be painted on both sides in olive grey colour.
	PROPOSED BOUNDARY TREATMENT: BT-04 2.20m ht. rendered both sides rough-cast concrete blockwork boundary wall with rounded pre-cast concrete capping. Pier spacing to engineer's design detail and specification. Wall to be painted on both sides in olive grey colour
	PROPOSED BOUNDARY TREATMENT: BT-05 0.50m height 0.25m width rough-cast wall with rounded capping where illustrated to front gardens, with end-piers to match existing entrances on Templeville Drive. Wall to be painted on both sides in olive grey colour.
	PROPOSED BOUNDARY TREATMENT: BT-06 1.80x1.80m panel 'Closed Square Trellis Panels' by Woodford or EQA FSC larch slats, planned all round and fully pressure-treated, ideal for use as screening and for climbing plant support. Trellis to be used to provide screening along site boundaries where required. No cut ends to be left exposed and untreated. All wood fencing to be stained black with Cuprinol 'Timbercare' or EQA to create a cohesive appearance in boundary treatments. Base of trellis erected at 1.50m ht off finished ground level and trellis to be mounted to 150x150mm pressure-treated softwood posts fixed with steel feet into concrete foundations.
	PROPOSED BOUNDARY TREATMENT: BT-07 2.00m ht. pressure-treated larch or equivalent FSC fencing to architect's design detail and specification with solid wooden slats, panels to be supported at 1.80m intervals with 200x200mm larch post on steel feet. All wood fencing to be stained black with Cuprinol 'Timbercare' or EQA to create a cohesive appearance in boundary treatments.
	PROPOSED BOUNDARY TREATMENT: BT-08 1.80m ht. FSC wooden panel fence with concrete posts to rear gardens of dwellings. FSC wooden gates to side access footpaths. Provide opes suitable for hedgehog commuting



BOUNDARY TREATMENT PLAN
SCALE 1:200@A3

BOUNDARY TREATMENT PLAN
SCALE 1:500@A3

Additional Information
Planning Ref: SD22A/0466
July 2023



LANDSCAPE ARCHITECTS & CONSULTANTS		
PROJECT: PROPOSED DEVELOPMENT AT TEMPLEVILLE DRIVE, TEMPLEOGUE, DUBLIN SW, CO. DUBLIN		
CLIENT: BARRY & SUSANNE COLEMAN	PROJECT ARCHITECTS: COLIN MACKAY MRIA	
JOB NO. 23_235	PLANNING PERMISSION REF: SD22A/0466	
DRAWING: BOUNDARY TREATMENT PLAN		
DRAWING NO. 23_235-PDFI-06	REVISION: -	FIRST ISSUED: 2023-07-20
DRAWN BY: J COUGHLAN	CHECKED: COLM KENNY	THIS ISSUE: 2023-07-25
STATUS: IN PROGRESS	SCALE: 1:200, 1:500 @ A3	REVISION: -
<small>NOTES: All dimensions are in millimeters unless otherwise stated and shall be checked and confirmed by the contractor on site. Any discrepancies shall be immediately reported to the landscape architects. Work to figured dimensions only. Do not scale from drawing. Not for Construction Purposes unless Specifically Marked. © THIS DRAWING IS COPYRIGHT OF LANDSCAPE DESIGN SERVICES</small>		