

DATE: 12 June 2023
DESIGNER: Patrick Redmond
PROJECT No: 22047
PROJECT NAME: Clonburriss, K1 REV E



Lighting designed to comply with I.S. EN 13201-2:2015 P4, prior to dimming by 25%, with a neutral (4,000K) source, due to the nature of the development. Energy consumption assessed in accordance with I.S. EN 13201-5:2015.

LMF 0.92 x LDF 0.9 x LSF 1 = MF 0.83 at 100,000 hours at 25 degrees ambient. Photometry measured at minimum 15 degree ambient.

Luminaire A, B, & E = 8W. Luminaire C = 5W.
Luminaire D & G = 9W. Luminaire F = 25W.
Luminaire H = 4W. Dimmed load, averaged for CLO.

Light Level ~ Dimmed By 25%

PREPARED BY: Patrick Redmond IEng MILP MSL
Redmond Analytical Management Services Ltd.
M~ 086 2356356
O~ 053 9383696
patrick@redmondams.ie
Rosewood House, Mount Seaton, Camolin,
Enniscorthy, Co. Wexford. Y21 K8P3
www.redmondams.ie
Document control: TD 01 Version: 1.0

Layout Report

General Data

Dimensions in Metres Angles in Degrees

Calculation Grids

ID	Grid Name	X	Y	X' Length	Y' Length	X' Spacing	Y' Spacing
1	Phase 1	2404333.18	732467.63	170.92	204.87	1.50	1.50
2	Phase 1A	2404312.75	732364.32	229.68	102.65	1.49	1.49

Luminaires

Luminaire A Data

Supplier	ASD Lighting
Type	HWD2-#4K08 350-S4-CLO Gen 5
Lamp(s)	LED
LampFlux(klm)/Colour	1.47 4000/72
File Name	HWD2-#4K08 350-S4-CLO (10W).ldt
Maintenance Factor	0.83
Imax70,80,90(cd/klm)	537.8, 42.2, 1.1
No. in Project	27

Luminaire B Data

Supplier	ASD Lighting
Type	HWD2-#4K08 350-S4-CLO Gen 5
Lamp(s)	LED
LampFlux(klm)/Colour	1.47 4000/72
File Name	HWD2-#4K08 350-S4-CLO (10W).ldt
Maintenance Factor	0.83
Imax70,80,90(cd/klm)	537.8, 42.2, 1.1
No. in Project	9

Luminaire C Data

Supplier	ASD Lighting
Type	HWD2-#4K04 400-N3-CLO Gen 5
Lamp(s)	LED
LampFlux(klm)/Colour	0.74 4000/72
File Name	HWD2-#4K04 400-N3-CLO (6W).ldt
Maintenance Factor	0.83
Imax70,80,90(cd/klm)	1101.0, 90.2, 1.0
No. in Project	7

Luminaire D Data

Supplier	ASD Lighting
Type	HWD2-#4K12 300-S8-CLO Gen 5
Lamp(s)	LED
LampFlux(klm)/Colour	1.73 4000/72
File Name	HWD2-#4K12 300-S8-CLO (12W).ldt
Maintenance Factor	0.83
Imax70,80,90(cd/klm)	513.1, 38.5, 0.3
No. in Project	9

Luminaire E Data

Supplier	ASD Lighting
Type	HWD2-#4K08 350-S0-CLO Gen 5
Lamp(s)	LED
LampFlux(klm)/Colour	1.38 4000/72
File Name	HWD2-#4K08 350-S0-CLO (10W).ldt
Maintenance Factor	0.83
Imax70,80,90(cd/klm)	455.1, 52.5, 0.5
No. in Project	4

Luminaire F Data

Supplier	ASD Lighting
Type	HWD2-#4K16 700-M2-CLO Gen 5
Lamp(s)	LED
LampFlux(klm)/Colour	3.95 4000/72
File Name	HWD2-#4K16 700-M2-CLO (33W).ldt
Maintenance Factor	0.83
Imax70,80,90(cd/klm)	846.5, 206.8, 2.0
No. in Project	3

Luminaires

Luminaire G Data

Supplier	ASD Lighting
Type	HWD2-#4K12 300-N3-CLO Gen 5
Lamp(s)	LED
LampFlux(klm)/Colour	1.72 4000/72
File Name	HWD2-#4K12 300-N3-CLO (12W).ldt
Maintenance Factor	0.83
Imax70,80,90(cd/klm)	1194.7, 79.2, 0.6
No. in Project	7

Luminaire H Data

Supplier	ASD Lighting
Type	HWD2-#4K04 200-N4-CLO Gen 5
Lamp(s)	LED
LampFlux(klm)/Colour	0.38 4000/72
File Name	HWD2-#4K04 200-N4-CLO (4W).ldt
Maintenance Factor	0.83
Imax70,80,90(cd/klm)	471.0, 18.0, 0.6
No. in Project	3

Layout

ID	Type	X	Y	Height	Angle	Tilt	Cant	Out-reach	Dimmed to	Target X	Target Y	Target Z
PL 1	B	2404389.38	732497.06	6.00	185.00	0.00	0.00	0.40	75%			
PL 2	A	2404386.72	732527.97	6.00	0.00	0.00	0.00	0.40	75%			
PL 3	A	2404399.92	732535.88	6.00	181.00	0.00	0.00	0.40	75%			
PL 4	A	2404386.10	732550.51	6.00	1.00	0.00	0.00	0.40	75%			
PL 5	A	2404399.24	732556.17	6.00	184.00	0.00	0.00	0.40	75%			
PL 6	A	2404379.32	732573.62	6.00	23.00	0.00	0.00	0.40	75%			
PL 7	A	2404389.34	732585.15	6.00	198.00	0.00	0.00	0.40	75%			
PL 8	A	2404368.82	732605.98	6.00	17.00	0.00	0.00	0.40	75%			
PL 9	A	2404380.79	732608.76	6.00	198.00	0.00	0.00	0.40	75%			
PL 10	A	2404376.56	732634.28	6.00	203.00	0.00	0.00	0.40	75%			
PL 11	A	2404363.62	732637.89	6.00	341.00	0.00	0.00	0.40	75%			
PL 12	A	2404380.17	732647.41	6.00	292.00	0.00	0.00	0.40	75%			
PL 13	A	2404406.91	732657.15	6.00	293.00	0.00	0.00	0.40	75%			
PL 14	A	2404436.93	732657.37	6.00	224.00	0.00	0.00	0.40	75%			
PL 15	A	2404427.52	732649.95	6.00	356.00	0.00	0.00	0.40	75%			
PL 16	D	2404411.66	732527.48	6.00	275.00	0.00	0.00	0.40	75%			
PL 17	D	2404432.53	732528.25	6.00	275.00	0.00	0.00	0.40	75%			
PL 18	A	2404470.70	732521.56	6.00	135.00	0.00	0.00	0.40	75%			
PL 19	F	2404463.16	732547.78	6.00	2.00	0.00	0.00	0.40	75%			
PL 20	A	2404455.64	732570.69	6.00	23.00	0.00	0.00	0.40	75%			
PL 21	A	2404445.21	732599.58	6.00	19.00	0.00	0.00	0.40	75%			
PL 22	A	2404434.61	732628.34	6.00	22.00	0.00	0.00	0.40	75%			
PL 23	A	2404340.35	732489.93	6.00	0.00	0.00	0.00	0.40	75%			
PL 24	A	2404349.92	732501.56	6.00	186.00	0.00	0.00	0.40	75%			
PL 25	B	2404474.88	732504.80	6.00	183.00	0.00	0.00	0.40	75%			
PL 26	F	2404331.77	732410.07	6.00	284.00	0.00	0.00	0.40	75%			
PL 27	F	2404353.35	732417.06	6.00	284.00	0.00	0.00	0.40	75%			
PL 28	C	2404331.15	732390.92	6.00	163.00	0.00	0.00	0.40	75%			
PL 29	C	2404325.55	732375.70	6.00	149.00	0.00	0.00	0.40	75%			
PL 30	A	2404372.41	732421.06	6.00	187.00	0.00	0.00	0.40	75%			
PL 31	A	2404359.85	732431.49	6.00	0.00	0.00	0.00	0.40	75%			
PL 32	A	2404359.31	732452.72	6.00	0.00	0.00	0.00	0.40	75%			
PL 33	D	2404376.12	732454.81	6.00	183.00	0.00	0.00	0.40	75%			
PL 34	G	2404392.95	732448.24	6.00	274.00	0.00	0.00	0.40	75%			
PL 35	E	2404443.16	732427.65	6.00	108.00	0.00	0.00	0.40	75%			
PL 36	E	2404434.83	732450.81	6.00	278.00	0.00	0.00	0.40	75%			

Layout Continued

ID	Type	X	Y	Height	Angle	Tilt	Cant	Out-reach	Dimmed to	Target X	Target Y	Target Z
PL 37	E	2404436.12	732461.73	6.00	7.00	0.00	0.00	0.40	75%			
PL 38	G	2404462.93	732455.68	6.00	286.00	0.00	0.00	0.40	75%			
PL 39	H	2404476.79	732457.59	6.00	284.00	0.00	0.00	0.40	75%			
PL 40	G	2404490.26	732459.82	6.00	278.00	0.00	0.00	0.40	75%			
PL 41	A	2404504.26	732470.75	6.00	11.00	0.00	0.00	0.40	75%			
PL 42	A	2404519.90	732472.43	6.00	190.00	0.00	0.00	0.40	75%			
PL 43	A	2404507.84	732447.34	6.00	15.00	0.00	0.00	0.40	75%			
PL 44	E	2404527.43	732456.70	6.00	238.00	0.00	0.00	0.40	75%			
ML 45	B	2404361.05	732587.99	6.00	291.00	0.00	0.00	0.40	75%			
PL 46	D	2404452.23	732528.95	6.00	275.00	0.00	0.00	0.40	75%			
PL 47	D	2404408.14	732506.73	6.00	5.00	0.00	0.00	0.40	75%			
PL 48	D	2404405.80	732487.53	6.00	4.00	0.00	0.00	0.40	75%			
PL 49	D	2404428.08	732510.95	6.00	94.00	0.00	0.00	0.40	75%			
PL 50	D	2404453.57	732511.95	6.00	93.00	0.00	0.00	0.40	75%			
PL 51	A	2404423.18	732495.03	6.00	180.00	0.00	0.00	0.40	75%			
PL 52	C	2404428.29	732549.84	6.00	114.00	0.00	0.00	0.40	75%			
PL 53	C	2404409.14	732550.67	6.00	290.00	0.00	0.00	0.40	75%			
PL 54	C	2404448.08	732557.69	6.00	274.00	0.00	0.00	0.40	75%			
PL 55	B	2404372.20	732527.28	6.00	275.00	0.00	0.00	0.40	75%			
PL 56	B	2404373.97	732508.46	6.00	271.00	0.00	0.00	0.40	75%			
PL 57	B	2404369.94	732487.42	6.00	272.00	0.00	0.00	0.40	75%			
PL 58	B	2404369.94	732487.81	6.00	91.00	0.00	0.00	0.40	75%			
PL 59	B	2404373.95	732509.04	6.00	89.00	0.00	0.00	0.40	75%			
PL 60	B	2404356.45	732520.12	6.00	5.00	0.00	0.00	0.40	75%			
PL 61	C	2404393.68	732486.50	6.00	271.00	0.00	0.00	0.40	75%			
PL 62	D	2404400.42	732514.67	6.00	95.00	0.00	0.00	0.40	75%			
PL 63	H	2404428.07	732510.58	6.00	273.00	0.00	0.00	0.40	75%			
PL 64	H	2404453.59	732511.57	6.00	273.00	0.00	0.00	0.40	75%			
PL 65	G	2404419.87	732449.85	6.00	273.00	0.00	0.00	0.40	75%			
PL 66	C	2404387.13	732417.32	6.00	97.00	0.00	0.00	0.40	75%			
PL 67	G	2404414.78	732425.09	6.00	95.00	0.00	0.00	0.40	75%			
PL 68	G	2404465.15	732437.05	6.00	101.00	0.00	0.00	0.40	75%			
PL 69	G	2404494.22	732446.71	6.00	102.00	0.00	0.00	0.40	75%			

Horizontal Illuminance (lux)

Phase 1



Results

Eav	4.03
Emin	0.81
Emax	12.67
Emin/Emax	0.06
Emin/Eav	0.20

Horizontal Illuminance (lux)

Phase 1A

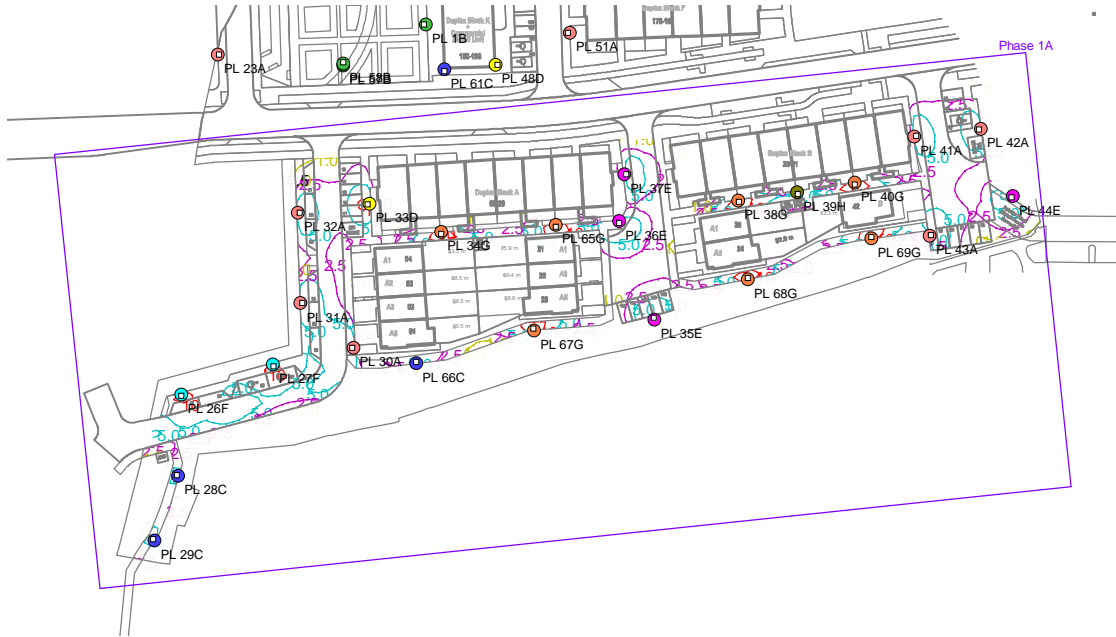

Results

Eav	4.34
Emin	0.88
Emax	12.30
Emin/Emax	0.07
Emin/Eav	0.20