

1. This drawing is the property of ALTU Architects Ltd. It must not be copied or given to a third party without the permission of ALTU Architects Ltd.
2. Work to figured dimensions only. Do not scale the drawing.
3. The contractor is responsible for checking all dimensions and levels on site and shall refer all discrepancies to the Project Architect.
4. Drawings to be read in conjunction with all relevant engineers drawings. Mechanical and electrical, any structural or services information shown on this drawing is indicative only.
5. The contractor shall be responsible for the coordination of all structure, services and finishes.
6. Proprietary items shall be fixed in strict accordance with manufacturers instructions.
7. This drawing shall only be used for the work stage as denoted and no subsequent stage.

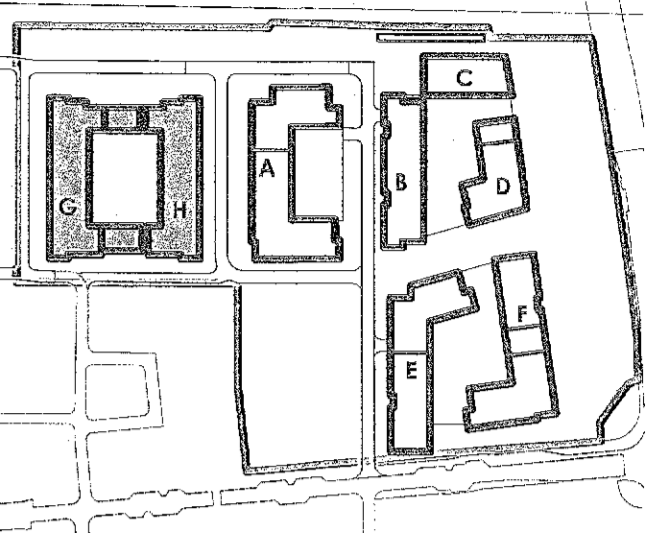

KEY PLAN G,H

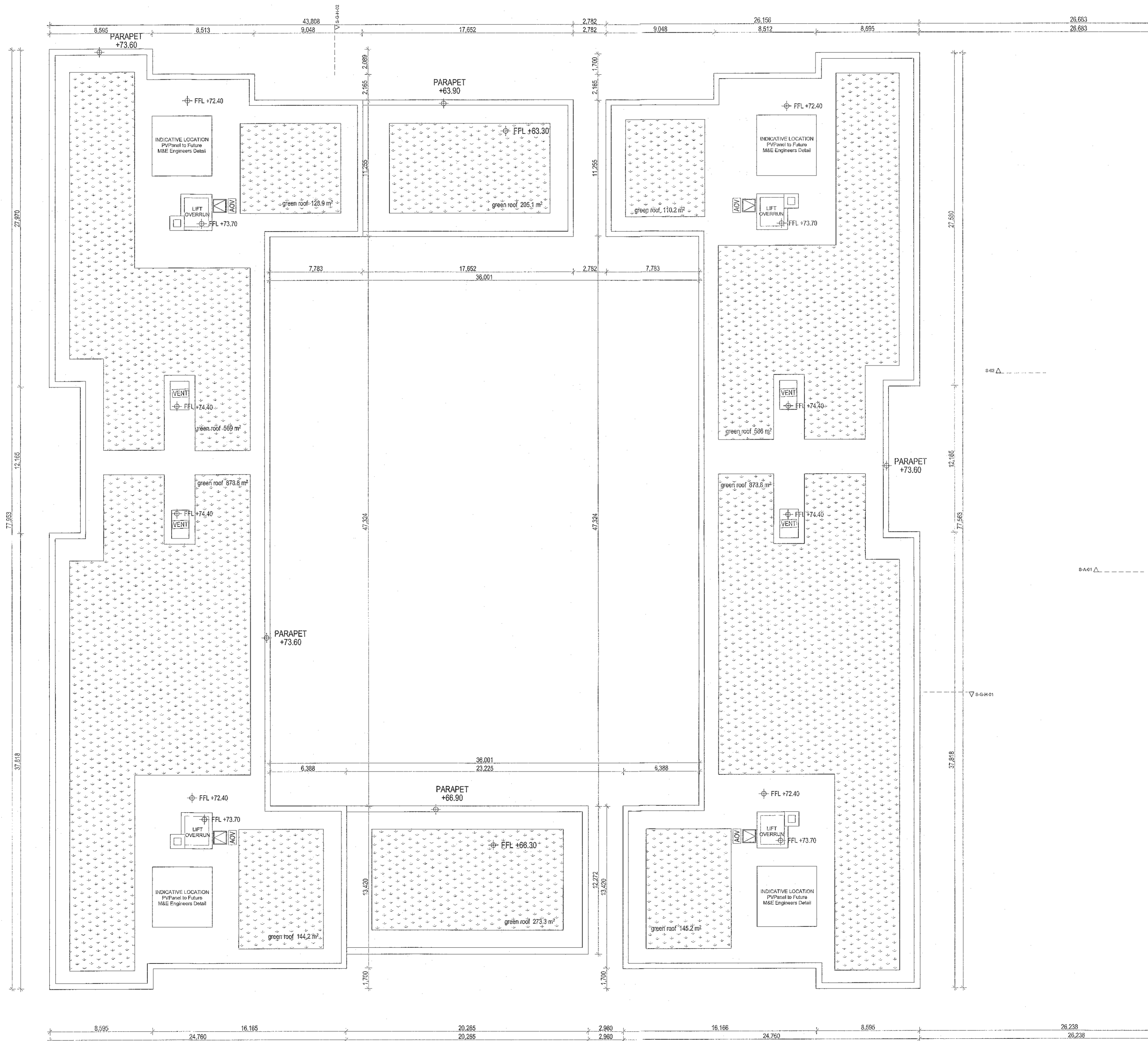
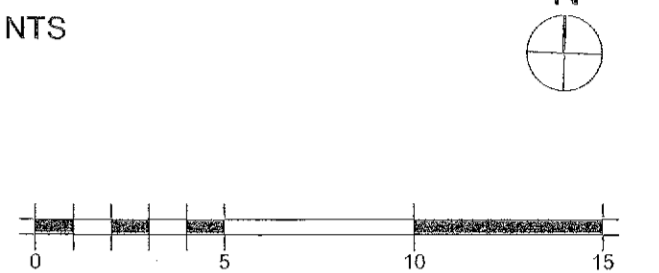

Rev	Date	Description	Issued by	Checked by

**ALTU** Architects  
 115C Camden Street Lower  
 Dublin 7  
 T: +353 (0)1 254 6998  
 E: info@altuarchitects.ie  
 W: altuarchitects.ie

**PLANNING FI**

Client:  
Cain Homes Properties Ltd

Project:  
Clonburris T2

Drawing:  
Block G, H - Roof Plan

Job No.	Date & At	Scale	Revision
21042	1200		

C'B - ALT - 0 - DR - A - P130