

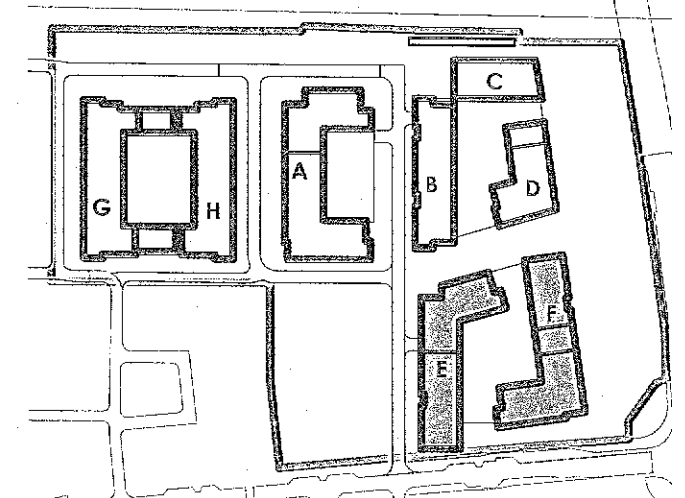

1. This drawing is the property of Altu Architects and shall not be copied or given to a third party without the permission of Altu Architects Ltd.
2. Work to be carried out on site shall be in accordance with the drawing.
3. The contractor is responsible for checking all dimensions and levels on site and shall refer all discrepancies to the Architect.
4. Drawings to be read in conjunction with all relevant engineering drawings, Mechanical and electrical, any structural or services information shown on this drawing is indicative only.
5. The contractor shall be responsible for the coordination of all structure, services and finishes.
6. Proprietary items shall be fixed in strict accordance with manufacturers instructions.
7. This drawing shall only be used for the work stage as detailed and no subsequent stages.

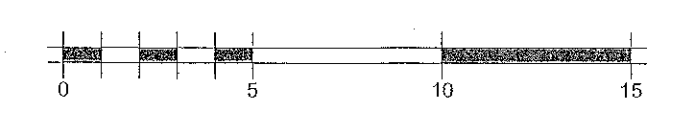

KEY PLAN E, F
NTS



No.	Date	Description	Issued By	Checked By

ALTU

ALTU Architects
84/85 Camden Street Lower
Dublin 2
T: +353 (0) 1 254 6995
E: info@altuarchitects.ie
W: altuarchitects.ie

PLANNING F I

Client: **Caim Homes Properties Ltd**

Project: **Clonburris T2**

Drawing: **Block E, F - Fourth Floor**

Job No.	Scale	Date	Drawn	Checked	Approved
21042	1:200	2024-08-08			

C/B - ALT - - 0 - DR - A - P22