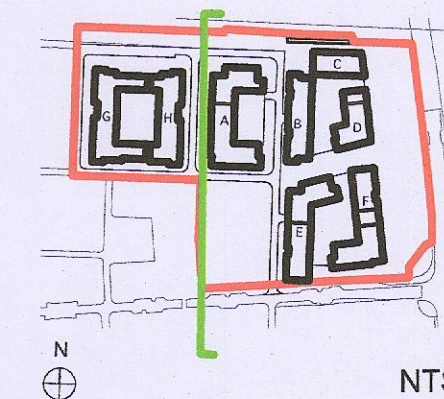
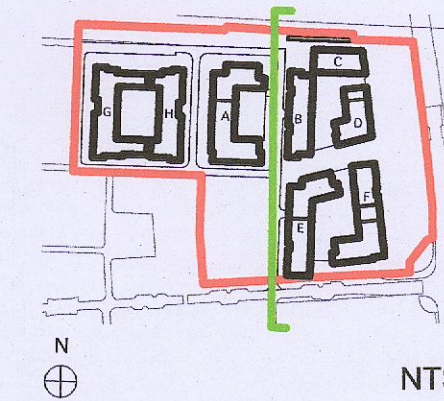
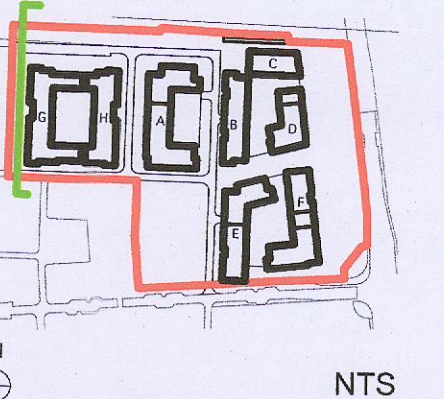
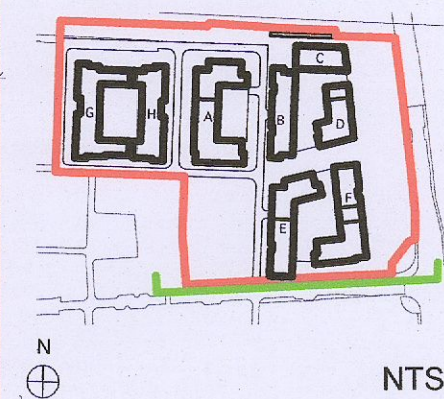
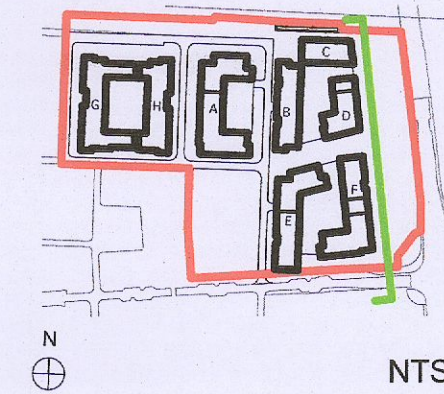
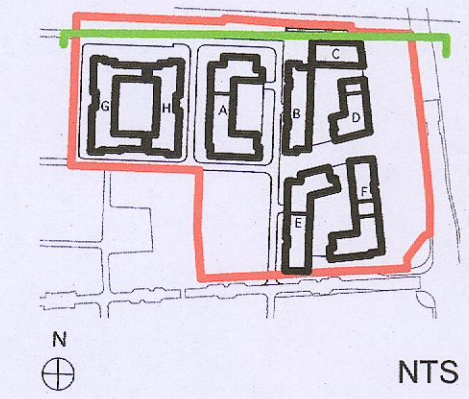

1. This drawing is the property of Altu Architects Ltd. It must not be copied or given to a third party without the permission of Altu Architects Ltd.
2. Work to figured dimensions only. Do not scale the drawing.
3. The contractor is responsible for checking all dimensions and levels on site and shall refer all discrepancies to the Project Architect.
4. Drawings to be read in conjunction with all relevant engineers drawings, Mechanical and electrical, any structural or services information shown on this drawing is indicative only.
5. The contractor shall be responsible for the coordination of all structure, services and finishes.
6. Proprietary items shall be fixed in strict accordance with manufacturers instructions.
7. This drawing shall only be used for the work stage as denoted and no subsequent stage.

[illegible]

ALTU

ALTU Architects
14/15 Camden Street Lower
Dublin 2
T: +353 (0) 1 254 6996
E: info@altuarchitects.ie
W: altuarchitects.ie

PLANNING FI

| | | | | | |
|----------------------------|--------------|------|-------|--------|------------|
| Client | | | | | |
| Cairn Homes Properties Ltd | | | | | |
| Project | | | | | |
| Clonburris T2 | | | | | |
| Drawing | | | | | |
| Contextual Elements | | | | | |
| Job No | Scale of A1 | | | Status | Revision |
| 21042 | 1:500 | | | | |
| project | introduction | note | level | type | discipline |
| C18 | ALT | - | 0 | DR | A - P105 |