

Tree Pit and Stake Detail
Rootballed Tree
Scale 1:20

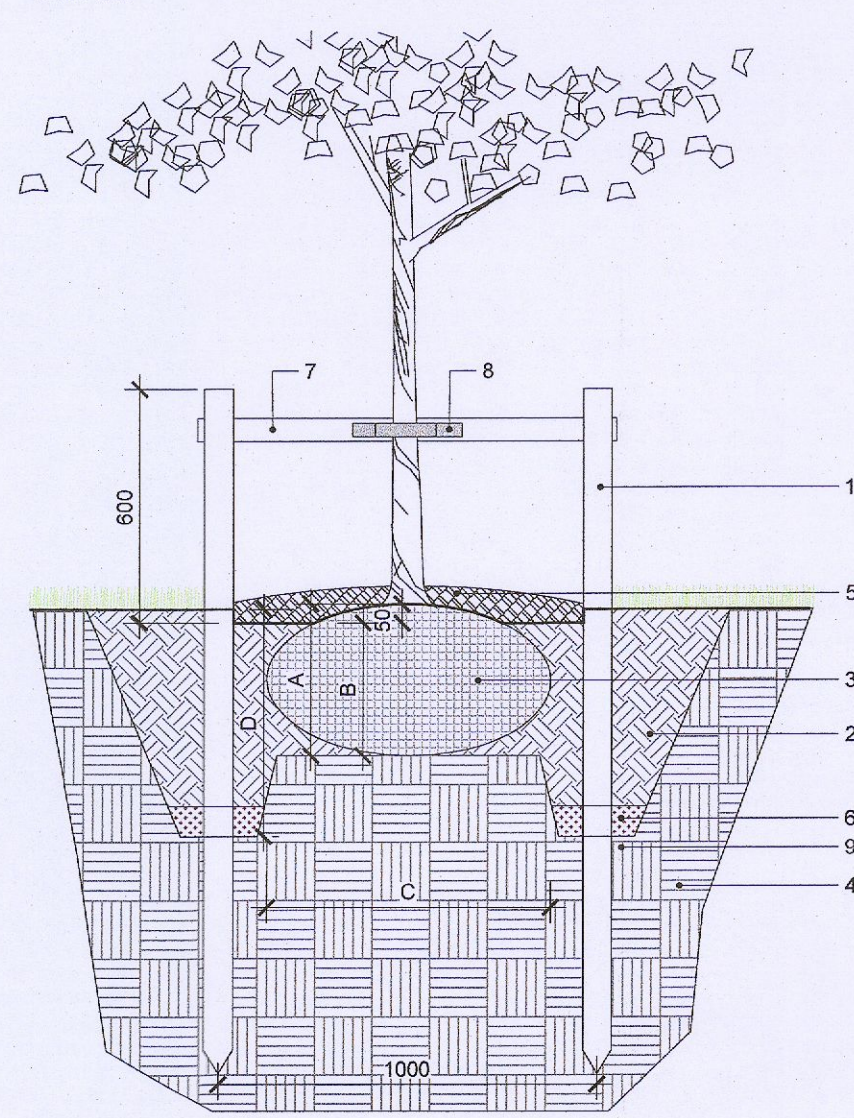

1. Round stake 1.8m long, 75mm diameter; Good quality topsoil to BS 3882 and slow release fertiliser (e.g. Sierrablen Flora &/or similar and approved). To include 7.5% Biochar by volume, 7.5% compost.
 2. Tree rootball;
 3. Free Draining Subsoil (to proposed levels and falls);
 4. Bark mulch, 75mm depth;
 5. 80mm layer of farmyard manure or a suitable compost material as approved;
 6. Crossbar - securely fixed to stakes;
 7. Adjustable tree tie - securely fixed to crossbar;
 8. Loosened subsoil, base and sides broken up.
- Dimensions:
A - Rootball depth
B - Rootball depth minus 50mm
C - Rootball diameter
D - Rootball depth plus 200mm

Planting Detail- Hedge, Shrubs & Perennials
All Levels
Scale 1:20

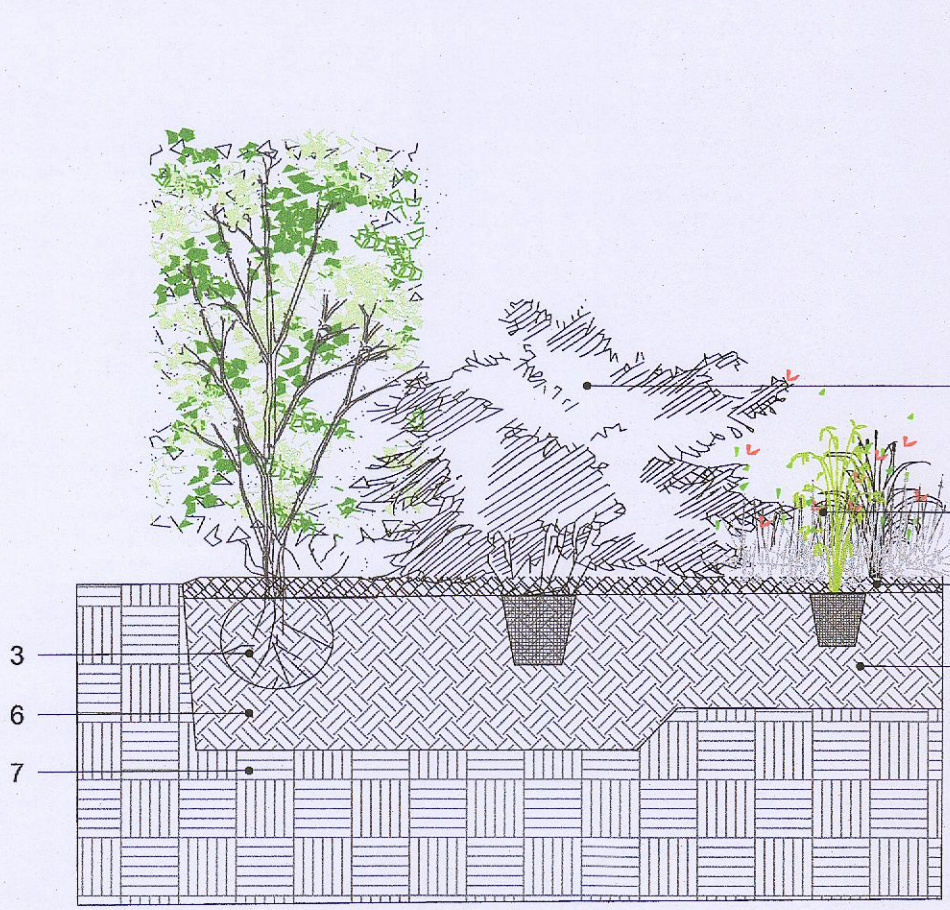

1. Good quality multi-purpose topsoil to depths as shown and in accordance with BS 3882 (perennials min 300mm, shrubs min 450mm), top of soil level to be 75mm below top of kerb to contain bark mulch (e.g. Sierrablen Flora or similar and approved)
2. Bark mulch to 75mm
3. Root Ball Hedge
4. Shrub planting
5. Perennial planting
6. Loosened subsoil, base and sides broken up
7. Subsoil

Stormwater tree pit
Typical Detail
Scale 1:20

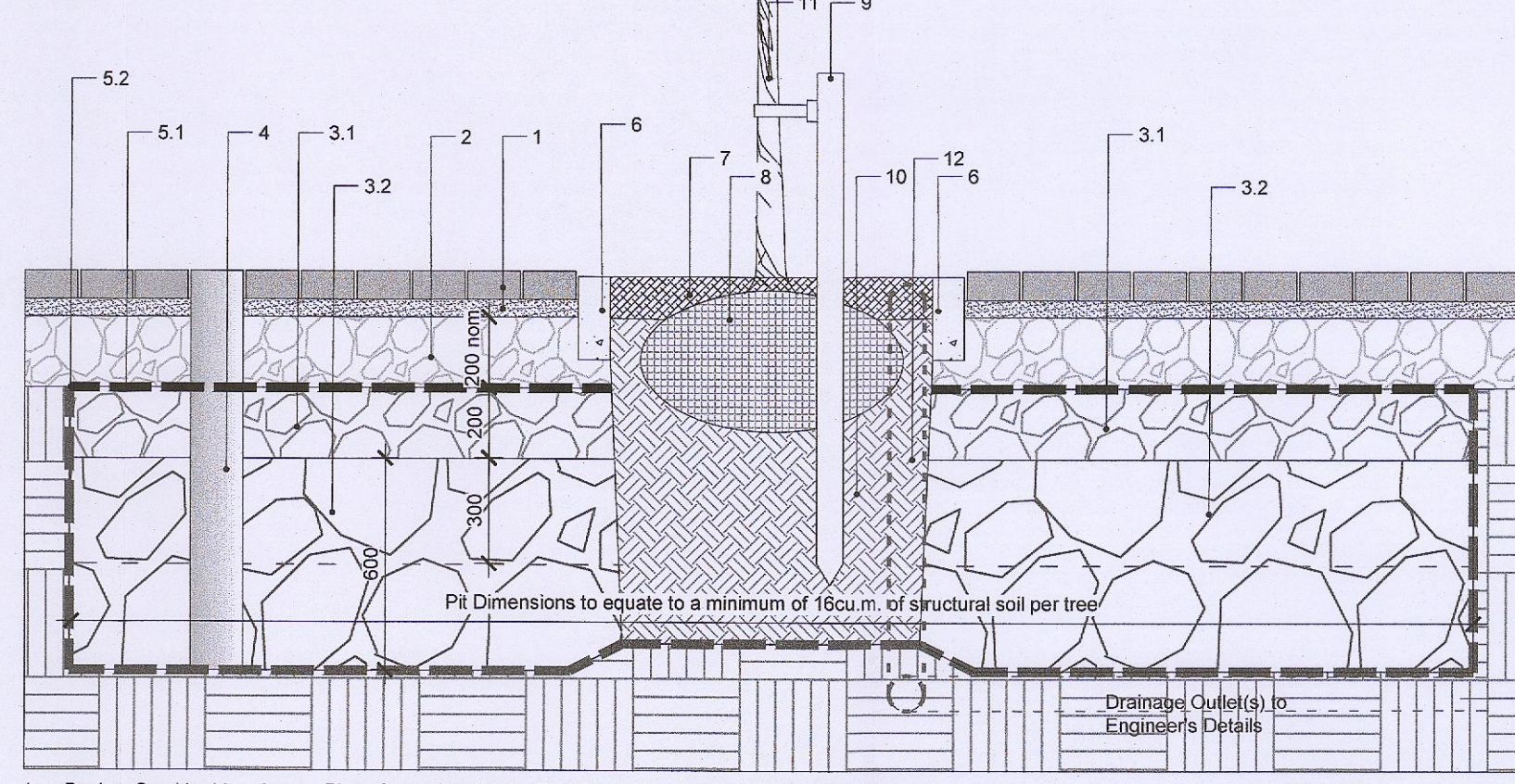

1. Paving: See Hard Landscape Plans for paving details. Bedding and build-up to Engineer's detail.
2. Stone buildup to Engineer's detail.
3. STRUCTURAL SOIL
3.1. Top Layer Structural soil - blend to be formed from 37-63mm clean stone (clause 505). To include 7.5% Biochar by volume, 7.5% compost.
3.2. Base Attenuation Layer Structural soil - blend to be formed from 120/150mm stone mix. Compact in two 300mm layers. To include 7.5% Biochar by volume, 7.5% compost.
NOTE: Biochar and compost can be pre-mixed into stone mix (blended onsite or sourced from Enrich or similar) or may be washed in after laying of each layer.
4. Aeration well / shaft formed from 100mm dia. perforated pipe with stainless steel heel-safe cover flush with ground level 100mm dia. x 6mm deep by Kent Stainless or equal; 50% free area. 1no. per 10sq.m surface area or 1no. per tree minimum.
5. Geotextiles:
5.1. Terram Rootguard geotextile or equal permeable root barrier to top of structural soil.
5.2. Standard permeable nonwoven geotextile fleece to base and/or other sides of pit - only if required, depends on subgrade.
6. Kerb
7. Bark mulch, 50-75mm depth.
8. Tree rootball (nominal).
9. Round stake 1.8m long, 75mm diameter, with crossbar and adjustable tree tie.
10. Good quality topsoil to BS 3882:2015 and slow release fertiliser (e.g. Sierrablen Flora or similar and approved). Min. 800mm for tree planting. To include 7.5% Biochar by volume, 7.5% compost.
11. Tree as per landscape plan.
12. 100mm dia. perforated pipe - overflow stack & outlet to stormwater drain to Engineer's detail. IL max. 250mm from top of structural soil.

Concrete and kerb with road
Typical detail
Scale 1:20

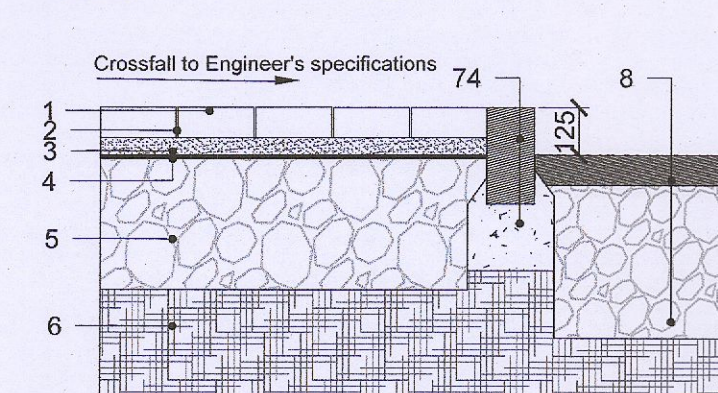

1. Permeable paving
2. 5mm joints with sand
3. Compacted sandstone grit laying course
4. Geotextile layer (bottom layer required when paving is within 5m of building).
5. Well compacted class 804 stone to falls/crossfalls required
6. Well compacted sub grade to appropriate level & profile to engineers approval.
6. Pre-cast concrete kerb, 125mm height difference from road FFL (specifications and build-up as per engineer's specifications).
7. Asphalt Road surfacing. (as per engineer's specifications).

Gravel Surface with steel edge
Typical detail
Scale 1:20

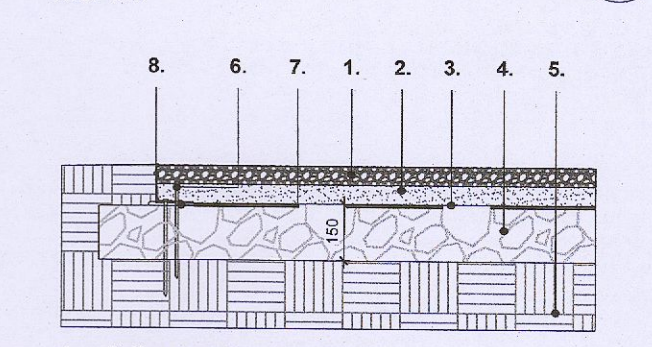

1. Self compacting gravel surface
2. Coarse sand compacted;
3. Geotextile membrane
4. Well compacted Sub-Base, as per appointed Engineer's details and specifications.
5. Well compacted sub grade;
6. Steel spiral Fixing Stake at regular intervals.
7. Sharp sand & cement base to raise and level.
8. 100mm Edging

Grass Protection Mesh
Typical Detail
Scale 1:10

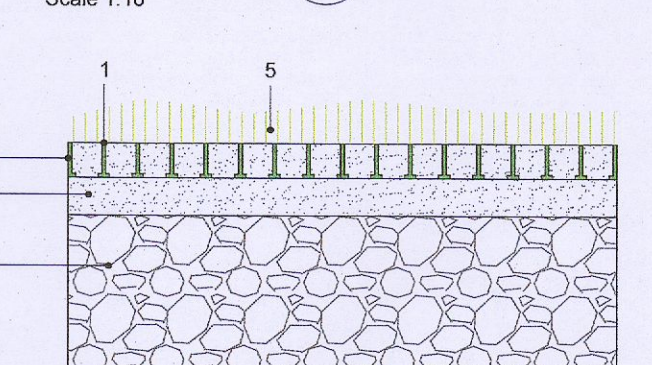

1. Grass protection mesh, ProGrass as supplied by Rätter or similar approved. Panel size (LxWxH) 500x350x45mm.
2. Substrate mixture, to include sand and good quality topsoil in accordance with BS 3882:2015.
3. Installation bed to include a gravel/sand mixture of 5-11mm, mixed with fertiliser in equal parts. The mixture to be water permeable, with a stable structure to offer a good root establishment.
4. Base course in accordance with ZTVT-Stb 86 directive. Base course to consist of a gravel layer with a depth of at least 20 cm consisting of gravel sand 0/32 mm, topped by a gravel base course 0/45 mm with a depth of at least 15 cm.
5. Amenity grass, to be seeded in substrate mixture as described in item 2.

Acoustic & Marginal Pond Planting
Typical detail
Scale 1:20

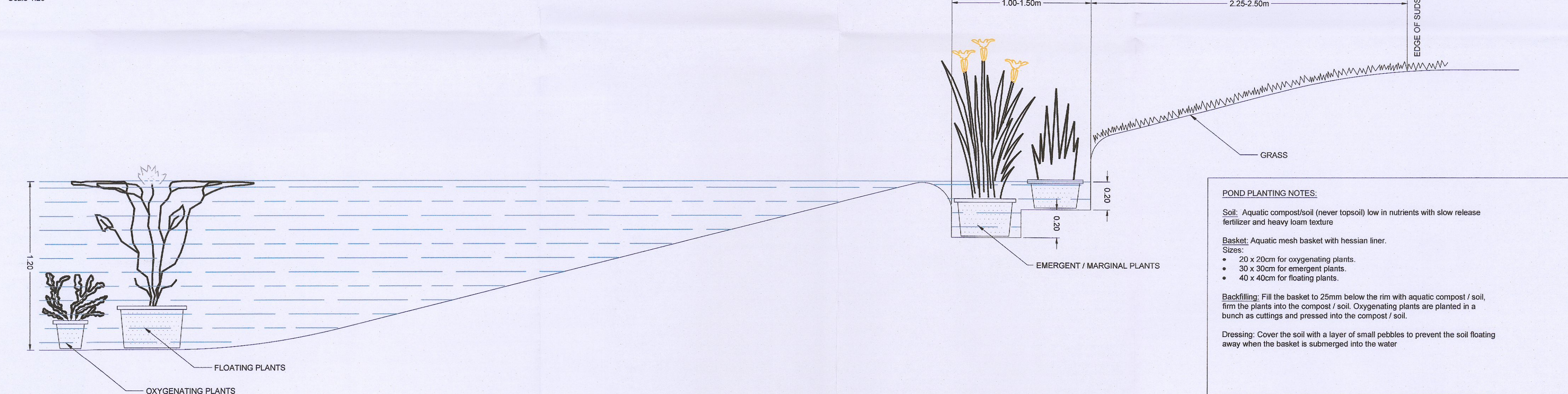

- POND PLANTING NOTES:**
- Soil: Aquatic compost/soil (never topsoil) low in nutrients with slow release fertilizer and heavy loam texture
- Basket: Aquatic mesh basket with hessian liner.
- Sizes:
- 20 x 20cm for oxygenating plants.
 - 30 x 30cm for emergent plants.
 - 40 x 40cm for floating plants.
- Backfilling: Fill the basket to 25mm below the rim with aquatic compost / soil, firm the plants into the compost / soil. Oxygenating plants are planted in a bunch as cuttings and pressed into the compost / soil.
- Dressing: Cover the soil with a layer of small pebbles to prevent the soil floating away when the basket is submerged into the water

Traditional Burial headstone
Typical Detail
Scale 1:10

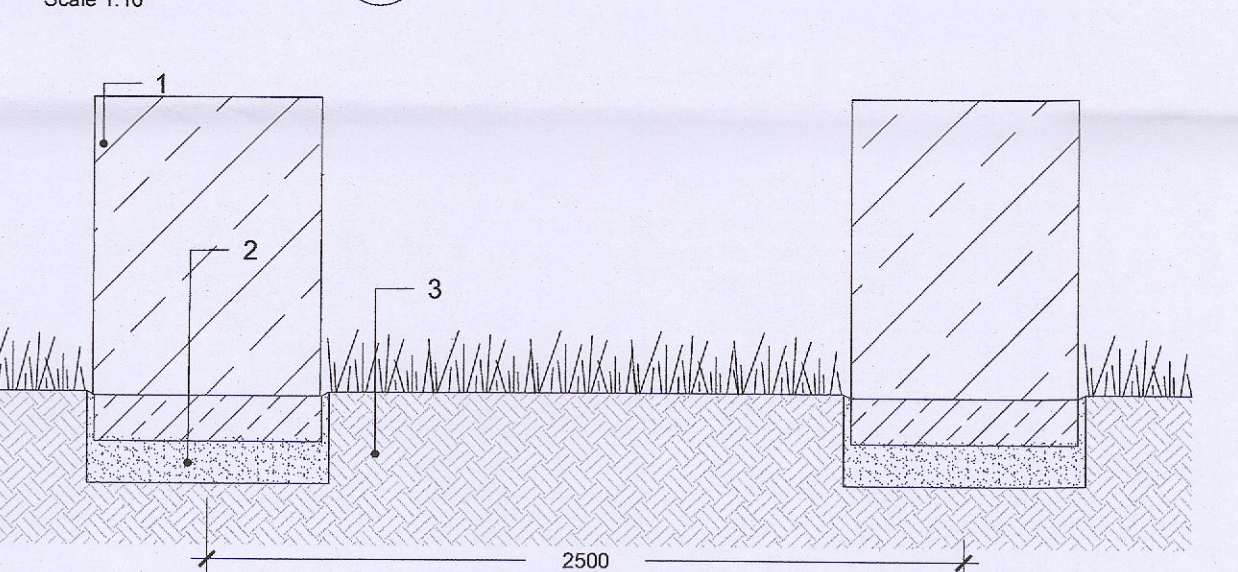

1. Nature Stone headstone, Dim TBD, polished, colour TBD
2. 2.5m on center space between each row (3.44 metre clear of ground water)
3. 60mm - Compacted coarse sand 6mm
3. Subsoil

Columbarium wall
Typical Detail
Scale 1:50

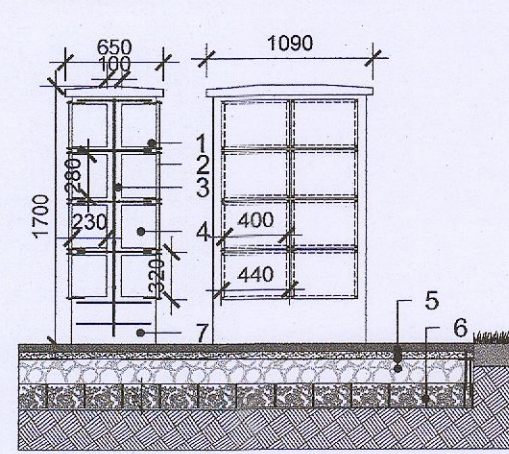

1. Nature Stone Capping, polished, colour TBD.
2. Natural stone doors, with peg attachments.
3. Concrete structure with 12mm rebar, finish to match building, details and spec to be provided by engineer.
4. Niche, for two urns. Size 400mm width x 280mm height x 230mm depth.
5. Gravel detail
6. No-Dig Geogrid system.
7. Base for stability to engineer's details

Entrance wall
Typical Detail
Scale 1:50

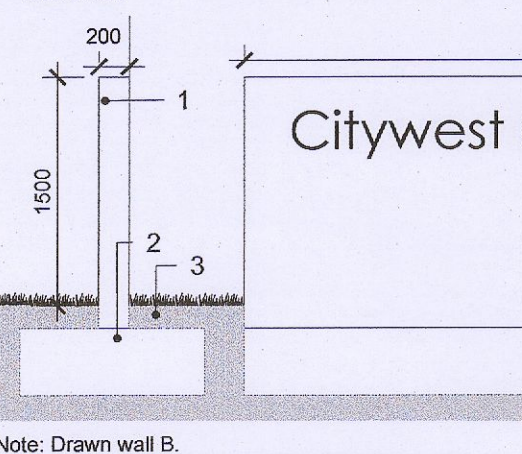

- Note: Drawn wall B.
1. Concrete blade wall, Finish to match building
 1. Wall A. Dim 200 x 3000mm x 2000mm.
 2. Wall B. Dim 200 x 5000 x 1500mm. With Engraved text.
 2. Wall C. Dim 200 x 5000 x 1500mm
 2. Foundations to engineer's specification.
 3. Subsoil

Boundary Treatment
Post & Rail Fence
Scale 1:50

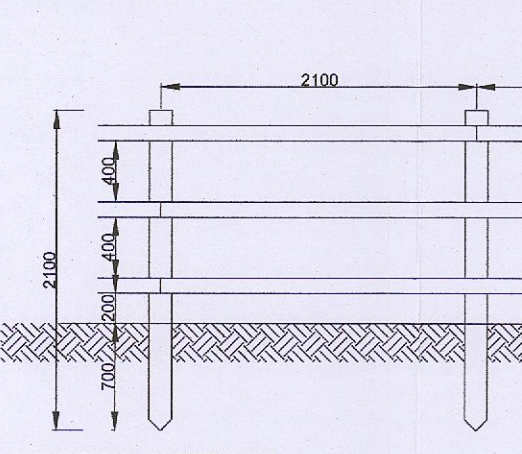

- ELEVATION - OUTER SIDE
- Post: 2100x150x75
Tolerances to IS435: 2005
Part 1 Cl. 4.1.4 and Fig. 1

Boundary Treatment
Round bar fence
Scale 1:50

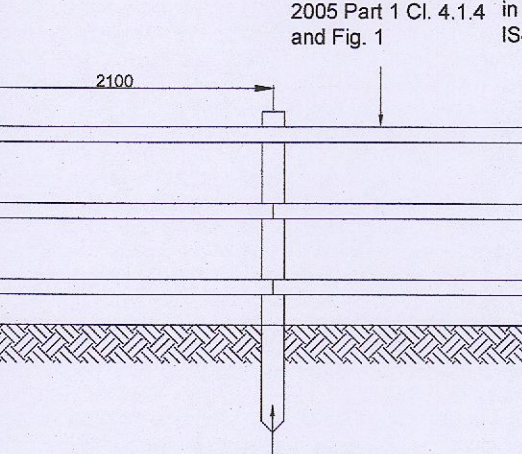

- ELEVATION - OUTER SIDE
- Post: 2100x150x75
Tolerances to IS435: 2005
Part 1 Cl. 4.1.4 and Fig. 1

Weather Detail
Pointing Detail as per IS 435-3, 2005

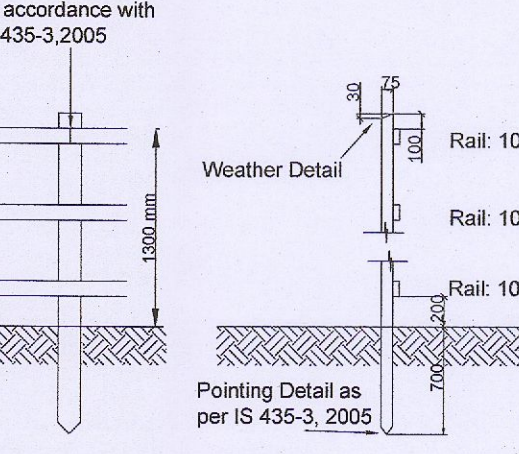

- SECTION
- Post: 2100x150x75
Tolerances to IS435: 2005
Part 1 Cl. 4.1.4 and Fig. 1

Boundary Treatment
Round bar fence
Scale 1:50

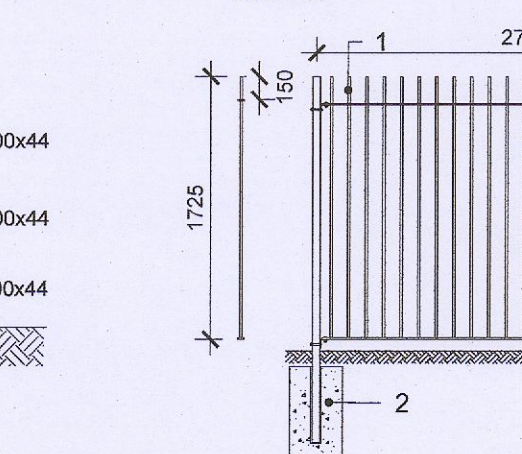

1. Round bar fence, 1800mm height to road side.
2. Foundations to engineer's specification.
3. Sliding gate to match.



This drawing is intended to show landscape structural proposals only. Please refer to Architects and Engineer's drawings for relevant details of buildings, structures, roads, paving, etc.
The copyright of this drawing is vested with Murray & Associates. This drawing may not be copied or reproduced without written consent.
All materials referred to on this drawing, including plant species - are indicative and subject to change following detailed site investigation. Significant changes, if any are required will be referred to the relevant authority for agreement.
This drawing is not suitable for use for construction purposes.
Discrepancies to be referred to Murray & Associates for clarification.

murray & associates
landscape architecture

15 The Seaport Building, 44-45 Clontarf Road, Dublin 3, D06 RFE3. mam@murray-associates.com +353 (0)1 654 0990

REV	DATE	REVISION	DRAWN	CHECKED
A	27/06/23	Planning-RFI	VI	JW
0	01/12/22	Planning	MA	JW

CLIENT: Cape Wrath Hotel Unlimited
PROJECT TITLE: Proposed Cemetery, Citywest Hotel and Convention Centre, Saggart, Co. Dublin

SHEET NO.	SHEET SIZE
1872_PL_D_01	A1
SCALE	REVISION
As Shown	A
STAGE	DATE
Planning-RFI	27/06/23