



- Legend**
- Application Site Boundary
 - Existing Levels (refer to Survey drawing)
 - 100.00 Proposed Levels (to be processed level)
 - EL - existing level
 - FF - finished floor level
 - Soft Landscape
 - Existing Trees
 - Existing Trees to be removed (See 1872_AMS for more information)
 - Proposed Trees - no.385
 - Existing Hedge to be retained
 - Proposed Hedge (Douglas spruce, Yucca sacculata, Boxwood, Crataegus monogyna)
 - Wildflower Meadow (EC03 Woodland Wild Flower Mixture)
 - Lawn (DW1: Short Cut Floral Lawn Mixture)
 - Mound (+500mm height)
 - Asiatic Planting (Years to full interest)
 - Pond (Existing ponds to be reshaped)
 - Hard Landscape
 - Road (To engineers specifications)
 - Road edge (Concrete)
 - Cycle Lane (2.5m width - To engineers specifications)
 - Footpath
 - Road for car park access (To engineers specifications)
 - Main Footpath/Heaven Road (3m width - Tar & Chip with Synthetic Street Surface (Buff Color))
 - Burials Footpath - Secondary (Compacted gravel with steel edging)
 - Burials Footpath - Plot Area (Reinforced grass)
 - Paving - Pavilion (Permeable concrete block paving)
 - Car parking spaces (no. 23) (Permeable concrete blocks)
 - Overflow car parking spaces (no. 43) (Concrete)
 - Traditional Burial Plots (no. 8047 units) (2500mm x 1200mm x 2500mm) (Marked with rectangular in-ground plaques)
 - Columbarium wall (no. 100 units) (1000mm x 1000mm x 1000mm height) (Holds 16 urns per unit)
 - Furniture & Boundaries
 - Fence (Post & Rail Fence - 1300mm high)
 - Fence and gate (1800mm in ht. Roundbar railing in colour black, adding gate to match railing)
 - Entrance Wall (Concrete block walls varying in size, one with engraved name, to match the adjacent fences height)
 - Seating Bench - (no. 32) (+400mm height Benches, steel frame and wood/composite bench, with back and armrests)
 - Cycle Stand - Visitor's cycle parking (no. 16 spaces) (Grade 316, stainless steel standard Sheffield cycle stand)
 - Infinite Edge Water Feature (Reflective pond (stone) deep with black polished granite 500x600x50mm)
 - Signage (Finish and form to be agreed with South Dublin County Council)
 - Lighting (Refer to the associated Lighting schedule)
 - Record of Protected Structures (Protected Structure: SDCPP RPS No. 297, Protected Structure: SDCPP RPS No. 292, Protected Structure: SDCPP RPS No. 222)

Scale
1:500

North Arrow

Notes

- The drawing is intended to show landscape architectural proposals only. Please refer to architectural and structural drawings for relevant details of buildings, structures, roads, etc.
- The planting of the drawing is not intended to be a final proposal. The drawing may not be suitable for reproduction or use in other contexts. All drawings are subject to change without notice. All drawings are subject to change without notice. All drawings are subject to change without notice.
- All drawings are subject to change without notice. All drawings are subject to change without notice. All drawings are subject to change without notice.
- All drawings are subject to change without notice. All drawings are subject to change without notice. All drawings are subject to change without notice.
- All drawings are subject to change without notice. All drawings are subject to change without notice. All drawings are subject to change without notice.
- All drawings are subject to change without notice. All drawings are subject to change without notice. All drawings are subject to change without notice.

Client
City West Hotel and Convention Centre, Saggart, Co. Dublin

Project Title
Proposed Cemetery, City West Hotel and Convention Centre, Saggart, Co. Dublin

Sheet Title
Site Layout Plan - Area C

RPI Stage
SDCC Reg. Ref. SD22A/0457

Sheet No.
1872_PL_P_00_3

Scale
1:500

Stage
Planning

Date
27/06/23

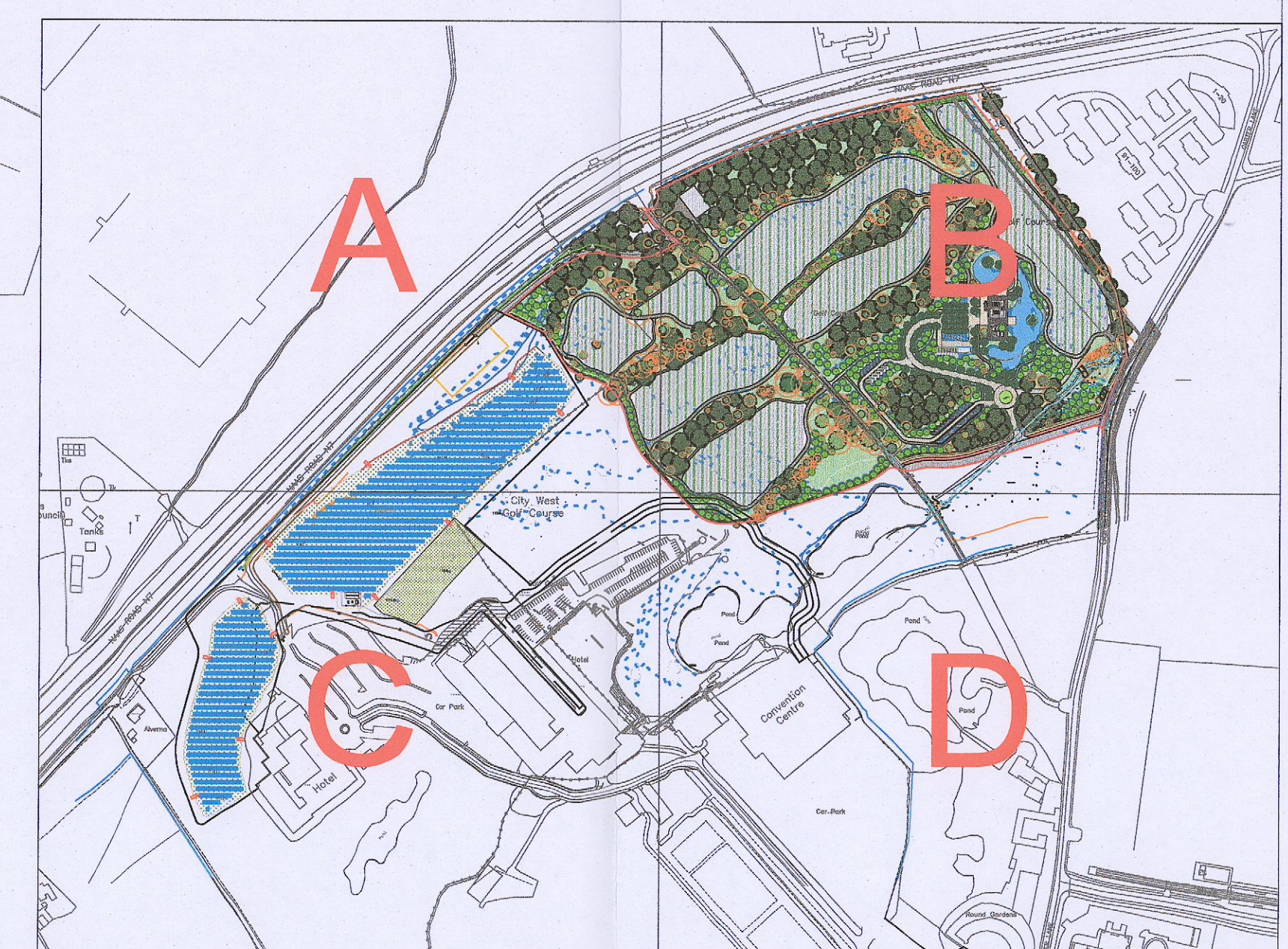

murray & associates
landscape architecture

10 The Saggart Building, Saggart, Co. Dublin
Tel: 01 454 6000
www.murrayandassociates.com

Project Team

Author	JW
Check	JW
Draw	JW
Plot	JW

Client
Cape Wrath Hotel Unlimited

Project Title
Proposed Cemetery, City West Hotel and Convention Centre, Saggart, Co. Dublin

Sheet Title
Site Layout Plan - Area C

RPI Stage
SDCC Reg. Ref. SD22A/0457

Sheet No.
1872_PL_P_00_3

Scale
1:500

Stage
Planning

Date
27/06/23

Copyright Murray and Associates, 2022