

## NATIVE TREE PLANTING:

Native trees and understory species to be planted where gaps are present in the existing woodland belt on the northern boundary of the site.

PLANT NAME	HT	GIRTH	ROOT	DENSITY*
<b>Trees</b>				
Sorbus aucuparia	3-4m	12-14cm	RB	1.5m centres
Betula pendula	3-4m	12-14cm	RB	1.5m centres
Prunus avium	3-4m	12-14cm	RB	1.5m centres
<b>Understory Species</b>				
Corylus avellana	90-120cm			750-900mm centres
Ilex aquifolium	90-120cm			750-900mm centres
Crataegus monogyna	90-120cm			750-900mm centres

\*A site visit will be undertaken to generate the final quantity of planting by the project landscape architect prior to commencement of construction.  
Areas of woodland planting to be planted using the Miyawaki Method

Note: All existing street trees outside of site boundary to be retained. It is proposed fill gaps along the existing streetscape with additional tree planting. Planting to be agreed in accordance with SDCC Parks Department.

Existing vegetation outside of site boundary retained

Grassland Management / Native Wildflower seed mix. Drifts of native wildflower seed of local provenance to be seeded throughout areas of existing grassland. A 1m mown strip to be retained around the sites perimeter fencing. Native wildflower seed mix to be planted and managed as per the All Ireland Pollinator Plan

Proposed rain garden drained from office roof. Rain garden to comprise a mix of pollinator friendly shrubs, perennial plantings and grasses

Proposed biodiversity enhancement measures comprising insect hotels and bird boxes

Existing vegetation to be retained and managed

Existing hedge/shrubs to be cut back/removed to facilitate a 1m offset on the external side of the proposed site security fence

Proposed grasscrete paving system

Pollinator friendly bulbs planted throughout the grassed areas within the site @ 10 per sqm (comprising of the following; Crocus spp., Galanthus nivalis, Colchicum spp., Ornamental Allium spp.)

## RAIN GARDEN PLANTING MIX:

PLANT NAME	DENSITY	SIZE
Viburnum opulus	1 per sqm	2 ltr
Rudbeckia spp.	3 per sqm	2 ltr
Aster spp.	3 per sqm	2 ltr
Bergenia spp.	3 per sqm	2 ltr
Iris pseudocorus	3 per sqm	2 ltr
Allium spp.	3 per sqm	2 ltr
Carex pendula	3 per sqm	2 ltr
Panicum virgatum	3 per sqm	2 ltr

Existing trees to be removed to facilitate the full footprint of the proposed development

Existing woodland belt retained and bolstered with additional native tree planting and understory species (5912 sqm). Native woodland to be planted as per the Miyawaki Method

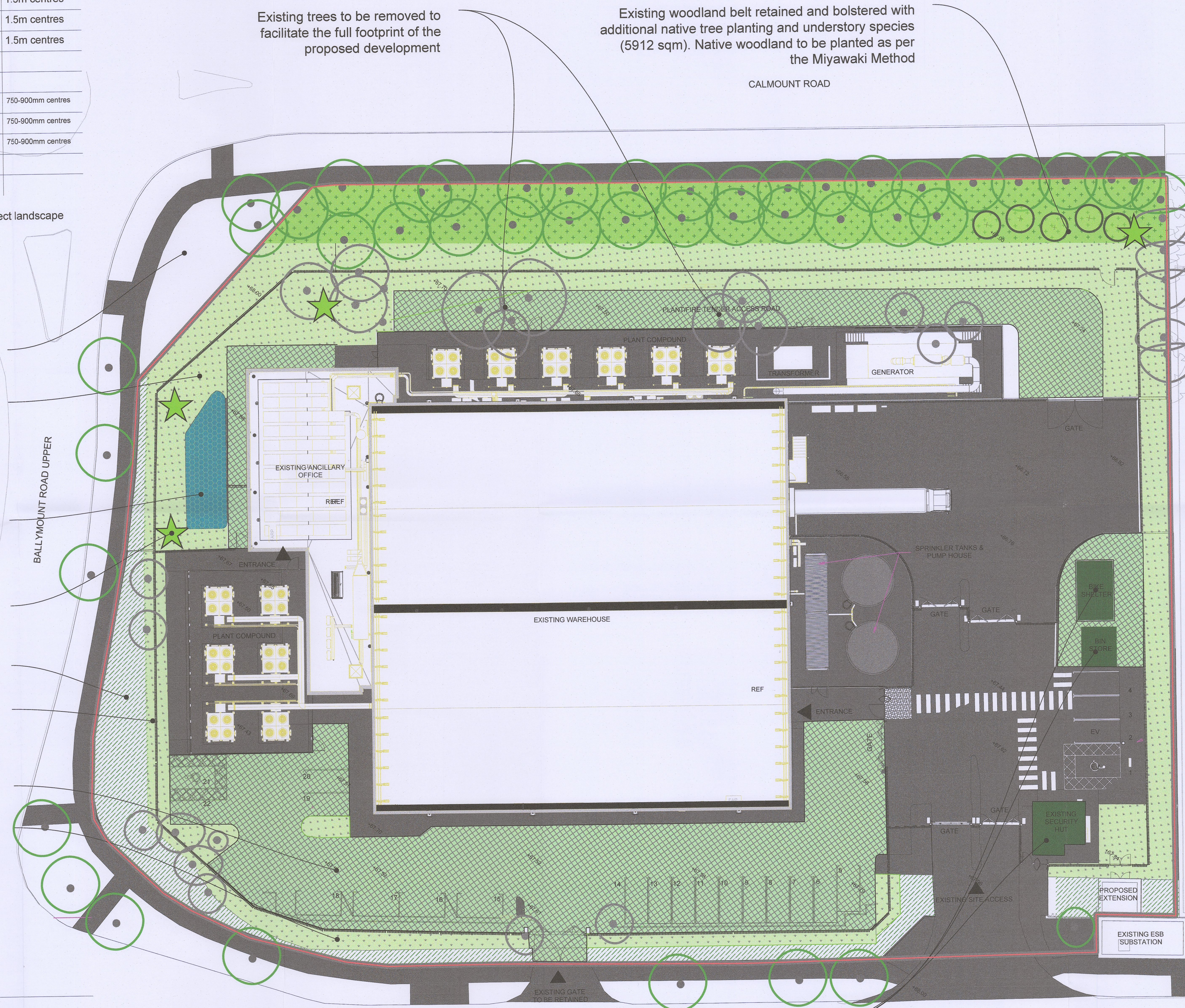

Extensive Green Roofs to be located on the proposed bike store, bin store and existing security hit. green roof structures will include low maintenance, drought-tolerant planting that is nectar-rich for butterflies, bees, moths and other invertebrate wildlife

### NOTES

#### GENERAL NOTE:

SITE PLAN TO BE READ IN CONJUNCTION WITH ARCHITECTS & CIVIL ENGINEERS DRAWINGS

### KEYNOTES

### LEGEND

- EXISTING TREES RETAINED
- EXISTING TREES REMOVED
- EXISTING TREE LINE BOLSTERED WITH ADDITIONAL NATIVE PLANTING
- PROPOSED NATIVE TREE PLANTING
- EXISTING SHRUBS/HEDGING RETAINED AND MANAGED
- GRASSLAND MANAGEMENT / NATIVE GRASS SEED MIX
- GRASSCRETE PAVING SYSTEM
- BIODIVERSITY ENHANCEMENT MEASURES (BIRD BOXES & INSECT HOTELS)
- GREEN ROOFS
- PROPOSED RAIN GARDEN
- SITE BOUNDARY

REV.	DATE	DESCRIPTION	DRN	ENG	CHK	APP

ANY UNAUTHORIZED USE OR REPRODUCTION OF THIS DOCUMENT IN WHOLE OR IN PART IS PROHIBITED. DELETE THIS DOCUMENT IF YOU HAVE RECEIVED IT IN ERROR

MECHANICAL & ELECTRICAL ENGINEER CIVIL & STRUCTURAL ENGINEER

**Clifton Scannell Emerson Associates**

Clifton Scannell Emerson Associates Limited  
Chartered Engineers, Civil & Structural Engineers, Building Services Engineers, Fire Engineers, Quantity Surveyors, Cost Estimators, Planning & Environmental Engineers  
200, Mount Pleasant Business Centre, Parkweg  
DUBLIN, D12  
T: +353 1 807 5012 E: info@scemason.com W: www.scemason.com

ARCHITECT

**KAVANAGH TUITE ARCHITECTS**

TERMINUS MILLS, CLODBAGH ROAD, D09 X207, IRELAND  
T: +353 1 2388888 W: WWW.KAVANAGHTUITE.COM

**BB7**

BB7 Fire & Security Consulting  
200, Mount Pleasant Business Centre, Parkweg  
DUBLIN, D12  
T: +353 1 807 5012 E: info@bb7.ie W: www.bb7.ie

SECURITY ENGINEER OTHER ENGINEER

**CUNDALL** **macroworks**

PROJECT: UNIT 1, M50 BUSINESS PARK

TITLE: LANDSCAPE PLAN - CLARIFICATION OF ADDITIONAL INFORMATION

DRAWING NO.: J2139-MAC-22-XX-DR-L-0001

SCALE: 1:250 AGILE No.: REV: P1