

CANAL

ATTENUATION POND PERMITTED UNDER PLANNING REF. SD21A/0042

PERMITTED EDCDUB05 UNDER PLANNING REF. SD21A/0042 DATA CENTRE - NOT UNDER CONSTRUCTION

ATTENUATION POND PERMITTED UNDER PLANNING REF. SD19A/0042 ABP-305948-19

OVERHEAD POWER LINES

EXISTING ESB PYLON

PROPOSED NEW BIO-SWALE

PROPOSED ATTENUATION PONDS

PROPOSED SECURITY FENCE - 2.4 METRE HIGH HERAS TR 200 VERTICAL BAR FENCE - TO BE PAINTED BLACK RAL 9005

PROPOSED NATIVE HEDGEROW NEW ECOLOGICAL CORRIDOR. REFER TO LANDSCAPE DRAWINGS FOR DETAILS.

PROPOSED NATIVE HEDGEROW NEW ECOLOGICAL CORRIDOR. REFER TO LANDSCAPE DRAWINGS FOR DETAILS.

PROPOSED LOCATION OF EDCDUB06 SUBJECT OF THIS APPLICATION

PROPOSED 50KWE - 230M2 OF SOLAR P.V PANELS TO BE INSTALLED ON ROOF - REFER TO ENERGY STATEMENT FOR DETAILS.

PROPOSED SECURITY GATE

PERMITTED PLANTING ALONG BOUNDARY PERMITTED UNDER PLANNING REF. SD19A/0042 ABP-305948-19

PROPOSED GREEN WALL

SITE ENTRANCE PERMITTED UNDER PLANNING REF. SD19A/0042 ABP-305948-19

R120

ALL DIMENSIONS TO BE CHECKED ON SITE NO DIMENSIONS TO BE SCALE FROM THIS DRAWING DRAWING IS TO BE READ IN CONJUNCTION WITH RELEVANT CONSULTANTS DRAWINGS

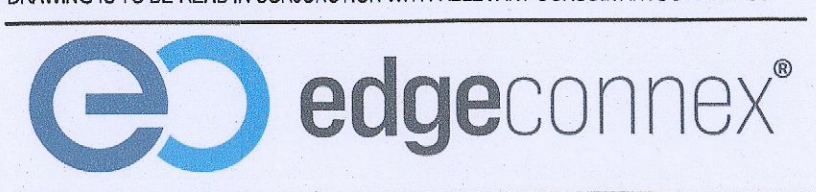

10400 Rodgers Road Houston, Texas 77070 Phone: 281-374-8644 Fax: 281-374-8992

Henry J Lyons Architects + Interiors 1351 888 3333 info@henryjlyons.com 5154 Paines Street Dublin D02 K405



PINNACLE CONSULTING ENGINEERS WOLVERSTONE HOUSE, 61 BERNERS STREET LONDON, W1T 3NJ Tel: 0207 0433410

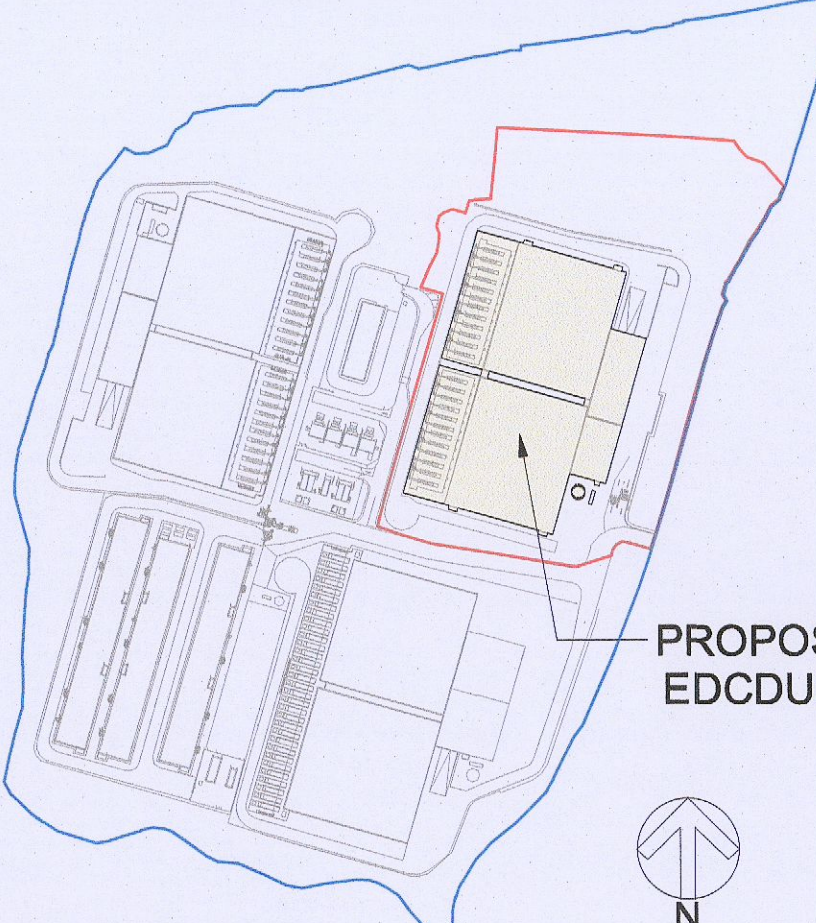

KEYPLAN LEGEND

- EXTENT OF SITE TO WHICH THIS PLANNING APPLICATION APPLIES OUTLINED IN RED
- EXTENT OF LAND IN CONTROL OF APPLICANT / OWNER IS OUTLINED IN BLUE
- PROPOSED LOCATION OF EDCDUB06 DATA CENTRE & ANCILLARY BUILDINGS SUBJECT OF THIS APPLICATION
- PROPOSED LOCATION OF ATTENUATION POND SUBJECT OF THIS APPLICATION
- PROPOSED NATIVE HEDGEROW NEW ECOLOGICAL CORRIDOR. REFER TO LANDSCAPE DRAWINGS FOR DETAILS.
- GREEN WALL
- 2.4 METRE HIGH SECURITY FENCE - TO BE PAINTED BLACK RAL 9005

REFER TO LANDSCAPING PLAN FOR FURTHER DETAILS NOTES IN RED REFERS TO THE CHANGES IN THE DRAWING

REV	DATE	DESCRIPTION	BY	CHKD
P2	19/05/2023	F1 SUBMISSION	JM	JM
P1	13/09/2022	PLANNING APPLICATION SUBMISSION	JM	CDM

EDCDUB06 CONSTRUCTION OF 2 NO. SINGLE STOREY DATA CENTRES, BOTH WITH ASSOCIATED PLANT AT ROOF LEVEL, WITH 24 NO. STANDBY DIESEL GENERATORS WITH ASSOCIATED FLUES (EACH 25M HIGH) THAT WILL BE ATTACHED TO A SINGLE STOREY GOODS RECEIVING AREA / STORE AND SINGLE STOREY OFFICE AREA. LOCATED TO THE WEST OF THE DATA CENTRES AS WELL AS ASSOCIATED WATER TOWER AND SPRINKLER TANK AND OTHER SERVICES.

STATUS CODE DESCRIPTION ISSUED FOR PLANNING APPROVAL

CLIENT EdgeConnex Inc.

PROJECT EDCDUB06

DRAWING PROPOSED SITE LAYOUT PLAN

PROJECT NUMBER 95597 DATE 26/04/2022

SCALE: A3 As Indicated DRAWN/CHECKED: CDW/JM

STATUS CODE: A1 DRAWING NUMBER: P1.04 REVISION: P2

Henry J Lyons Architects + Interiors 1351 888 3333 info@henryjlyons.com 5154 Paines Street Dublin D02 K405

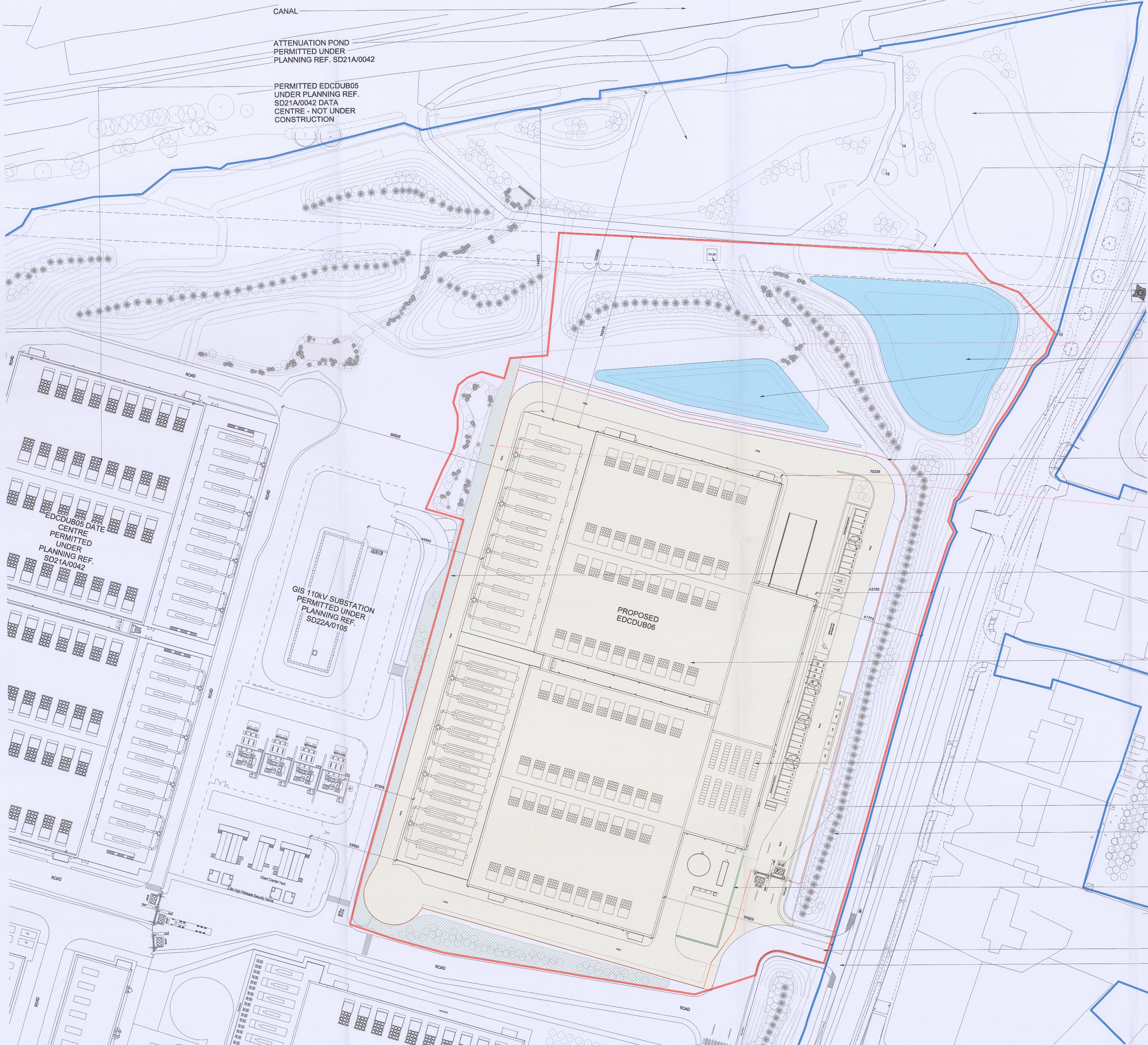

1 PROPOSED SITE LAYOUT PLAN SCALE: 1:500