

Vehicle Details:

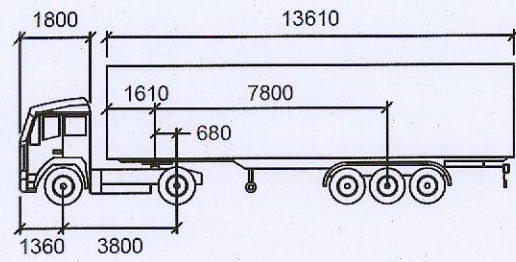

ARTIC

Tractor Width	: 1800	Lock to Lock Time	: 6.0
Trailer Width	: 2550	Steering Angle	: 33.1
Tractor Track	: 2550	Articulating Angle	: AA
Trailer Track	: 2550		

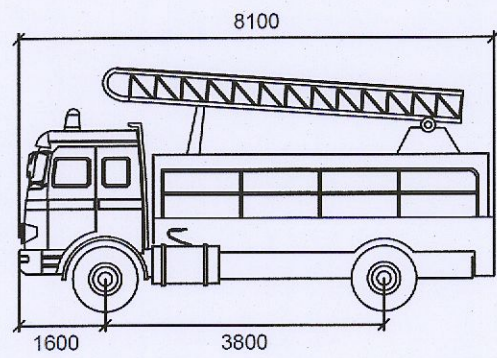

FIREAP

Width	: 2200	Lock to Lock Time	: 6.0
Track	: 2200	Steering Angle	: 33.1
		Articulating Angle	: AA

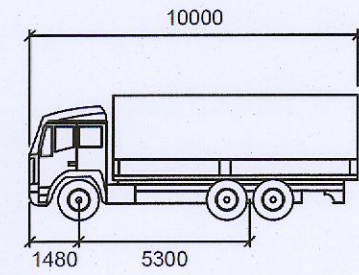

HIAB

Width	: 2500
Track	: 2500
Lock to Lock Time	: 6.0
Steering Angle	: 42.3

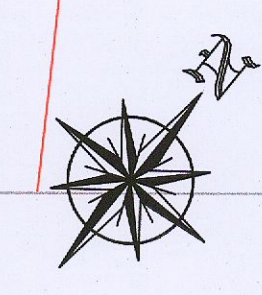
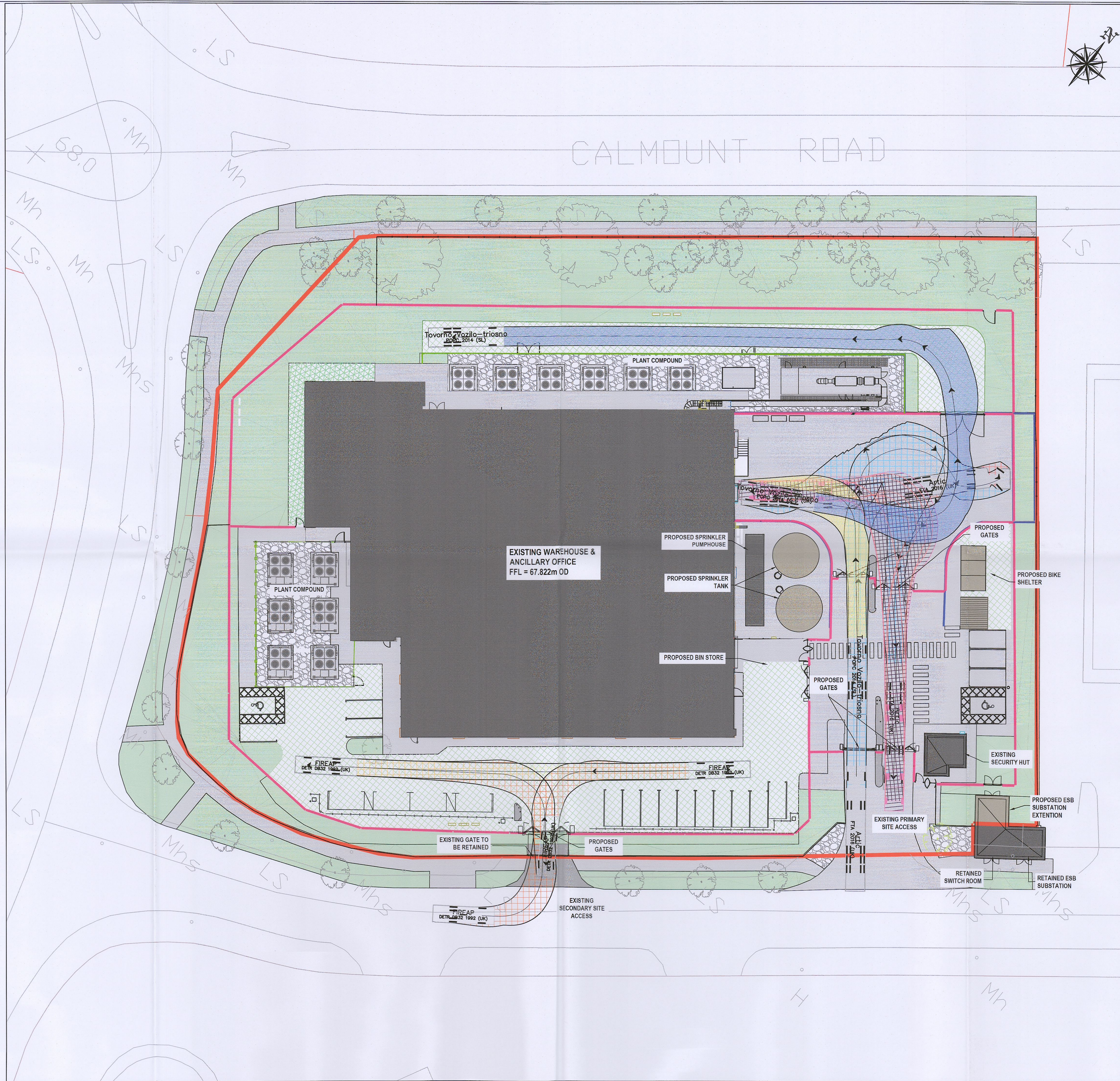

NOTES

LEGEND

- **OUTLINE OF THE SITE SUBJECT TO THIS APPLICATION**
- **RETAINING WALLS**
- EXISTING BUILDINGS**
- GRASSCRETE**
- CONCRETE PAVING**
- PROPOSED BUILDINGS**
- GRAVEL**
- LANDSCAPING AREA (REFER TO LANDSCAPE ARCHITECT DRAWING)**
- **PROPOSED FENCE**
- **PROPOSED PLANT SCREEN**
- **PROPOSED FENCE**
- **EXISTING FENCE**
- **LOW LEVEL BARRIER**

REV.	DATE	DESCRIPTION	DRN	ENG	CHK	APP
P04	03/04/23	PLANNING ISSUE	LT	CD	CD	HF
P03	08/12/22	PLANNING ISSUE	LT	CD	CD	HF
P02	14/10/22	PLANNING ISSUE	LT	CD	CD	HF
P01	02/09/22	DRAFT PLANNING ISSUE	LT	CD	CD	HF

ANY UNAUTHORIZED USE OR REPRODUCTION OF THIS DOCUMENT IN WHOLE OR IN PART IS PROHIBITED. DELETE THIS DOCUMENT IF YOU HAVE RECEIVED IT IN ERROR

MECHANICAL & ELECTRICAL ENGINEER CIVIL & STRUCTURAL ENGINEER

Clifton Scannell Emerson Associates

Civil Structural Engineers Limited
Consulting Engineers, 3rd Floor The Heights, Baines Place, Parnley Rd,
Doncaster, South Yorkshire, DN10 1JG
Tel: 0114 2761111 E: info@scannell-emerson.co.uk W: www.scannell-emerson.co.uk

KAVANAGH TUITE ARCHITECTS

TERMINAL HILL 8, CLOONRASH ROAD, DUBLIN 15, IRELAND
T: +353 1 2885800 E: info@kavanaghtuite.ie W: www.kavanaghtuite.ie

BB7

BB7 Fire & Security Consulting
Unit 5, North Point Business Centre, Sandwich
Dublin, D08 X712
T: +353 1 857 2222 E: info@bb7.ie W: www.bb7.ie

CUNDALL

Cundall Engineering Limited
7 St Stephen's Green, Dublin
D02 R222, Ireland
T: +353 01 451 7100 E: admin@cundall.com W: www.cundall.com

PROJECT: Unit 1, M50 Business Park

TITLE: PROPOSED OVERALL HGV AUTOTRACKING MOVEMENTS

DRAWING NO.: 22_112-CSE-00-XX-DR-C-2022

SCALE: 1:200	AGILE No.:	REV.: P04
---------------------	-------------------	------------------