

PIPE COVER CHART: WITHOUT CONCRETE ENCASUREMENT	MIN. COVER
SEWERS IN ROAD	1200
SEWERS IN OPEN SPACES	900
NOT ADJACENT TO ROADS	900
SEWERS IN GARDENS	900
WATERMANS ALL LOCATIONS	900
WATER SERVICES ALL LOCATIONS	600
ELEC/SB CABLE DUCTS IN ROADWAY	900
ELEC/SB CABLE DUCTS IN FOOTPATHS	500
NATURAL GAS MAINS IN ROADWAYS	800
NATURAL GAS MAINS IN FOOTPATHS	600
TELECOM DUCTS IN ROADWAYS	750
TELECOM DUCTS IN FOOTPATHS	350
CABLE TV DUCTS IN ROADS & FOOTPATHS	450

- 1) COPYRIGHT AND OWNERSHIP OF THIS DRAWING IS VESTED IN HORGANLYNCH, WHOSE PRIOR WRITTEN CONSENT IS REQUIRED FOR ITS USE, REPRODUCTION OR FOR PUBLICATION.
- 2) THIS DRAWING IS TO BE READ IN CONJUNCTION WITH ALL RELEVANT ARCHITECT'S, SERVICES ENGINEERS AND HORGANLYNCH DRAWINGS, DETAILS AND SPECIFICATIONS.
- 3) ALL DIMENSIONS TO BE CHECKED ON SITE AND ANY DISCREPANCY TO BE REPORTED TO THE ARCHITECT / ENGINEER. FIGURED DIMENSIONS ONLY TO BE USED, DRAWINGS NOT TO BE SCALED. ALL LEVELS ARE STRUCTURAL UNLESS OTHERWISE NOTED.
- 4) THIS DRAWING TO BE READ IN CONJUNCTION WITH ALL HL DRAWINGS AND SPECIFICATIONS

**DRAINAGE NOTES:**  
 AT TIME OF COMPLETION THE DEVELOPER SHOULD ENSURE THAT ALL DRAINS WITHIN THE SITE ARE CLEAN AND FREE OF OBSTRUCTIONS.  
 A CONDITION SURVEY SHOULD ALSO BE CARRIED OUT VIA CCTV FOOTAGE AND PRESENTED TO THE LOCAL AUTHORITY PRIOR TO SITE HANDOVER.

PIPEWORK PROTECTION - CONCRETE SURROUND PROTECTION OF FOUL NETWORK TO BE C16/20 CONCRETE (REFER TO SECTION 4.7 OF IW-CDS-5030 FOR FURTHER DETAILS AND SPECIFICATIONS).

**WATER TEST:**  
 FOUL & STORM SEWERS SHOULD BE TESTED FOR A MIN OF 30 MINUTES, UNDER A HEAD OF NOT LESS THAN 1M OR GREATER THAN 2.5M OVER THE HIGHEST POINT ON THE LINE UNDER TEST. THE PIPELINE SHOULD 'STAND' FOR A PERIOD 2 HOURS AFTER FILLING AND TOPPED UP AS NECESSARY BEFORE COMMENCING THE TEST.  
 THE MAXIMUM AMOUNT OF WATER LOSS SHOULD BE IN ACCORDANCE WITH LOCAL AUTHORITY GUIDELINES

AN AIR TEST MAY BE CARRIED OUT IN LIEU OF THE ABOVE AND IN ACCORDANCE WITH LOCAL AUTHORITY GUIDELINES

AT TIME OF COMPLETION THE DEVELOPER SHOULD ENSURE THAT ALL DRAINS WITHIN THE SITE ARE CLEAN AND FREE OF OBSTRUCTIONS

LOCATION OF ALL STORM DRAINAGE ON THIS PLAN IS INDICATIVE / REPRESENTATIVE ONLY.

A CONDITION SURVEY SHOULD ALSO BE CARRIED OUT VIA CCTV FOOTAGE AND PRESENTED TO THE LOCAL AUTHORITY PRIOR TO SITE HANDOVER

- LEGEND:**
- PROPOSED STORM AJ
  - PROPOSED STORM MANHOLE
  - PROPOSED STORM SEWER
  - PROPOSED STORM PERFORATED PIPE
  - EXISTING STORM SEWER

TOTAL CUMULATIVE VOLUME OF SUDS FEATURES - SWALES / INFILTRATION BASINS - 96M<sup>3</sup>  
 TOTAL CUMULATIVE VOLUME OF STORAGE BENEATH ROAD SURFACE / PERMEABLE PAVEMENTS - 100M<sup>3</sup>

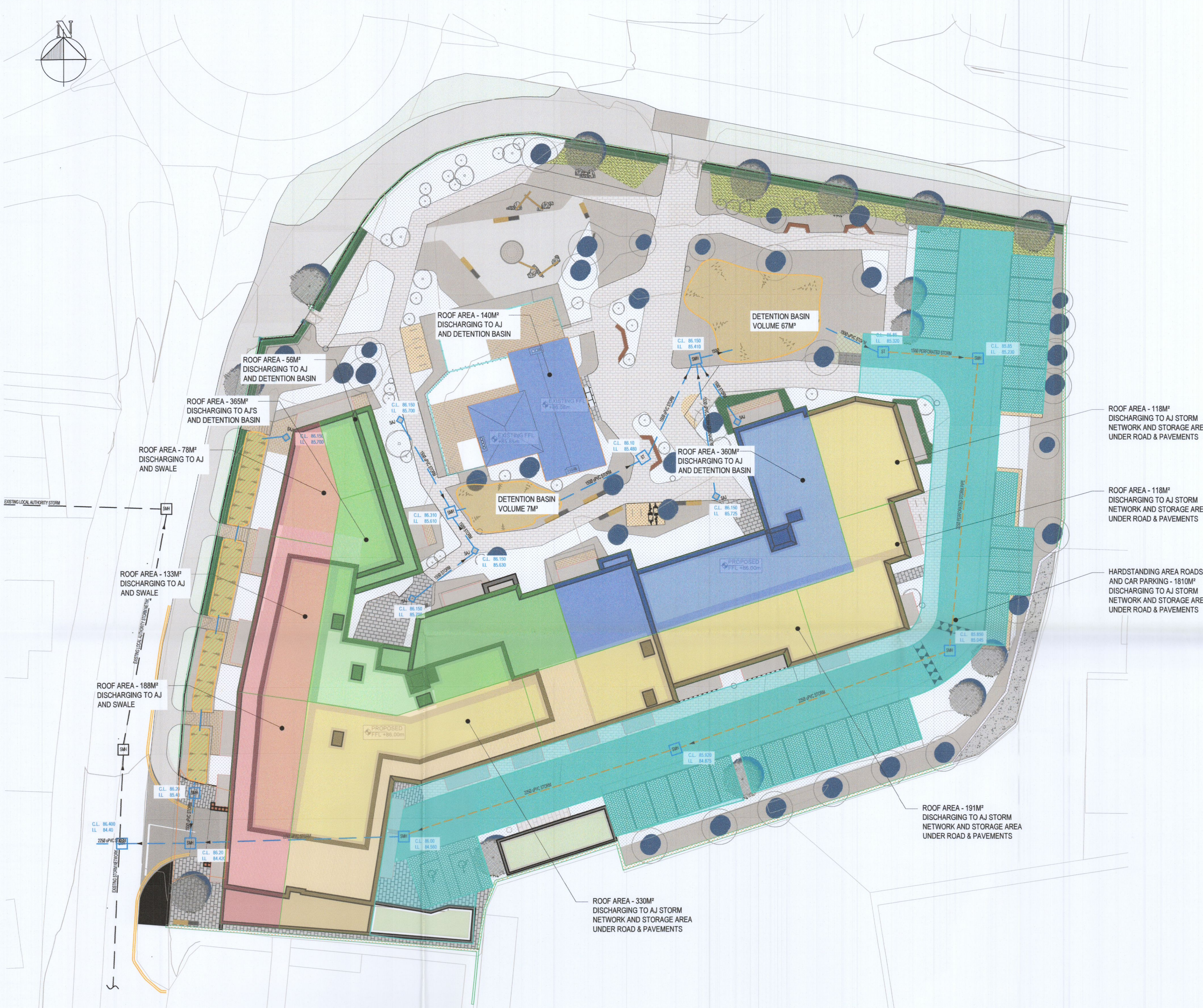

PROPOSED DRAINAGE CATCHMENT AREAS  
 SCALE 1:250

REV	BY	CHKD.	DATE	DESCRIPTION
0	KL	NF	11.04.23	ISSUED FOR PLANNING RFI

L:\CL\1201-WP\GAD\12-V1-XXX-DR-HLCE-CE-007.dwg 11/4/2023 14:17 - A1

PROJECT  
**RESIDENTIAL DEVELOPMENT AT SCHOLARSTOWN DUBLIN**

DRG. TITLE  
**PROPOSED STORM CATCHMENT AREAS**

SCALE	DRAWN BY	CHECKED BY	APPROVED BY
AS SHOWN (@ A1)	KL	KC	KC

**Horganlynch**  
 Consulting Engineers  
 Tellengana, Blackrock Road, Cork.  
 t: +353 21 4936100  
 e: cork@horganlynch.ie  
 www.horganlynch.ie

DWG: CL12-V1-XXX-DR-HLCE-CE-007

HL PROJECT REF.	STATUS	REVISION
CL12	P3	0