

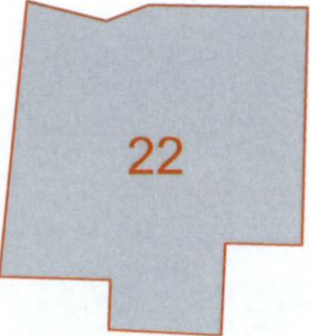

Junction sight distance of 24m measured at 2.4m back from the road edge to the north and road centerline to the south in accordance with the Design Manual for Urban Roads and Streets for a design speed of 30km/hr.

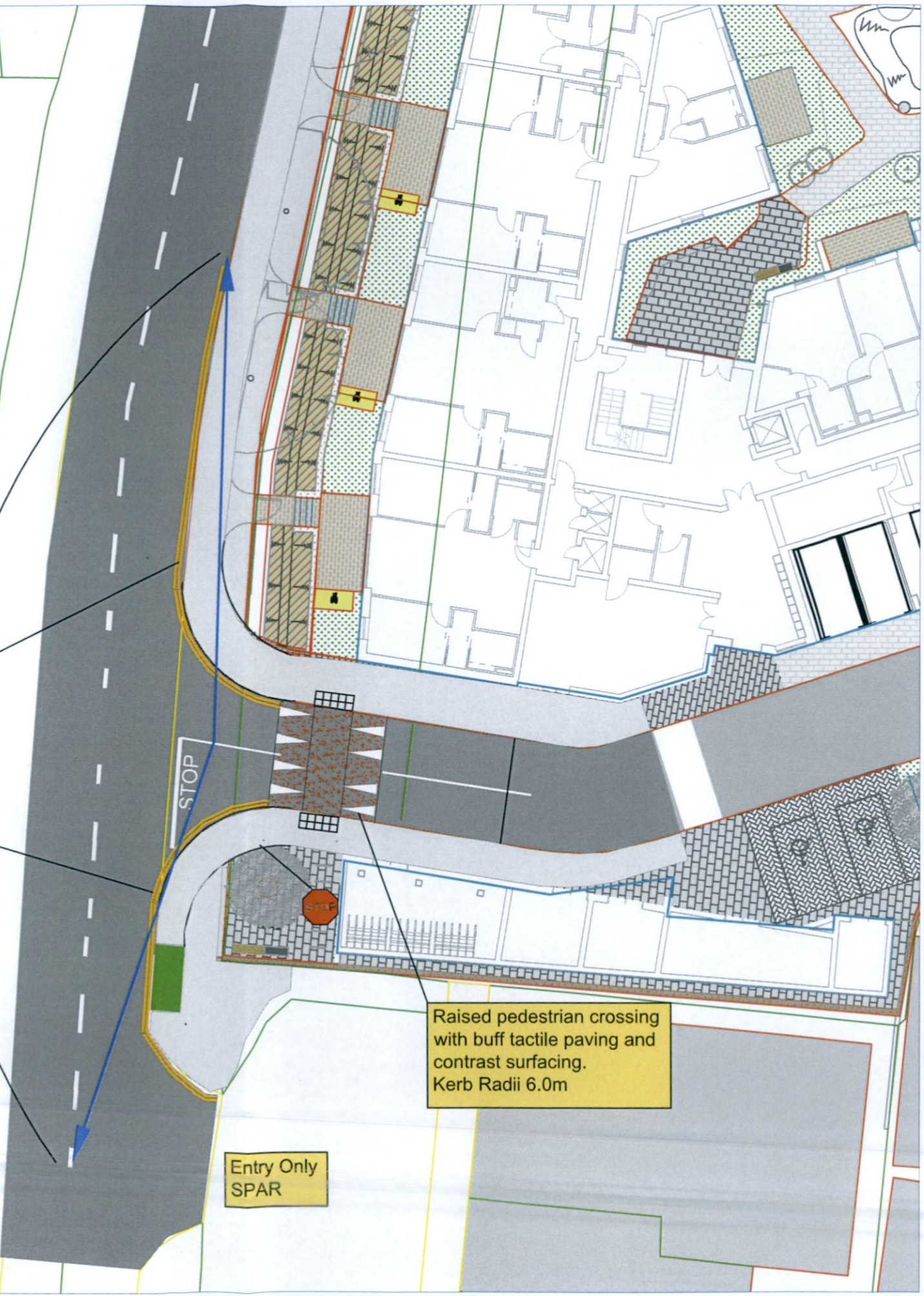

Double yellow road marking to prevent illegal parking



Raised pedestrian crossing with buff tactile paving and contrast surfacing. Kerb Radii 6.0m

Entry Only SPAR

NOTES:
 All dimensions in metres.
 Do not scale from drawing.
 For any discrepancies found please consult with design office.
 This drawing should be read in conjunction with all contract drawings, documents and specifications.

Rev	By	Date	Description
03	MH	02-05-23	Minor revisions to layout
02	MH	06-03-23	Minor revision to entrance
01	MH	18-01-23	Pedestrian crossing altered at Entrance

Drawing Status: PLANNING
NOT CERTIFIED FOR CONSTRUCTION

Project Title:
 Apartment Development Scholarstown House Dublin 16.

Drawing Title:
 Development Access.

Client:
 Clancy Homes & Client Emmaville Ltd.

Martin Hanley
 Traffic & Transportation Consulting Engineers.
 73 Lisdoonbeg, Maryborough Hill, Douglas, Cork.
 Tel: 031-4857959
 E-Mail: martinhanley1@gmail.com

Designed:	MH	Date:	May 2023
Scale:	1/250 at A3	Job No:	22-05TT
Drawing No:	SH-DA-P02	Revision:	03



NOTES:
 All dimensions in metres.
 Do not scale from drawing.
 For any discrepancies found please consult with design office.
 This drawing should be read in conjunction with all contract drawings, documents and specifications.

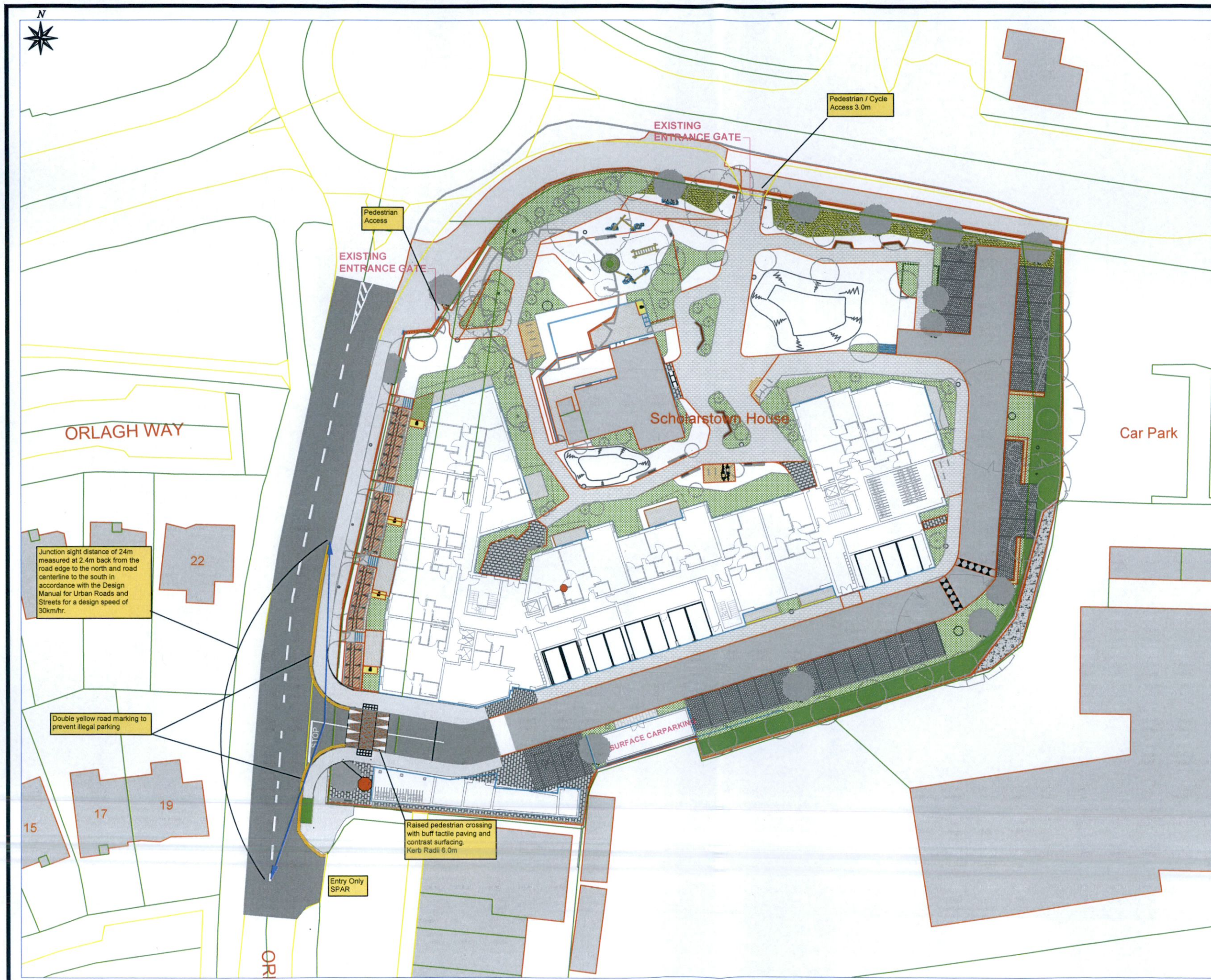

Rev	By	Date	Description
03	MH	02-05-23	Minor revisions to layout
02	MH	06-03-23	Minor revision to entrance
01	MH	18-01-23	Pedestrian crossing altered at Entrance

Drawing Status: PLANNING
NOT CERTIFIED FOR CONSTRUCTION

Project Title:
 Apartment Development Scholarstown House Dublin 16.

Drawing Title:
 Development Access.

Client:
 Clancy Homes & Client Emmaville Ltd.

Martin Hanley
 Traffic & Transportation
 Consulting Engineers.
70 Lisdaell, Maryborough Hill, Douglas, Cork. Tel: 021-4857959 E-Mail: martinhanley1@gmail.com

Designed: MH	Date: May 2023
Scale: 1/500 at A3	Job No: 22-05TT
Drawing No: SH-DA-P01	Revision: 03