

© COPYRIGHT OF THIS DRAWING IS RESERVED BY DBFL CONSULTING ENGINEERS. NO PART SHALL BE REPRODUCED OR TRANSMITTED WITHOUT THEIR WRITTEN PERMISSION.

NO CHANGES OF WHATSOEVER NATURE ARE TO BE MADE TO ANY DETAILS SET OUT OR CONTAINED IN ANY DBFL SPECIFICATIONS OR DRAWINGS UNLESS THE EXPRESS CONSENT HAS BEEN OBTAINED IN ADVANCE, IN WRITING, FROM DBFL.

- NOTES:
- GENERAL NOTES:
1. ALL WORKS TO BE CONSTRUCTED IN ACCORDANCE WITH THE NRA SPECIFICATION FOR ROAD WORKS UNLESS OVERRIDDEN BY LOCAL OVERSEING AUTHORITY'S STANDARDS.
  2. ALL ROAD MARKINGS & SIGNS SHALL COMPLY FULLY WITH THE TRAFFIC SIGNS MANUAL, PUBLISHED BY THE DEPARTMENT OF TRANSPORT, NOVEMBER 2015.
  3. SIGNS & MARKINGS: CONTRACTOR TO CONFIRM PRECISE SETTING OUT WITH EMPLOYERS REPRESENTATIVE PRIOR TO COMPLETION.
  4. ALL SIGNS TO BE MOUNTED ON 75mm GALVANISED STEEL POSTS WITH COLOURED SLEEVES U.N.O. TO SPECIFICATION AND IN ACCORDANCE WITH THE TRAFFIC SIGNS MANUAL. MOUNTING HEIGHT TO BOTTOM OF SIGN = 2.3m U.N.O.
  5. ALL TRAFFIC MANAGEMENT TO COMPLY FULLY WITH THE PROVISIONS OF CHAPTER 6 OF THE TRAFFIC SIGNS MANUAL.
  6. ALL CO-ORDINATES ARE TO IRISH TRANSVERSE MERCATOR.
  7. ALL LEVELS ARE TO ORDNANCE DATUM AND ARE IN METRES.
  8. ALL STREET FURNITURE TO BE TAKEN UP AND SET ASIDE FOR RE-USE. PROPOSED STREET FURNITURE TO BE RETROFITTED BY OTHERS.
  9. ALL EXISTING SIGNS (INCLUDING POLES) AND MARKINGS TO BE TAKEN UP OR COVERED AND TEMPORARY MEASURES APPLIED IN ACCORDANCE WITH CONTRACTORS TRAFFIC MANAGEMENT PLAN. THE CONTRACTOR MAY USE EXISTING SIGNAGE AS PART OF THEIR TRAFFIC MANAGEMENT PLAN.
  10. ALL EXISTING CHAMBERS AND ACCESS POINTS TO REMAIN CLEAR OF OBSTRUCTION THROUGHOUT WORKS. CHAMBERS SHALL BE REBUILT/RETAINED IN POSITION IDENTIFIED ON FINISHING WORKS DRAWING.
  11. ALL PEDESTRIAN, CYCLE AND VEHICULAR ROUTES MUST BE RETAINED IN ACCORDANCE WITH APPROVED TRAFFIC MANAGEMENT PLAN.
  12. ALL MATERIALS TO BE DISPOSED OFF SITE SHALL BE TAKEN TO A LICENSED FACILITY APPROVED BY THE LOCAL OVERSEING AUTHORITY.
  13. THE CONTRACTOR MUST LIAISE DIRECTLY WITH LOCAL AUTHORITY DEPARTMENTS AS DIRECTED IN THE WORKS REQUIREMENTS.
  14. ALL VEHICULAR & PEDESTRIAN, CYCLE & PRIVATE ACCESS ROUTES WITHIN AND SURROUNDING THE WORKS EXTENTS MUST BE MAINTAINED THROUGHOUT THE WORKS IN ACCORDANCE WITH THE CONTRACTORS APPROVED TEMPORARY TRAFFIC & OPERATIONS MANAGEMENT PLAN.

- LEGEND
- APPLICATION BOUNDARY
  - PROPOSED ROAD
  - PROPOSED FOOTPATH (REFER TO LANDSCAPE ARCHITECTS PLAN FOR FOOTPATH FINISHES)
  - EXISTING ROAD TO BE RESURFACED
  - PROPOSED RAIN GARDEN
  - COLOURED TARMAC
  - PROPOSED PERMEABLE PAWING
  - PROPOSED PERMEABLE SURFACE
  - PROPOSED PERMEABLE ASPHALT
  - PROPOSED PERMEABLE GRASS
  - PROPOSED LATERAL INLET KERB
  - PROPOSED DROPPED KERB
  - PROPOSED ROAD CENTRELINE
  - PROPOSED 25mm RAISED KERB
  - PROPOSED RAISED TABLE
  - PROPOSED BUFF TACTILE PAWING
  - PROPOSED ROAD LEVEL
  - PROPOSED FINISHED FLOOR LEVEL

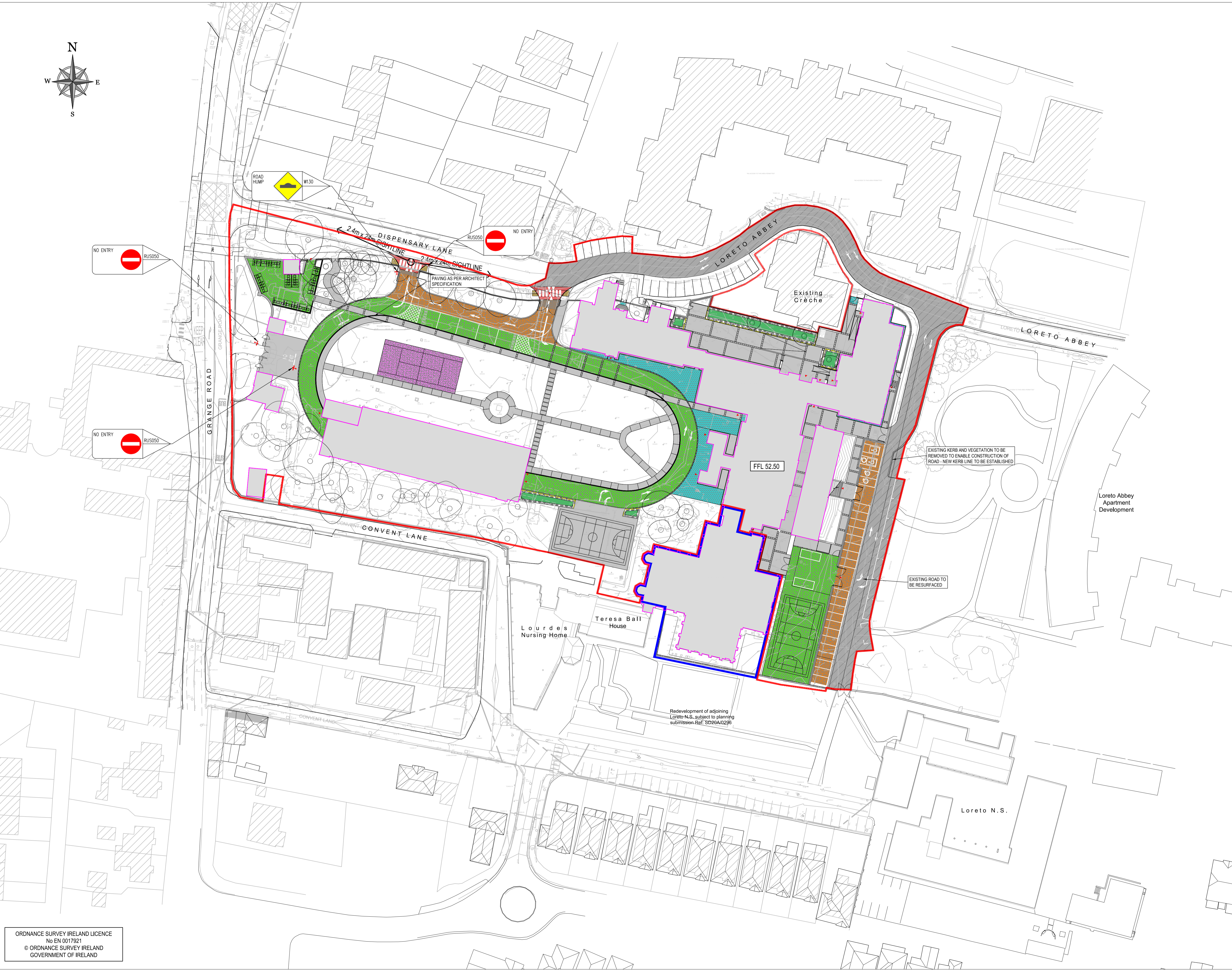

rev	date	RFI RESPONSE	description	PGC	ED
P01	21-04-23				

client approval: A - Approved, B - Approved with comments, C - Do not use

suitability: S2 - INFORMATION, PLANNING

**DBFL Consulting Engineers**  
Civil, Structural & Transportation Engineering  
www.dbfl.ie

DUBLIN OFFICE: Ormond House, Upper Ormond Quay, Dublin 7, D07 W704  
PHONE: +353 1 400 4000

CORK OFFICE: 14 South Mall, Cork, T12 CT91  
PHONE: +353 21 2024538

WATERFORD OFFICE: Suite 10 The Arkun, Maritime Gate, Canada Street, Waterford, X91 W028  
PHONE: +353 51 309 500

project ref: GAELOCHLAISTE PHIARSAIGH RATHFARNHAM

drawing title: ROADS LAYOUT

client: DEPARTMENT OF EDUCATION & SKILLS

designed by: EDA, author: ICD, scale: 1:500, sheet size: A1, drawing no.: 190187-DBFL-RD-SP-DR-C-1211, revision: P01

ORDNANCE SURVEY IRELAND LICENCE  
No EN 0017921  
© ORDNANCE SURVEY IRELAND  
GOVERNMENT OF IRELAND