

KEY ELEVATION - DET 1 - 1:25

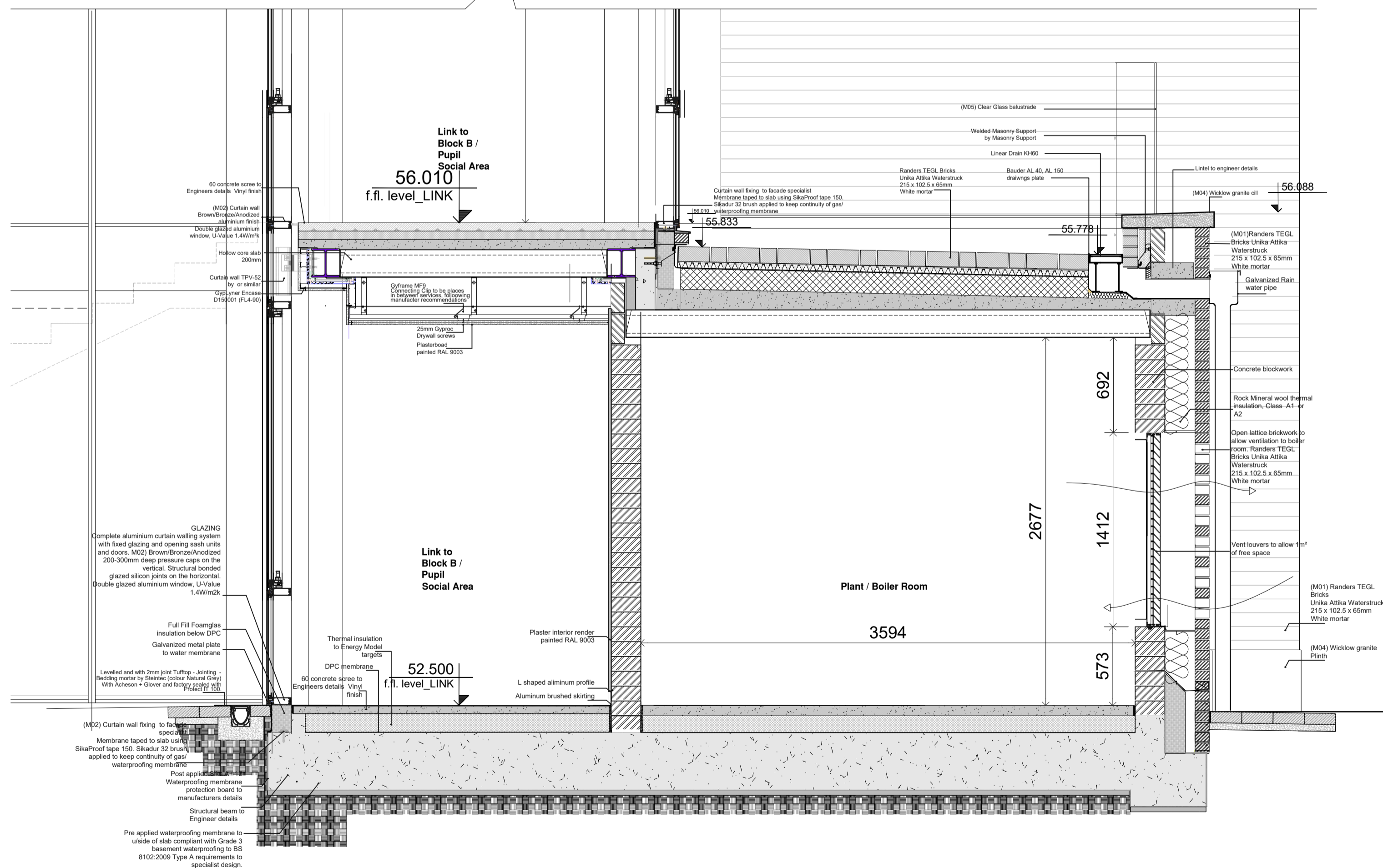

KEY ELEVATION - DET 2 - 1:25

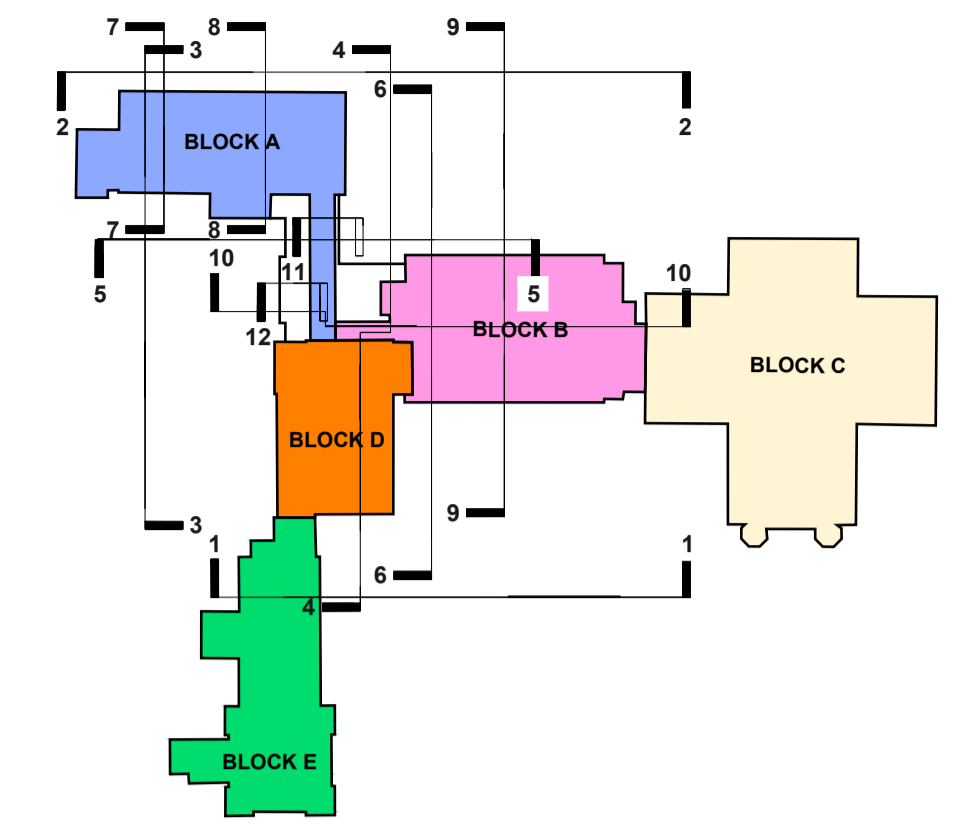

KEY PLAN

NOTE: Details provided in response to planning RFI Item 2 "The applicant is to submit detailed drawings and CGIs of the proposed glazed link, from all sides". Should planning permission be granted, details to be further developed for tender and construction stages



KEY ELEVATION - CALL OUT - 1:200

Conditions of use of this drawing
 note: If this A1 size drawing is reproduced at a smaller size which makes these conditions difficult to read, please contact the Architects office for a legible copy of these conditions.
 1. This drawing is to be used only for the specific project and for the specific purpose for which it has been prepared. It is not to be used for any other project or purpose.
 2. This drawing is to be used only for the specific project and for the specific purpose for which it has been prepared. It is not to be used for any other project or purpose.
 3. This drawing is to be used only for the specific project and for the specific purpose for which it has been prepared. It is not to be used for any other project or purpose.
 4. This drawing is to be used only for the specific project and for the specific purpose for which it has been prepared. It is not to be used for any other project or purpose.

5. Do not scale off this drawing. Figured metric dimensions only should be taken off this drawing. Imperial dimensions, if any, contained on this drawing are given for illustrative purposes only.
 6. All contractors, whether main or sub contractors, must visit the site and are responsible for taking and checking any and all dimensions levels and the like that relate to the work.
 7. Where this drawing contains discrepancies in relation to other relevant documents, such discrepancies shall be brought to the attention of the Architects who shall issue a written instruction as to which information is to be followed, and until such written Architects instruction has been issued any work carried out on the basis of the discrepancies shall be unauthorised.
 8. References to National Standards, whether in Irish (ISI), British (BS) or otherwise, or codes of practice (CP) shall be deemed to refer to the relevant standard or code current at the date of issue of the drawing notwithstanding any reference to the contrary or to any earlier standard.
 9. Any reference to the "Architect" or "Architects" on this or any other relevant documents shall mean the nominated project Architect and/or a Director of Simon J Kelly Architects who has been nominated as the partner-in-charge but only while such Architect remains in the employment of Simon J Kelly Architects.
 10. Any questions as to the meaning or application of these conditions shall be submitted in writing to the Architect for his/her ruling and such a ruling shall be conclusive as to the meaning or application of these conditions.
 11. Simon J Kelly Architects, their Agents, Architects, employees and or directors shall not be liable for any loss damage or injury consequential or otherwise howsoever arising for failure to comply with any or all of these conditions.
 12. Should anyone copy this drawing in whole or in part with or without consent and use the copy in relation to a purpose and or requirements and or statutory obligations, the drawing has not been prepared for, such use is at the sole and exclusive risk of the copier and Simon J Kelly Architects do not accept any liability whatsoever howsoever arising in relation to such use.
 13. Should anyone copy this drawing in whole or in part with or without consent they should also copy these conditions of use in full and reproduce them with the copy. These conditions of use are to be read in conjunction with the drawing and its contents, these conditions of use form part of the drawing and or its content and are inseparable from this drawing and or its content.
 14. The use of or reliance upon this drawing and or its contents shall be deemed to be acceptance of these conditions of use unless otherwise agreed in writing, such written agreement to be sought from and issued by the Architects prior to the use or reliance upon this drawing and or its contents.
 15. All drawings are to be read in conjunction with the fire safety compliance report, all other contract documents, all statutory consents and or requirements and all statutory obligations.

RFI Response

PROJECT: Gaelscoiláiste an Phiarsaigh - Loreto Abbey, Rathfarnham		rev. date description by	
CLIENT: Department of Education / Board of Management			
DRAWING: General Arrangement Section 11 - Details 1		Fitzgerald Kavanagh + Partners 1 Mount Street Crescent, Dublin 2, D02 XF57 +353 1 676 4128 info@fkp.ie www.fkp.ie	
DRAWING PURPOSE: RFI Response	DRAWN BY: SFR	APPROVED: SFR	DATE: April 2023
DRAWING SIZE: A1	SCALE: 1/100	DRAWING REFERENCE: 2300-SJK_RFI_S2B_S_200_E280	REV. NO.: Rev 00
PROJECT: Gaelscoiláiste an Phiarsaigh - Loreto Abbey, Rathfarnham			
CLIENT: Department of Education / Board of Management		Simon J Kelly Architects 21 Middle Street, Galway G35 91 68 2949 Co. Clare, Westport, Mayo M35 9E 24 414 mail@sjk.ie www.sjk.ie	