

PHASE 2 WORKS

LISEUX - BLOCK E

CONCERT HALL - BLOCK D

GEORGIAN HOUSE - BLOCK B

PROPOSED LINK BUILDING

ST. ANNES - BLOCK A

SECTION 6-6

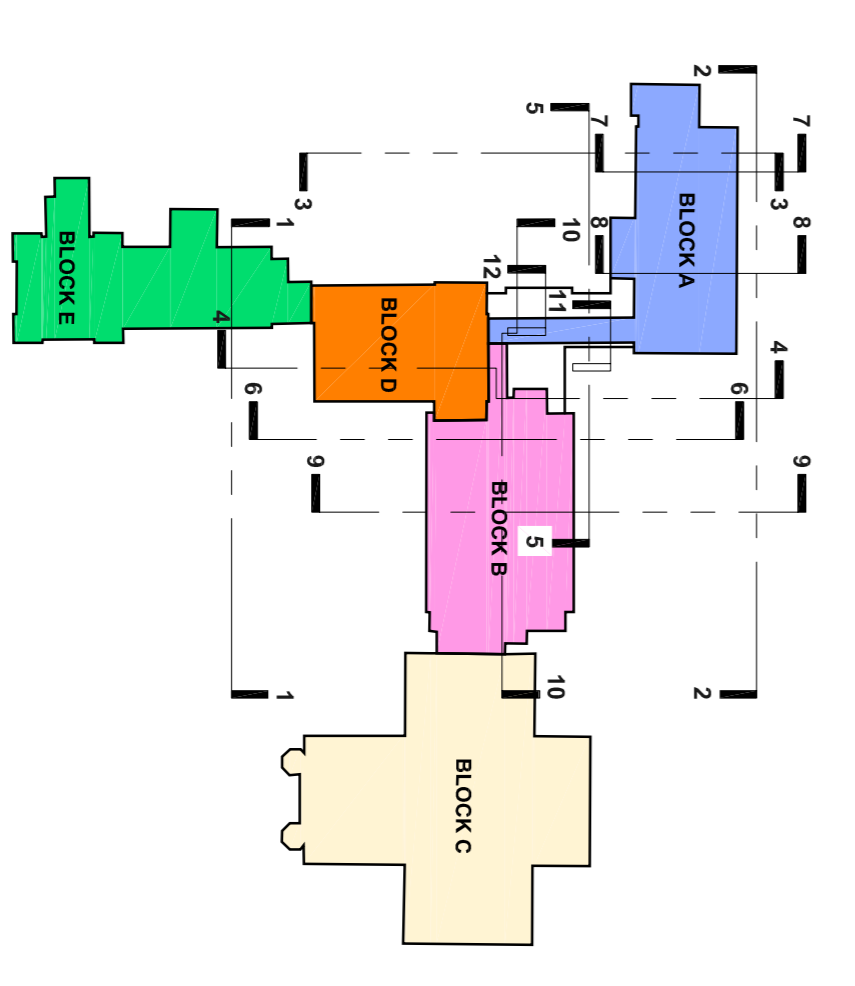

KEY PLAN

Conditions of use of this drawing

- This drawing is a preliminary drawing and is not to be used for construction purposes. It is intended for information only and is subject to change without notice.
- The drawing is to be used only for the specific purpose for which it has been prepared. The drawing is not to be used for any other purpose without the written consent of the Architect.
- The drawing is to be used only for the specific purpose for which it has been prepared. The drawing is not to be used for any other purpose without the written consent of the Architect.
- The drawing is to be used only for the specific purpose for which it has been prepared. The drawing is not to be used for any other purpose without the written consent of the Architect.
- The drawing is to be used only for the specific purpose for which it has been prepared. The drawing is not to be used for any other purpose without the written consent of the Architect.

Conditions of use of this drawing

- This drawing is a preliminary drawing and is not to be used for construction purposes. It is intended for information only and is subject to change without notice.
- The drawing is to be used only for the specific purpose for which it has been prepared. The drawing is not to be used for any other purpose without the written consent of the Architect.
- The drawing is to be used only for the specific purpose for which it has been prepared. The drawing is not to be used for any other purpose without the written consent of the Architect.
- The drawing is to be used only for the specific purpose for which it has been prepared. The drawing is not to be used for any other purpose without the written consent of the Architect.
- The drawing is to be used only for the specific purpose for which it has been prepared. The drawing is not to be used for any other purpose without the written consent of the Architect.

Conditions of use of this drawing

- This drawing is a preliminary drawing and is not to be used for construction purposes. It is intended for information only and is subject to change without notice.
- The drawing is to be used only for the specific purpose for which it has been prepared. The drawing is not to be used for any other purpose without the written consent of the Architect.
- The drawing is to be used only for the specific purpose for which it has been prepared. The drawing is not to be used for any other purpose without the written consent of the Architect.
- The drawing is to be used only for the specific purpose for which it has been prepared. The drawing is not to be used for any other purpose without the written consent of the Architect.
- The drawing is to be used only for the specific purpose for which it has been prepared. The drawing is not to be used for any other purpose without the written consent of the Architect.

Conditions of use of this drawing

- This drawing is a preliminary drawing and is not to be used for construction purposes. It is intended for information only and is subject to change without notice.
- The drawing is to be used only for the specific purpose for which it has been prepared. The drawing is not to be used for any other purpose without the written consent of the Architect.
- The drawing is to be used only for the specific purpose for which it has been prepared. The drawing is not to be used for any other purpose without the written consent of the Architect.
- The drawing is to be used only for the specific purpose for which it has been prepared. The drawing is not to be used for any other purpose without the written consent of the Architect.
- The drawing is to be used only for the specific purpose for which it has been prepared. The drawing is not to be used for any other purpose without the written consent of the Architect.

Conditions of use of this drawing

- This drawing is a preliminary drawing and is not to be used for construction purposes. It is intended for information only and is subject to change without notice.
- The drawing is to be used only for the specific purpose for which it has been prepared. The drawing is not to be used for any other purpose without the written consent of the Architect.
- The drawing is to be used only for the specific purpose for which it has been prepared. The drawing is not to be used for any other purpose without the written consent of the Architect.
- The drawing is to be used only for the specific purpose for which it has been prepared. The drawing is not to be used for any other purpose without the written consent of the Architect.
- The drawing is to be used only for the specific purpose for which it has been prepared. The drawing is not to be used for any other purpose without the written consent of the Architect.

Conditions of use of this drawing

- This drawing is a preliminary drawing and is not to be used for construction purposes. It is intended for information only and is subject to change without notice.
- The drawing is to be used only for the specific purpose for which it has been prepared. The drawing is not to be used for any other purpose without the written consent of the Architect.
- The drawing is to be used only for the specific purpose for which it has been prepared. The drawing is not to be used for any other purpose without the written consent of the Architect.
- The drawing is to be used only for the specific purpose for which it has been prepared. The drawing is not to be used for any other purpose without the written consent of the Architect.
- The drawing is to be used only for the specific purpose for which it has been prepared. The drawing is not to be used for any other purpose without the written consent of the Architect.

- LEGEND**
- Existing gutter replaced and reinstated in redox paint wall to give a guarding protection
 - Historic C18th window to be protected and repaired. Replacing all masonry above the window with new masonry and replacing with new high performance slim glazing units within the existing timber frames
 - New 4-storey curtain wall link providing circulation route between Blocks A, B and D
 - Existing Block A top floor PVC windows replaced with one-over-one timber sliding sashes
 - New heritage style roof lights & associated flashing
 - Localised dormers in standing seam profile roof to accommodate existing arched windows
 - Floor boards to be lifted to show first floor floor joisting works. Refer to Structural Engineers' detail
 - Callig timbers to be treated with an emulsion paint or similar fire retardant coating
 - Timber sash windows to be repaired, existing grills to be re-installed to protect glazing. New black-out blinds to be installed (Window no.s: E-WD001, and E-WD024 to E-WD037)
 - Suspended timber floor to be retained
 - New entrance to new link to Blocks A, B and D
 - Existing stairway
 - Existing wall to be removed shown hatched
 - New fire-rated glazed screen into new circulation link
 - New bridge walkway
 - Existing arched window head retained with new door into link
 - New powder-coated steel railings to masonry plinth wall. Plinth wall faced on exterior blocks of Window grills

RFI Response

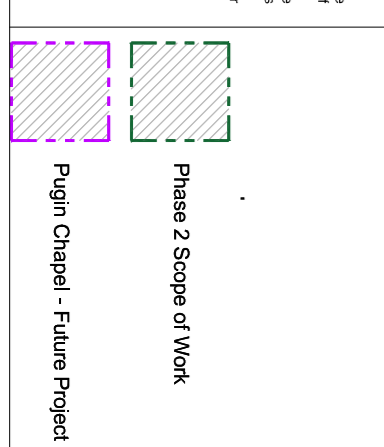

PROJECT:	Caerobdole an Pharsaigh - Lorcio Abbey, Rathfriland
CLIENT:	Department of Education / Board of Management
GENERAL ARRANGEMENT:	Proposed Elevation - Section 6-6
DRAWING NUMBER:	2250-SLK_RFI_528_S_200
DRAWING SCALE:	1/100
DRAWING DATE:	11/100
DRAWING REFERENCE:	2250-SLK_RFI_528_S_200
DRAWING REVISION:	00

Project: Caerobdole an Pharsaigh - Lorcio Abbey, Rathfriland

Client: Department of Education / Board of Management

General Arrangement: Proposed Elevation - Section 6-6

Drawing Number: 2250-SLK_RFI_528_S_200

Drawing Scale: 1/100

Drawing Date: 11/100

Drawing Reference: 2250-SLK_RFI_528_S_200

Drawing Revision: 00

Project: Caerobdole an Pharsaigh - Lorcio Abbey, Rathfriland

Client: Department of Education / Board of Management

General Arrangement: Proposed Elevation - Section 6-6

Drawing Number: 2250-SLK_RFI_528_S_200

Drawing Scale: 1/100

Drawing Date: 11/100

Drawing Reference: 2250-SLK_RFI_528_S_200

Drawing Revision: 00