

- LEGEND**
- ① Existing railings repaired and reinstated in raised plinth wall to give a guarding protection
 - ② Historic C18th window to be protected and repaired, retaining all historic hand-drawn glass in-situ
 - ③ Replacement single-glazed float glass removed and replaced with new high performance slim glazing units within the existing timber frames
 - ④ New 4-storey curtain wall link providing circulation route between Blocks A, B, and D
 - ⑤ Existing Block A top floor PVC windows replaced with one-over-one timber sliding sashes
 - ⑥ New heritage style roof lights & associated flashing installed in existing roof
 - ⑦ Localized dormers in standing seam profile roof to accommodate existing arched windows
 - ⑧ Floor boards to be lifted to allow first floor strengthening works. Refer to Structural Engineers' detail
 - ⑨ Ceiling timbers to be treated with an envirograph paint or similar fire retardant coating
 - ⑩ Timber sash windows to be repaired, existing grills to be re-installed to protect glass. New black-out blinds to be installed (Window no.s: E-WD001, and E-WD024 to E-WD031)
 - ⑪ Suspended timber floor to be retained
 - ⑫ New entrance to new link to Blocks A, B, and D

SECTION 3-3 ST. ANNE'S - BLOCK A PROPOSED LINK BUILDING CONCERT HALL - BLOCK D LISEUX - BLOCK E

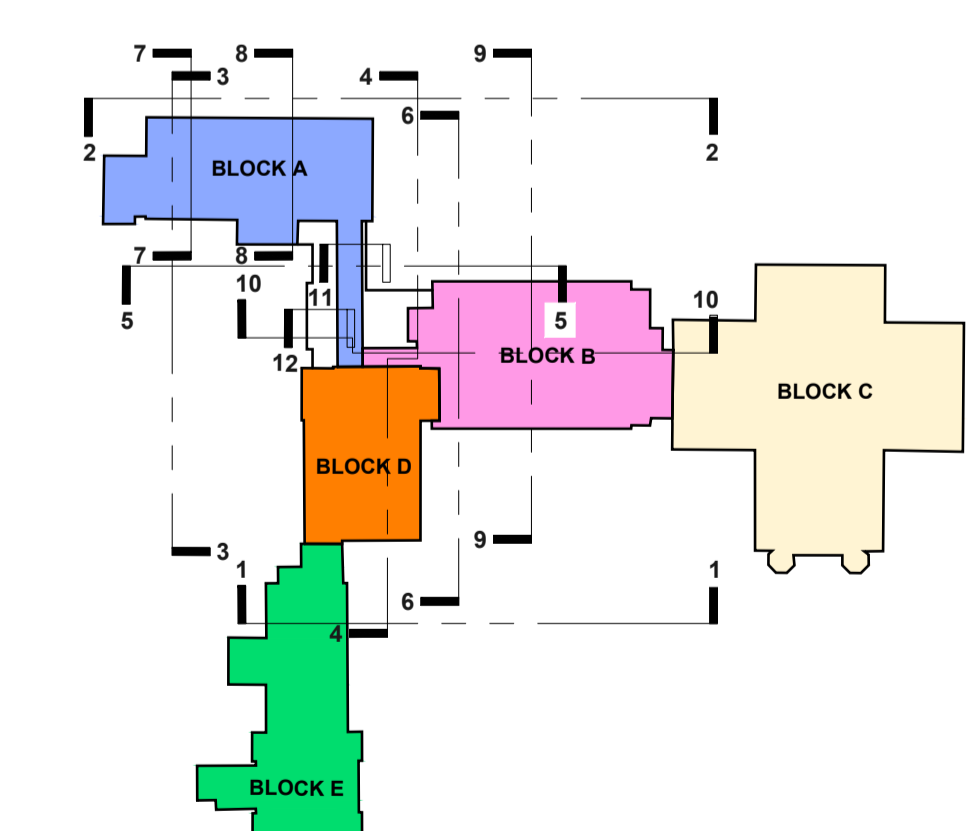

KEY PLAN

Conditions of use of this drawing
 note: if this A1 size drawing is reproduced at a smaller size which makes these conditions difficult to read, please contact the Architects office for a legible copy of these conditions.
 1. This drawing is to be used only for the specific project and for the specific purposes for which it has been prepared. This drawing is not to be relied upon for construction purposes, and no implied or expressed warranty is given as to the suitability for construction purposes, unless the purpose of this drawing is stated to be "construction" or "contract". If the purpose is stated to be "contract" this drawing is not to be used for construction if it is also marked "preliminary".
 2. The Employer is granted a copyright license to use this drawing and its contents for the purpose for which the drawing has been prepared. If this drawing has been produced for construction purposes the license will only be valid for a single construction reproduction and shall expire once a single reproduction has occurred. Any such license only passes to the Employer on payment of Architects fees in full and in any event the license cannot be assigned without prior written consent of Simon J Kelly Architects.
 3. Where the Architects conditions of employment provide that the Employer obtains copyright (whether by transfer of ownership or expressed or implied license) for use on projects other than the project which the copyright material was specifically prepared for, the Architect does not accept any liability whatsoever howsoever arising for use of this drawing and its contents (in whole or in part) in relation to any project and/or purpose other than that for which it was specifically prepared. A copyright entitlement to use this drawing and its contents (in whole or in part) is not a warranty that use of this drawing and its contents (in whole or in part) is appropriate in circumstances other than the purpose and project for which it has been prepared.
 4. Do not scale off this drawing. Figured metric dimensions only should be taken off this drawing. Imperial dimensions, if any, contained on this drawing are given for illustrative purposes only.
 5. All contractors, whether main or sub contractors, must visit the site and are responsible for taking and checking any and all dimensions levels and the like that relate to the work.
 6. Where this drawing contains discrepancies in relation to other relevant documents, such discrepancies shall be brought to the attention of the Architects who shall issue a written instruction as to which information is to be followed, and until such written Architects instruction has been issued any work carried out on foot of the discrepancies shall be unauthorised.
 7. References to National Standards, whether to BS (British), BS (BSI) or otherwise, or codes of practice (CP) shall be deemed to refer to the relevant standard or code current at the date of issue of the drawing notwithstanding any reference to the contrary or to any earlier standard.
 8. Any reference to the "Architect" or "Architects" on this or any other relevant documents shall mean the nominated project Architect and/or a Director of Simon J Kelly Architects who has been nominated as the partner-in-charge but only while such Architect remains in the employment of Simon J Kelly Architects.
 9. Any questions as to the meaning or application of these conditions shall be submitted in writing to the Architect for his/her ruling and such a ruling shall be conclusive as to the meaning or application of these conditions.
 10. Simon J Kelly Architects, their Agents, Architects, employees and or directors shall not be liable for any loss damage or injury consequential or otherwise howsoever arising for failure to comply with any or all of these conditions.
 11. Should anyone copy this drawing in whole or in part with or without consent and use the copy in relation to a purpose and/or project for which the drawing has not been prepared for, such use is at the sole and exclusive risk of the copier and Simon J Kelly Architects do not accept any liability whatsoever howsoever arising in relation to such use.
 12. Should anyone copy this drawing in whole or in part with or without consent they should also copy these conditions of use in full and reproduce them with the copy. These conditions of use are to be read in conjunction with the drawing and its contents, these conditions of use form part of the drawing and its content and are inseparable from the drawing and its content.
 13. The use of or reliance upon this drawing and/or its contents shall be deemed to be acceptance of these conditions of use unless otherwise agreed in writing, such written agreement to be sought from and issued by the Architects prior to the use or reliance upon this drawing and/or its contents.
 14. All drawings are to be read in conjunction with the fire safety compliance report, all other contract documents, all statutory consents and/or requirements and all statutory obligations.

RFI Response

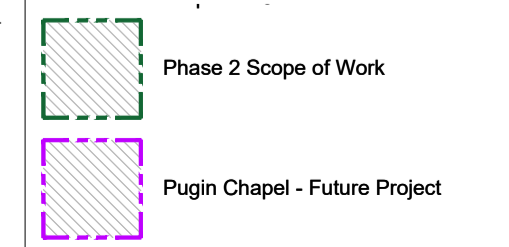

PROJECT: Gaelcholáiste an Phiarsaigh - Loreto Abbey, Rathfarnham			
CLIENT: Department of Education / Board of Management			
DRAWING: General Arrangement Proposed Elevation_Section 3-3			
DRAWING PURPOSE: RFI Response	DRAWN BY: LD/GUIC	APPROVED: SR	DATE: April 2023
DRAWING SIZE: A1	SCALE: 1/100	DRAWING REFERENCE: 2360-SJK_RFI_S28_S_200_E252	REV. NO.: Rev 00

rev. | date | description | by

Fitzgerald Kavanagh Partners
 1 Mount Street Crescent,
 Dublin 2,
 D02 XF57
 +353 1 676 4128
 info@fkp.ie
 www.fkp.ie

Simon J Kelly Architects
 21 Middle Street,
 Galway
 +353 91 66 2949
 Cax's Yard,
 Westport, Mayo
 +353 96 24 414
 mail@sjk.ie
 www.sjk.ie