

DE SELBY PARK

ADDITIONAL INFORMATION.

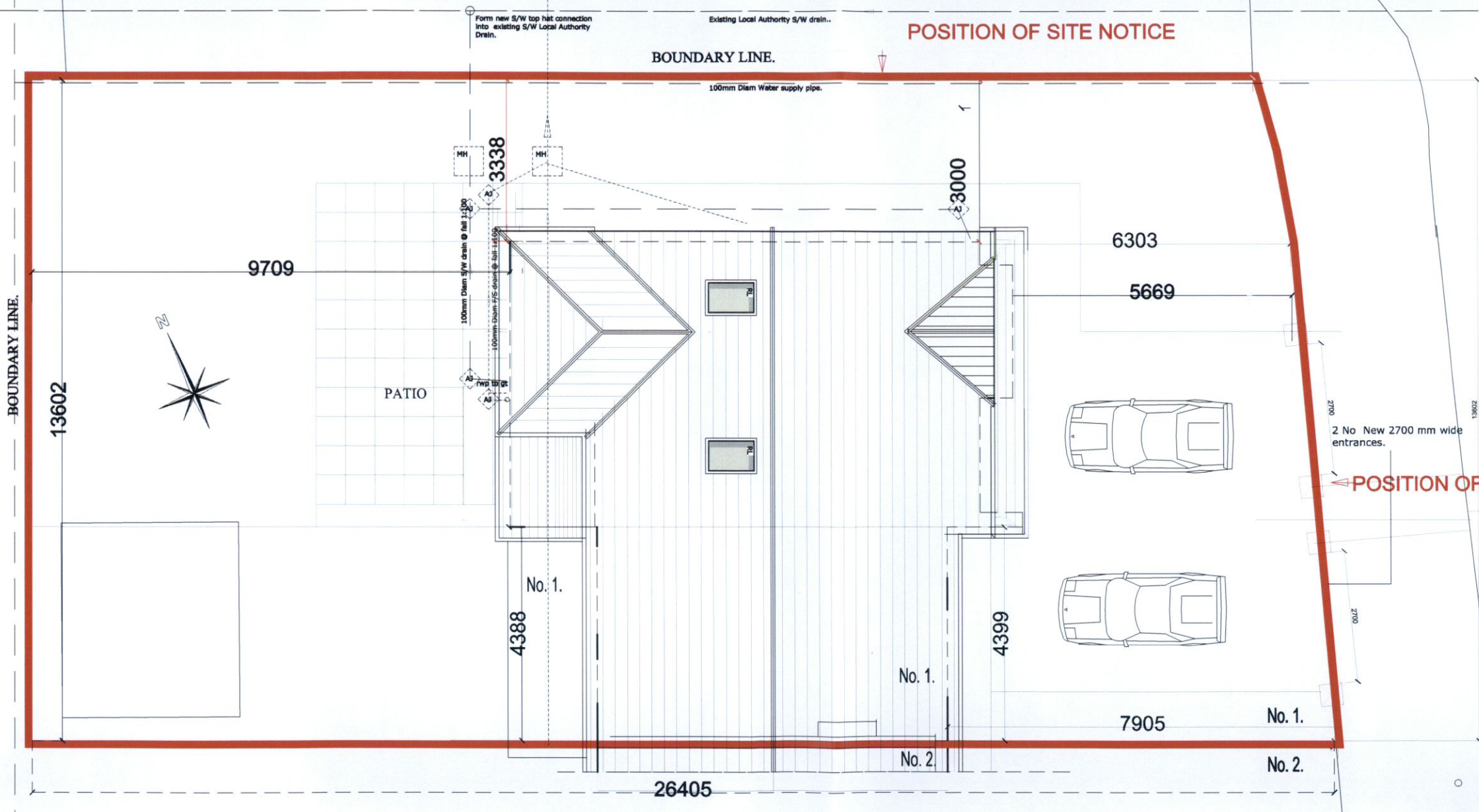

POSITION OF SITE NOTICE

POSITION OF SITE NOTICE

DE SELBY PARK

ADDITIONAL INFORMATION ISSUE.

DESMOND J. HALPIN & ASSOCIATES
 Planning & Building Design Consultants

15 Carriglea Drive, Firhouse, Dublin 24 Phone: 01-4523710 Email: deshalpin15@gmail.com

Project: PROPOSED NEW DWELLING AT No 1 DE SELBY PARK, BLESSINGTON ROAD, TALLAGHT, DUBLIN 24,	Scale 1:100 @ A3.	Drawn DJH
Drawing Title PROPOSED SITE PLAN,	Drawing No 13 -12 -22	Rev
Applicant: Ms. DANIELLE DONNOLLY.	Date April 2023	Chk JK

NOTE:
 1. REVIEW OF EXISTING DRAINAGE SYSTEM TO BE CARRIED OUT PRIOR TO THE COMMENCEMENT OF THE WORK.
 2. THE DRAINAGE SYSTEM IS A COMBINED DRAINAGE SYSTEM.
 3. THE RAINWATER DRAIN RUNS TO DISCHARGE INTO EXISTING COMBINED ST/ WASTE SYSTEM.
 4. THE FOGG DRAIN RUNS TO DISCHARGE INTO EXISTING COMBINED SOIL AND SEWER.
 5. ALL 100mm DIAM SURFACE / RAINWATER WATER DRAIN RUNS UNDER STRUCTURE TO BE DISCARSED IN 150mm DEEP CONCRETE WITH PRECAST CONC LINTOLS OVER.
 6. ALL DERIVED DRAIN RUNS, AIS AND GUTTS TO BE REMOVED AND FILLED IN WITH JETTABLE MATERIAL.

No. 3.