

NOTES

- THIS DRAWING IS TO BE READ IN CONJUNCTION WITH THE RELEVANT SPECIFICATIONS AND DRAWING STANDARDS.
- FIGURED DIMENSIONS ONLY TO BE TAKEN FROM THIS DRAWING. ALL DIMENSIONS TO BE CHECKED ON SITE. ENGINEER TO BE INFORMED IMMEDIATELY OF ANY DISCREPANCIES BEFORE ANY WORK PROCEEDS.
- REFER TO DRAWING 20047-DOW-00-XX-00-00-000 FOR PROJECT SPECIFICATION.

| PROJECT INFORMATION | |
|---------------------|----------------------------------|
| PROJECT NO. | 20047-DOW-00-XX-00-00-000 |
| DATE | 10/20/20 |
| SCALE | AS SHOWN |
| PROJECT NAME | CLONBRONE DUBLIN, EUROPE, EUROPE |



CLONBRONE
DUBLIN, EUROPE, EUROPE

SC-740 STORM TECH CHAMBER SPECIFICATIONS

- CHAMBERS SHALL BE STANDARD SIZE.
- CHAMBERS SHALL BE MANUFACTURED FROM HIGH DENSITY POLYPROPYLENE (HDPE) WITH A MINIMUM WALL THICKNESS OF 10mm.
- CHAMBERS SHALL BE MANUFACTURED FROM POLYPROPYLENE (PP) COMPAUNDED WITH GLASS FIBRE REINFORCEMENT.
- CHAMBERS SHALL BE MANUFACTURED WITH AN INTERNAL SUPPORT STRUCTURE TO MAINTAIN THE CHAMBER'S RIGIDITY UNDER LOADS.
- THE STRUCTURAL DESIGN OF THE CHAMBERS SHALL BE IN ACCORDANCE WITH THE REQUIREMENTS OF THE EUROPEAN STANDARD EN 12409-1.
- CHAMBERS SHALL BE MANUFACTURED WITH AN INTERNAL SUPPORT STRUCTURE TO MAINTAIN THE CHAMBER'S RIGIDITY UNDER LOADS.
- CHAMBERS SHALL BE MANUFACTURED WITH AN INTERNAL SUPPORT STRUCTURE TO MAINTAIN THE CHAMBER'S RIGIDITY UNDER LOADS.
- CHAMBERS SHALL BE MANUFACTURED WITH AN INTERNAL SUPPORT STRUCTURE TO MAINTAIN THE CHAMBER'S RIGIDITY UNDER LOADS.
- CHAMBERS SHALL BE MANUFACTURED WITH AN INTERNAL SUPPORT STRUCTURE TO MAINTAIN THE CHAMBER'S RIGIDITY UNDER LOADS.
- CHAMBERS SHALL BE MANUFACTURED WITH AN INTERNAL SUPPORT STRUCTURE TO MAINTAIN THE CHAMBER'S RIGIDITY UNDER LOADS.

IMPORTANT - NOTES FOR THE BIDDING AND INSTALLATION OF THE SC-740 SYSTEM

- SC-740 CHAMBERS SHALL BE INSTALLED ON A COMPACTED SUBGRADE.
- CHAMBERS SHALL BE INSTALLED IN ACCORDANCE WITH THE 'STORMTECH SC-740' CONSTRUCTION GUIDE.
- CHAMBERS SHALL BE MANUFACTURED WITH AN INTERNAL SUPPORT STRUCTURE TO MAINTAIN THE CHAMBER'S RIGIDITY UNDER LOADS.
- CHAMBERS SHALL BE MANUFACTURED WITH AN INTERNAL SUPPORT STRUCTURE TO MAINTAIN THE CHAMBER'S RIGIDITY UNDER LOADS.
- CHAMBERS SHALL BE MANUFACTURED WITH AN INTERNAL SUPPORT STRUCTURE TO MAINTAIN THE CHAMBER'S RIGIDITY UNDER LOADS.
- CHAMBERS SHALL BE MANUFACTURED WITH AN INTERNAL SUPPORT STRUCTURE TO MAINTAIN THE CHAMBER'S RIGIDITY UNDER LOADS.
- CHAMBERS SHALL BE MANUFACTURED WITH AN INTERNAL SUPPORT STRUCTURE TO MAINTAIN THE CHAMBER'S RIGIDITY UNDER LOADS.
- CHAMBERS SHALL BE MANUFACTURED WITH AN INTERNAL SUPPORT STRUCTURE TO MAINTAIN THE CHAMBER'S RIGIDITY UNDER LOADS.
- CHAMBERS SHALL BE MANUFACTURED WITH AN INTERNAL SUPPORT STRUCTURE TO MAINTAIN THE CHAMBER'S RIGIDITY UNDER LOADS.
- CHAMBERS SHALL BE MANUFACTURED WITH AN INTERNAL SUPPORT STRUCTURE TO MAINTAIN THE CHAMBER'S RIGIDITY UNDER LOADS.

| NO. | DESCRIPTION | QUANTITY | UNIT | REMARKS |
|-----|-------------------|----------|------|---------|
| 1 | SC-740 CHAMBER | 1 | EA | |
| 2 | SC-740 END CAP | 1 | EA | |
| 3 | SC-740 ISOLATOR | 1 | EA | |
| 4 | SC-740 GRATE | 1 | EA | |
| 5 | SC-740 COVER | 1 | EA | |
| 6 | SC-740 INSULATION | 1 | EA | |
| 7 | SC-740 SAND | 1 | EA | |
| 8 | SC-740 GRAVEL | 1 | EA | |
| 9 | SC-740 ASPHALT | 1 | EA | |
| 10 | SC-740 CONCRETE | 1 | EA | |

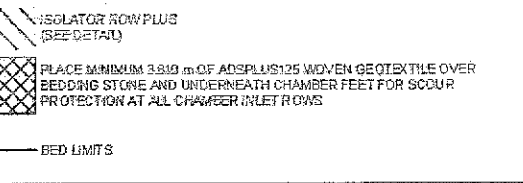
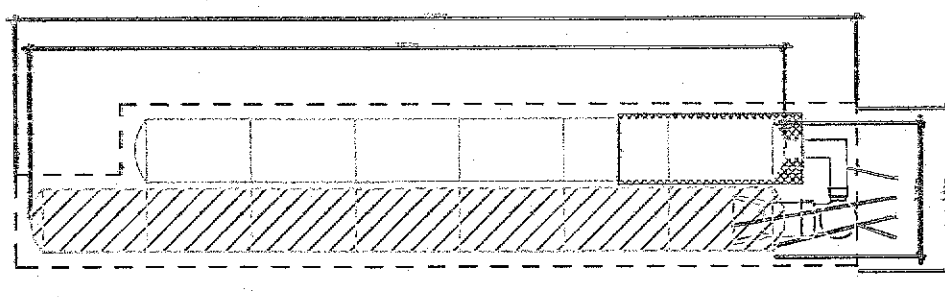

ACCEPTABLE FILL MATERIALS: STORMTECH SC-740 CHAMBER SYSTEMS

| MATERIAL LOCATION | DESCRIPTION | ASHTO MATERIAL CLASSIFICATION | COMPACTION / DENSITY REQUIREMENT |
|-------------------|------------------|-------------------------------|----------------------------------|
| 1 | Subgrade | Subgrade | 95% Proctor Density |
| 2 | Chamber Bed | Chamber Bed | 95% Proctor Density |
| 3 | Chamber Surround | Chamber Surround | 95% Proctor Density |
| 4 | Chamber Top | Chamber Top | 95% Proctor Density |
| 5 | Chamber Base | Chamber Base | 95% Proctor Density |

- REMARKS:**
- THE FILL MATERIALS SPECIFIED ARE FOR GUIDANCE ONLY. THE CONTRACTOR SHALL BE RESPONSIBLE FOR OBTAINING THE NECESSARY TEST RESULTS FOR ALL MATERIALS USED.
 - WHEREVER THE CONTRACTOR IS REQUIRED TO PLACE OR COMPACT MATERIALS TO A SPECIFIC DENSITY, THE CONTRACTOR SHALL BE RESPONSIBLE FOR OBTAINING THE NECESSARY TEST RESULTS.
 - WHEREVER THE CONTRACTOR IS REQUIRED TO PLACE OR COMPACT MATERIALS TO A SPECIFIC DENSITY, THE CONTRACTOR SHALL BE RESPONSIBLE FOR OBTAINING THE NECESSARY TEST RESULTS.
 - WHEREVER THE CONTRACTOR IS REQUIRED TO PLACE OR COMPACT MATERIALS TO A SPECIFIC DENSITY, THE CONTRACTOR SHALL BE RESPONSIBLE FOR OBTAINING THE NECESSARY TEST RESULTS.

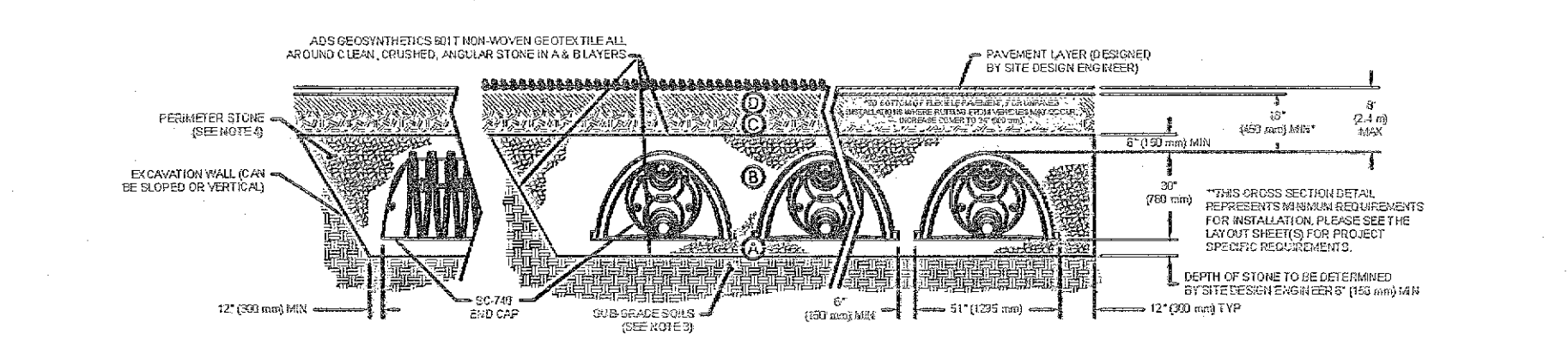

- NOTES:**
- CHAMBERS SHALL BE MANUFACTURED WITH AN INTERNAL SUPPORT STRUCTURE TO MAINTAIN THE CHAMBER'S RIGIDITY UNDER LOADS.
 - CHAMBERS SHALL BE MANUFACTURED WITH AN INTERNAL SUPPORT STRUCTURE TO MAINTAIN THE CHAMBER'S RIGIDITY UNDER LOADS.
 - CHAMBERS SHALL BE MANUFACTURED WITH AN INTERNAL SUPPORT STRUCTURE TO MAINTAIN THE CHAMBER'S RIGIDITY UNDER LOADS.
 - CHAMBERS SHALL BE MANUFACTURED WITH AN INTERNAL SUPPORT STRUCTURE TO MAINTAIN THE CHAMBER'S RIGIDITY UNDER LOADS.
 - CHAMBERS SHALL BE MANUFACTURED WITH AN INTERNAL SUPPORT STRUCTURE TO MAINTAIN THE CHAMBER'S RIGIDITY UNDER LOADS.

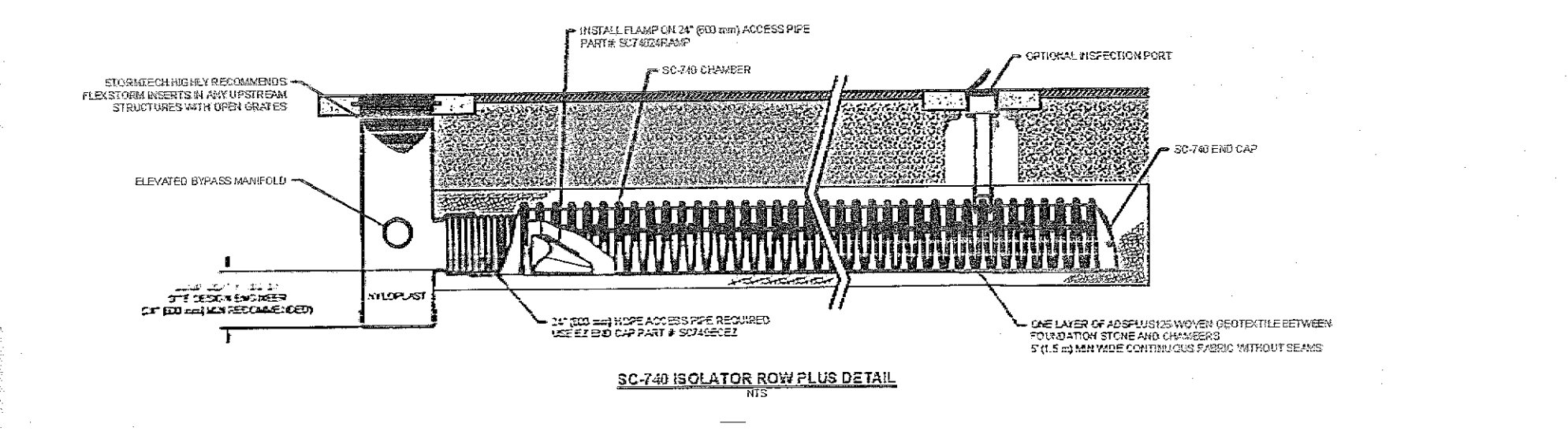

- INSPECTION & MAINTENANCE**
- INSPECTION AND MAINTENANCE SHALL BE PERFORMED AT THE FOLLOWING INTERVALS:
 - INSPECTION AND MAINTENANCE SHALL BE PERFORMED AT THE FOLLOWING INTERVALS:
 - INSPECTION AND MAINTENANCE SHALL BE PERFORMED AT THE FOLLOWING INTERVALS:
 - INSPECTION AND MAINTENANCE SHALL BE PERFORMED AT THE FOLLOWING INTERVALS:
 - INSPECTION AND MAINTENANCE SHALL BE PERFORMED AT THE FOLLOWING INTERVALS:

SC-740 TECHNICAL SPECIFICATION

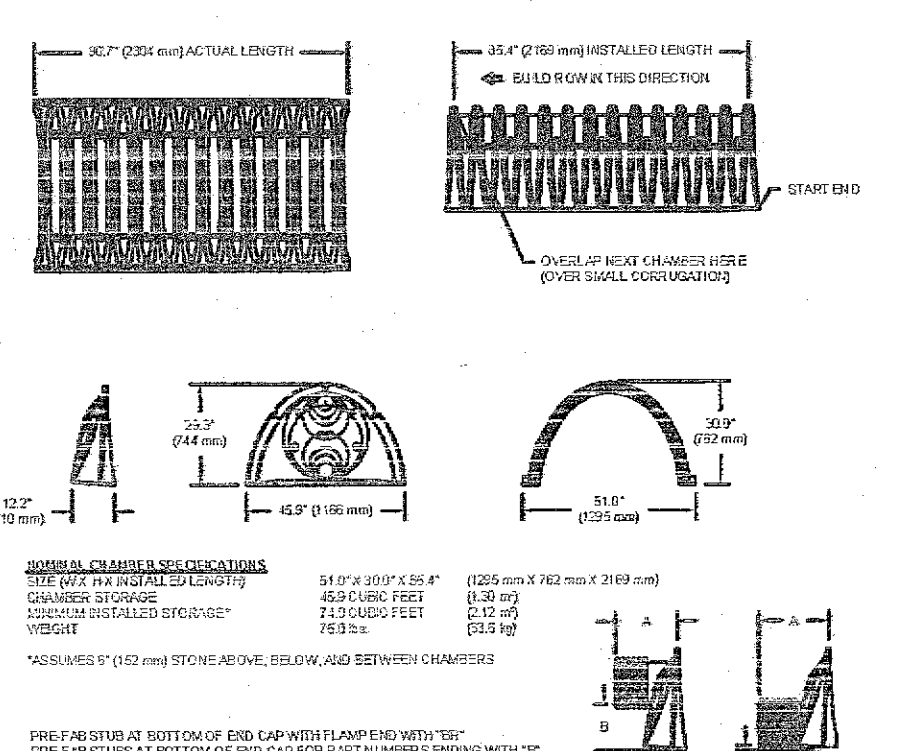

WYLOFAST DRAIN BASIN

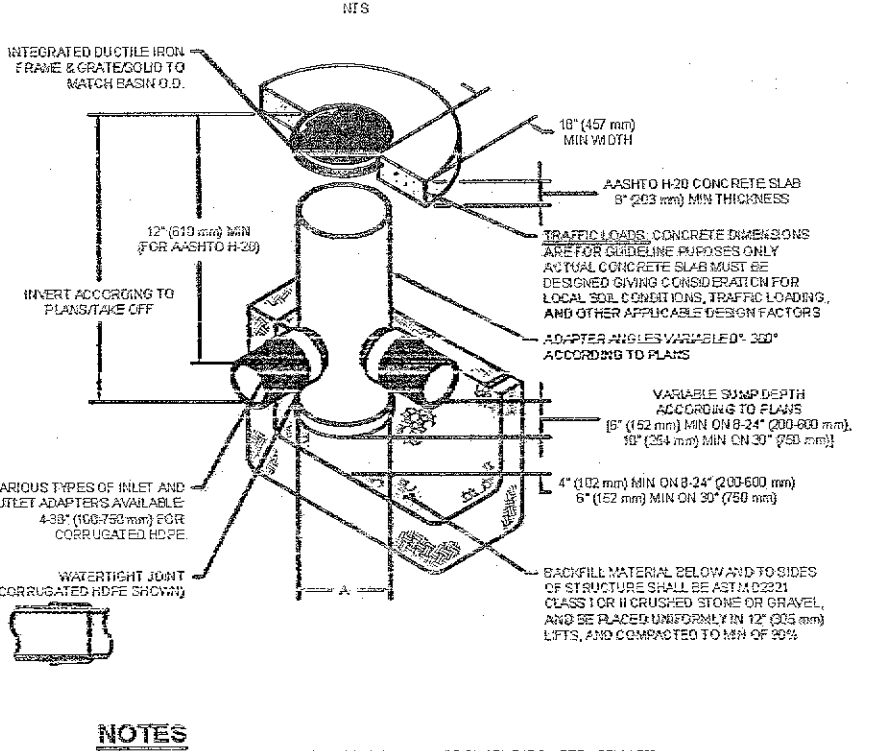

| PART # | STUD | A | B | C |
|--------|------|------|------|------|
| 1 | 100 | 100 | 100 | 100 |
| 2 | 150 | 150 | 150 | 150 |
| 3 | 200 | 200 | 200 | 200 |
| 4 | 250 | 250 | 250 | 250 |
| 5 | 300 | 300 | 300 | 300 |
| 6 | 350 | 350 | 350 | 350 |
| 7 | 400 | 400 | 400 | 400 |
| 8 | 450 | 450 | 450 | 450 |
| 9 | 500 | 500 | 500 | 500 |
| 10 | 550 | 550 | 550 | 550 |
| 11 | 600 | 600 | 600 | 600 |
| 12 | 650 | 650 | 650 | 650 |
| 13 | 700 | 700 | 700 | 700 |
| 14 | 750 | 750 | 750 | 750 |
| 15 | 800 | 800 | 800 | 800 |
| 16 | 850 | 850 | 850 | 850 |
| 17 | 900 | 900 | 900 | 900 |
| 18 | 950 | 950 | 950 | 950 |
| 19 | 1000 | 1000 | 1000 | 1000 |

- NOTES:**
- CHAMBERS SHALL BE MANUFACTURED WITH AN INTERNAL SUPPORT STRUCTURE TO MAINTAIN THE CHAMBER'S RIGIDITY UNDER LOADS.
 - CHAMBERS SHALL BE MANUFACTURED WITH AN INTERNAL SUPPORT STRUCTURE TO MAINTAIN THE CHAMBER'S RIGIDITY UNDER LOADS.
 - CHAMBERS SHALL BE MANUFACTURED WITH AN INTERNAL SUPPORT STRUCTURE TO MAINTAIN THE CHAMBER'S RIGIDITY UNDER LOADS.
 - CHAMBERS SHALL BE MANUFACTURED WITH AN INTERNAL SUPPORT STRUCTURE TO MAINTAIN THE CHAMBER'S RIGIDITY UNDER LOADS.
 - CHAMBERS SHALL BE MANUFACTURED WITH AN INTERNAL SUPPORT STRUCTURE TO MAINTAIN THE CHAMBER'S RIGIDITY UNDER LOADS.

| | |
|--------------------------------------|---|
| PROJECT | PROPOSED HOUSING DEVELOPMENT AT CLONBRONE, LUCAN, DUBLIN 20 |
| CLIENT | NACUL DEVELOPMENTS Ltd |
| DRAWING TITLE | ATTENUATION DETAILS |
| DATE | 10/20/20 |
| SCALE | AS SHOWN |
| PROJECT NO. | 20047-5008 |
| DRAWING NO. | P01 |
| AP - PLANNING | |
| Subsidiary Status Code - Description | |
| Client Business Centre | Cashel Road, Kilmagee, Dublin 12 |
| Tel | 01 4501811 |
| Email | adam@downesassociates.ie |
| Website | www.downesassociates.ie |

