

GENERAL NOTES

1. ALL LEVELS IN METRES ABOVE ORDNANCE DATUM.
2. ALL DRAINAGE DETAILS TO BE SUBMITTED AND AGREED WITH SOUTH DUBLIN COUNTY COUNCIL PRIOR TO COMMENCEMENT OF WORKS.
3. CONTRACTOR TO TRACE ALL SERVICES WITHIN SITE BOUNDARY TO ASCERTAIN OUTFALL LOCATIONS OF ALL DRAIN RUNS & LOCATION OF ALL LIVE SERVICES PRIOR TO COMMENCEMENT OF SITE CLEARANCE WORKS.
4. CONTRACTOR TO AGREE ANY DIVERSIONS WHERE NECESSARY WITH CONSULTANTS / LOCAL AUTHORITY.
5. INVERT & COVER LEVELS ARE INDICATIVE ONLY. DRAIN RUNS & LEVELS ARE TO BE AGREED WITH SOUTH DUBLIN COUNTY COUNCIL PRIOR TO COMMENCEMENT OF WORKS.
6. PIPES LAID IN ROADWAYS TO BE ENCASED IN 150MM CONCRETE WHERE COVER TO PIPE IS LESS THAN 1.7M. PIPES LAID IN OPEN SPACES TO BE ENCASED IN 150MM CONCRETE WHERE COVER TO PIPE IS LESS THAN 0.9M.
7. CONTRACTOR TO ENSURE FULL COORDINATION WITH ALL OTHER UNDERGROUND SERVICES PRIOR TO COMMENCEMENT OF WORKS.

CIVIL LEGEND	
EX SURFACE WATER
SURFACE WATER
EX WASTE WATER	-----
WASTE WATER	-----
FOUL ACCESS JUNCTION
SURFACE WATER INSPECTION CHAMBER
RAINWATER PIPE
SOIL VENT PIPE
ROAD GULLEY
BACK INLET GULLEY TRAP
FOUL RODDING EYE
SURFACE RODDING EYE
GULLEY TRAP
EX WATERMAIN
WATERMAIN
SLUICE VALVE
STOP COCK
AIR VALVE
FIRE HYDRANT
MAGNETIC FLOW WATER METER
IRRIGATION VALVE
TRUST BLOCK
BASEMENT OUTLINE

CE
CK

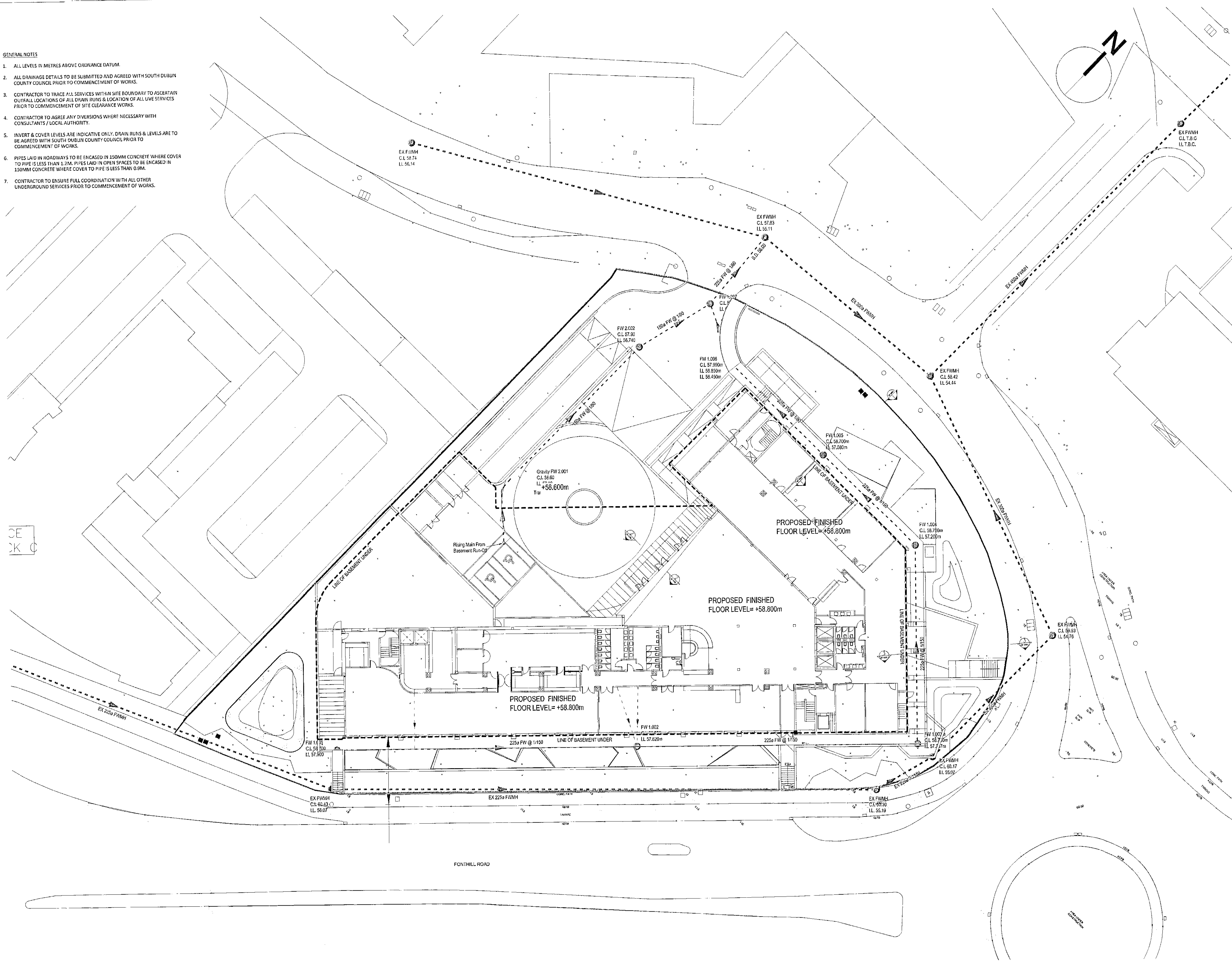

Rev	Sts	Description	Date
P01	S2	Issued for Information	14.11.22
P02	S2	Issued for Planning	08.12.22
P03	S2	Issued In Response To RFI	18.04.23

MMOS The Chapel,
Blackrock House,
Blackrock Road,
Cork, T12 KRK7
Tel: 353 21 4317608

PROJECT
Hotel Development, Site D,
Liffey Valley

CLIENT
Winmar Developments Unlimited
Company

TITLE
Foul Sewer Layout Plan

DRAWN BY AR	CHECKED BY DOS	APPROVED BY DOS
SCALE 1:250 (A1)	PROJECT NUMBER 22265	
DOCUMENT REFERENCE 22265-MMS-ZZ-ST-DR-C-10000		STATUS S2
PROJECT ORIGINATOR ZONE LEVEL TYPE DIC LINE NUMBER		REV P03

Proposed Foul Sewer Layout
Scale 1:250 (A1)