

APPLICANT: MR. PETER LAWLOR
EXISTING DEVELOPMENT AT MOUNTPELIER,
BOHERNABREENA, DUBLIN 24

SuDS MANAGEMENT PLAN

PATRICK JOYCE ASSOCIATES
CONSULTING ENGINEERS
2 PROSPECT GROVE
STOCKING LANE,
RATHFARNHAM,
DUBLIN 16.

APRIL 2023

PATRICK JOYCE ASSOCIATES

Consulting Engineers

2 Prospect Grove,
Stocking Lane,
Rathfarnham,
Dublin 16

Tel: (01) 4946745
Mobile: 087 2476375

Email: patrickjoyceassociates@gmail.com

PATRICK C. JOYCE BE, MBA, C.Eng., MIEI

APPLICANT: MR. PETER LAWLOR

EXISTING DEVELOPMENT AT MOUNTPELIER,

BOHERNABREENA, DUBLIN 24

SuDS MANAGEMENT PLAN

Introduction:

The proposed development consists of single storey extension to the rear of the existing dwelling-house at Mountpelier, Bohernabreena, Dublin 24.

It is proposed that the surface water drainage system should incorporate, where practical, green infrastructure measures to mitigate and compensate for the impact of the proposed development on the existing site. The measures should include SuDS measures such as gravel paving surfaces, water butts for water recycling and grass swale.

The rainwater run-off from the existing dwelling-house discharges to the existing stone filled soakaways located within the existing site. The runoff from the existing tarmac surface at the entrance to the dwelling-house site and on the existing road to the family farm discharges to the existing stone filled soakaway located inside the site entrance.

It is proposed to discharge the rainwater runoff from the proposed extension to a new Grass Swale located where shown on the Drainage Layout Plan.

Proposed Green Infrastructure and SuDS Measures:

The proposed surface water drainage system shall incorporate, where practical, green infrastructure measures to mitigate and compensate for the impact of the proposed development on the existing site. The measures shall include additional landscaping features together with SuDS measures such as gravel paving surfaces, water butts for water recycling and grass swale.

Details of the proposed landscaping measures are provided on the Landscape Architect's Drawings and Landscape Specification prepared by Landmark Design & Consultancy Limited.

The proposed measures specific to the proposed development include the following:

- Discharge of the rainwater runoff from the proposed extension to a new Grass Swale located where shown on the Drainage Layout Plan.
- The provision of 2 No. 200 litre water butts, for rainwater recycling, where shown on Drainage Layout Plan.

These SuDS measures shall be incorporated to minimise the impact of the surface water run-off on water quality and quantity and to maximise the amenity and biodiversity opportunities within the proposed development.

Hence, all of the rainwater run-off resulting from the proposed development shall be disposed off by SuDS type measures. All surface water run-off generated from structures or hard surfaces within the site shall be disposed off within the site and there shall be no run-off to watercourses.

SuDS Management Plan:

As outlined above, the proposed surface water drainage system shall incorporate green infrastructure measures to mitigate and compensate for the impact of the proposed development on the existing site.

The applicant shall implement a comprehensive maintenance plan in respect of the surface water system including maintenance of the SuDS features. Where possible the idea of 'passive maintenance' shall be considered with SuDS components integrated into the everyday management of the proposed development and site. Where possible, the maintenance should take place as part of the landscape management and maintenance. Responsibility for the maintenance shall be the applicant's or other experienced personnel nominated by the applicant.

SuDS & Site Maintenance Schedule:

Grass Verges: Mow all grass verges at 35 – 50 mm with 75 mm max monthly in growing season or as required.

Grass Swale: Mow the dry grass swale at 100 mm with 150 mm max every six weeks during growing season or as required. Inspect grass swale inlet monthly, remove silt and leaves etc.

General SuDS: Inspect SuDS system to check for damage or failure when carrying out other tasks monthly. Undertake remedial work as required.

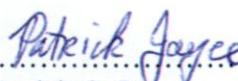
Signed: 
Patrick C. Joyce
Patrick Joyce Associates

Date: 13th April 2023

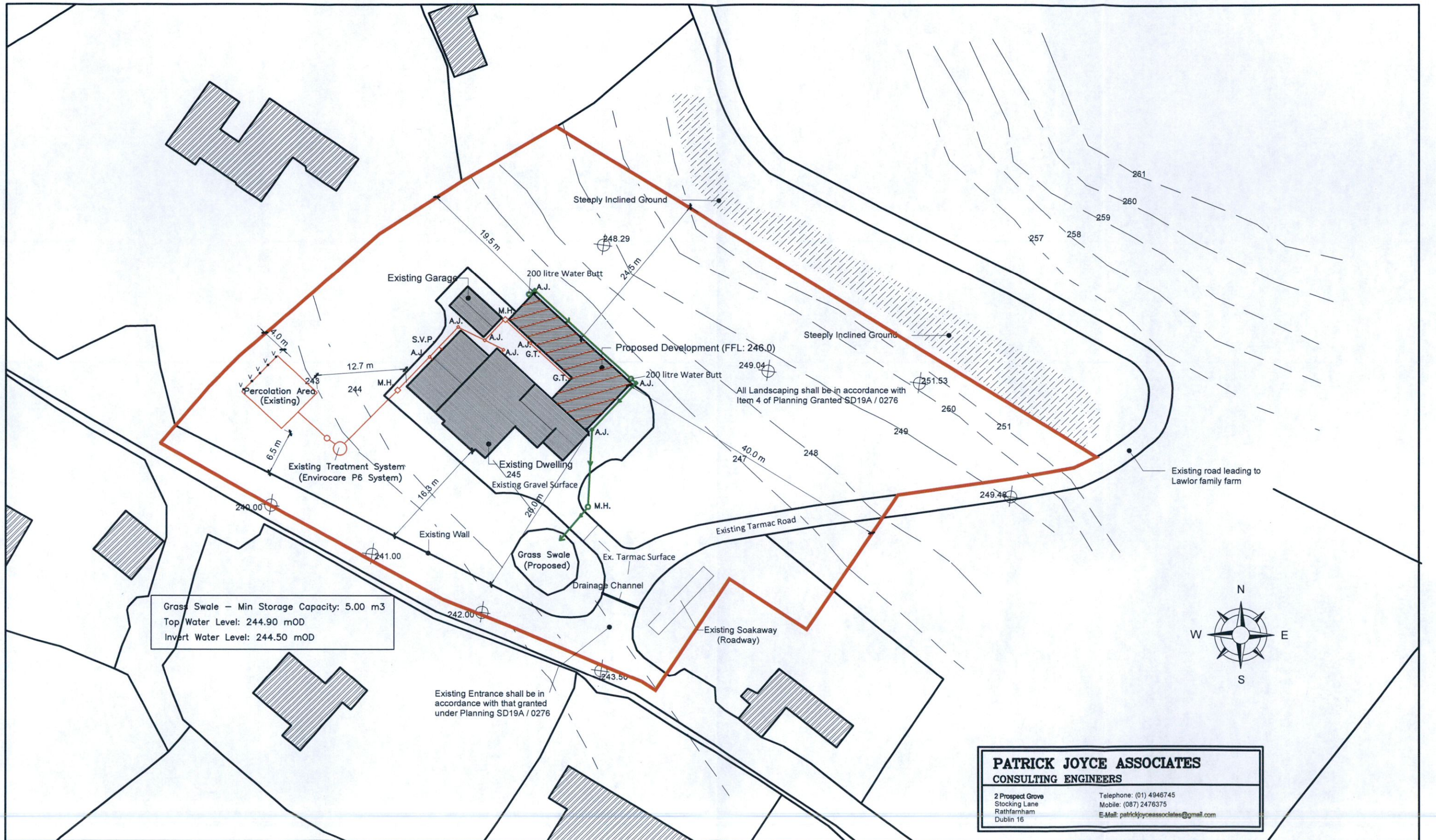

Grass Swale – Min Storage Capacity: 5.00 m3
 Top Water Level: 244.90 mOD
 Invert Water Level: 244.50 mOD

PATRICK JOYCE ASSOCIATES
 CONSULTING ENGINEERS

2 Prospect Grove
 Stocking Lane
 Rathfarnham
 Dublin 16

Telephone: (01) 4946745
 Mobile: (087) 2476375
 E-Mail: patrickjoyceassociates@gmail.com

MCGILLEN DESIGN SERVICES
 PLANNING AND PROJECT MANAGEMENT

BURGAGE
 BLESSINGTON
 Co. WICKLOW.

Tel. (045) 891 468
 Mob. (087) 646 9079
 Email. petermcgillen@hotmail.com

COPYRIGHT:
 The design and details shown on this drawing are applicable to their project only and may not be reproduced in whole or in part or be used for any other project or purposes without the written permission of McGillen Design Services with whom the copyright resides.

DO NOT SCALE FROM THIS DRAWING.
 Use given dimensions. Contractor to check all dimensions on site prior to commencement of works. Any discrepancies are to be referred to the Site Architect / Engineer.

Date:	Issue:	Rev.	Description:
			Indicates New Works.

ISSUED FOR PLANNING PURPOSES ONLY				
CLIENT: Mr. Peter Lawlor	PROJECT: PROPOSED DEVELOPMENT AT MOUNTPELIER BOHERNABREENA CO. DUBLIN.	DRAWING TITLE: DRAINAGE LAYOUT PLAN		
PREPARED BY: P Mc Gillen	DATE: Dec. 2022	DWG. NO. PP010	SCALE: 1 : 500	REVISION: STATUS: