

1 2 3 4 5 6 7 8 9 10 11 12

Design originator:



www.burnsmcd.com/locations/London  
10 Bishops Square, London E1 6AO, United Kingdom  
www.burnsmcd.com/services

NOTES:

- 107mm HDPE smooth single wall RED service duct Stamped Public Lighting to be used from MCC Micro Pillar to Chambers and Retention Sockets.
- 2 x 107mm HDPE smooth single wall RED service duct Stamped Public Lighting to be used on Carriageway crossing.
- 50mm CD ESB Networks Approved RED service duct at 600mm depth with yellow ESB approved YELLOW warning tape at 300mm depth with 10mm draw rope to be used between ESB Networks Mini Pillar and MCC Micro Pillar. If distance between ESB mini Pillar and MCC Micro Pillar exceeds 50m, use 125 RED ESB Networks approved Duct.
- All ducts to be finish flush with Access Chamber Wall.

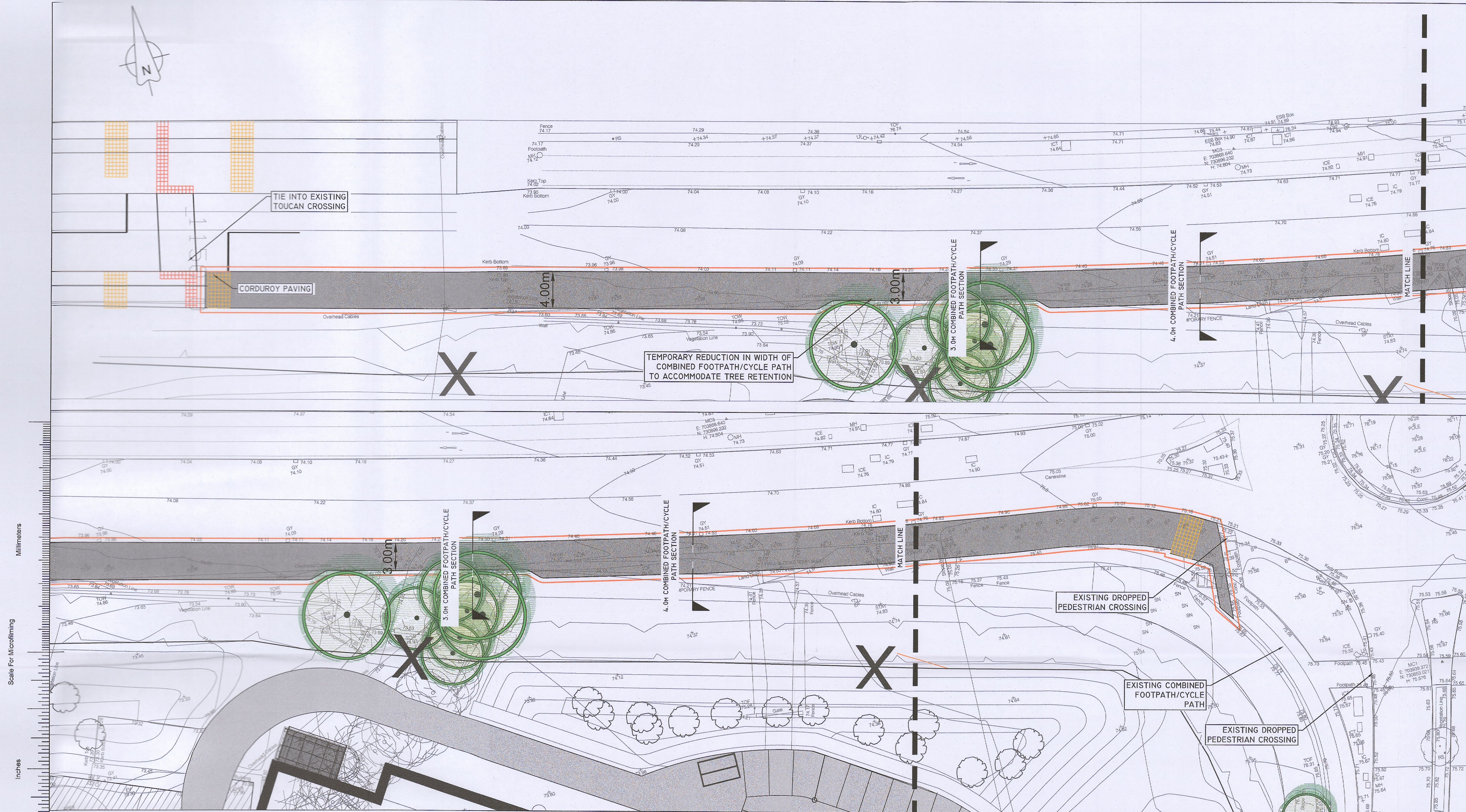

Scale For Microlimiting  
Millimeters  
Inches

V1	09/03/2023	RK	JM	ISSUED FOR PLANNING
Rev.	Rev. Date	Drawn By	Checked By	Description

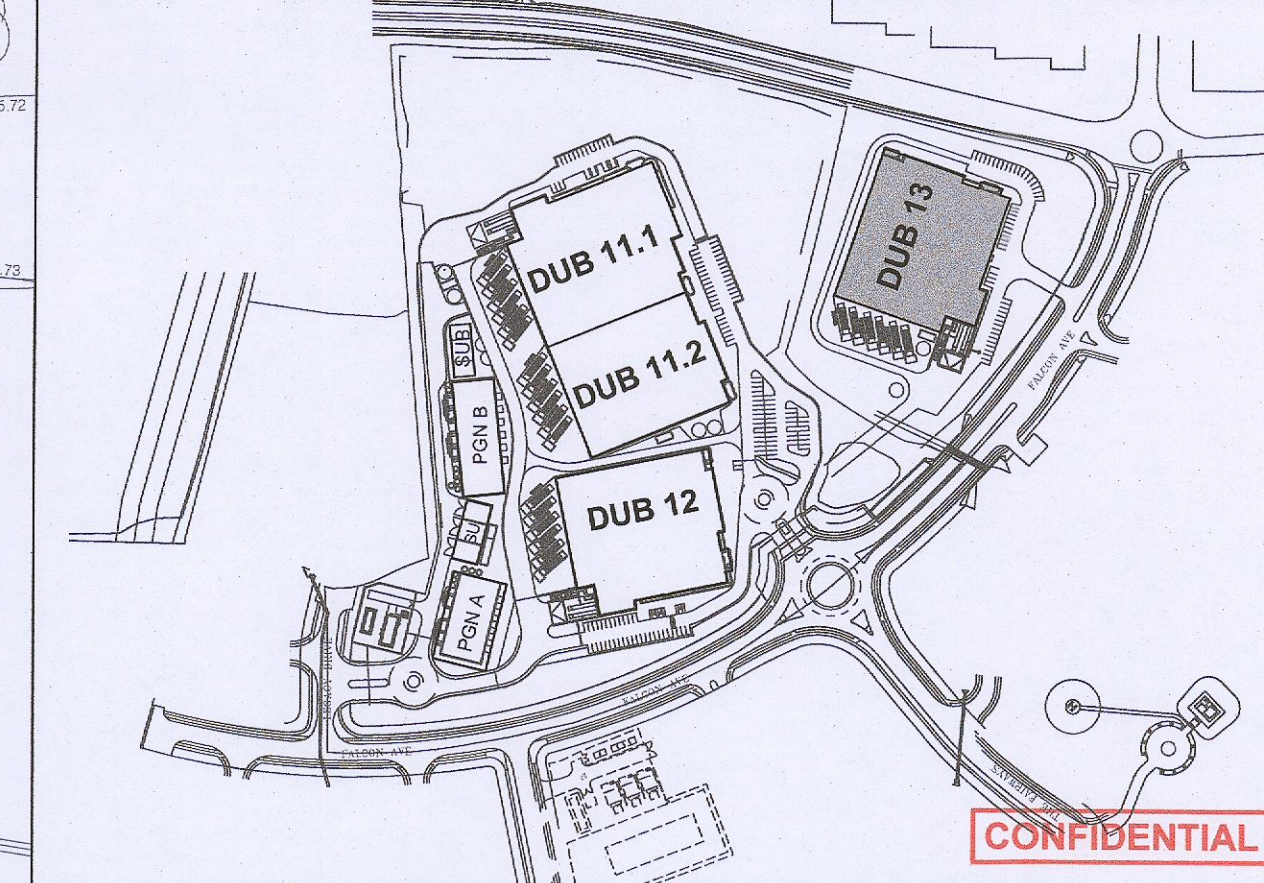

CONFIDENTIAL

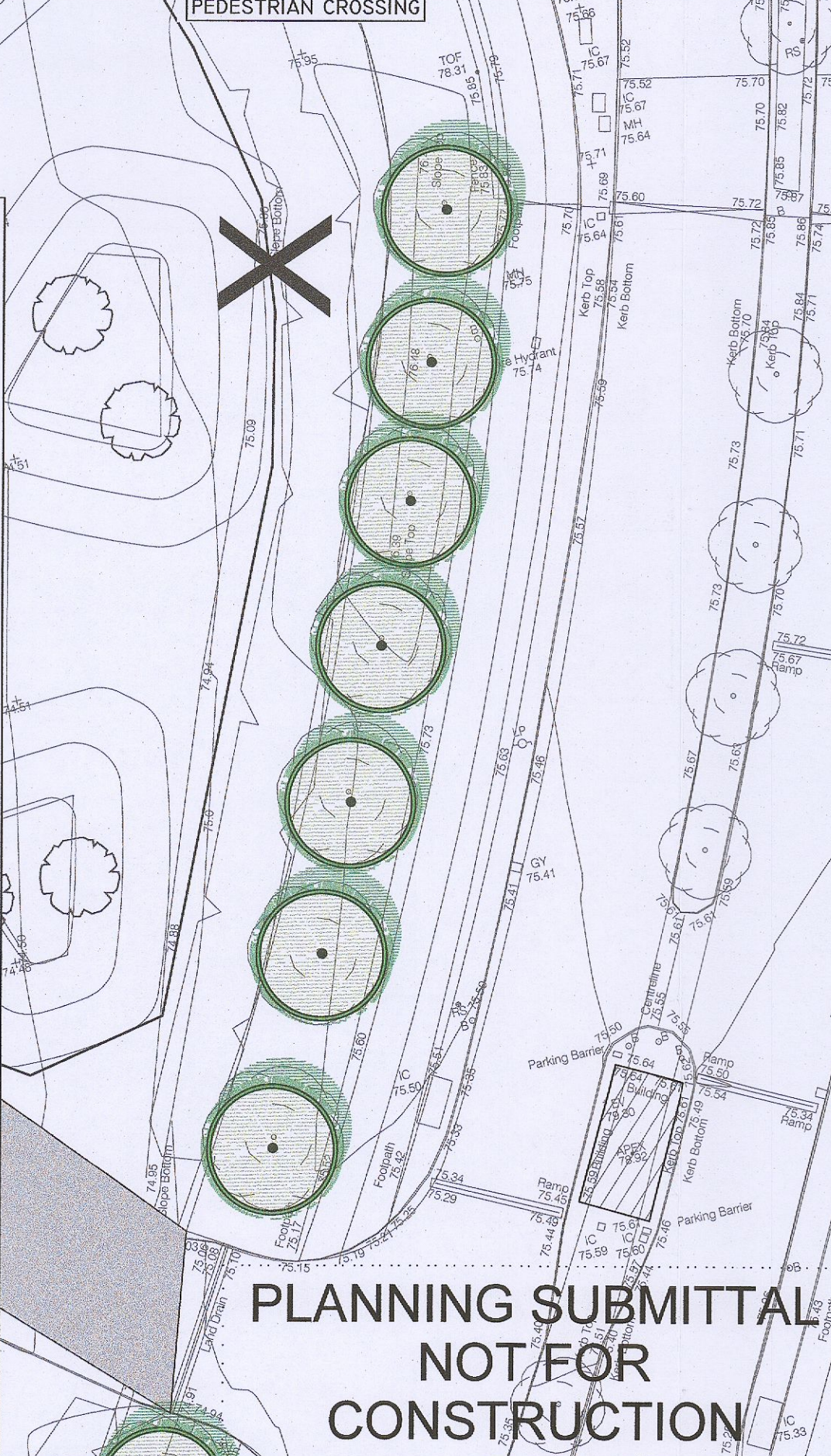
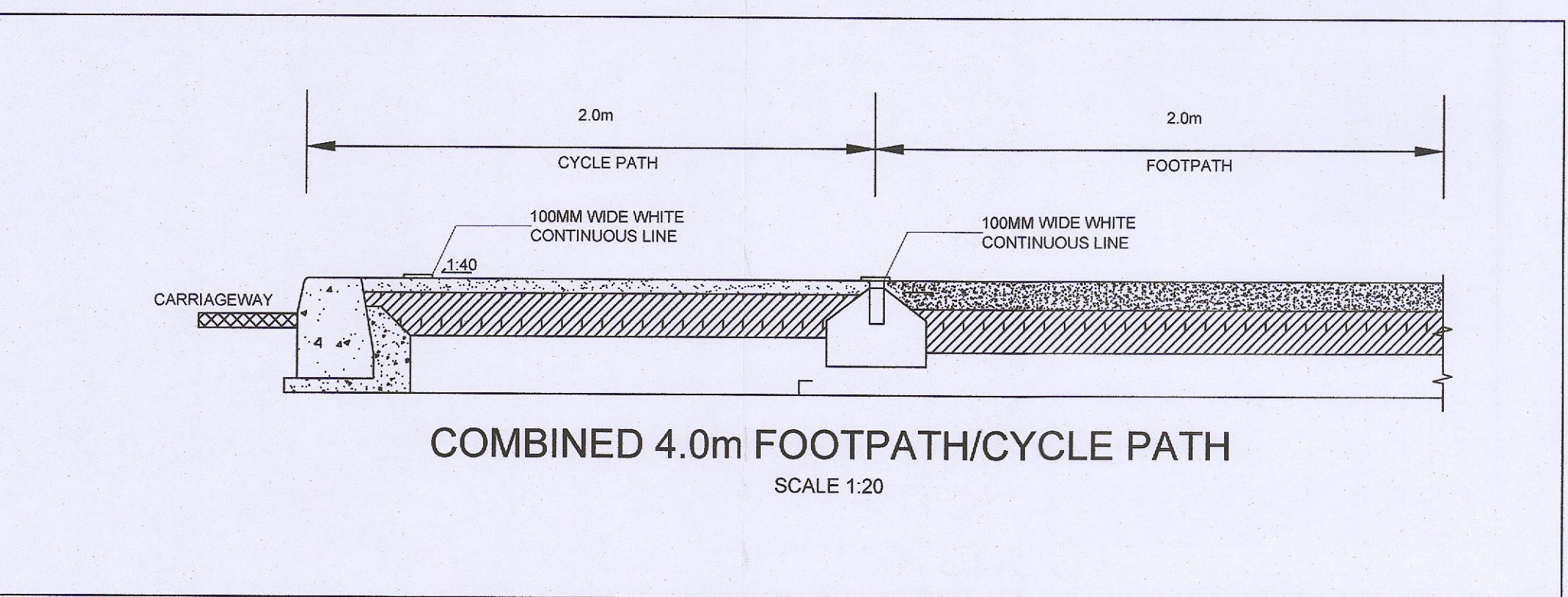
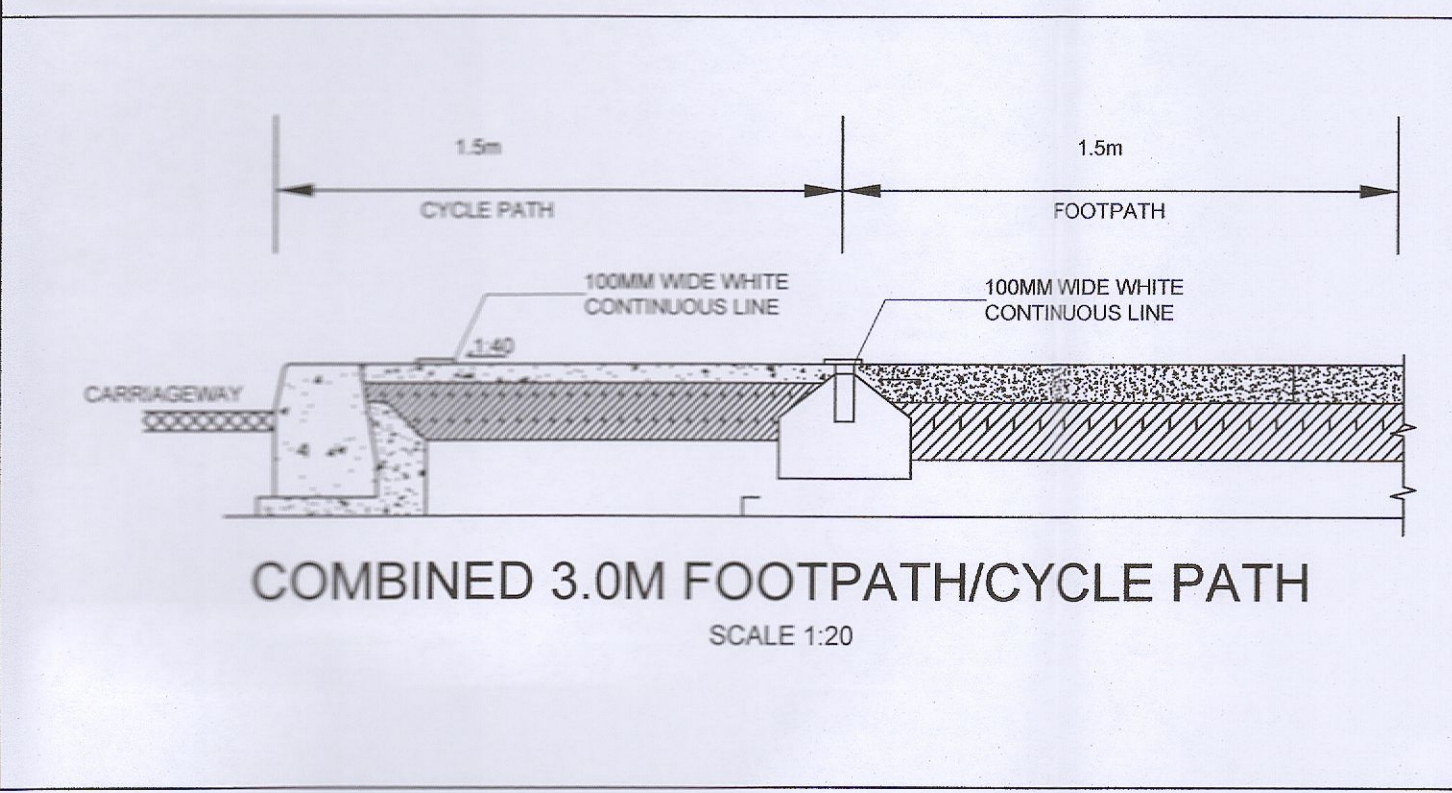
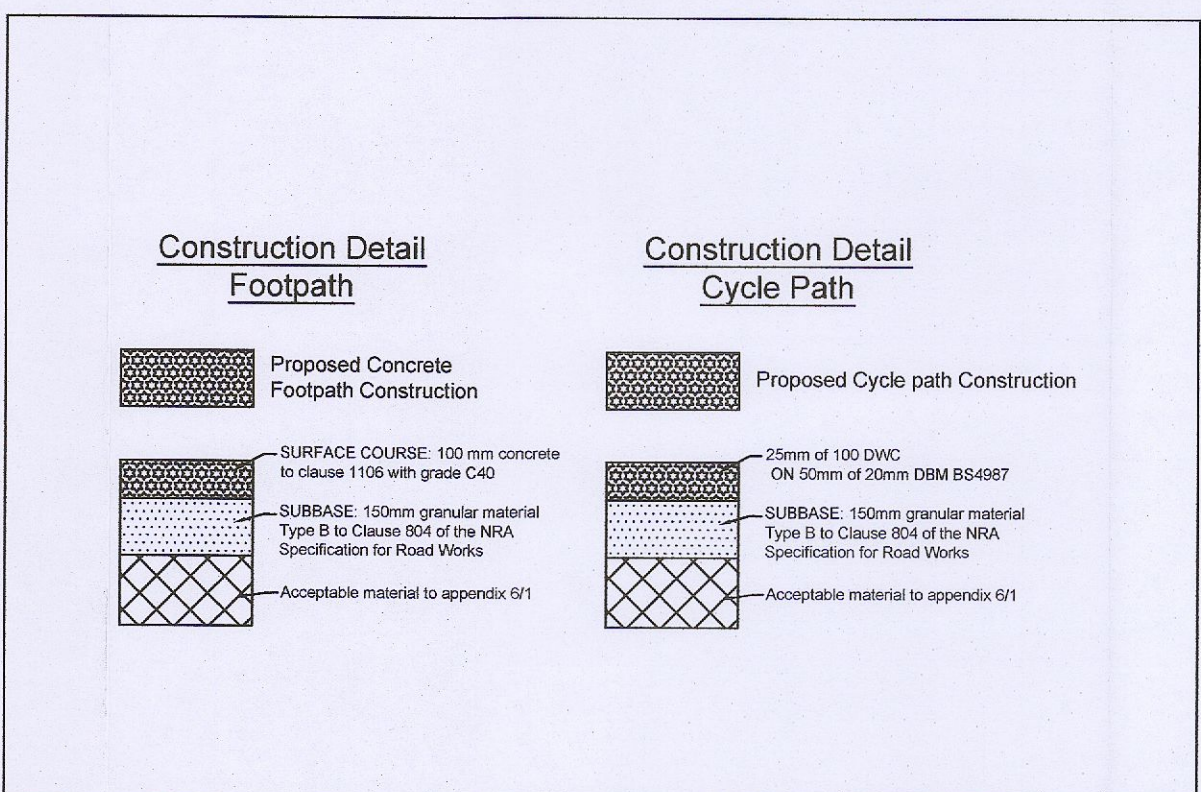
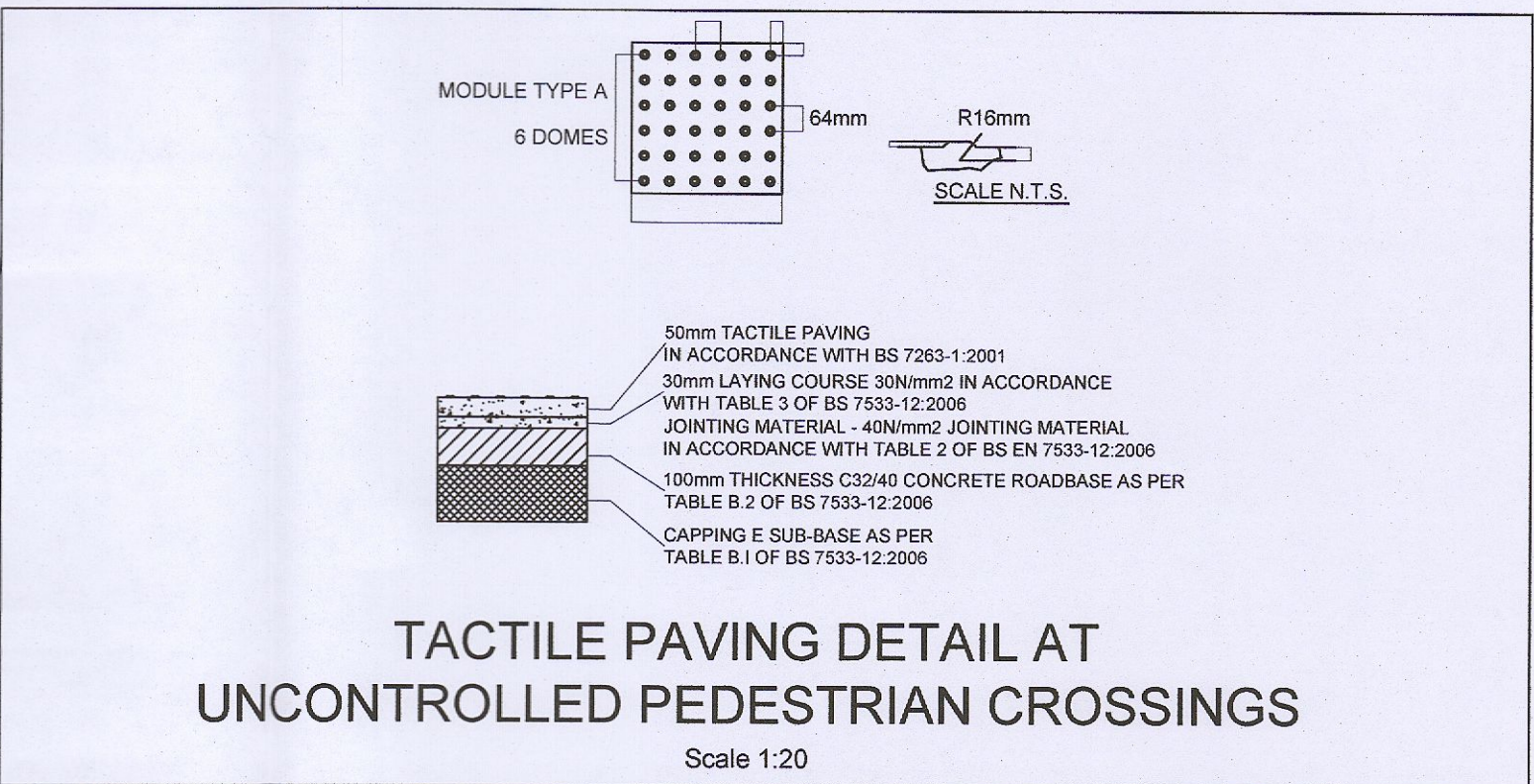
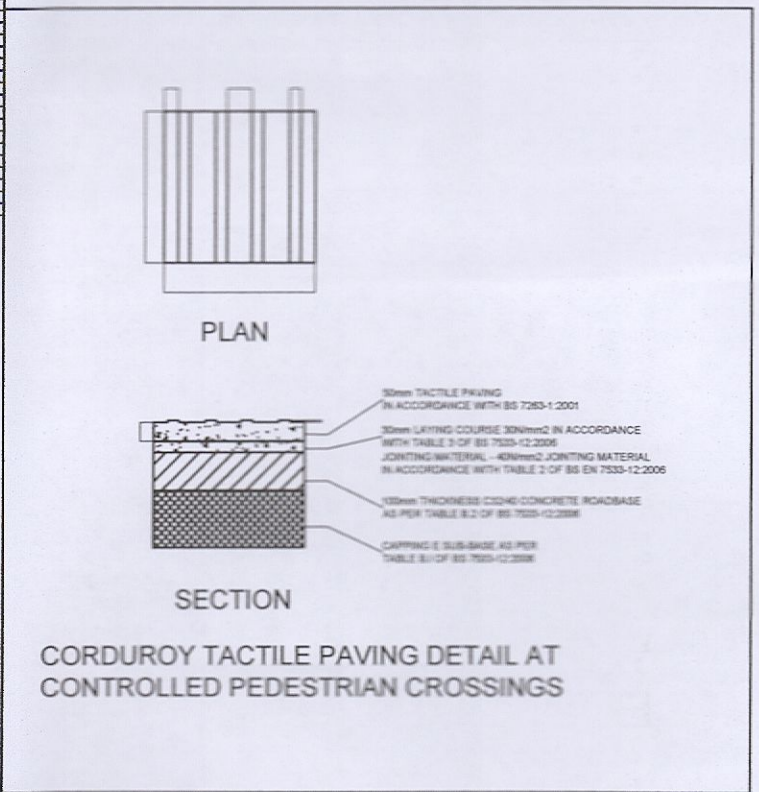

Client: <b>VANTAGE DATA CENTERS</b>	Architect: <b>Hyphen</b> HYPHEN ARCH-IRELAND LTD Unit G2, Avonmore House, Hill Street Monaghan, H16 H528 Republic of Ireland		
Mechanical/Electrical/Public Health/Automation/Telecoms/Security Fire Protection Engineer: <b>BURNS &amp; MCDONNELL</b> BURNS & MCDONNELL 10 Bishops Square London E1 6AO United Kingdom	Structural/Civils Engineer: <b>PINNACLE CONSULTING ENGINEERS</b> PINNACLE CONSULTING ENGINEERS Acherly, Bessmer Rd, Wexley Garden City, AL7 1HE United Kingdom		
Bill coordinator: AMB	Approved by: JM	Checked by: RK	Drawn by: RK
Project address: Profile Park, Dublin 22, Ireland 53° 19' 1.40"N 6° 28' 40.80"W			
Drawing title: EXTERNAL WORKS - FOOTPATH/CYCLE PATH			Sheet number: <b>C104</b>
Format / Size: A1 594x841	Scale: 1:200	Status: ISSUED	Date: 09/03/2023
File Code: DUB13-DR-SP-C104-V1-WS3-PIN	Rev: V1		