

GENERAL NOTES

- DO NOT SCALE THIS DRAWING. WORK ONLY TO FIGURED DIMENSIONS.
- FOR ALL RELEVANT NOTES, REFER TO STRUCTURAL AND CIVIL ENGINEERING PERFORMANCE SPECIFICATION.
- ANY DISCREPANCIES ARE TO BE REPORTED TO PINNACLE CONSULTING ENGINEERS IMMEDIATELY.
- THIS DRAWING IS TO BE READ IN CONJUNCTION WITH ALL OTHER RELEVANT ENGINEERS, ARCHITECTS AND SUB-CONTRACTORS DRAWINGS AND DETAILS.

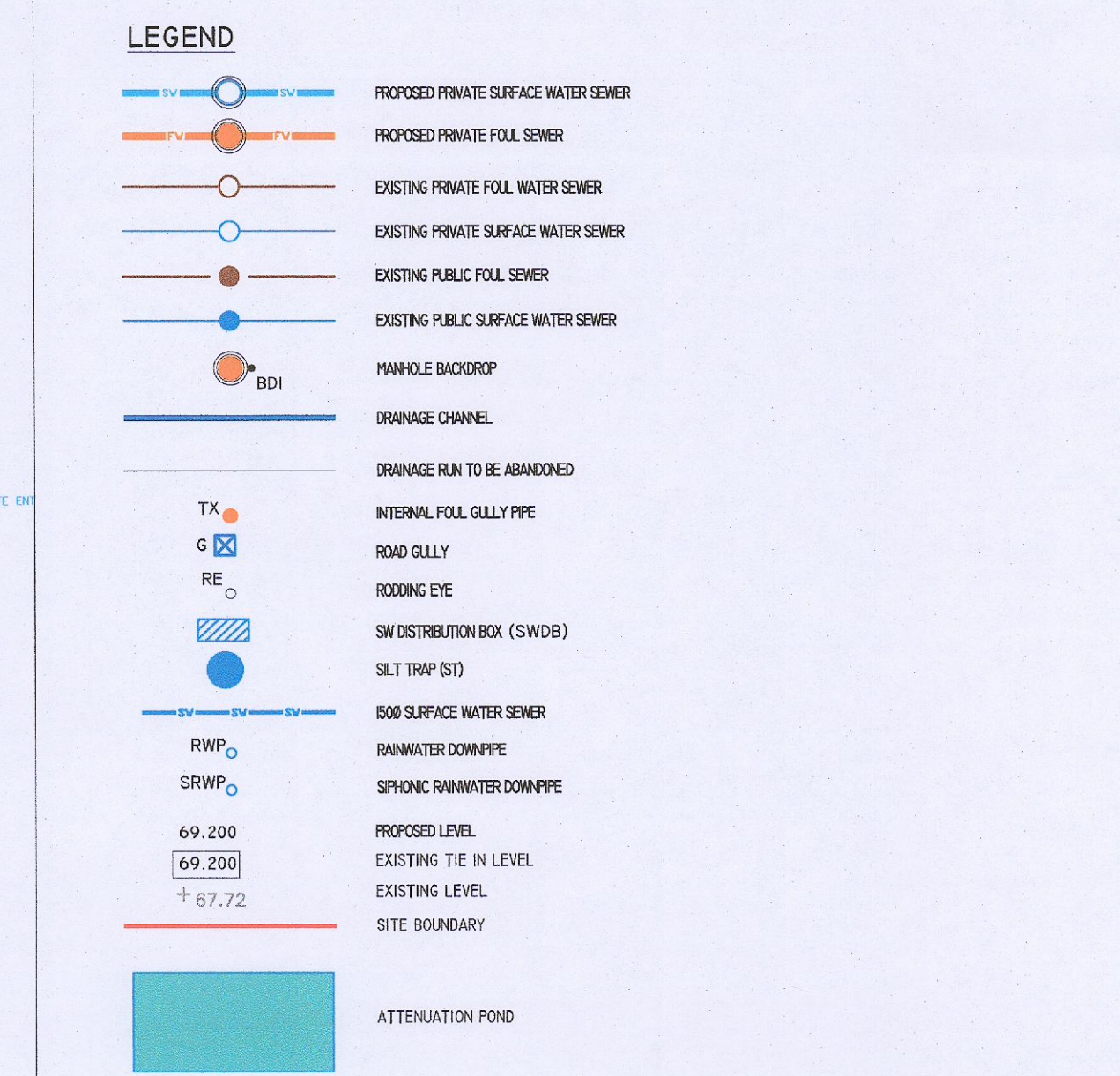

V4	13/03/2023	FJVR	SOR	SITE PLAN UPDATED
V3	08/02/2023	FJVR	SOR	SITE PLAN UPDATED
V2	09/09/2022	FJVR	SOR	ISSUED FOR PLANNING

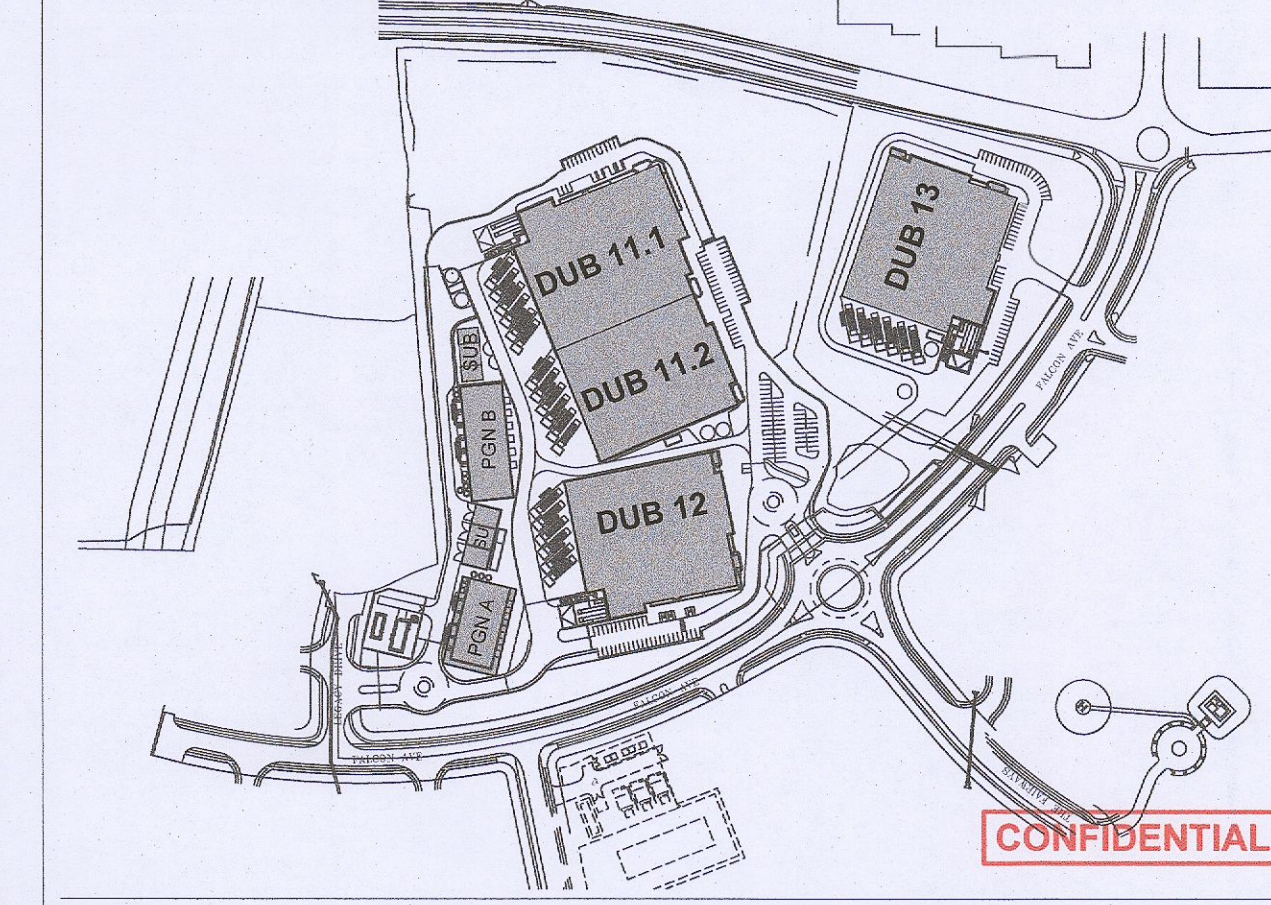

Client: **VANTAGE DATA CENTERS**
 Architect: **Hyphen**
 HYPHEN ARCHITECTURE LTD
 Unit G2, Avelon House, Hill Street, Monaghan, H18 H528, Republic of Ireland

Structural/Civils Engineer: **BURNS & MEDONNELL**
 10 Bishops Square, London E1 6AQ, United Kingdom
 Pinnacle Consulting Engineers
 Abbey, Bessmer Rd, Wexham Garden City, AL7 1HE, United Kingdom

Bill coordinator: **JM**
 Approved by: **JM**
 Checked by: **SOR**
 Drawn by: **FJVR**

Project address:
Profile Park, Dublin 22, Ireland
 53° 19' 1.40"N 6° 26' 40.80"W

Drawing title: **PROPOSED DRAINAGE LAYOUT**
 Sheet number: **127**

Format / Size:	Scale:	Status:	Date:	File Code:	Rev:
A1 594x841	1:500	ISSUED	09/09/2022	DUB13-DR-UG-C127-V2-WS4-PIN	V4

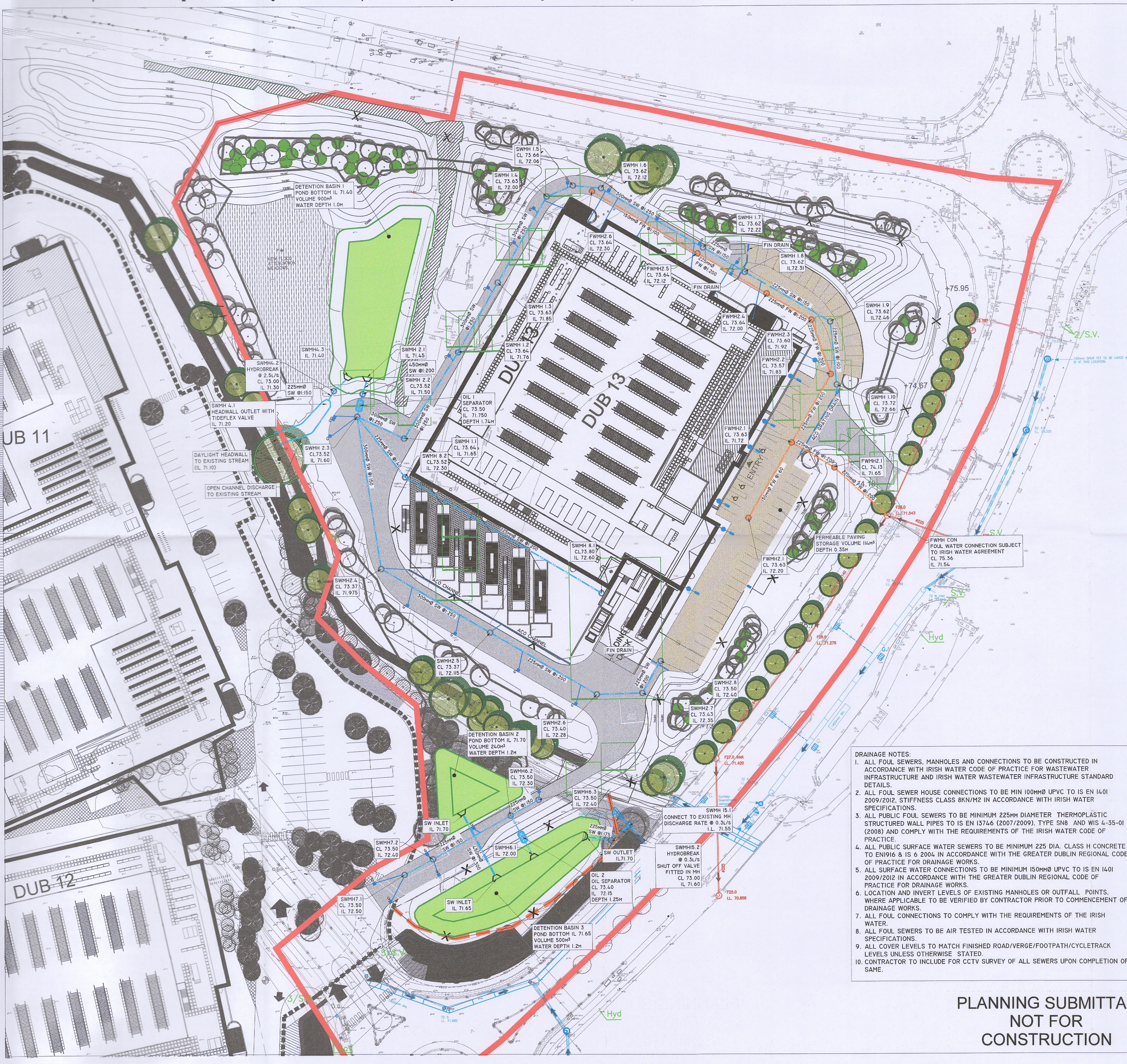

DRAINAGE NOTES:

- ALL FOUL SEWERS, MANHOLES AND CONNECTIONS TO BE CONSTRUCTED IN ACCORDANCE WITH IRISH WATER CODE OF PRACTICE FOR WASTEWATER INFRASTRUCTURE AND IRISH WATER WASTEWATER INFRASTRUCTURE STANDARD DETAILS.
- ALL FOUL SEWER HOUSE CONNECTIONS TO BE MIN 100MM Ø UPVC TO IS EN 1401 2009/2012, STIFFNESS CLASS 8KN/M2 IN ACCORDANCE WITH IRISH WATER SPECIFICATIONS.
- ALL PUBLIC FOUL SEWERS TO BE MINIMUM 225MM DIAMETER THERMOPLASTIC STRUCTURED WALL PIPES TO IS EN 13746 (2007/2009), TYPE SN8 AND WIS 4-35-01 (2008) AND COMPLY WITH THE REQUIREMENTS OF THE IRISH WATER CODE OF PRACTICE.
- ALL SURFACE WATER SEWERS TO BE MINIMUM 225 DIA. CLASS H CONCRETE TO EN1916 & IS 6 2004, IN ACCORDANCE WITH THE GREATER DUBLIN REGIONAL CODE OF PRACTICE FOR DRAINAGE WORKS.
- ALL SURFACE WATER CONNECTIONS TO BE MINIMUM 150MM Ø UPVC TO IS EN 1401 2009/2012 IN ACCORDANCE WITH THE GREATER DUBLIN REGIONAL CODE OF PRACTICE FOR DRAINAGE WORKS.
- LOCATION AND INVERT LEVELS OF EXISTING MANHOLES OR OUTFALL POINTS, WHERE APPLICABLE TO BE VERIFIED BY CONTRACTOR PRIOR TO COMMENCEMENT OF DRAINAGE WORKS.
- ALL FOUL CONNECTIONS TO COMPLY WITH THE REQUIREMENTS OF THE IRISH WATER.
- ALL FOUL SEWERS TO BE AIR TESTED IN ACCORDANCE WITH IRISH WATER SPECIFICATIONS.
- ALL COVER LEVELS TO MATCH FINISHED ROAD/VERGE/FOOTPATH/CYCLETRACK LEVELS UNLESS OTHERWISE STATED.
- CONTRACTOR TO INCLUDE FOR CCTV SURVEY OF ALL SEWERS UPON COMPLETION OF SAME.

**PLANNING SUBMITTAL
 NOT FOR
 CONSTRUCTION**

Scale For Microlining: Millimeters
 Scale For Macrolining: Inches