

DATE: 15 March 2023
DESIGNER: Graham Sheehan
PROJECT No: SES 14322 Rev B
PROJECT NAME: Aderrig Phase 3 Quintain Ireland



Designed in accordance with ISEN13201-2:2015

Rev A: Redesigned to suit latest layout.
Rev B: Redesigned to suit latest layout.

Outdoor Lighting Report

PREPARED BY: Sabre Electrical Services Ltd.
Unit 11 Bellevue Ind. Est.
Finglas
Dublin 11.
Email: graham@sabrelighting.ie
Ph: 01 8110875

Layout Report

General Data

Dimensions in Metres Angles in Degrees

Calculation Grids

ID	Grid Name	X	Y	X' Length	Y' Length	X' Spacing	Y' Spacing
1	Grid 1	701298.00	733129.00	156.00	374.00	1.50	1.50
2	Grid 2	701356.00	733501.00	108.00	94.00	1.50	1.52
3	Grid 3	701301.00	733270.00	144.00	27.00	1.50	1.50

Luminaires



Luminaire A Data

Supplier	C U Phosco
Type	P852-12-P4-NW-CB0400-17W
Lamp(s)	740C NW
Lamp Flux (klm)	2.06
File Name	P852-12-P4-NW-CB0400-17W.ies
Maintenance Factor	0.83
Imax70,80,90(cd/klm)	760.6, 161.3, 0.8
No. in Project	44



Luminaire B Data

Supplier	C U Phosco
Type	P852-12-R3B-NW-CB0200-9W
Lamp(s)	740C NW
Lamp Flux (klm)	1.11
File Name	P852-12-R3B-NW-CB0200-9W.ies
Maintenance Factor	0.83
Imax70,80,90(cd/klm)	896.4, 62.1, 1.9
No. in Project	12



Luminaire D Data

Supplier	C U Phosco
Type	P862-256-P4-740-W5-0250-64W
Lamp(s)	740SS
Lamp Flux (klm)	9.39
File Name	P862-256-P4-740-W5-0250-64W.ies
Maintenance Factor	0.83
Imax70,80,90(cd/klm)	431.2, 124.0, 0.4
No. in Project	9

Layout

ID	Type	X	Y	Height	Angle	Tilt	Cant	Out-reach	Target X	Target Y	Target Z
1	A	701447.90	733453.13	6.00	87.00	0.00	0.00	0.40			
2	A	701416.95	733480.59	6.00	354.00	0.00	0.00	0.40			
3	A	701415.53	733454.27	6.00	357.00	0.00	0.00	0.40			
4	A	701427.88	733503.34	6.00	185.00	0.00	0.00	0.40			
5	A	701420.61	733522.97	6.00	0.00	0.00	0.00	0.40			
6	A	701413.92	733501.25	6.00	83.00	0.00	0.00	0.40			
7	A	701426.94	733431.29	6.00	185.00	0.00	0.00	0.40			
8	A	701426.58	733392.67	6.00	181.00	0.00	0.00	0.40			

Layout Continued

ID	Type	X	Y	Height	Angle	Tilt	Cant	Out-reach	Target X	Target Y	Target Z
9	A	701424.96	733363.72	6.00	177.00	0.00	0.00	0.40			
10	A	701423.64	733335.50	6.00	185.00	0.00	0.00	0.40			
12	A	701403.96	733316.73	6.00	86.00	5.00	0.00	0.40			
13	A	701358.93	733318.15	6.00	85.00	5.00	0.00	0.40			
14	A	701315.39	733294.17	6.00	4.00	0.00	0.00	0.40			
15	A	701317.73	733325.75	6.00	357.00	0.00	0.00	0.40			
16	A	701315.71	733354.85	6.00	350.00	0.00	0.00	0.40			
17	A	701320.26	733381.28	6.00	349.00	0.00	0.00	0.40			
19	A	701373.91	733375.32	6.00	85.00	0.00	0.00	0.40			
21	A	701325.61	733434.80	6.00	328.00	0.00	0.00	0.40			
22	A	701344.21	733432.52	6.00	86.00	0.00	0.00	0.40			
25	B	701360.97	733484.27	6.00	314.00	0.00	0.00	0.40			
26	B	701385.14	733500.33	6.00	306.00	0.00	0.00	0.40			
27	B	701376.00	733488.41	6.00	305.00	0.00	0.00	0.40			
28	B	701432.29	733549.83	6.00	326.00	0.00	0.00	0.40			
29	B	701448.41	733581.86	6.00	336.00	0.00	0.00	0.40			
30	B	701440.07	733564.96	6.00	336.00	0.00	0.00	0.40			
31	B	701443.70	733539.40	6.00	268.00	0.00	0.00	0.40			
32	B	701443.98	733382.16	6.00	85.00	0.00	0.00	0.40			
33	B	701437.21	733315.11	6.00	265.00	0.00	0.00	0.40			
34	B	701425.33	733300.47	6.00	354.00	0.00	0.00	0.40			
35	D	701453.37	733313.36	10.00	354.00	0.00	0.00	0.40			
36	B	701383.74	733305.04	6.00	175.00	0.00	0.00	0.40			
37	A	701333.56	733330.96	6.00	274.00	5.00	0.00	0.40			
38	A	701439.74	733228.21	6.00	85.00	0.00	0.00	0.40			
39	A	701440.32	733244.68	6.00	265.00	0.00	0.00	0.40			
41	A	701418.37	733241.67	6.00	267.00	0.00	0.00	0.40			
43	A	701411.10	733246.52	6.00	177.00	0.00	0.00	0.40			
44	A	701437.59	733167.89	6.00	86.00	0.00	0.00	0.40			
46	A	701410.84	733178.51	6.00	267.00	0.00	0.00	0.40			
48	A	701384.74	733170.48	6.00	89.00	0.00	0.00	0.40			
49	A	701360.95	733187.91	6.00	40.00	0.00	0.00	0.40			
50	A	701319.40	733243.84	6.00	36.00	0.00	0.00	0.40			
51	A	701327.15	733271.06	6.00	182.00	0.00	0.00	0.40			
53	A	701437.84	733468.15	6.00	271.00	0.00	0.00	0.40			
54	A	701403.56	733498.72	6.00	124.00	0.00	0.00	0.40			

Layout Continued

ID	Type	X	Y	Height	Angle	Tilt	Cant	Out-reach	Target X	Target Y	Target Z
56	A	701415.08	733405.56	6.00	359.00	0.00	0.00	0.40			
57	A	701412.57	733347.32	6.00	354.00	0.00	0.00	0.40			
59	A	701377.17	733328.97	6.00	267.00	5.00	0.00	0.40			
60	A	701406.70	733372.38	6.00	87.00	0.00	0.00	0.40			
61	A	701340.84	733378.09	6.00	86.00	0.00	0.00	0.40			
62	A	701345.54	733465.44	6.00	306.00	0.00	0.00	0.40			
63	A	701370.48	733431.11	6.00	86.00	0.00	0.00	0.40			
64	A	701405.70	733429.24	6.00	87.00	0.00	0.00	0.40			
65	A	701326.58	733312.25	6.00	179.00	0.00	0.00	0.40			
66	A	701319.78	733402.72	6.00	4.00	0.00	0.00	0.40			
67	D	701441.30	733282.25	10.00	267.00	0.00	0.00	0.40			
68	D	701407.48	733285.71	10.00	266.00	0.00	0.00	0.40			
69	D	701329.21	733289.54	10.00	266.00	0.00	0.00	0.40			
70	D	701368.38	733287.72	10.00	272.00	0.00	0.00	0.40			
71	D	701379.40	733273.08	10.00	87.00	0.00	0.00	0.40			
72	D	701342.38	733274.86	10.00	86.00	0.00	0.00	0.40			
73	D	701304.09	733278.36	10.00	86.00	0.00	0.00	0.40			
74	A	701337.19	733220.07	6.00	40.00	0.00	0.00	0.40			
70	B	701407.43	733520.02	6.00	326.00	0.00	0.00	0.40			
66	A	701411.99	733265.73	6.00	179.00	0.00	0.00	0.40			
67	D	701426.36	733270.56	10.00	88.00	0.00	0.00	0.40			

Horizontal Illuminance (lux)

Grid 1

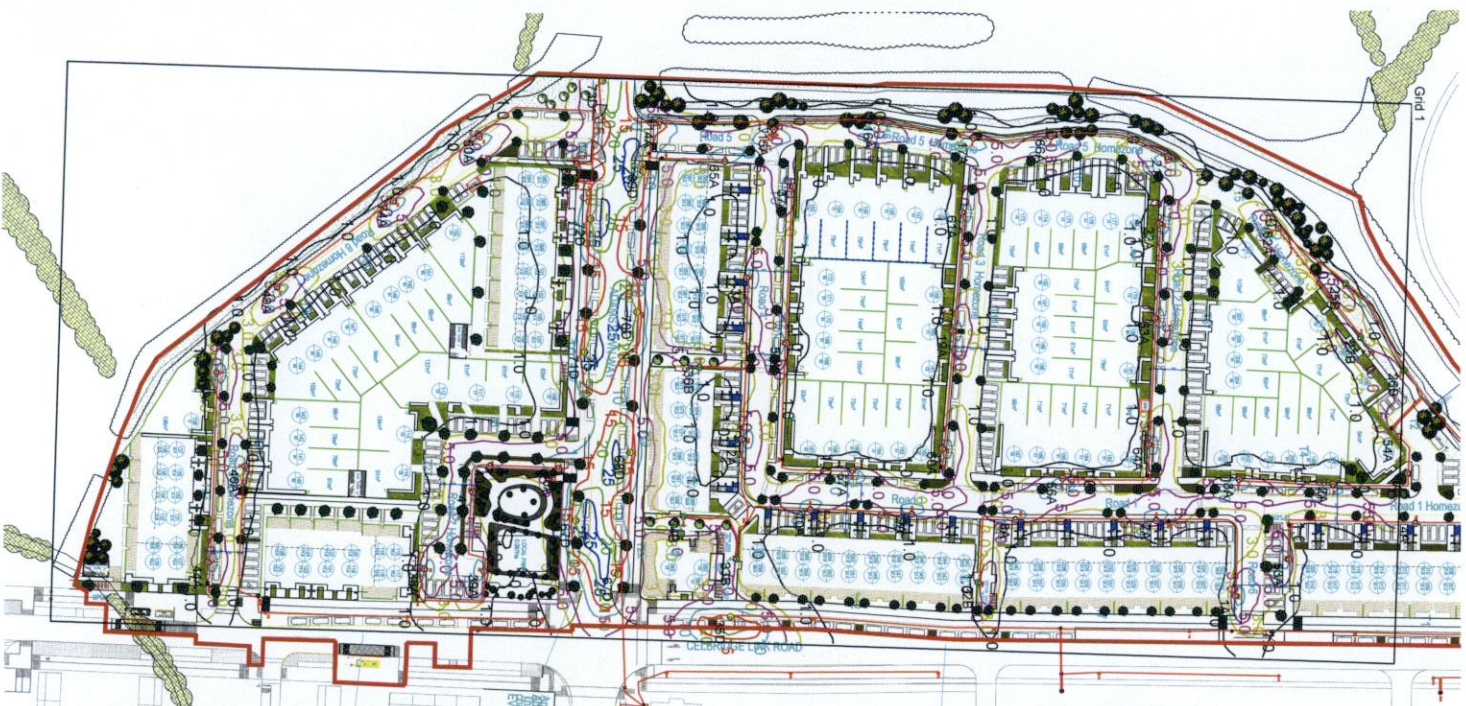

Results

Eav	5.00
Emin	0.98
Emax	18.80
Emin/Emax	0.05
Emin/Eav	0.20

Horizontal Illuminance (lux)

Grid 1

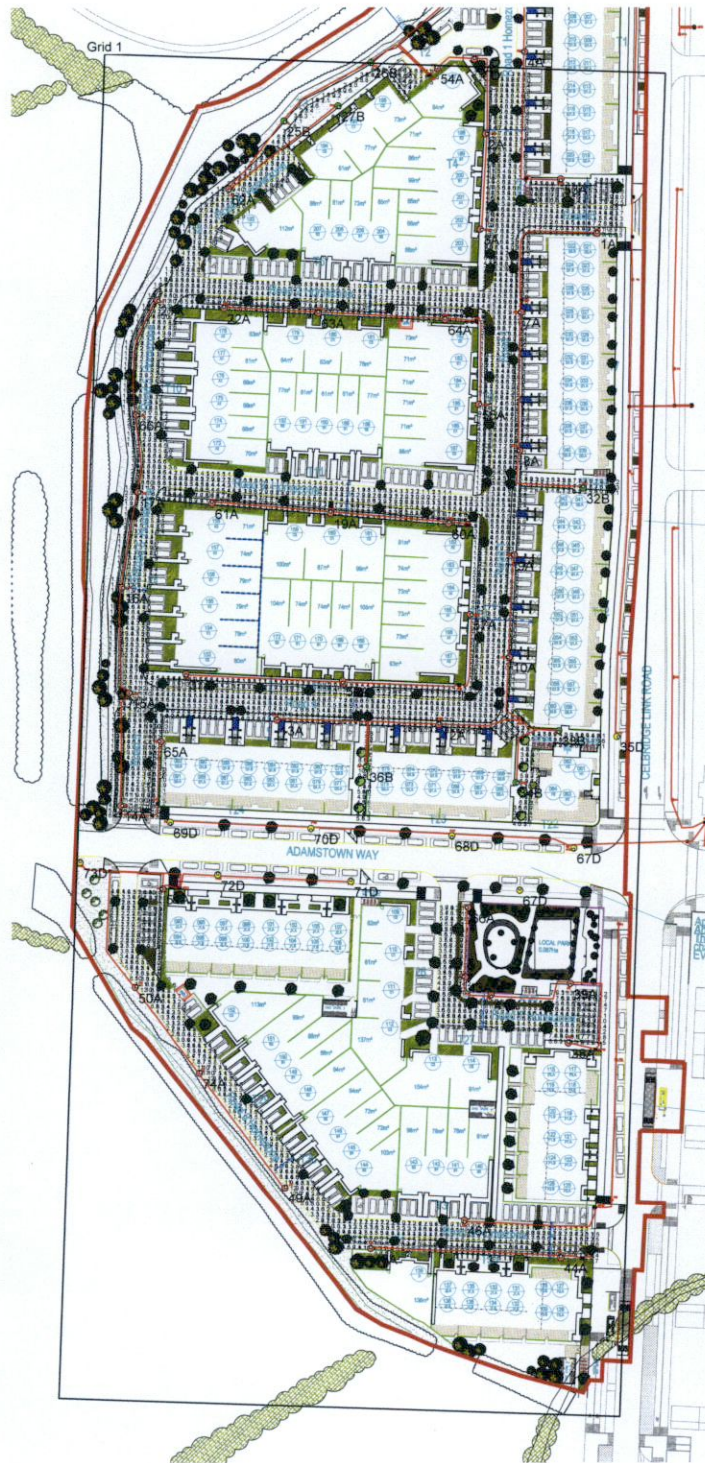

Results

Eav	5.00
Emin	0.98
Emax	18.80
Emin/Emax	0.05
Emin/Eav	0.20

Horizontal Illuminance (lux)

Grid 2



Results

Eav	6.62
Emin	1.36
E _{max}	15.55
Emin/E _{max}	0.09
Emin/Eav	0.21

Horizontal Illuminance (lux)

Grid 2

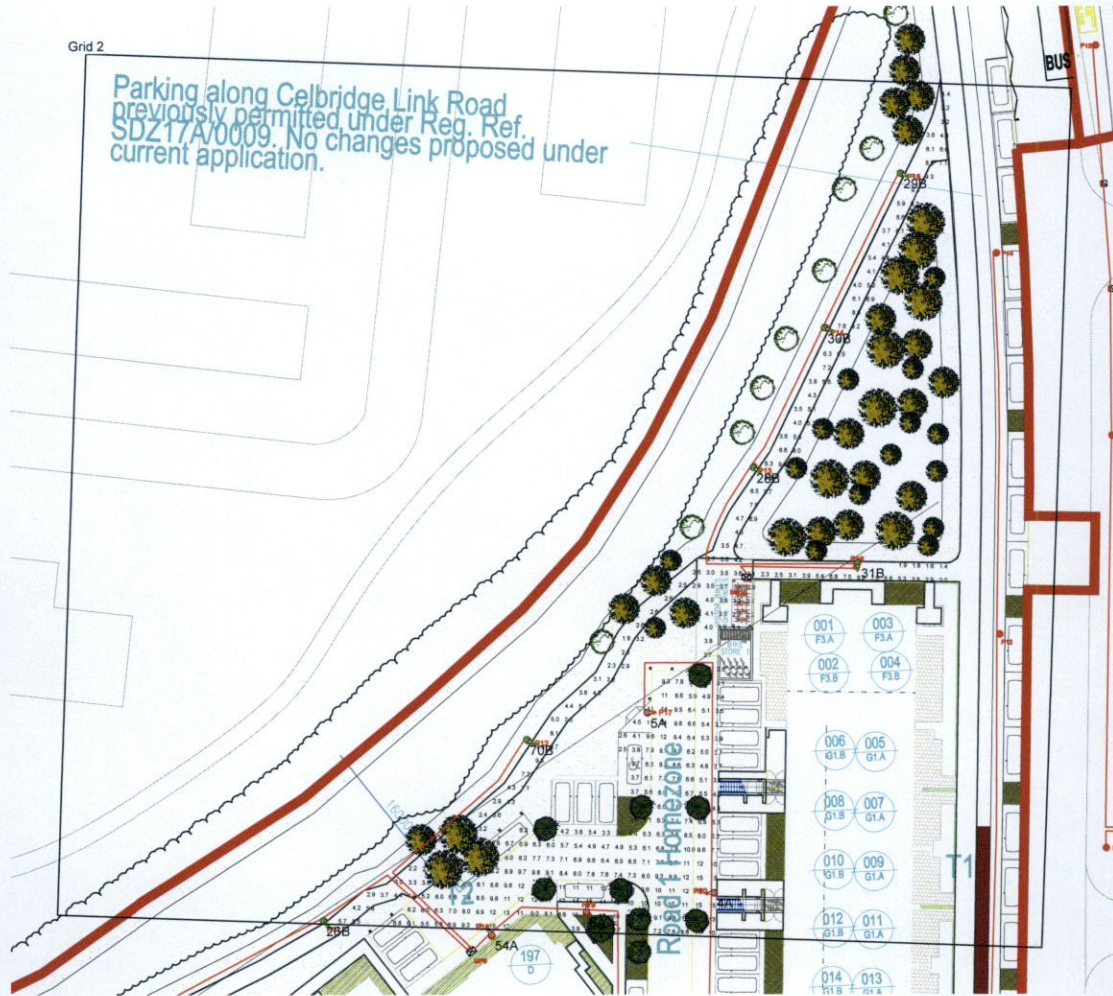

Results

Eav	6.62
Emin	1.36
Emax	15.55
Emin/Emax	0.09
Emin/Eav	0.21

Horizontal Illuminance (lux)

Grid 3

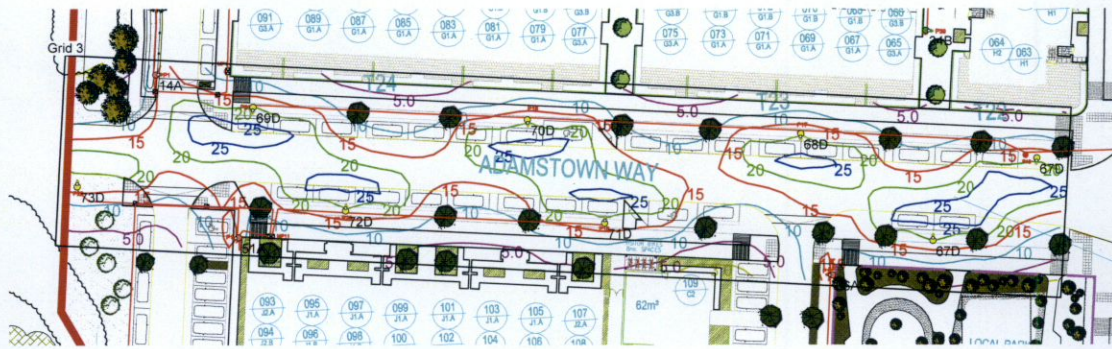

Results

Eav	14.83
Emin	3.84
E _{max}	29.11
E _{min} /E _{max}	0.13
E _{min} /E _{av}	0.26

Horizontal Illuminance (lux)

Grid 3

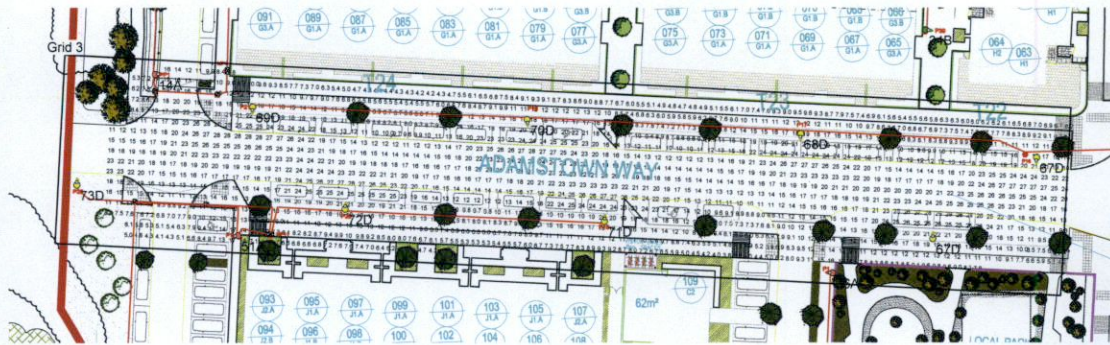

Results

Eav	14.83
Emin	3.84
Emax	29.11
Emin/Emax	0.13
Emin/Eav	0.26