

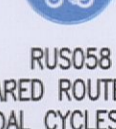
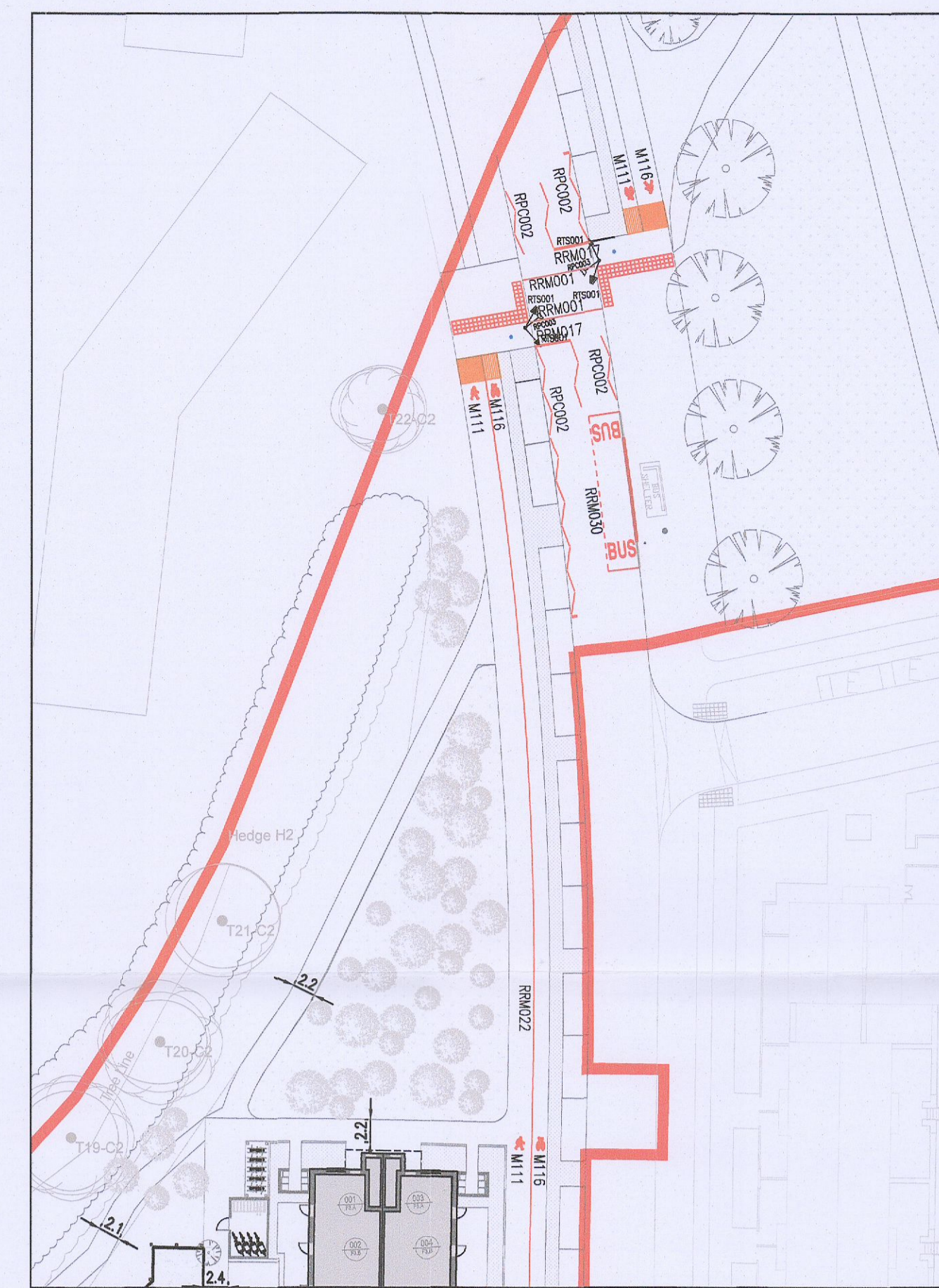
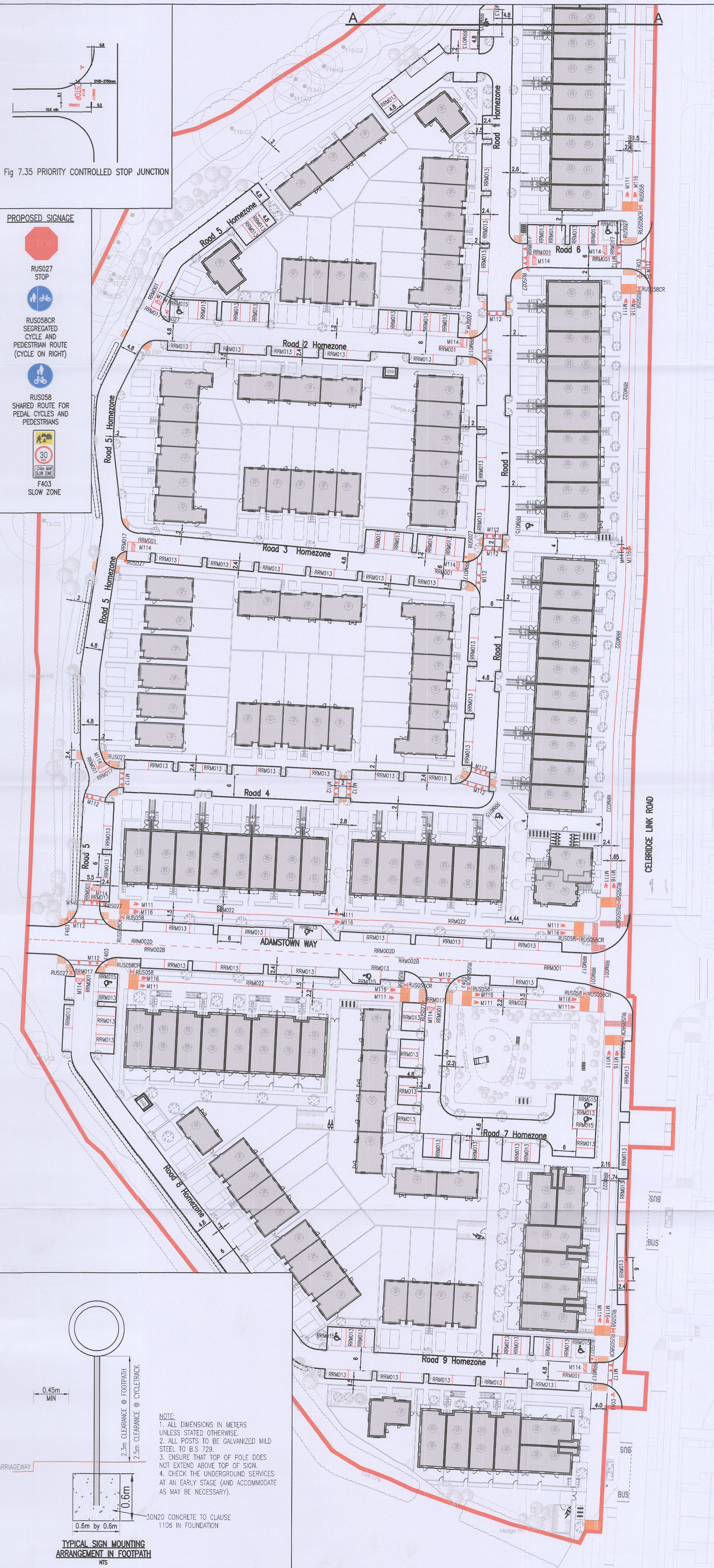

Fig 7.35 PRIORITY CONTROLLED STOP JUNCTION

PROPOSED SIGNAGE

-  RUS027 STOP
-  RUS058B SEGREGATED CYCLE AND PEDESTRIAN ROUTE (CYCLE ON RIGHT)
-  RUS058 SHARED ROUTE FOR PEDAL CYCLES AND PEDESTRIANS
-  FA03 SLOW ZONE



INSET A  
SCALE 1:500

- NOTES:
- DO NOT SCALE. USE FIGURED DIMENSIONS ONLY.
  - THIS DRAWING IS TO BE READ IN CONJUNCTION WITH ALL OTHER RELEVANT ARCHITECTURAL AND ENGINEERING DRAWINGS.
  - IT IS THE CONTRACTOR'S RESPONSIBILITY TO ENSURE THAT ALL WORKS ARE CONSTRUCTED IN ACCORDANCE WITH THE IRISH WATER CODE OF PRACTICE AND STANDARD DETAILS. THE CODE OF PRACTICE AND STANDARD DETAILS ARE AVAILABLE TO DOWNLOAD FROM THE IRISH WATER WEB SITE AT [WWW.WATER.IE/CONNECTIONS/DEVELOPER-SERVICES/](http://WWW.WATER.IE/CONNECTIONS/DEVELOPER-SERVICES/) WHERE THE DETAILS CONTAINED ON THIS DRAWING DIFFER FROM THE IRISH WATER CODE OF PRACTICE OR STANDARD DETAILS THIS MUST BE BROUGHT TO THE ATTENTION OF THE ENGINEER IMMEDIATELY. IRISH WATER STANDARDS WILL TAKE PRECEDENCE.
  - FOR ROAD MARKINGS SPECIFICATIONS, REFER TO 'TRAFFIC SIGNS MANUAL - CHAPTER 7 - ROAD MARKINGS'.

BASED ON DRAWINGS:		ISSUED DATE:
ARCHITECTS	6259A-P-003_REV_2 PROPOSED SITE LAYOUT PLAN	14-03-2023
LANDSCAPING	LP-01-FI LANDSCAPE PLAN	15-03-2023
SERVICES	PHMCCARTHY ADAMSTOWN WATER SUPPLY SCHEME 821-06-001 REV E DRAFT	27-11-2019
SURVEY	LENMAR SURVEY L_01380_TP REV A	04-2022

CONTRACTOR TO ENSURE DRAWINGS ARE CURRENT.

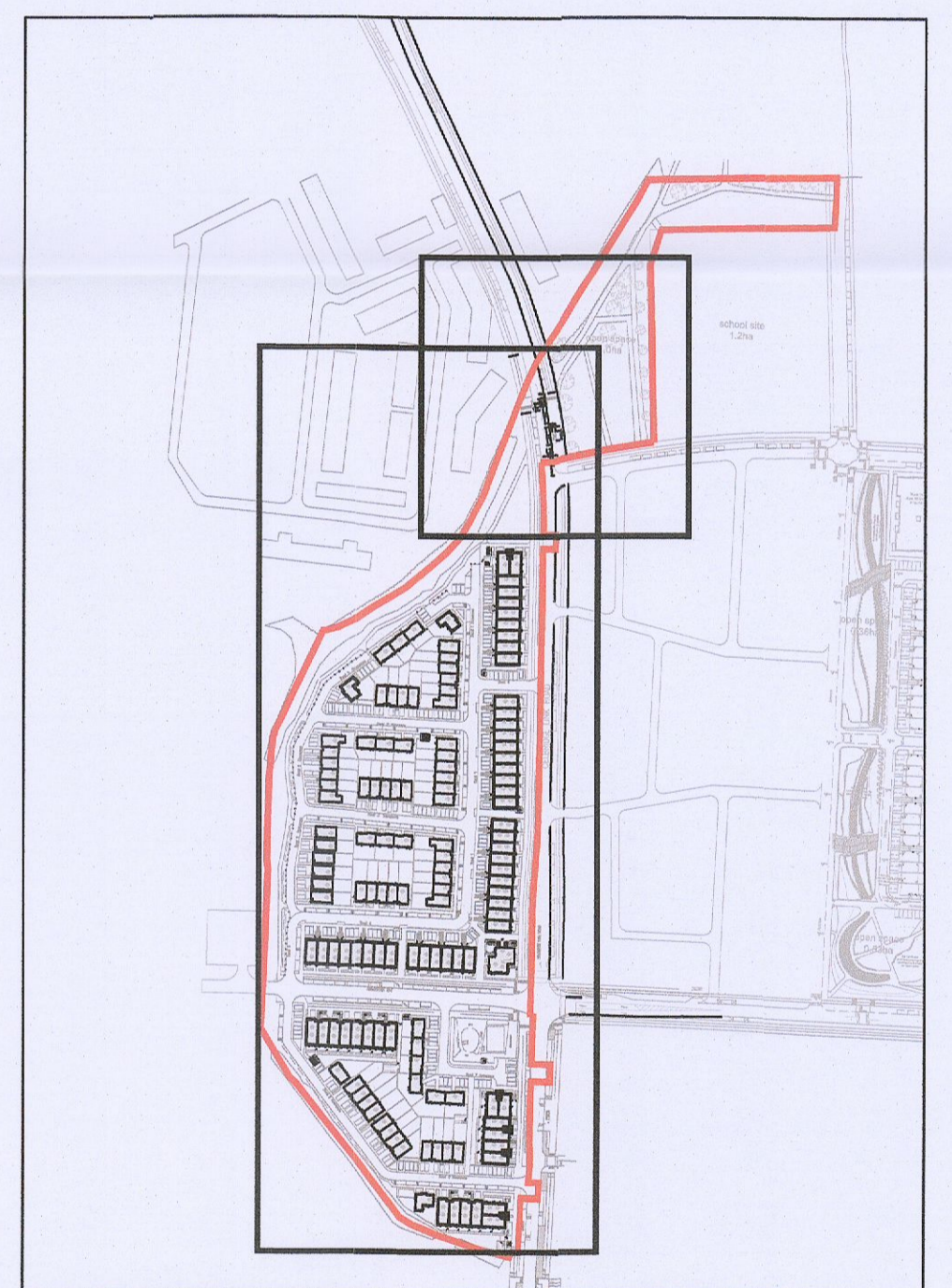

KEY PLAN  
SCALE 1:2500

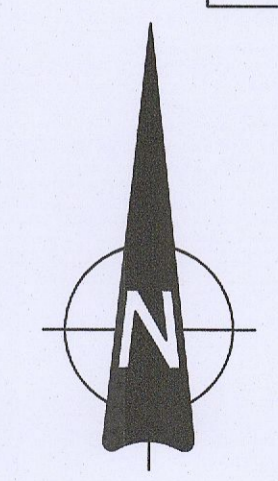
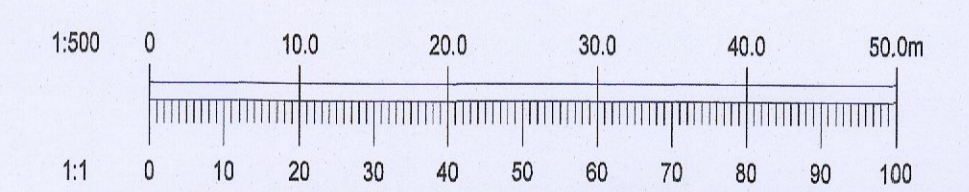

Ordnance Survey Ireland Licence No. EN 0006021 © Ordnance Survey Ireland/Government of Ireland.

REV.	DATE	AMENDMENT	DRN	APPD
B	16/03/23	ISSUED FOR RFI	MS	IW
A	21/02/23	ISSUED FOR TENDER & RSA	MS	IW
-	24/11/22	ISSUED FOR TENDER	MS	IW

STATUS **FOR TENDER**

**Waterman Moylan**  
Engineering Consultants  
BLOCK 8, EASTPOINT BUSINESS PARK, ALFIE BYRNE ROAD, DUBLIN D08 H3P4 IRELAND.  
Tel: (01) 884 8800 Fax: (01) 661 3818  
Email: info@waterman-moylan.ie www.waterman-moylan.ie

CLIENT **QUINTAIN DEVELOPMENTS IRELAND LTD**  
ARCHITECT **BKD ARCHITECTS**  
PROJECT **ADERRIG PHASE 3**  
TITLE **PROPOSED ROAD MARKINGS & SIGNAGE**

DRAWN	DESIGNED	APPROVED	DATE
MS	JB	IW	NOV. 2022
SCALE	JOB NO.	DRG. NO.	REVISION
1:500 @ A1	22-023	T110	B

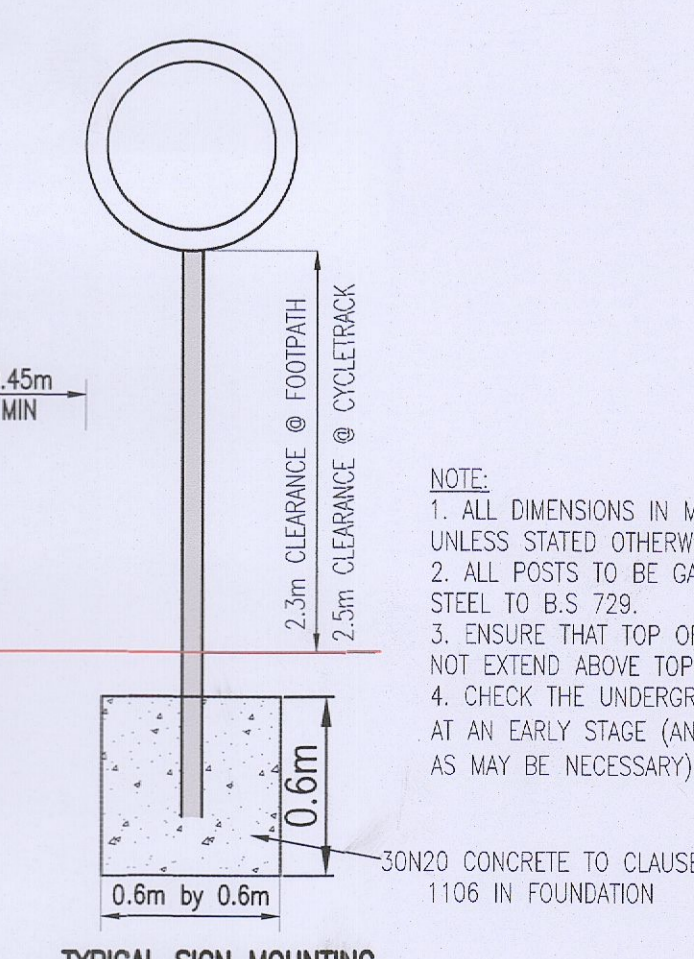

NOTE:  
1. ALL DIMENSIONS IN METERS UNLESS STATED OTHERWISE.  
2. ALL POSTS TO BE GALVANIZED MILD STEEL TO B.S 729.  
3. ENSURE THAT TOP OF POLE DOES NOT EXTEND ABOVE TOP OF SIGN.  
4. CHECK THE UNDERGROUND SERVICES AT AN EARLY STAGE (AND ACCOMMODATE AS MAY BE NECESSARY).