

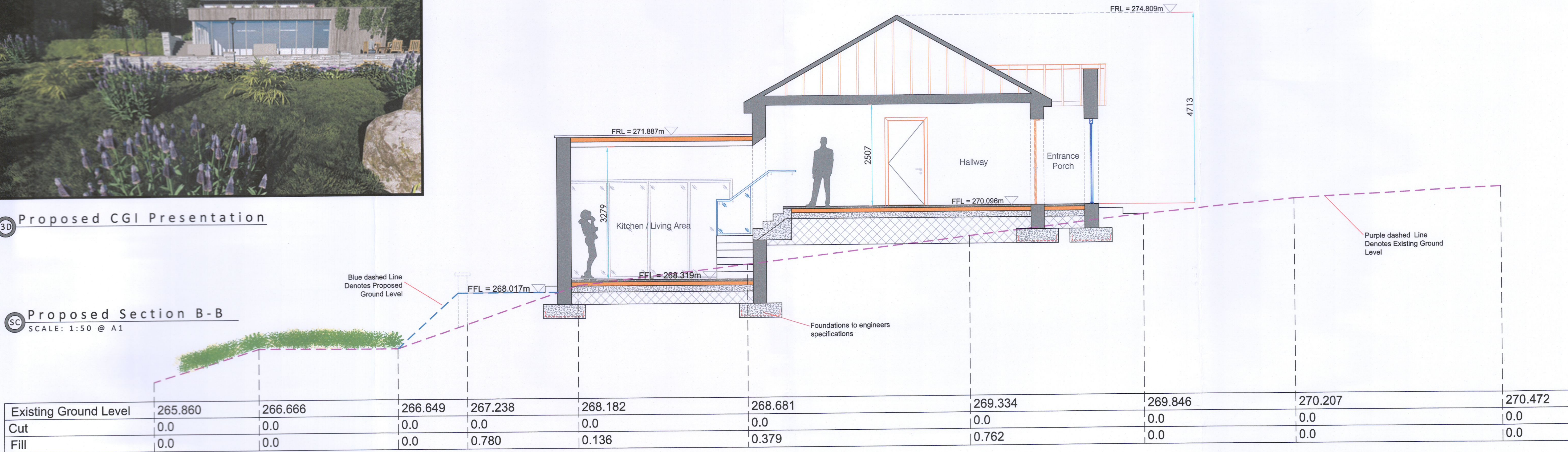

3D Proposed CGI Presentation

SC Proposed Section B-B
SCALE: 1:50 @ A1



3D Proposed CGI Presentation

SC Proposed Section C-C
SCALE: 1:50 @ A1

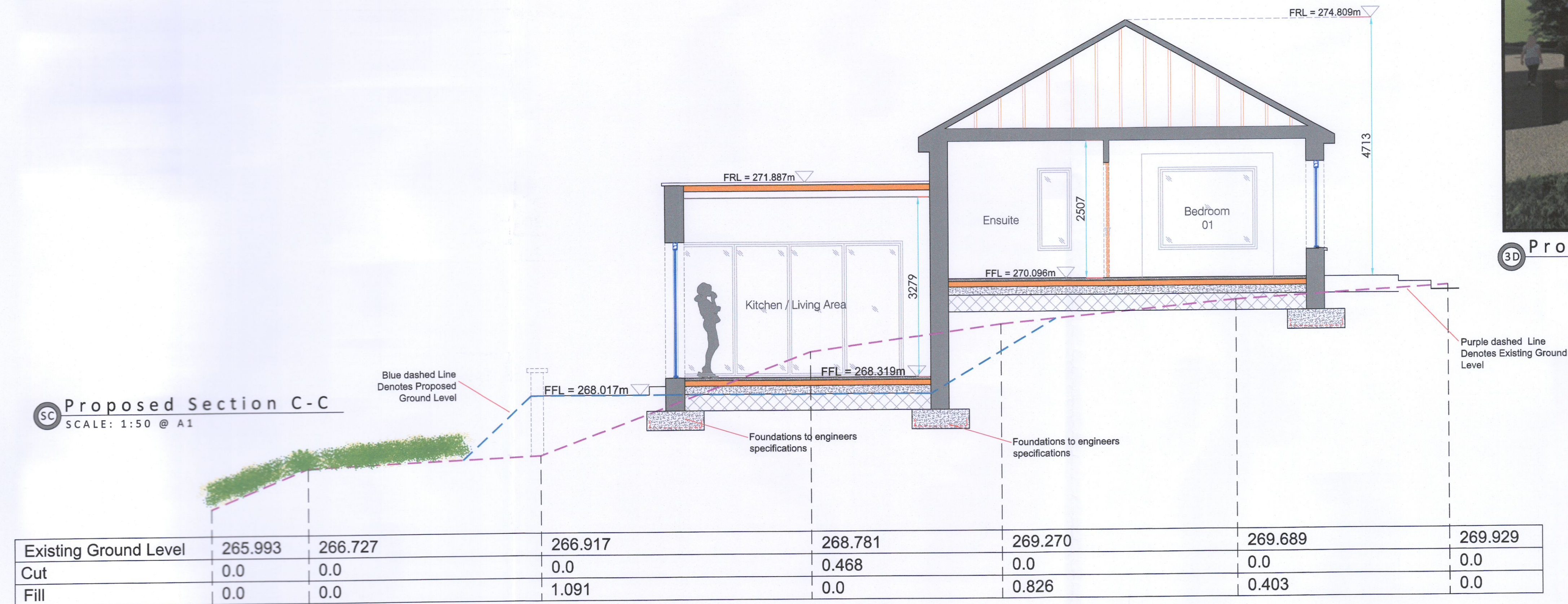

FURTHER INFORMATION

WILLIAM DONOGHUE & ASSOCIATES
 Consulting Engineers & Architectural Services
 Woodlands, Rathangan, Co. Kildare
 Tel: (087) 9252448

Client: Jamie Goldrick
 Address: Blackthorn Hill,
 Coolmine, Saggart,
 Co. Dublin

Scale: 1:50 @ A1
 Date: 08/03/2023
 Cad Ref: WD - 238 - TG - 03B
 Site Area: 0.00 Acres
 Drawn by: P. O'Connor