

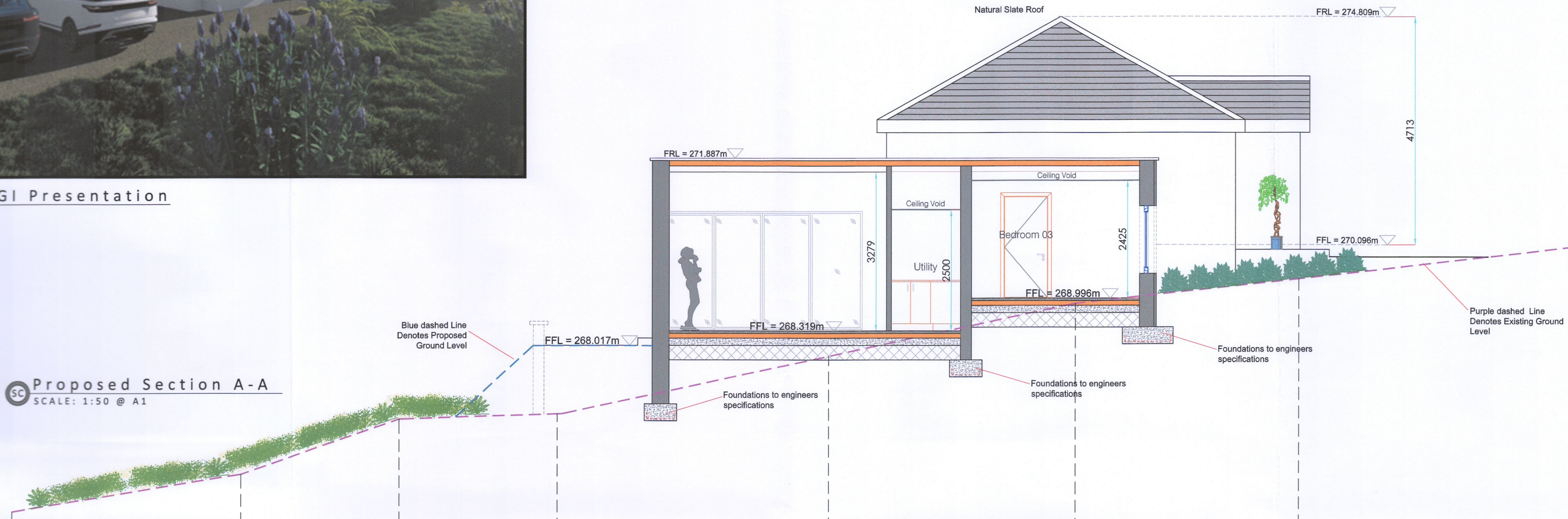

3D Proposed CGI Presentation

SC Proposed Section A-A
SCALE: 1:50 @ A1



Existing Ground Level	264.592	265.325	266.498	266.608	267.796	268.890	269.390	270.153
Cut	0.0	0.0	0.0	0.0	0.0	0.0	0.0	0.0
Fill	0.0	0.0	0.0	1.410	0.522	0.105	0.0	0.0



IMG View from North East of Site



IMG View from North East of Site



IMG View from South of Site

FURTHER INFORMATION

WILLIAM DONOGHUE & ASSOCIATES
Consulting Engineers & Architectural Services
Woodlands, Rathangan, Co. Kildare
Tel: (087) 9252448



Client: Jamie Goldrick
Address: Blackthorn Hill,
Coolmine, Saggart,
Co. Dublin
Title: PROPOSED LAYOUT FOR
PLANNING PURPOSES ONLY

Scale: 1 : 50 @ A1
Date: 08/03/2023
Cad Ref: WD - 238 - TG - 03A
Site Area: 0.00 Acres
Drawn by : P. O'Connor