

01 Proposed First Floor Plan
PA-105 1:200

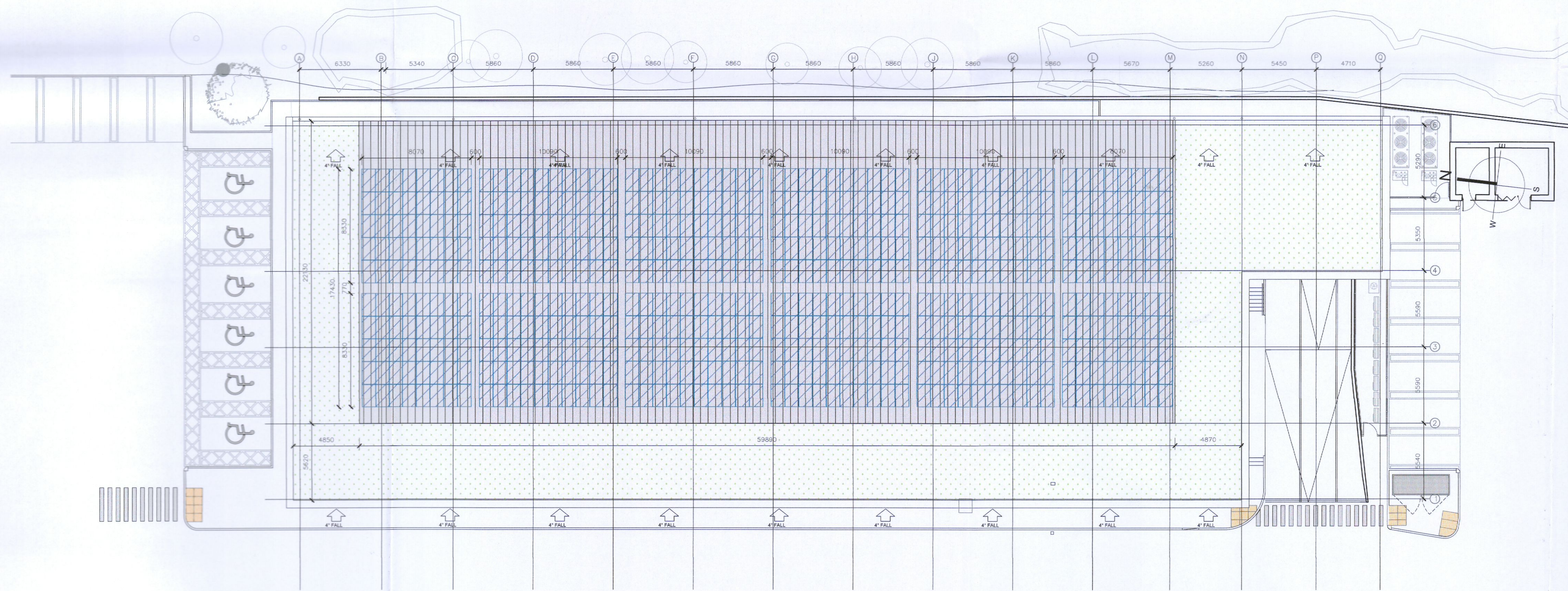

01 Proposed First Floor Plan
PA-105 1:200

LIDL STORE FLOOR AREAS	
LOCATION	AREA (m ²)
SALES AREA	1373
STORAGE	146.7
SECURE STORAGE	133.7
CHILLER	36.8
ENTRANCE POD	42
BAKERY PREPARATION AREA	65.5
FREEZER AREA	64.3
CUSTOMER LOBBY & CUSTOMER WC	8.6
WELFARE LOBBY	5.5
OPERATIONAL OFFICE	10.2
PLANT ROOM	11.1
STAIR CORE	23
GROUND FLOOR SUB TOTAL	1920
CANTEEN	30.5
MEETING ROOM	13
CORRIDOR	6
IT ROOM	12
LOCKER ROOM	18.7
SHOWER ROOM	8
FEMALE WC	3
MALE WC	3
STAIR CORE	11
PLANT AREA	71
FIRST FLOOR SUB TOTAL	176
INTERNAL WALLS	71
TOTAL AREA INCL. INTERNAL WALLS	2167

NOTES:
Do not scale from this drawing.
Any discrepancies found on site to be reported to Darmody Architects immediately.
Any discrepancies found on drawings to be reported to Darmody Architects immediately.
Refer to engineers drawings for structural details.
All dimensions sized to blockwork.

Rev.	Description	Date	Initials

DRAWING KEY

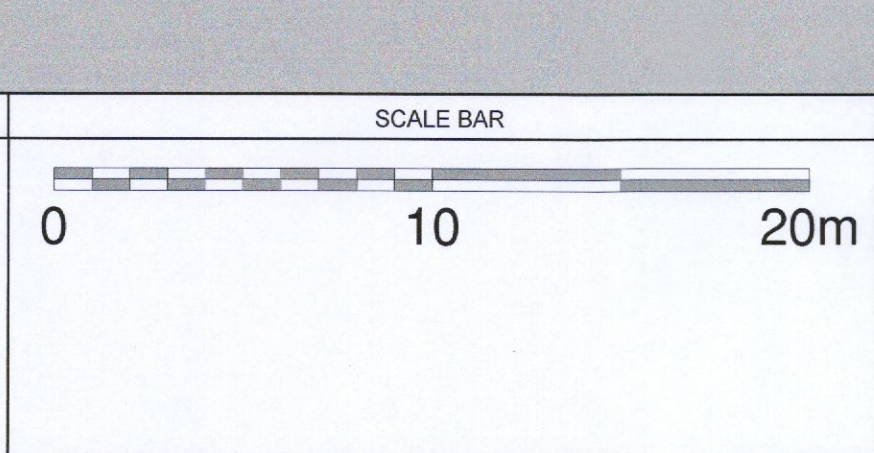

DRAWING KEY

creative innovative flexible

darmody architecture
91 Townsend Street, Dublin 2
353 1 672 9907
info@darmodyarchitecture.com
darmodyarchitecture.com

Rev. No.	Scale	Date	Drn. By	Chkd. By	Issue
	1:200 @ A1	23/01/2023	Kevin Barry	Alan Ryan	CFI

Project:	Proposed Lidl Store at Newcastle, Co. Dublin
Title:	Lidl Store - Proposed First Floor & Roof Plan
Client:	Lidl Ireland GmbH
Dwg. No.	PA-105
Job No.	22013