

LEGEND	
	DENOTES SCOPE OF PLANNING APPLICATION
	DENOTES INTERNAL AREAS WITHIN SCOPE LINE BUT OUTSIDE SCOPE OF THIS PLANNED APPLICATION
	DENOTES AREAS OUTSIDE SCOPE OF PLANNING APPLICATION
	DENOTES BUILDING DIMENSIONS

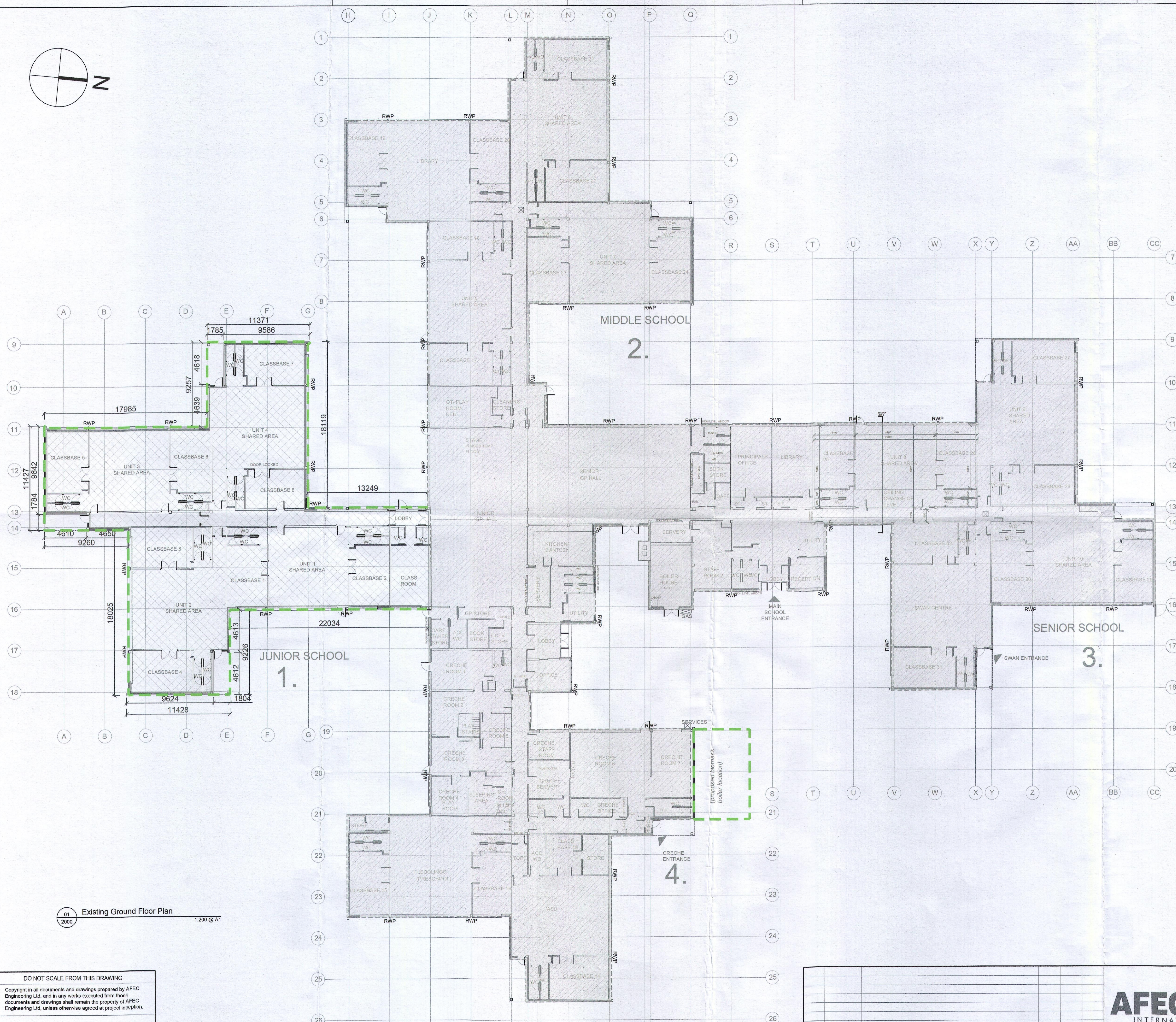

01 Existing Ground Floor Plan 1:200 @ A1

PLANNING APPLICATION

DO NOT SCALE FROM THIS DRAWING
 Copyright in all documents and drawings prepared by AFEC Engineering Ltd. and in any works executed from those documents and drawings shall remain the property of AFEC Engineering Ltd. unless otherwise agreed at project inception.
 This drawing is to be read in conjunction with all relevant engineers & specialist drawings, specifications and contract documents. Work to figured dimensions only. All documents to be verified by the contractor on site. All discrepancies should be reported to the architect prior to commencement of the works.

REV	DATE	DESCRIPTION	JD DRWN BY	LP CHKD BY	CK APPD BY
P01	18.01.2023	ISSUED FOR PLANNING APPLICATION			

AFEC INTERNATIONAL

88, Swords Enterprise Park, Swords, Dublin, K67YX37
 W - www.afec.ie E - admin@afec.ie P - 01 6642836

CLIENT Department of Education	AFEC JOB NO. 21051
DRAWING TITLE Existing Ground Floor Plan	SCALE (@A1) 1:200
PROJECT Project Pathfinder - St. Anne's Primary School	STATUS S2
DRAWING NUMBER 21051-AFEC-00-GF-DR-A-2000	REVISION P01