

WATER
 NOTE: THE CONTRACTOR IS RESPONSIBLE FOR ENSURING ALL WORKS ARE CARRIED OUT IN ACCORDANCE WITH THE FOLLOWING CODES OF PRACTICE AND STANDARD DETAILS;
 • CODE OF PRACTICE FOR WATER INFRASTRUCTURE VERSION IW-CDS-5020-03 (REVISION 2) – JULY 2020
 • WATER INFRASTRUCTURE STANDARD DETAILS VERSION IW-CDS-5020-01 (REVISION 4) – JULY 2020
 AND QUALITY ASSURANCE REGIME;
 • QUALITY ASSURANCE (QA) DESIGN REQUIREMENTS MANUAL IW-CDS-5010-01 (REVISION 3) – AUGUST 2020
 • QUALITY ASSURANCE (QA) FIELD INSPECTION REQUIREMENTS MANUAL IW-CDS-5010-02 (REVISION 3) – AUGUST 2020

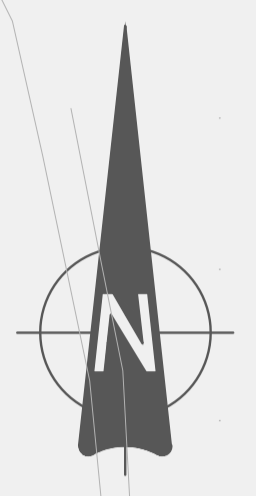
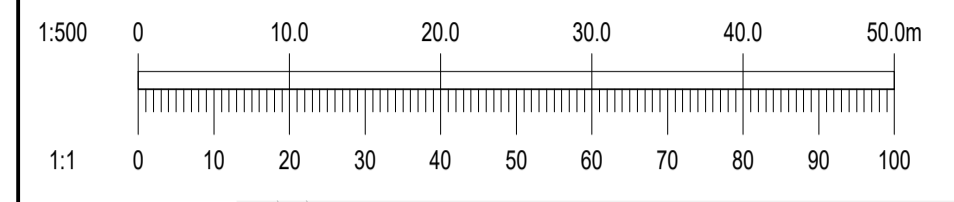

A PORTION OF THE AD14 REGIONAL WATER SUPPLY NETWORK WILL BE CONSTRUCTED FOR 6 NO. UNITS WHICH WILL TEMPORARILY BE CONNECTED VIA THE PLANNED CLOSED VALVE. THE END OF LINES WILL BE CONSTRUCTED WITH TEMPORARY WASHOUT HYDRANTS. ONCE THE ENTIRETY OF THE TANDY'S LANE PHASE 2 IS CONSTRUCTED THE AD 14 NETWORK WILL BE COMPLETED AND THE SOUTHERN INTERLINK AD13 TO AD14 CLOSED VALVE WILL BE CLOSED.

CLOSED VALVE LINKING AD13 AND AD14 AS PER ADAMSTOWN WATER SUPPLY SCHEME (17-113-821/06/001 REV E)

SCOUR VALVE TO DISCHARGE INTO THE SURFACE WATER SYSTEM. NRV TO PREVENT BACKFLOW INTO THE WATER SUPPLY NETWORK

SCOUR VALVE TO DISCHARGE INTO THE SURFACE WATER SYSTEM. NRV TO PREVENT BACKFLOW INTO THE WATER SUPPLY NETWORK.

REFER TO IRISH WATER STANDARD DETAIL STD-W-30A

CONNECTION INTO TLV PH1 WITH PROPOS

- NOTES:**
- DO NOT SCALE. USE FIGURED DIMENSIONS ONLY.
 - THIS DRAWING IS TO BE READ IN CONJUNCTION WITH ALL OTHER RELEVANT ARCHITECTURAL AND ENGINEERING DRAWINGS.

LEGEND

	SCOPE OF WORK BOUNDARY
	EXISTING WATERMAIN
	PROPOSED 250mmØ PE WATERMAIN
	PROPOSED 150mmØ PE WATERMAIN
	PROPOSED 100mmØ PE WATERMAIN
	PROPOSED WATERMAIN TO BE CONSTRUCTED IN THE FUTURE
	PROPOSED SLUICE VALVE
	PROPOSED HYDRANT
	PROPOSED BULK WATER METER
	PROPOSED SCOUR VALVE
	PROPOSED AIR VALVE
	PROPOSED WASHOUT HYDRANT
	PROPOSED NON RETURN VALVE
	PROPOSED BLANK CAP
	PROPOSED BOUNDARY BOX AND 25 mmØ CONNECTION

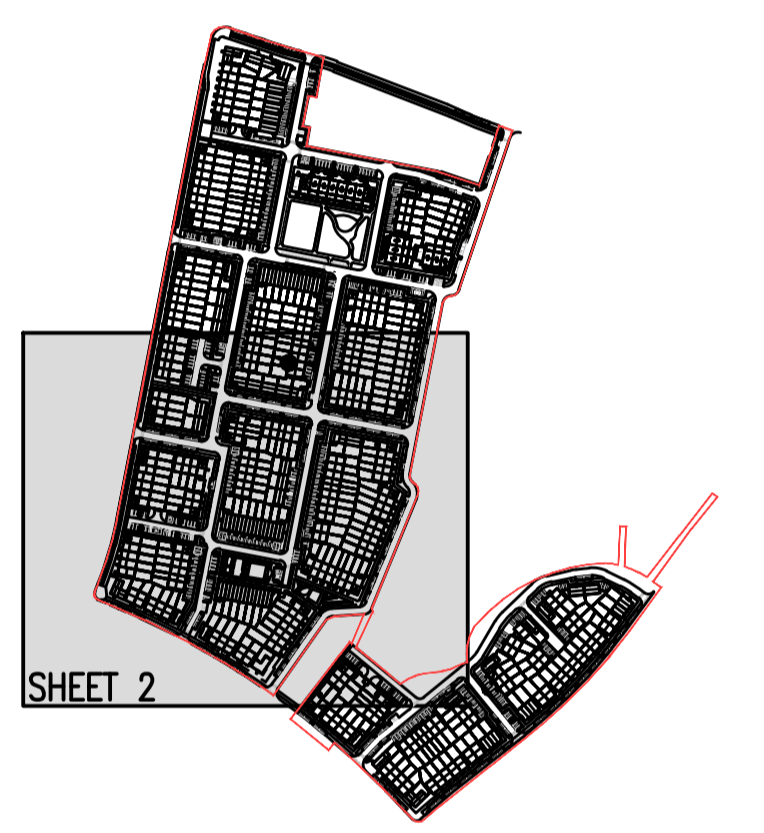

SHEET 2

KEYPLAN
SCALE 1:5000

Ordnance Survey Ireland
 Ordnance Survey Ireland Licence No. EN 0006022 © Ordnance Survey Ireland/Government of Ireland.

20/01/23	IRISH WATER SUBMISSION – PHASE 1 SOW – 193 UNITS	PW	IW
REV.	DATE	AMENDMENT	DRN APPD

STATUS **FOR INFORMATION ONLY NOT FOR CONSTRUCTION**

Waterman Moylan
 Engineering Consultants
 BLOCK 5, EASTPOINT BUSINESS PARK, ALFIE BYRNE ROAD, DUBLIN D03 H3F4 IRELAND. Tel: (01) 664 8900
 Email: info@waterman-moylan.ie www.waterman-moylan.ie

CLIENT **QUINTAIN DEVELOPMENTS IRELAND Ltd.**

ARCHITECT **MOLA ARCHITECTS**

PROJECT **TANDY'S LANE VILLAGE – PHASE 2**

TITLE **PROPOSED WATERMAIN LAYOUT SHEET 2 OF 3**

DRAWN	DESIGNED	APPROVED	DATE
PW	JB	IW	JAN. 2023
SCALE	JOB NO.	DRG. NO.	REVISION
1:500 0A1	21-058	T1301	-

© 2013. This drawing is copyright. No part of this document may be reproduced or transmitted in any form or stored in any retrieval system or any other way without the written permission of the consulting engineer or copyright holder except as agreed for use on the project for which the document was originally issued.