



p | d | c architectural

Churchfields,  
Kentstown,  
Navan,  
Co. Meath

Office: 041 9884877 Mobile: 0876875720

South Dublin County Council  
Planning Department  
County Hall,  
Tallaght,  
Dublin 24

LAND USE, PLANNING  
& TRANSPORTATION DEPT.

03 FEB 2023

Re: Planning Application Further Info - SD22B/0486

- 1) Please see attached revised drawings.
- 2) Please see attached revised drawings & letter from applicant.
- 3) Please see attached revised drawings.
- 4) The existing dwelling is located on the old Lucan Road in Palmerstown, the dwelling have never had parking to front, and also double yellow lines are marked on the roadway outside, as per below photo,  
As per cover letter we are not creating any further car movements on the site, the existing house is located with a shared rear access right of way to a development to the rear, see below AutoTRAK extract it is impossible to have parking radius correctly due to the width of the existing lane,



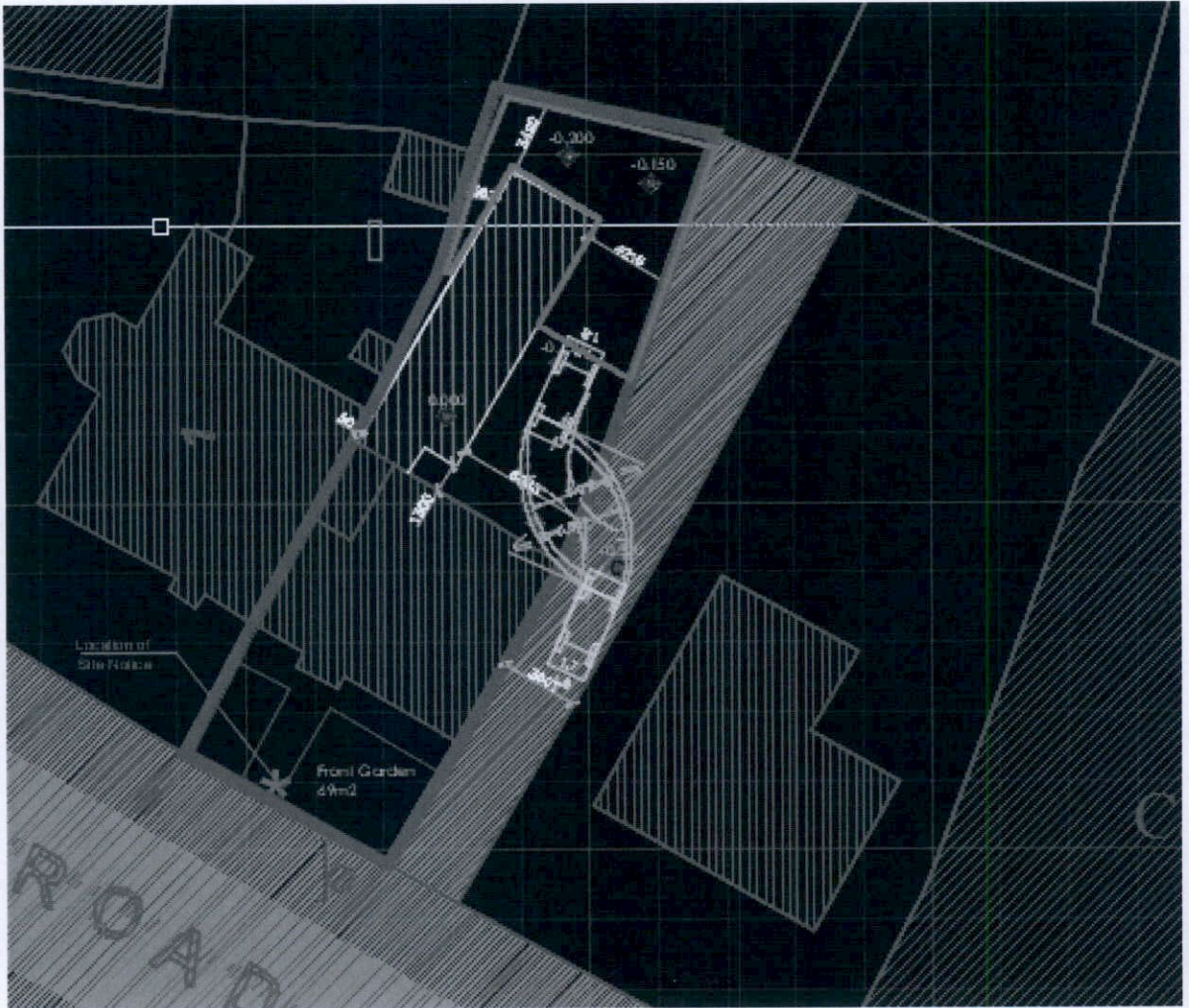

5) The proposed development will have the following Green Infrastructure – due to site constraints

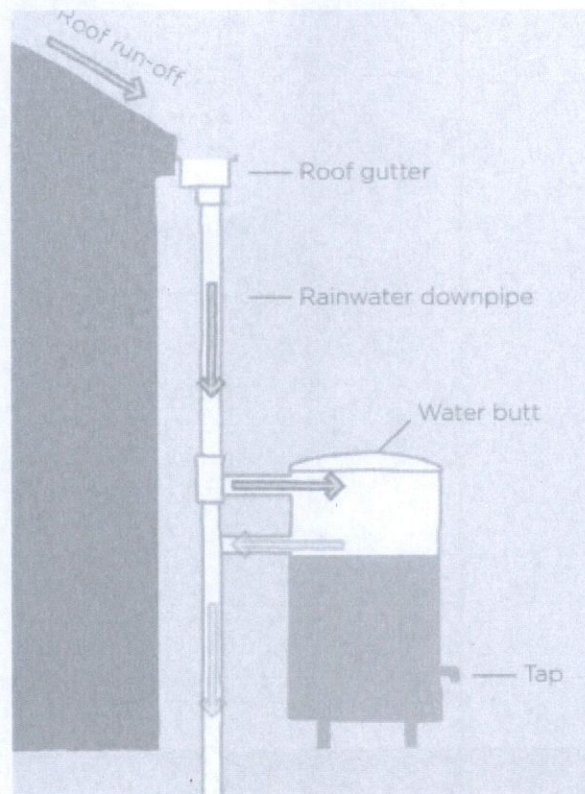

Image: typical water butt arrangement

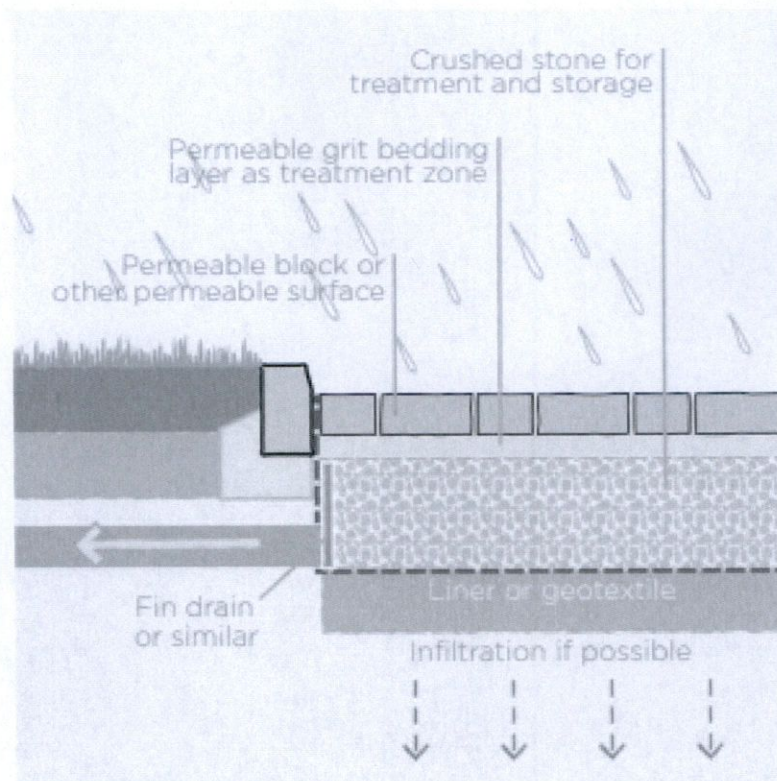
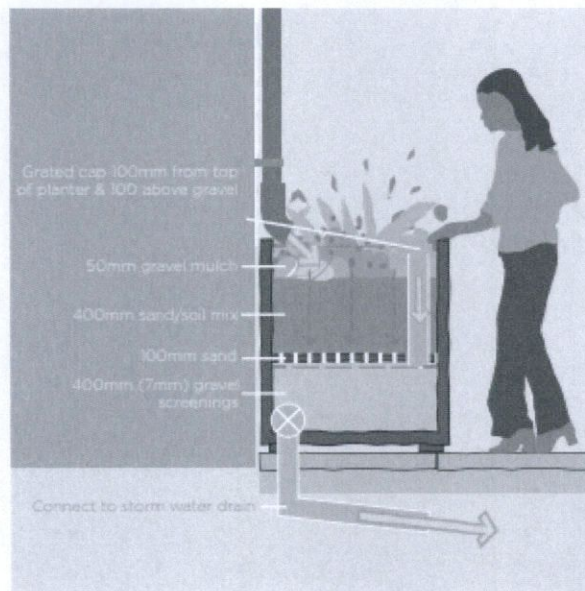

Image: typical construction profile of permeable pavement



*Image: permeable grass grid used on a driveway*



*Image: typical raingarden planter profile*

Yours Sincerely

*Keith Matthews*

For and on behalf of p|d|c architectural

p|d|c architectural  
CRO Reg: 491995 – Tax Reg: 7193089

