

PROPOSED BIO MASS UNIT - PLAN
1:50 @ A1

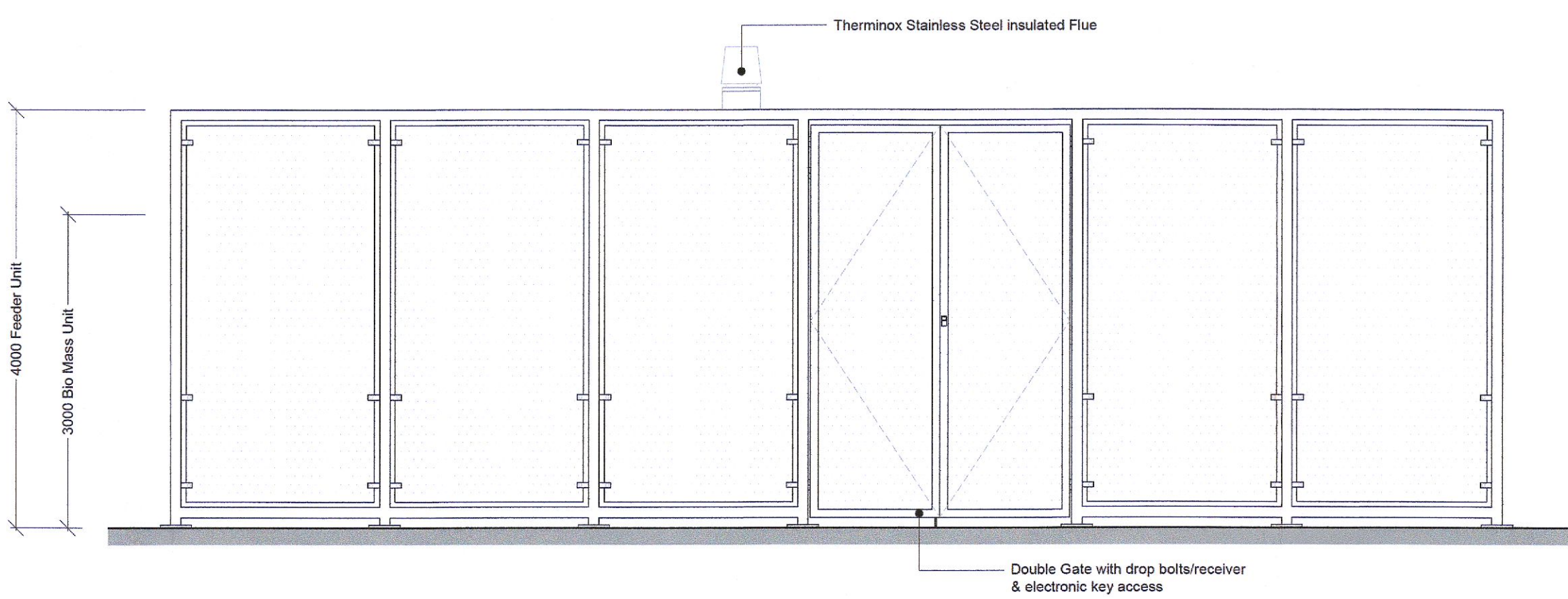

ELEVATION 01
1:50 @ A1

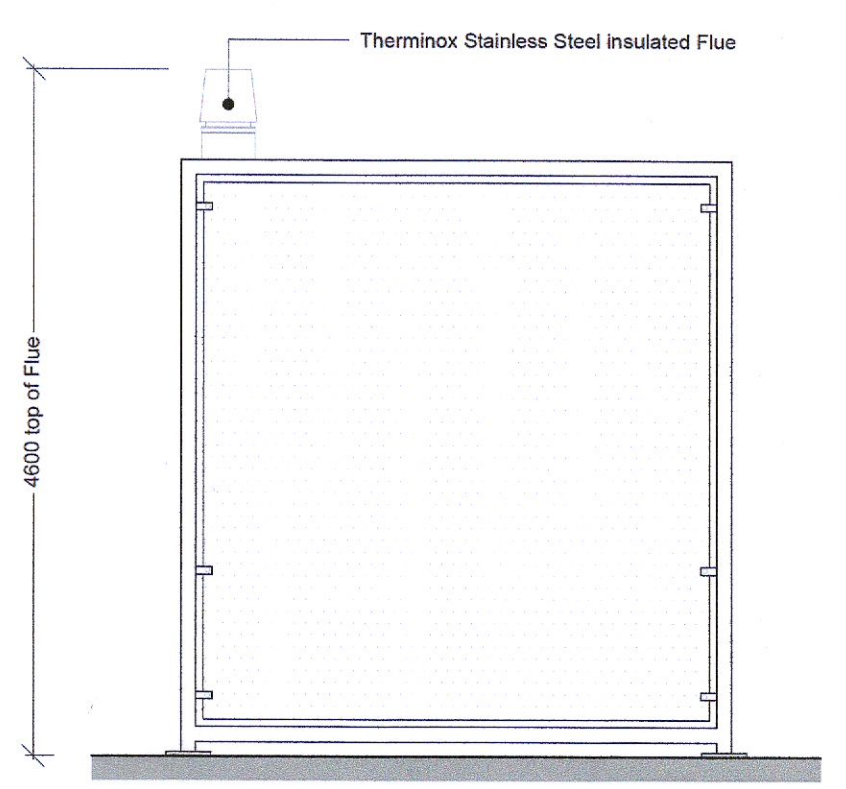

ELEVATION 02
1:50 @ A1

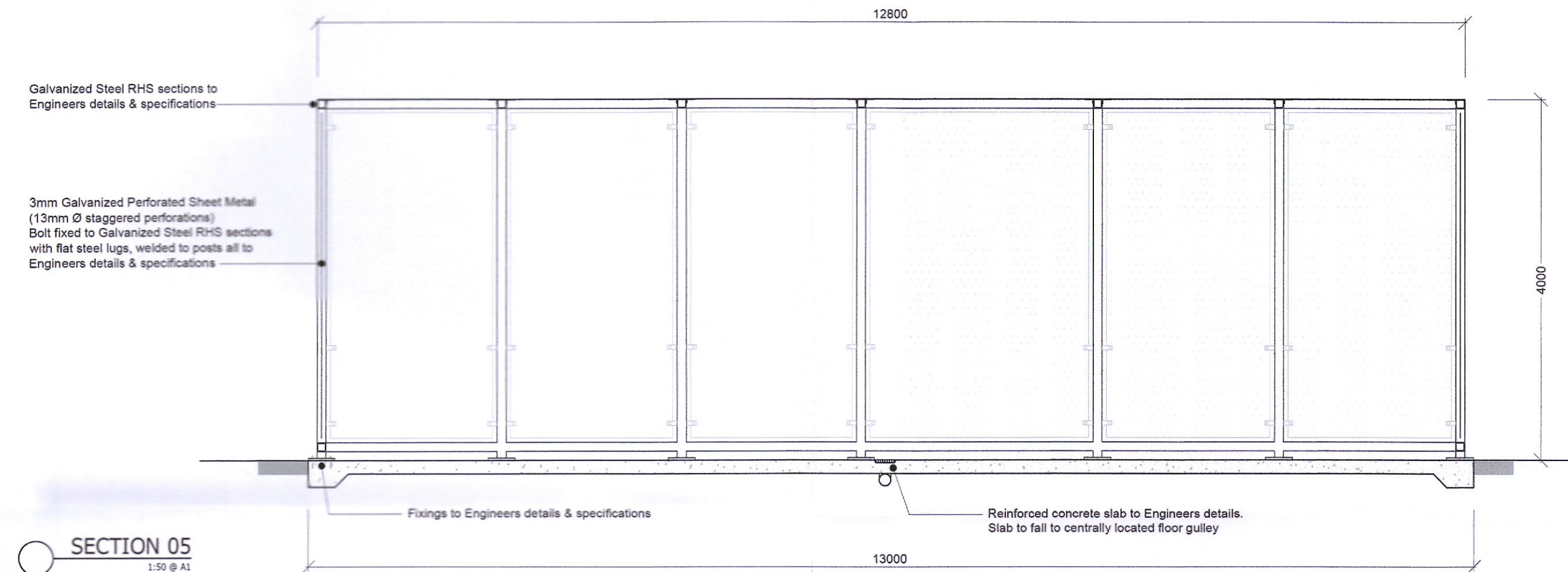

SECTION 05
1:50 @ A1

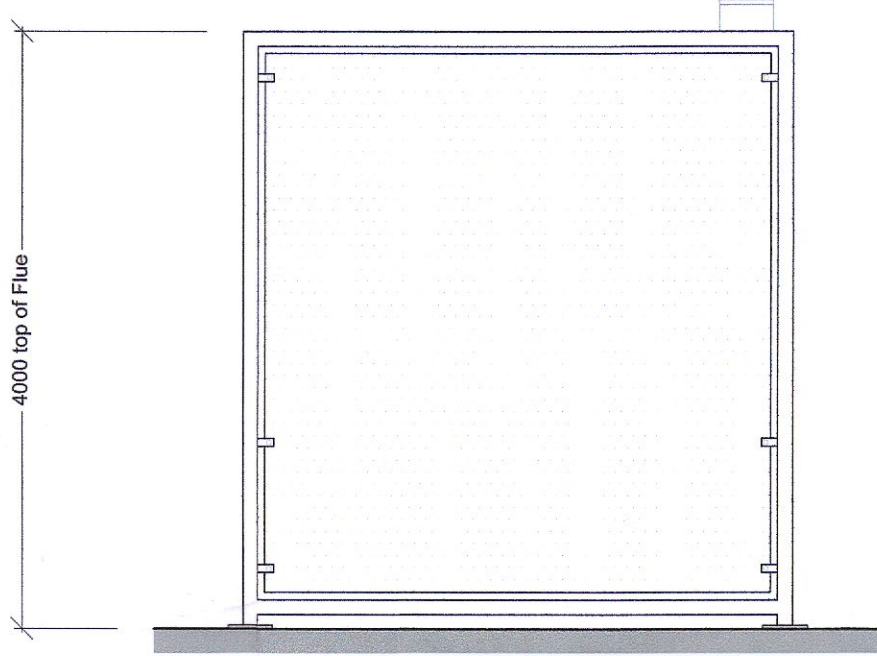

ELEVATION 04
1:50 @ A1

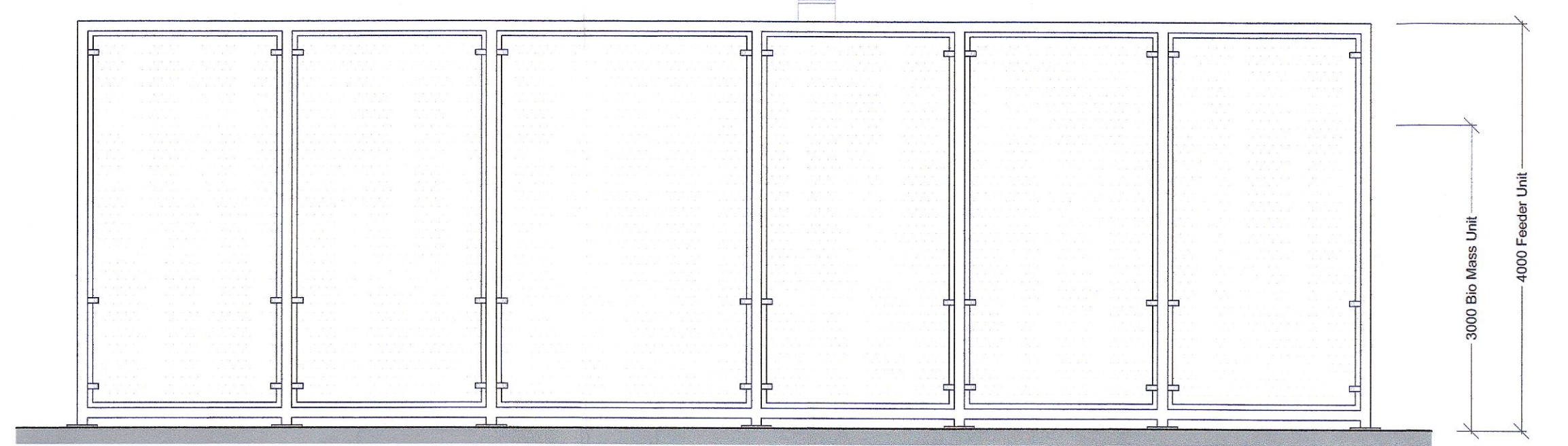

ELEVATION 03
1:50 @ A1

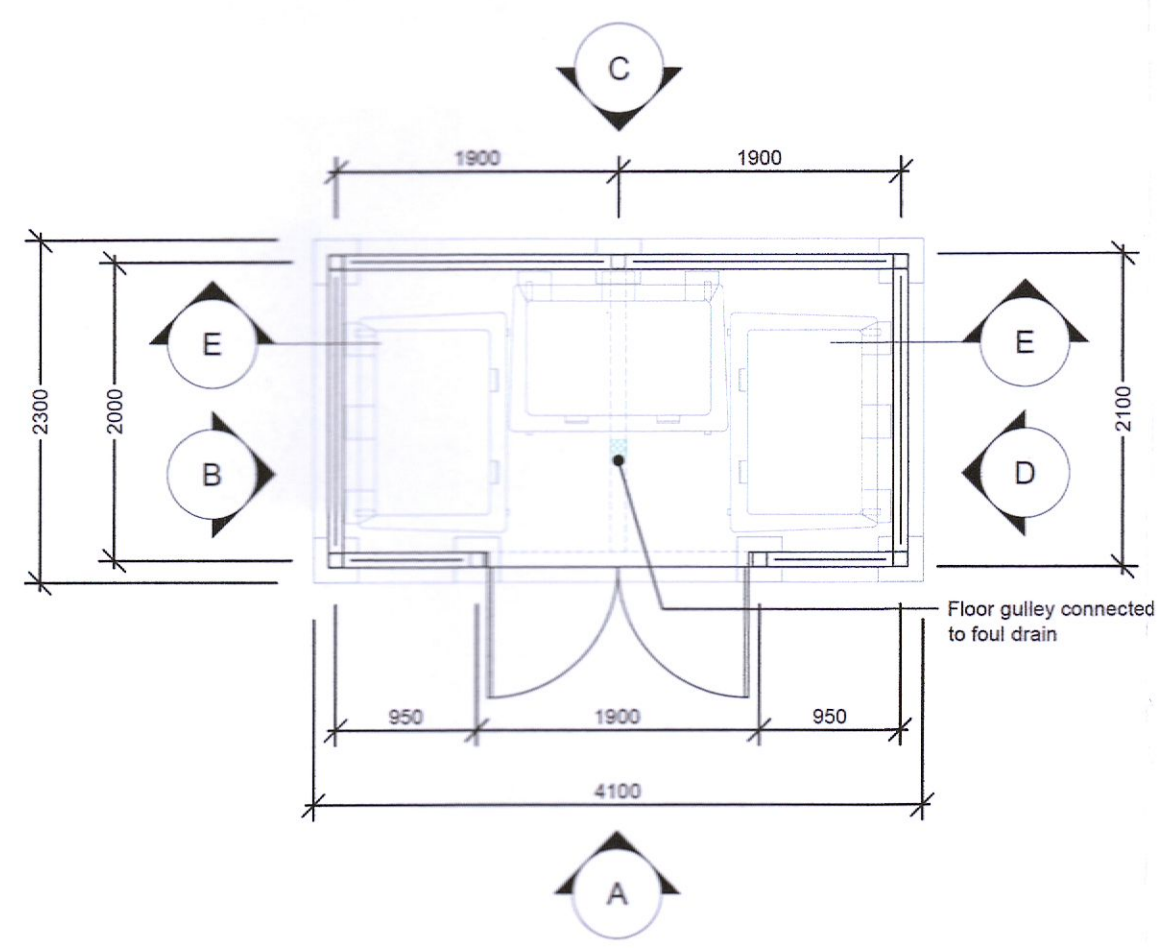

PROPOSED BIN SHELTER - PLAN
1:50 @ A1

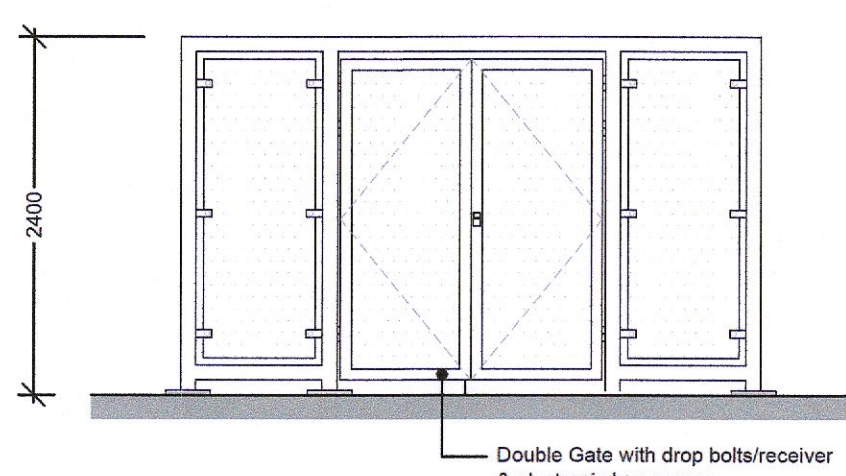

ELEVATION A
1:50 @ A1

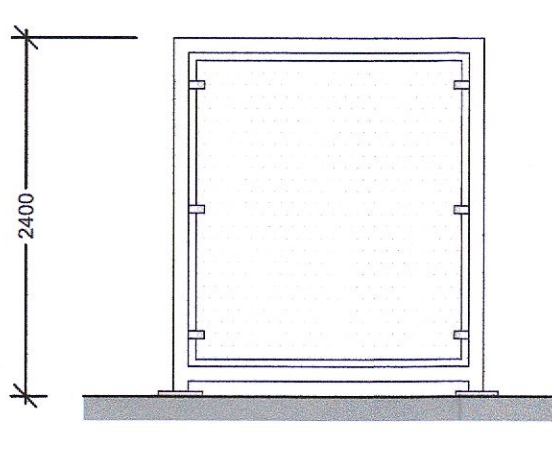

ELEVATION B
1:50 @ A1

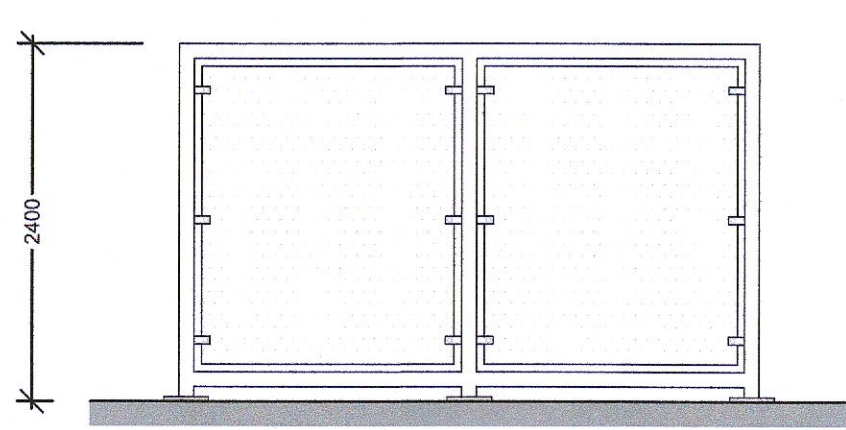

ELEVATION C
1:50 @ A1

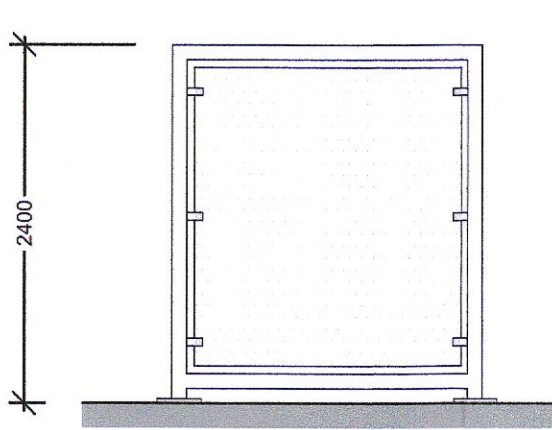

ELEVATION D
1:50 @ A1

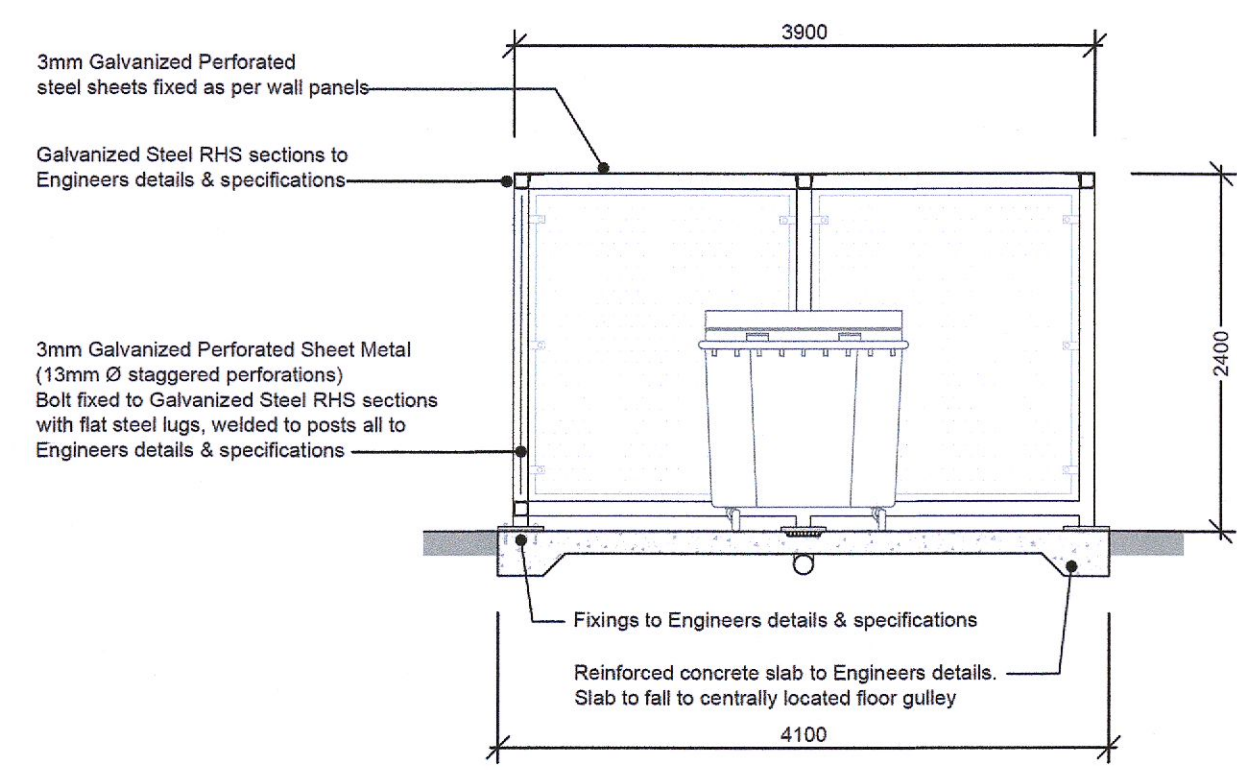

SECTION E
1:50 @ A1

PLANNING RFI RESPONSE

DO NOT SCALE FROM THIS DRAWING
Copyright in all documents and drawings prepared by AFEC Engineering Ltd. and in any works extracted from these documents and drawings shall remain the property of AFEC Engineering Ltd. unless otherwise agreed at project inception.
This drawing is to be read in conjunction with all relevant engineers & specialist drawings, specifications and contract documents. Work to agreed dimensions only. All documents to be verified by the contractor on site. All discrepancies should be reported to the architect prior to commencement of the works.

REV	DATE	DESCRIPTION	DRWN BY	CHKD BY	APPD BY
P02	16.01.2023	ISSUED AS PLANNING RFI	CW	DL	MC
P01	25.07.2022	ISSUED FOR PLANNING	MD	DL	CK

CLIENT	AFEC JOB NO.
Department of Education	22005
DRAWING TITLE	SCALE (@ A1)
External Structures - Biomass Unit & Bin Storage	1:50
SCHOOL	STATUS
Site @ Kishoge	S04
DRAWING NUMBER	REVISION
SDP-AFEC-00-DR-A-6001	P02



Bl. Swords Enterprise Park, Swords, Dublin, M17YX37
www.afec.ie | info@afec.ie | P: 01 6642855